

Sears

owners manual

SPIKE TOOTH HARROW

another free manual from www.searstractormanuals.com

MODEL NO.
235 261320

M 5555

DIV.# 32 QTY 1
SCE# 235
PART# 507024
DATE 12-15-78

CAUTION:
Read Rules for
Safe Operation
and Instructions
Carefully

- Assembly
- Operating
- Repair Parts

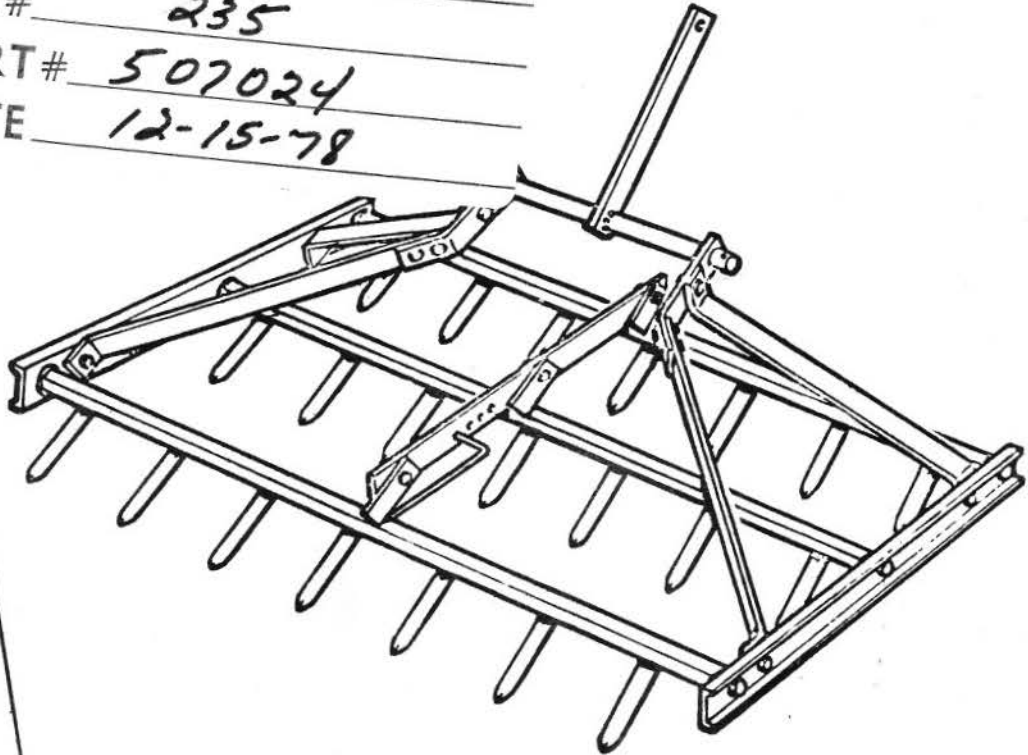

SEARS, ROEBUCK AND CO. U.S.A.
SIMPSONS-SEARS LIMITED, CANADA

507024

Printed in U.S.A.

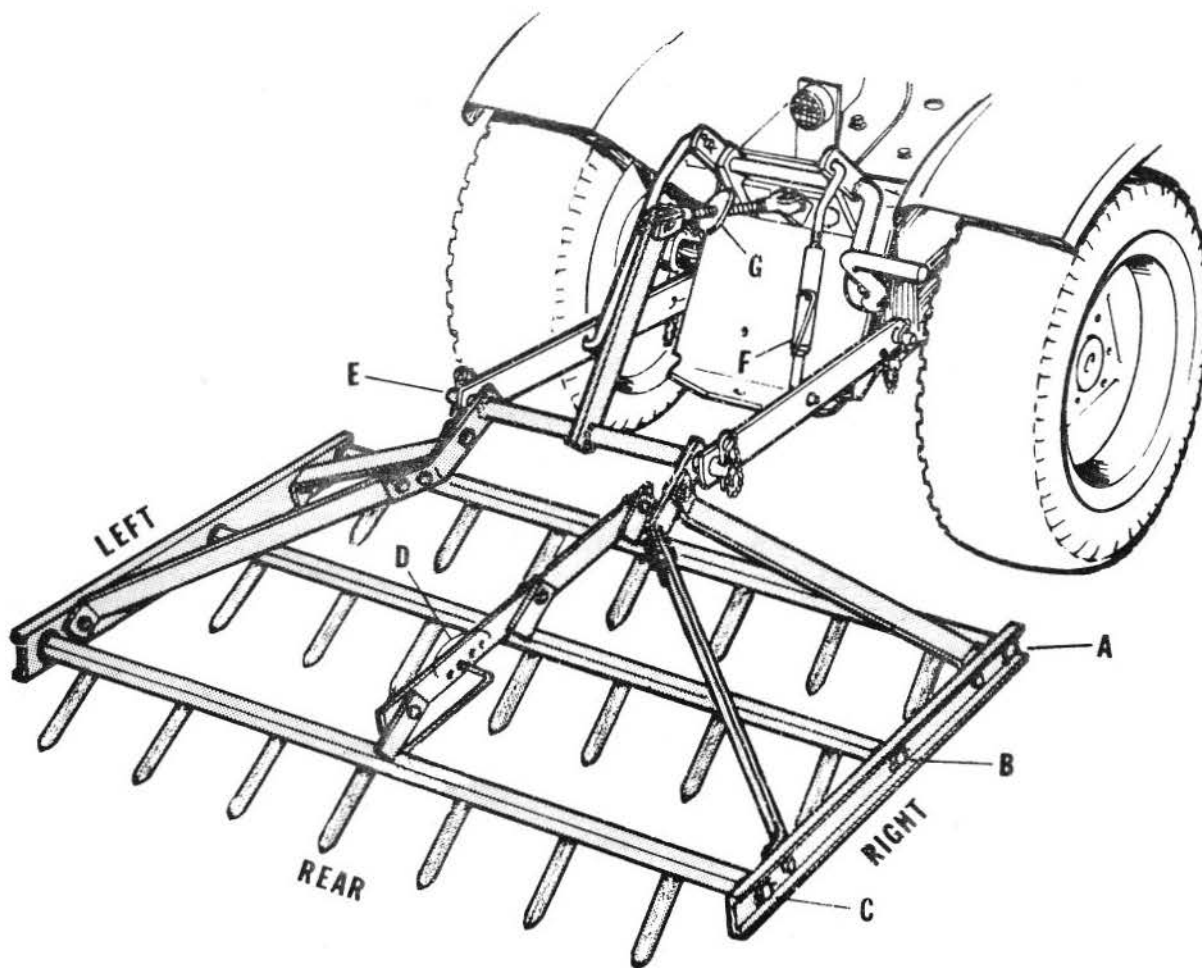

FIGURE 1

ASSEMBLY

ASSEMBLING THE HARROW (See Figure 1 and 2).

1. A. Lay side rails out parallel and approximately 40' apart. The flat side of the rails should face each other.
 - B. Next, lay the tooth bars between the side rails with the teeth down. **Note:** Each bar has a different spacing arrangement for teeth. Note also that each bar has an adjusting flange welded to the top of the bar. This flange points rearward or to the rear of the harrow.
 - C. Insert the round end of the first tooth bar into the most forward hole (A) in each of the side rails. Place the center bar in the center hole of the rails (B) and then the rear tooth bar, which has the adjusting pin attached, into the most rearward hole (C).
 - D. Put a cotter pin #11 into the holes on each end of all bars and secure by bending the ends.
2. A. Attach the adjusting bar #5 to the three tooth bars. The 3 adjusting holes (D) in the bar should locate between the center and the rear tooth bars. The adjusting bar mounts on right side of the tooth bar flanges. Secure with capscrews and nuts. Do not tighten.
 - B. Place adjusting pin in the first or second hole on adjusting bar and insert retaining pin #12.
3. A. Attach lower end of each rear brace #3 to side rails. Tighten capscrew and nut only finger tight. **DO NOT SECURE.**

- B. Attach lower end of each front brace #2 to side rails. Again tighten capscrew and nut finger tight only.
- C. Attach top end of front brace #2 to the frame #1. Do not tighten nuts.
- D. Attach top end of rear brace #3 to frame #1.
- E. Now, go back and tighten nuts. Alternating side to side to prevent twisting the unit off center. **NOTE:** Do not tighten the 3 nuts on the adjusting bar.

ATTACHING TO TRACTOR

- 1. A. Refer to your 3 point hitch instruction book if the hitch is not yet mounted on tractor.
 - B. With hitch on tractor, back tractor into position in front of harrow.
- 2. Slip L.H. hitch link onto the round frame rods (E) of harrow and secure with the retaining pin.
- 3. The R.H. hitch link is adjustable by means of the turnbuckle (F) on that side of the hitch. Rotate the turnbuckle until the hole in the R.H. hitch link aligns with the frame rod. Slip the link onto the rod and secure with the retaining pin.
- 4. Attach one end of the clevis to the center point of the hitch and the other end to the center bar of the frame.
 - A. Secure with pin and cotter on each end.

adjusting

ADJUSTING THE HARROW

- 1. A. Move the tractor and harrow to a fairly level surface such as lawn, driveway or shed floor.
 - B. The turnbuckle (F) on the R.H. link will level the harrow from side to side.
 - C. The clevis adjusting screw (G) raises or lowers the front of the harrow.
 - D. Make adjustments at these points until the harrow is setting level. This is the correct position for normal operation.

OPERATING

- 1. A. Drag the harrow a short distance in the soil you desire to work. Dismount and check the result.
 - B. Deeper harrowing is done by moving the adjusting pin to a more forward hole.
 - C. A concrete block or large stones placed in the weight box #10, also helps. The weight box sits atop the center and rear tooth bars and should be centered side to side.
- 2. The front of the harrow should be raised slightly for clearing trash, etc.
- 3. Moving in alternate directions or going over the same area at a right angle make a finer seed bed.
- 4. The drag harrow can be used for all jobs and purposes for which a large harrow is used. The prime uses being to drag, level and prepare soil for seed bed prior to planting.

MAINTENANCE

- 1. Clean the drag harrow of mud and debris after each use.
- 2. Check nuts and tighten any that have worked loose.
- 3. Put a small amount of grease or oil on the ends of the teeth bars and outside rod ends of the frame to prevent squeaks.

LEGEND: LH - Left Hand RH - Right Hand

REPAIR PARTS

SPIKE TOOTH HARROW ASSEMBLY - MODEL NUMBER 235 261320

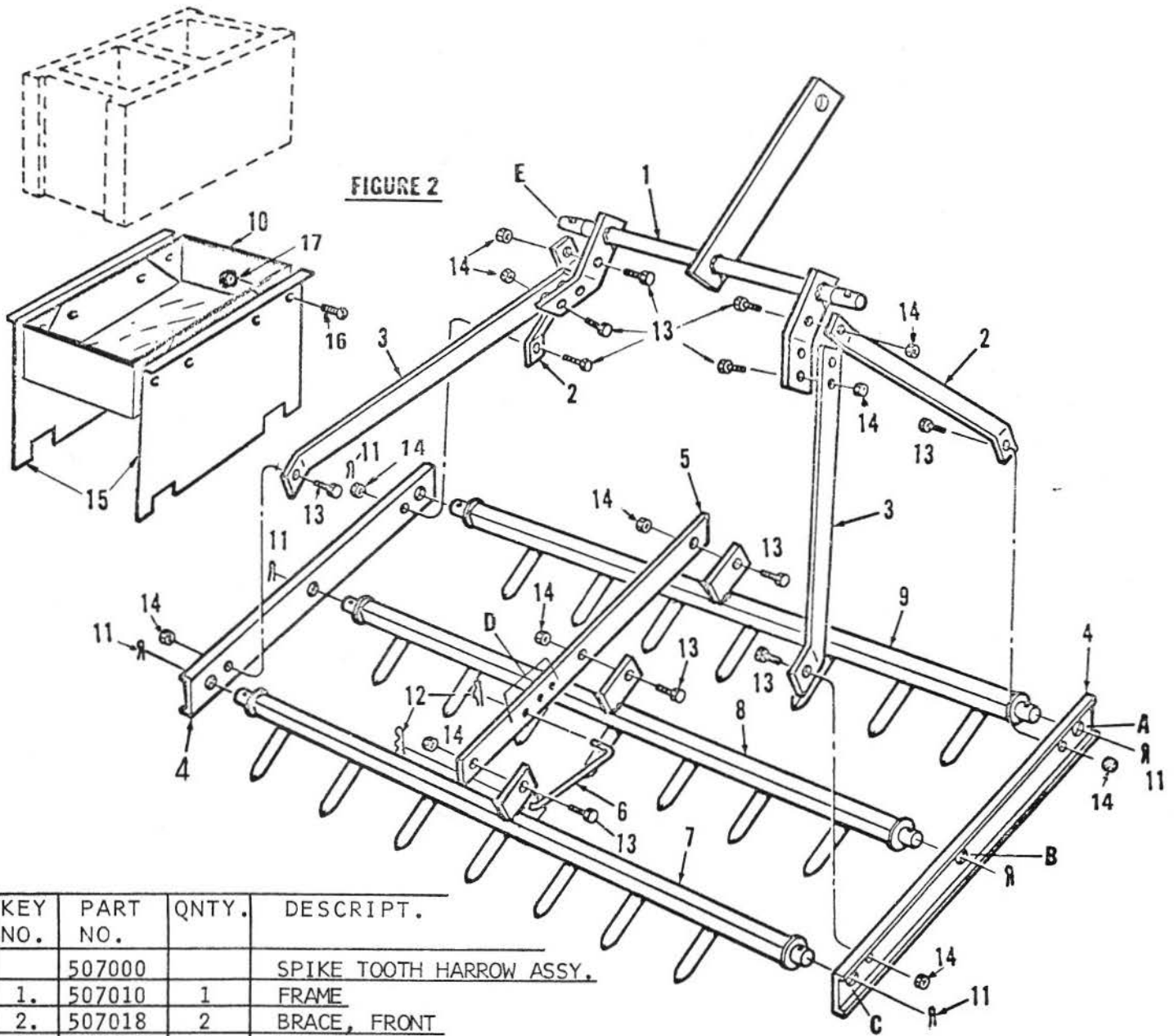

KEY NO.	PART NO.	QNTY.	DESCRIPT.
	507000		SPIKE TOOTH HARROW ASSY.
1.	507010	1	FRAME
2.	507018	2	BRACE, FRONT
3.	507017	2	BRACE, REAR
4.	507014	2	SIDE RAIL
5.	507015	1	ADJUSTING BAR
6.	507016	1	ADJUSTING PIN
7.	507008	1	TOOTH BAR, REAR
8.	507007	1	TOOTH BAR, CENTER
9.	507006	1	TOOTH BAR, FRONT
10.	507028	1	WEIGHT BOX SHELF
11.	103408	6	COTTER PIN, 3/16" X 1 1/4"
12.	900001	2	#3 HAIR PIN
13.	120233	13	3/8-16 X 1" HEX HD. BOLTS
14.	9416107	13	3/8-16 LOCKNUTS
15.	507027	2	WEIGHT BOX SIDES
16.	131375	8	1/4-20 RD. HD. SCREWS
17.	9416918	8	1/4" FLANGE NUTS