

Sears

**owners
manual**



MODEL NO.
597.261620

SUBURBAN TRACTOR SEEDER AND FERTILIZER

CAUTION:
Read Rules for
Safe Operation
and Instructions
Carefully

- Assembly
- Operating
- Maintenance
- Repair Parts

Sears, Roebuck and Co., Chicago, Ill. 60684 U.S.A.
and Simpsons Sears Limited, Toronto

INTRODUCTION

The Sears Seeder has been designed to permit quick mounting and dismounting to the Sears Suburban Tractor. The Seeder will plant a variety of seeds and will meter the seeds accurately at all practical spacings and will eliminate the need for thinning crops.

It is important that the instructions in the manual be studied and followed closely in order to obtain good results.

The Sears Tractor Seeder Model 597.261620 is shipped in one carton. Carton #597.25.

The Fertilizer attachment is especially designed for quick easy on and off mounting to your Seeder. Mounting is extremely rugged and will operate under many types of conditions. The flexibility of the fertilizer attachment will allow its use for any normal type use. The simple easy adjustments allow the fertilizer to be placed as far or close to seed as is desired for all practical purposes. Fertilizer may also be placed on top of the ground or to any depths to 4" below the ground. Simple finger tip adjustment permits control of amount of fertilizer that is required. Hopper design allows material to flow without clogging.

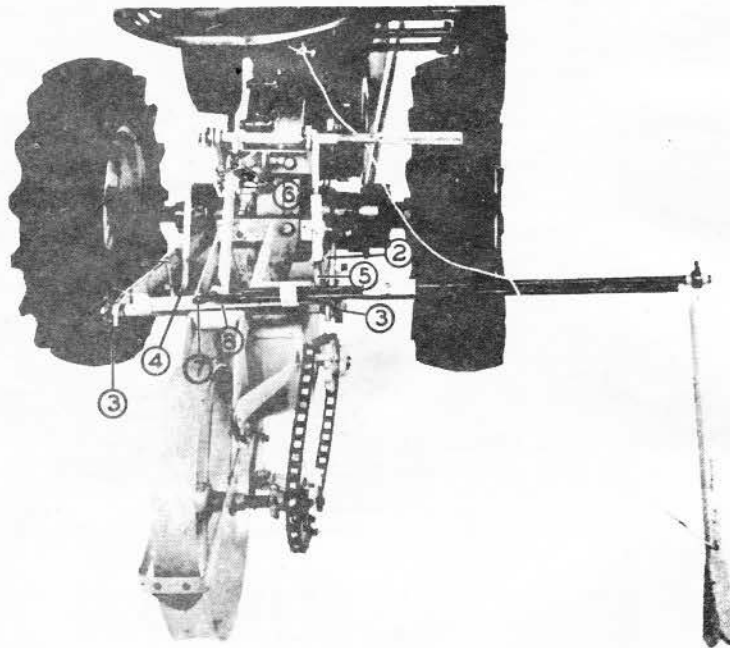

HOW TO ASSEMBLE SEEDER

Mount the Three Point Hitch to the tractor and assemble with the instructions furnished;

1. Assemble the adapter plate marked "L" to the left hand three point hitch lift lever.
2. Assemble the adapter plate marked "R" to the right hand three point hitch lift lever.
3. Slide the two bearings of the two lifting levers over the shaft welded to the seeder frame and lock in place with bobby pins.
4. By moving the left hand three point hitch lifting link the end of the link can be aligned to be inserted into the hole of the adapter plate. Lock in place with bobby pin.
5. By turning the adjustment on the right hand three point hitch lifting link the end of the link can be aligned to be inserted into the hole of the adapter plate. Lock in place with bobby pin.
6. By turning the adjustment on the center upper three point hitch lifting link the end of the link can be aligned to be inserted into the hole of the lift bar welded to the seeder. Lock in place with bobby pin and then turn adjustment until seeder is in a level position. Tension on the wheel can be changed by the adjustment.

7. When seeder is in use without Fertilizer Attachment, mount the Marker Mounting Bracket to the top of the back Hopper Bracket (bracket closest to wheel) of the Seeder, keeping the stops on the marker bracket to the rear of the Seeder. The stops of the Mounting Bracket are the two welded angles on each end of the Mounting Bracket. Secure the Marker Bracket with the two (2) bolts provided, using the two (2) holes located in the rear hopper bracket.
8. The bent end of the marker rod is inserted into the bushing which is located in the center of the mounting bracket. This rod should be inserted from the rear of the Marker Mounting Bracket so that the Marker Rod will rest in front of the stops of the marker bracket.
9. When the Fertilizer Attachment is being used with the Seeder the Fertilizer is mounted in accordance with the instructions provided with the Fertilizer. The Fertilizer bracket is mounted under the marker bracket and the two bolts which are provided with the marker bracket are used in place of two bolts which come with Fertilizer. The washers are used as spacers and are placed on each of the bolts between the Fertilizer bracket and the Marker Mounting bracket.

HOW TO ASSEMBLE FERTILIZER

(A) — To Assemble Fertilizer Attachment and Mount on Seeder:

1. Remove U Bolts (#8020).
2. Attach mounting bracket (#F8013) to fertilizer bracket assembly (#F8007) as shown in Fig. A. Do not tighten nut too securely. Then place this assembly in position as shown in Fig. B, keeping the two bars which extend down from the fertilizer mounting bracket on the outside of Seeder rear scraper bracket. Now fasten securely with 2 bolts the T End of Mounting Bracket Part (#F8013) to the bracket on Seeder.
3. Replace U bolts (#8020) see Fig. B, bring side braces which hold U Bolts (#8020) backwards so the edge of side braces will be flush with the back side of Seeder scraper bracket. While in this position tighten U Bolts. (#8020).
4. Now tighten nut under instruction #2 above so that mounting bracket (#F8013) and fertilizer bracket assembly (#F8007) are secure.
5. Remove cotter key (opposite from sprocket) on Seeder axle shaft, loosen set screw in wheel hub and then remove axle shaft from seeder. Place sprocket (#F8025) on axle shaft and then replace shaft back to its original position. Replace cotter key being sure cotter key is up against rear axle bearing and then retighten the set screw on rear wheel hub. Do not fasten set screw on sprocket (#F8025) yet.
6. Loosen the two top nuts on the fertilizer mounting bracket (#F8007). Place fertilizer body assembly (#F8001) in place as shown in Fig. A. Do not fasten nuts yet.
7. Place chain (#F8021) over both sprockets (#F8025 - #F8006). Line up the sprocket (#F8025) on Seeder axle with the sprocket (#F8006) on fertilizer shaft, then tighten the set screw on sprocket (#F8025).
8. Raise fertilizer body assembly (#F8001) keeping same level until slack is removed from chain (#F8021) and tighten the two nuts which hold fertilizer body in place. CAUTION: Do not overtighten chain.
9. Loosen U Bolts (#8016) enough to permit feed tubes (#8015) to be inserted thru U bolts. See Fig. B, raise feed tubes until they meet with bottom of fertilizer body and then tighten nuts on U bolts.

Fertilizer attachment is now ready for use.

SEEDER OPERATING INSTRUCTIONS

The ground intended to be planted should be properly prepared and should be of a fine texture, free of trash, and should be well leveled by raking or rolling.

The depth of planting is first determined and then adjusted by raising or lowering the seed hopper unit by means of loosening the two wing nuts which hold the hopper in place. Additional adjustment may be obtained by loosening the set screw on the hopper shoe and then raising or lowering the shoe.

Row covers, (illustration #26 and #27) are furnished, which are adjustable. By loosening the bolts which hold them in place, the angles of the covers may be changed, which will put more or less dirt on the seeds as desired.

Each sprocket is numbered according to the number of teeth on it, and is both interchangeable and reversible — i.e., it will go on either wheel or hopper shaft and will go on either way which allows proper alignment of sprocket chain.

For best results it is important to select the proper seed disc. To help in selecting the disc refer to chart on page 9. The chart is intended as a general guide and is not always the most accurate, since seeds will vary in shape and size. It is recommended that the proper disc for each purpose can be selected by a few simple tests. In some cases one seed at a time is desired for planting, while in other cases, it may be desired to plant two or more seeds at a time. To select the correct disc, choose one that appears to be correct, hold same in your hand in a vertical position and hold in the same hand a flat piece of steel or wood backed against the side of the disc where the pocket breaks through. Place the number of seeds you wish to be planted together in the one pocket of the seed disc and see if the pocket will hold the seed or seeds. Remove the wood or steel backing and see if the seed will fall through the pocket. By following this procedure you will be able to determine whether the seed disc pocket is too small or too large to permit the planting of seed or seeds as desired. If the disc you tested does not suit, select the next size larger or smaller as the test indicates and repeat the test until the proper disc is found.

When filling the seed hopper with any particular type of seed, always make certain that there are no left-overs in the hopper. Remove the hopper by loosening the two wing nuts and then slipping the wing nuts through the slots of the seeder brackets. The hopper is easily cleaned by turning same upside down.

The flow control disc is used to regulate the flow of seeds from the large compartment to the sowing compartment. Adjust the flow control disc by rotating until the desired opening is obtained. Note: When sowing a small quantity of small seeds, better results are obtained by completely closing the flow-control disc and inserting the seeds directly into the sowing compartment.

To remove seed disc from hopper, take hold of the outer end of the hopper shaft and pull outward thus compressing the clutch spring, which releases the seed disc for removal or insertion. After inserting required disc, release hold on hopper shaft and revolve shaft which will automatically engage seed disc with the drive disc.

The brush assembly is used to insure positive ejection of small seeds. It is easily removed or replaced and we recommend its use only with the A and B disc.

Do not permit tractor to go backwards while planting shoe is engaged with the soil, as this will cause shoes to become clogged.

FERTILIZER OPERATING INSTRUCTIONS

1. To adjust for the desired spacing of fertilizer loosen U bolts holding feed tubes enough to permit feed tubes to be spread apart to the desired position, then retighten the U bolts.
2. To place fertilizer at desired depth loosen the nuts on U bolts which are welded to openers, then raise or lower openers to obtain desired location and then retighten nuts. Position the openers as in photo B.
3. Before filling the hopper with fertilizer pull Feed Adjustment gauge (#8010) out to the last notch of finger feed. (Shut off position so that fertilizer will not feed).
4. Fertilizer is now loaded into the hopper. To adjust for the required amount of fertilizer desired move feed adjustment gauge into the desired notch. There are 5 notches which permit a closing and 4 different size openings, each of the notches regulating different amounts of fertilizer to be fed.
5. NOTE: Fertilizer is fed when agitators are moving and it is important that the set screws on both sprockets and agitators are tight to prevent any of these parts from slipping on shafts.

DESIGN FEATURES

The Seeder is designed to handle every variety of practical problem that may confront the planter of garden seeds. The large selection of various size seed discs will permit the planting of every type seed from lettuce to beans.

For continuous-row, or drill seeding any one of the 7 twelve-pocket seed discs is used. The pockets of each disc are of a different size, corresponding to the size of the seed required. For hill seeding, four 2 pocket seed discs are available. As the disc turns, the pockets on the disc pick the seeds up from the bottom of the hopper and deliver the seed through the opening in the side of the hopper, allowing them to fall through the ground tube and out through the opening shoe into the soil. This positive-feed method assures uniform, accurate spacing between seed dropping regardless of how fast the seeder is operated, or the number of stops made in crossing the field. This method will plant seeds without injuring the seeds.

For hill seeding where one or more seeds will be required in each hill, four-2 pocket discs are used, which permit the planting of one or more seeds in each hill at intervals of 16 - 24 - 36 - 48 - or 72 inches. The G-2 disc is furnished as standard equipment. The F-2, E-2, and J-2 discs are available by special order.

A full and adequate selection of seed spacing is provided through the use of the two combination sprockets. Depending upon which of the shafts each sprocket is placed on, and on which way it is placed any one of 7 combinations may be selected. By using a 12 pocket disc 7 combinations are possible. By using the 2 pocket disc 7 more combinations are available. The total of 14 combinations will make it possible to plant at all practical spacings. Each combination sprocket is made in one solid piece, therefore, there are no "spare" sprockets to get mislaid or lost, since both combination sprockets are always in use on the seeder.

The wheel is fitted with a scraper to keep the soil from sticking to it and making operation clumsy and difficult.

The seed hopper is instantly removable, so that any left over seeds can be easily emptied out when changing to a different type seed. Depth of planting is regulated by a quick simple adjustment. The design of the opening-plow insures sowing in a straight, narrow row, which permits close cultivation and a considerable saving of time and labor by elimination of thinning and a great reduction in the amount of weeding necessary.

A pair of adjustable row coverers is furnished which can be adjusted to each individual need to insure proper coverage of dirt over the seed regardless of the unevenness of the ground over which the seeder is being operated.

The Marker Assembly is provided so that the desired spacing between rows can be maintained when planting.

The extension clamp is provided to permit adjusting to various desired spacings. The Marker is held in place by inserting the Marker Collar between the eyes of the Marker and sliding the marker rod through the eyes and marker collar. Secure thumb screw on marker collar when desired position is found.

To change the marker for use from one side to the other side, swing the marker rod with the rope.

SEARS SUBURBAN TRACTOR SEEDER

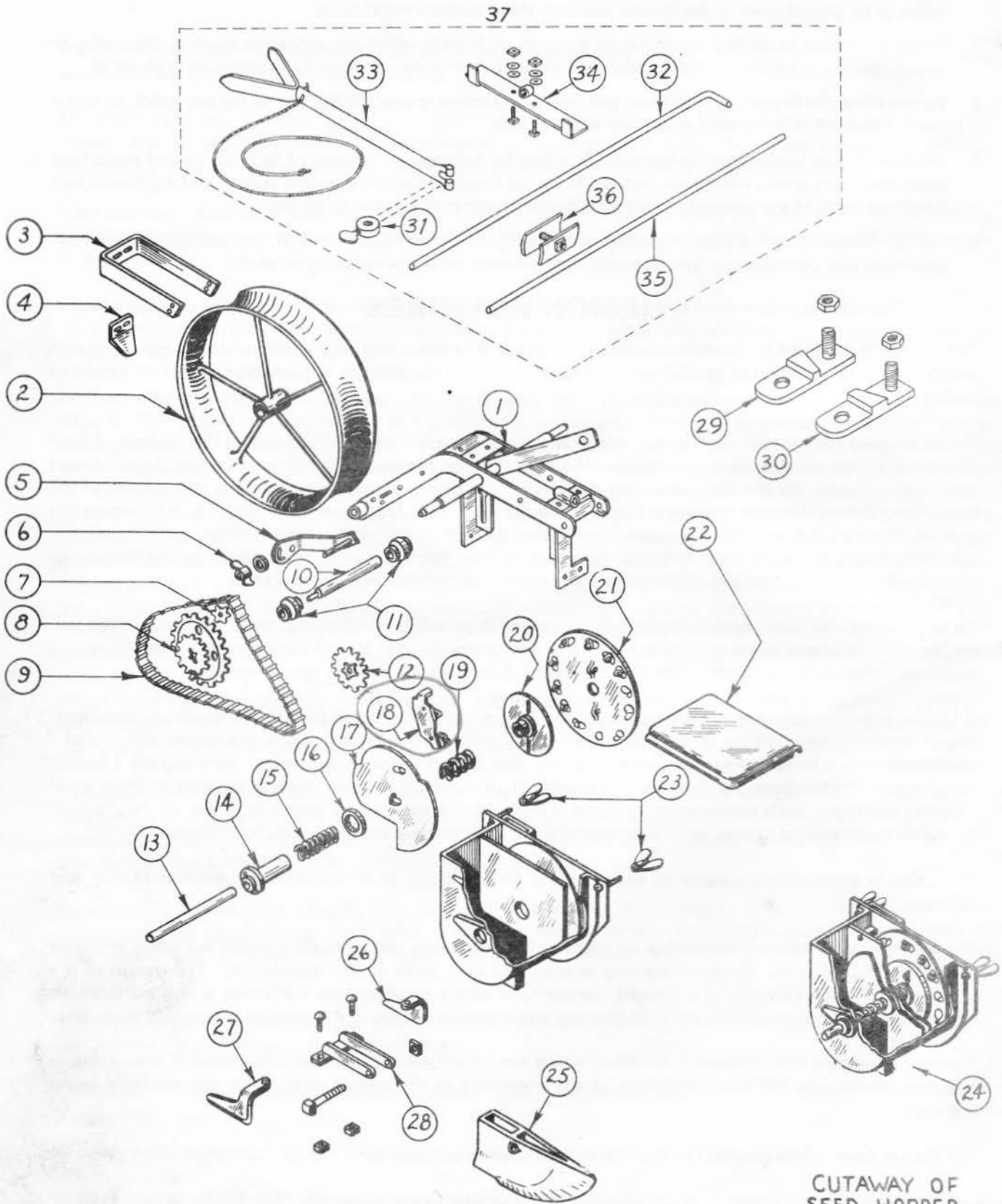

FIGURES 3 AND 3A

CUTAWAY OF SEED HOPPER

SEARS SUBURBAN TRACTOR SEEDER PARTS LIST

Illus. No.	Part No.	Part Name	Illus. No.	Part No.	Part Name
1	#17034R	Chassis Assembly		#17020E 2	3/8 Diam. Pocket (2 Pocket Seed Disc)
2	#17112B	Concave Rear Wheel		#17020F 2	1/2 Diam. Pocket (2 Pocket Seed Disc)
3	#17093	Rear Scraper Bracket		#17020G 2	9/16 Diam. Pocket (2 Pocket Seed Disc)
4	#17117	Concave Wheel Scraper		#17020J 2	3/4 Diam. Pocket (2 Pocket Seed Disc)
5	#17182B	Idler Lever Assembly			
6	#10000	5/16 - 18 Wing Nut	22	#17097	Hopper Cover
7	#17081	Idler Sprocket 6T	23	#17094	5/16 - 18 Wing Nut
8	#17019	Large Double Sprocket 12T-18T	24	#17060	Hopper Welded Assembly
9	#10001	Sprocket Chain #25 Link Belt 45 Links	25	#18093	Hopper Shoe
10	#17046	Rear Axle	26	#18090	L. H. Coverer Blade
11	#17045	Rear Wheel Bushings	27	#18089	R. H. Coverer Blade
12	#17018	Small Double Sprocket 6T-12T	28	#18091	Coverer Bracket Assembly
13	#17055	Hopper Shaft	29	#17303A	L.H. Adapter Plate
14	#17092	Hopper Sleeve Assembly	30	#17302A	R.H. Adapter Plate
15	#17062	Flow Control Disc Spring	31	#17024	Marker Collar
16	#17058	Hopper Flow Disc Washer	32	#17025R	Marker Rod
17	#17061	Flow Control Disc	33	#17078H	Marker
18	#17102	Brush Assembly	34	#17310	Marker Mtg. Bracket Assembly
19	#17063	Driving Disc Spring	35	#17311	Marker Ext. Rod
20	#17064	Driving Disc Assembly	36	#17312	Marker Ext. Clamp Assembly
21	#17020A12	1/8 Diam. Pocket (12 Pocket Seed Disc)	37	#17313	Complete Marker Assembly
	#17020B12	3/16 Diam. Pocket (12 Pocket Seed Disc)			
	#17020C12	1/4 Diam. Pocket (12 Pocket Seed Disc)			
	#17020D12	5/16 Diam. Pocket (12 Pocket Seed Disc)			
	#17020E12	3/8 Diam. Pocket (12 Pocket Seed Disc)			
	#17020F12	1/2 Diam. Pocket (12 Pocket Seed Disc)			
	#17020G12	9/16 Diam. Pocket (12 Pocket Seed Disc)			

NOTE: The Seed Discs (Tow Pocket), E-2, F-2, and J-2, are not furnished as standard equipment. These discs are optional and are available by special orders.

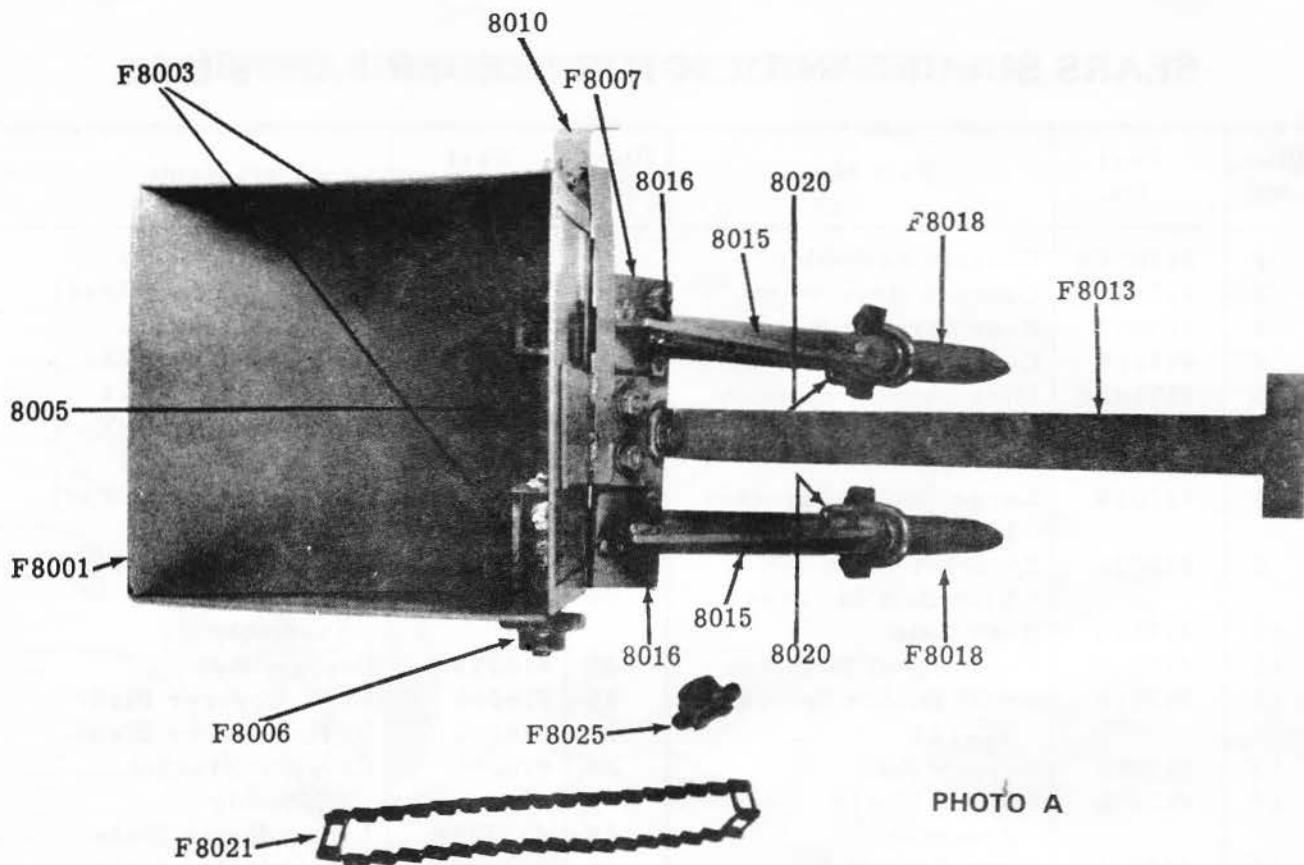

Figure A

FERTILIZER PARTS LIST

Part Number	No. Required	Part Name
F8001	1	Fertilizer Body only, including Feed Adjustment Gauge
F8003	2	Agitators
8005	1	Fertilizer Shaft
F8006	1	Fertilizer Sprocket 6T 7/16 Bore
F8007	1	Fertilizer Mounting bracket Assembly w/bolts, washers, and nuts
8010	1	Feed Adjustment gauge
F8013	1	Mounting Bracket
8015	2	Feed Tubes
8016	2	U Bolts w/nuts
F8018	2	Opener Assemblies
8020	2	U Bolts w/nuts
F8021	1	Std. #25 Link Belt Chain 38 Links
F8025	1	Axle Sprocket 6T



Figure B

DATA FOR FERTILIZER ATTACHMENT FOR GARDEN SEEDER

FERTILIZER HOPPER WHEN FULL HOLDS 15 LBS. OF FERTILIZER

GRANULATED FERTILIZER

When Adjusted:

- Full open — Fertilizer will run for 937 feet.
 - $\frac{3}{4}$ open — Fertilizer will run for 1406 feet.
 - $\frac{1}{2}$ open — Fertilizer will run for 1875 feet.
 - $\frac{1}{4}$ open — Fertilizer will run for 2344 feet.
-

- 1 lb. of Fertilizer will pass thru each full opening per 112 feet of travel.
 - 1 lb. of Fertilizer will pass thru each $\frac{3}{4}$ opening per 164 feet of travel.
 - 1 lb. of Fertilizer will pass thru each $\frac{1}{2}$ opening per 248 feet of travel.
 - 1 lb. of Fertilizer will pass thru each $\frac{1}{4}$ opening per 320 feet of travel.
-

PELLET TYPE FERTILIZER

When adjusted:

- Full open — Fertilizer will run for 875 feet.
 - $\frac{3}{4}$ open — Fertilizer will run for 1000 feet.
 - $\frac{1}{2}$ open — Fertilizer will run for 1715 feet.
 - $\frac{1}{4}$ open — Fertilizer will run for 9175 feet.
-

- 1 lb. of Fertilizer will pass thru both full openings per 58 feet of travel.
 - 1 lb. of Fertilizer will pass thru both $\frac{3}{4}$ openings per 66 feet of travel.
 - 1 lb. of Fertilizer will pass thru both $\frac{1}{2}$ openings per 112 feet of travel.
 - 1 lb. of Fertilizer will pass thru both $\frac{1}{4}$ openings per 612 feet of travel.
-

All of the above figures were calculated under normal operating conditions. Under certain variable conditions such as rates of speed of travel, different types of fertilizer, etc., variations of the above charts will occur. The above charts are approximate and are intended as a general guide.

DRILL SOWING CHART

Sprocket Arrangement		18 Tooth On Wheel 12 Tooth On Hopper	12 Tooth On Wheel 12 Tooth On Hopper	12 Tooth On Wheel 18 Tooth On Hopper
Pocket Disc	Seed			
A	Lettuce	400 ft. per oz.	600 ft. per oz.	900 ft. per oz.
A12	Carrots	400 ft. per oz.	600 ft. per oz.	900 ft. per oz.
	Onions	300 ft. per oz.	450 ft. per oz.	600 ft. per oz.
B12	Spinach	230 ft. per oz.	350 ft. per oz.	470 ft. per oz.
	Radish	165 ft. per oz.	250 ft. per oz.	335 ft. per oz.
C12	Parsnip	120 ft. per oz.	350 ft. per oz.	470 ft. per oz.
D12	Beets	185 ft. per oz.	275 ft. per oz.	370 ft. per oz.
	Swiss Chard	185 ft. per oz.	275 ft. per oz.	370 ft. per oz.
E12	Pea Beans	400 ft. per lb.	600 ft. per lb.	900 ft. per lb.
F12	Sweet Corn	400 ft. per lb.	600 ft. per lb.	900 ft. per lb.
G12	Peas	415 ft. per lb.	625 ft. per lb.	835 ft. per lb.
	Kidney Beans	200 ft. per lb.	300 ft. per lb.	400 ft. per lb.
E2	For Muskmelon and Cucumber			
F2 G2 J2	For Field Corn, Sweet Corn, Peas, Kidney Beans, when spacings from 16 inches to 72 inches are desired. These Seed Discs also can be used where more than one seed at a time is desired to be planted.			

HILL SOWING CHART

Spacing	Sprocket Arrangement		Pocket Disc
1 inch	18 Tooth on Wheel	6 Tooth On Hopper	12
2 inches	12 Tooth On Wheel	6 Tooth On Hopper	12
3 inches	18 Tooth On Wheel	12 Tooth On Hopper	12
4 inches	12 Tooth On Wheel	12 Tooth On Hopper	12
6 inches	12 Tooth On Wheel	18 Tooth On Hopper	12
8 inches	6 Tooth On Wheel	12 Tooth On Hopper	12
12 inches	6 Tooth On Wheel	18 Tooth On Hopper	12
16 inches	18 Tooth On Wheel	12 Tooth On Hopper	2
24 inches	12 Tooth On Wheel	12 Tooth On Hopper	2
36 inches	12 Tooth On Wheel	18 Tooth On Hopper	2
48 inches	6 Tooth On Wheel	12 Tooth On Hopper	2
72 inches	6 Tooth On Wheel	18 Tooth On Hopper	2

BEANS

CORN

IMPORTANT

The Sears Suburban Tractor Seeder is guaranteed for reasonable accuracy, dependability and economy when used in accordance with the preceding instructions. We cannot guarantee best results and full satisfaction if these instructions are not read and followed.

Sears

owners manual

MODEL NO.
597.261620

How to Order Repair Parts

**SEARS SERVICE
IS AT YOUR SERVICE
WHEREVER YOU LIVE
OR MOVE
IN THE U.S.A.**

The Model Number will be found on a plate attached to the side of the frame. Always mention the Model Number when requesting service or repair parts for your Seeder and Fertilizer.

All parts listed herein may be ordered through SEARS, ROEBUCK AND CO., or SIMPSONS-SEARS LIMITED. When ordering parts by mail, selling prices will be furnished on request or parts will be shipped at prevailing prices and you will be billed accordingly.

WHEN ORDERING PARTS, ALWAYS GIVE THE FOLLOWING INFORMATION AS SHOWN IN THIS LIST.

1. The PART NUMBER
2. The PART DESCRIPTION
3. The MODEL NUMBER
597.261620
4. The NAME OF ITEM—
Seeder and Fertilizer



When you buy merchandise from Sears you get an extra something that nobody else can offer . . . Sears Service.

Across town or across the country, wherever you live or move in the U.S.A., Sears Service follows you, providing trustworthy, competent service technicians using only Sears specified factory parts.

Sears, Roebuck and Co., Chicago, Ill. 60684 U.S.A.
and Simpsons Sears Limited, Toronto