

**Sears**  
owners  
manual

MODEL NO  
842.26002

**CAUTION:**  
Read Rules for  
Safe Operation  
and Instructions  
Carefully

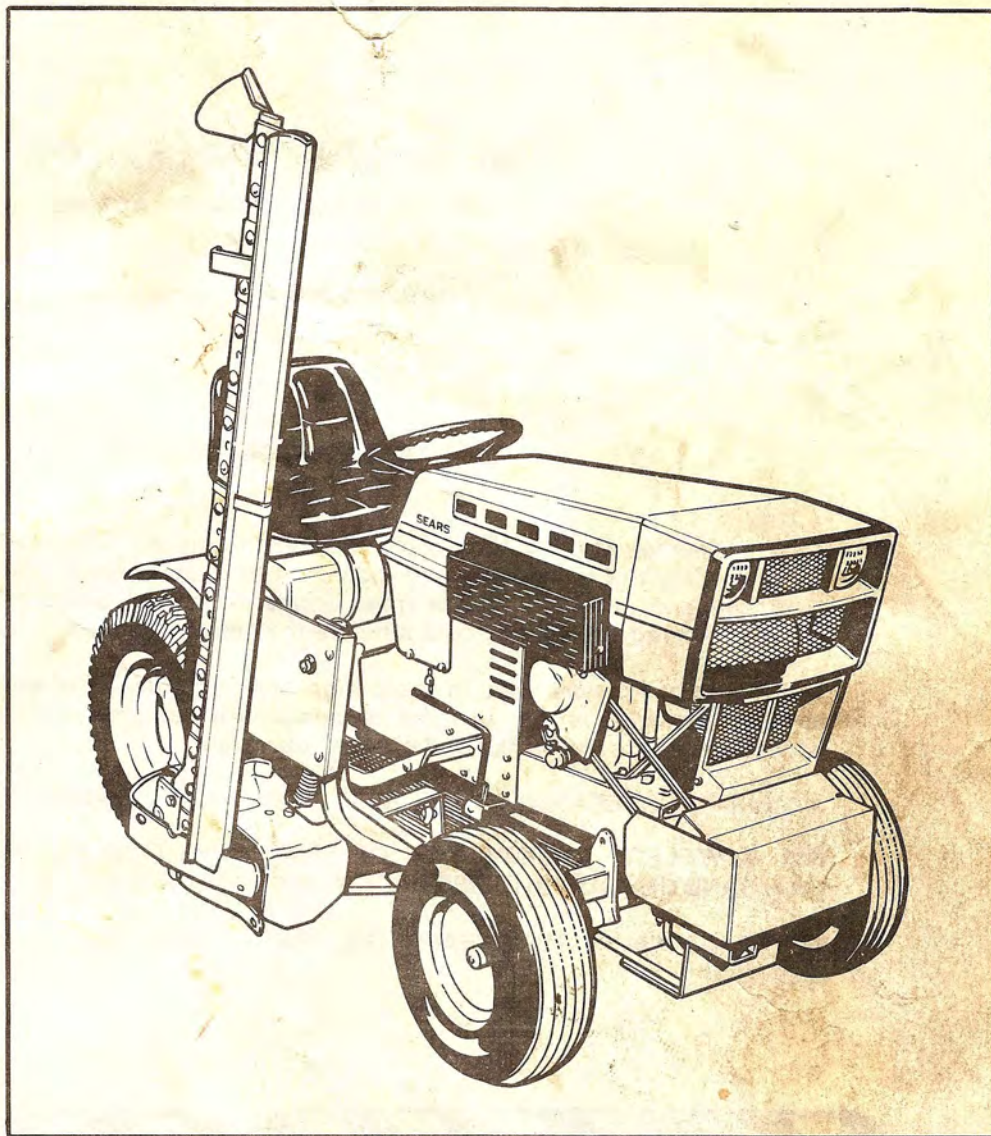

## SICKLE BAR MOWER ATTACHMENT

- **Set-up**
- **Operation**
- **Maintenance**
- **Repair Parts**

Sears, Roebuck and Co., Chicago, Ill. 60684 U.S.A.  
and Simpsons Sears Limited, Toronto

# BE A SAFE OPERATOR

BY THINKING – BEFORE ACTING

AND

BY READING YOUR OPERATORS MANUAL

## AVOID ACCIDENTS

Most accidents, whether they occur in industry, on the farm, at home, or on the highway are caused by the failure of some individual to follow simple and fundamental safety rules or precautions. For this reason most accidents can be prevented by recognizing the real cause and doing something about it before the accident occurs.

Regardless of the care used in the design and construction of any type of equipment, there are many conditions that can not be completely safe guarded against without interfering with reasonable accessibility and efficient operation.

A CAREFUL OPERATOR IS THE BEST INSURANCE AGAINST AN ACCIDENT.

THE COMPLETE OBSERVANCE OF ONE SIMPLE RULE WOULD PREVENT MANY THOUSAND SERIOUS INJURIES EACH YEAR. THAT RULE IS:

**NEVER ATTEMPT TO CLEAN, OIL, OR ADJUST A MACHINE WHILE IT IS IN MOTION!**

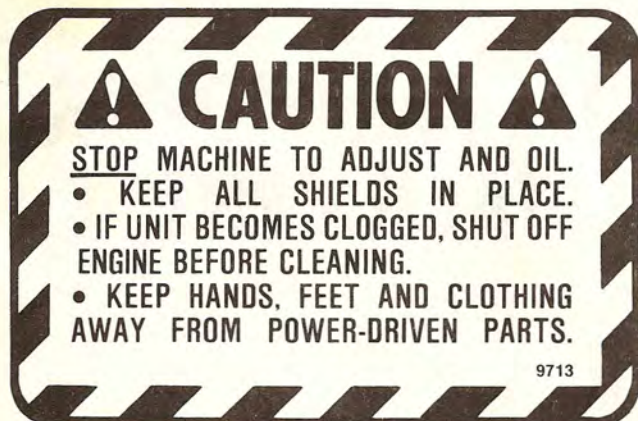

# SAFETY RULES



**ATTENTION! BECOME  
ALERT! YOUR SAFETY IS  
INVOLVED!**

This symbol is used to call your attention to safety precautions that should be followed by the operator to avoid accidents. When you see this symbol - Heed Its Warning.

Many hours of lost time and much suffering is caused by the failure to practice simple safety rules.

**IT IS TOO LATE TO REMEMBER WHAT SHOULD HAVE BEEN DONE AFTER THE ACCIDENT HAS HAPPENED.**

Read and become familiar with the owners manual for your tractor and mower before operating the mower.

Do not allow anyone to use the mower unless they have been instructed in how to operate it safely.

Never attempt to adjust, repair or service the mower while the tractor engine is running.

Be sure the sickle knives and drive belts have stopped after shutting off engine before attempting to adjust, repair or service the mower.

Do not allow others near the mower when it is operating.

Always stay clear of the drive belts, pulleys and sickle knives when the tractor engine is running.

Always disengage power to the mower and stop the engine before leaving the operators position.

Do not wear loose fitting clothing that may be blown into moving parts.



**CAUTION:** The sickle knives and belts may continue to move several seconds after the clutch has been disengaged or the engine shut off.

Mark clearly, or remove from any area to be mowed any objects which might be caught in or be struck by the sickle bar.

Always keep all shields and guards in place.

Tractor and mower should always be stopped and inspected for damage after striking a foreign object and the damage should be repaired before restarting and operating the equipment.

Operate the mower only in daylight.

Use caution when mowing on sloping surfaces.

When leaving tractor and mower unattended, always disengage PTO clutch, shift into neutral, set parking brake, stop engine and remove key. Install knife guard over sickle.

Always be especially careful when working around, raising or lowering cutter bar to or from transport position. The sickle knife cutting edges are very sharp and can cause injury.

**REMEMBER THAT SAFE OPERATION IS NO ACCIDENT.**



## SAFETY PRECAUTIONS



**CAUTION:** ALWAYS disengage tractor and/or sickle bar attachment clutch, stop tractor engine and set tractor parking brake before dismounting from tractor.

**CAUTION:** KEEP HANDS and feet away from the sickle.

**CAUTION:** DO NOT allow anyone to walk alongside, in front of, or behind the machine during operation.

**CAUTION:** The machine should not be lubricated or any adjustment made while it is RUNNING.

**CAUTION:** AVOID excessive speed.

# SEARS SICKLE BAR MOWER

## MODEL 842.26002

Your Sears Sickle Bar Mower has been designed specifically for your tractor with all controls convenient to the operator, its rugged construction assures you long life and highest performance. The mower cuts an effective 48" swath.

Keep this manual available for ready reference. It has been carefully prepared to instruct you in operating, maintaining and lubricating your Sears Sickle Bar Mower. Emphasis has been placed on safety and operator protection. However, careless and negligent operation can still result in serious injury to persons and property. It is very important that each operator fully understands the contents of this manual for safe, dependable operation and to prolong the life of the equipment.

### OPERATING TRACTORS WITH GEAR TYPE TRANSMISSIONS

Best cutting results will be obtained by operating tractor at  $\frac{3}{4}$  to full engine speed.

The tractor should be equipped with a wheel weight on the left rear wheel of the tractor. These can be obtained from your Sears store

Performance of the sickle knife depends on the following points, all of which are important: (1) sharpness of sickle knife; (2) wear plate adjustment; (3) straightness of knife bar; (4) hold-down clip clearance; (5) speed of sickle knife.

When mowing in extremely rough areas, tractor should be operated in 1st Gear (Low Range). Depending on ground and grass conditions. In other areas, 2nd Gear (Low Range) or 1st Gear (High Range) will usually give you the best results. When cutting brush larger than 1/2" diameter, it may be necessary to stop tractor movement when sickle bar makes contact and allow the sickle knife to cut through the brush material. It is not recommended to attempt to cut through material exceeding an inch in diameter.

The sickle bar mower can be transported from one location to another by raising the unit and locking it into position as illustrated on page 11 Fig. 15

Always install knife guard on mower bar when transporting. Fig. 15

Always operate at careful speeds in transporting and avoid making sudden or sharp turns with the mower in raised position.

### SPECIFICATIONS

Cutting Width .....	Mows 48" Swath
Drive .....	Belt Driven from tractor P.T.O.
Clutch .....	Manual
Suspension .....	Free-Floating, Spring Suspended
Mounting .....	Swivel, Vibration-Dampening
Cutting Speed .....	900-1100 Strokes per Minute
Stroke .....	Full 3" Width
Shear Knives .....	High Carbon Steel
Guards .....	Non-clogging
Vertical Adjustment .....	45° below to 45° above horizontal
Transport Position .....	Pin-Locked for Transport Automatic Spring-Loaded "Swing Back" device protects against damage from solid objects
Construction .....	All Steel, with Anti-Friction bearings

## Table of Contents

SAFETY .....	2-3
SET UP .....	5-9
OPERATION .....	10-15
MAINTENANCE .....	16
OPERATING MOWER .....	10
V-BELTS .....	12-13
SICKLE KNIFE .....	14
TRANSPORTING MOWER .....	11
ADJUSTMENTS .....	12-14
SERVICE TIPS .....	15
PARTS LISTING .....	17-23

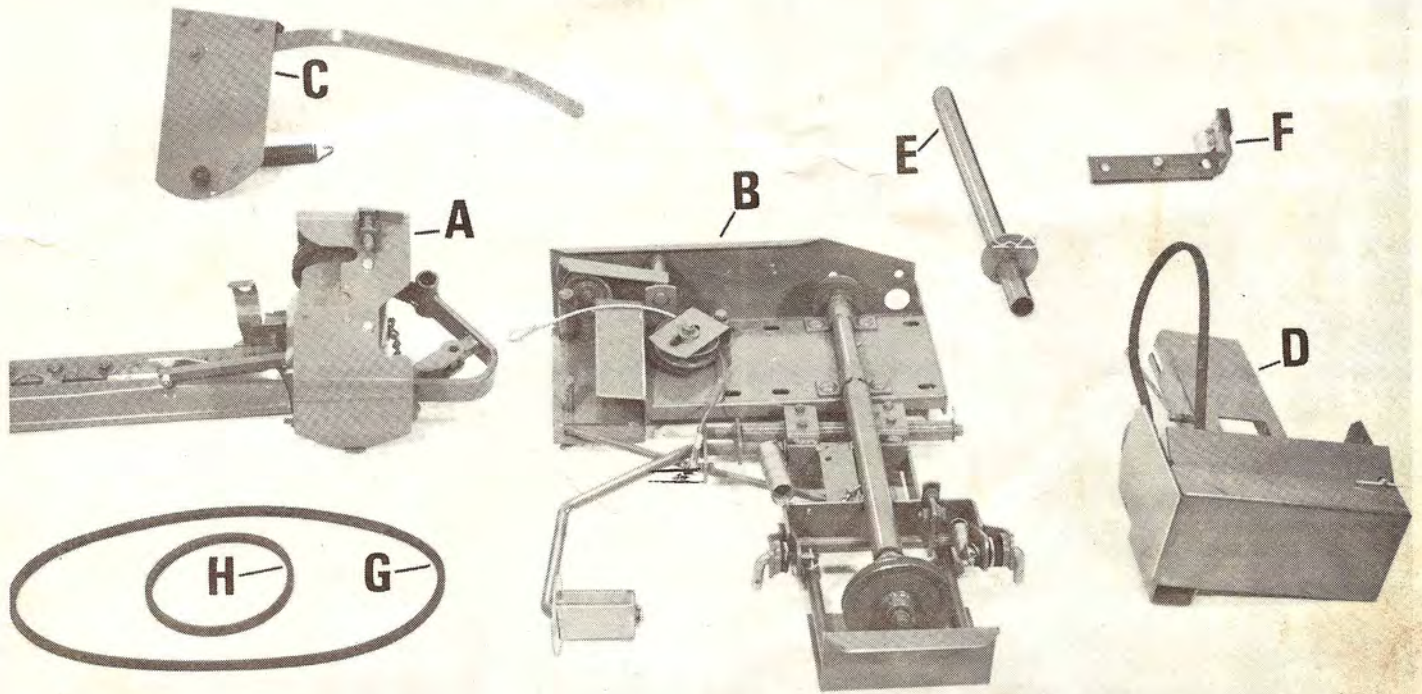

Fig. 1

Your Sears Sickle Bar attachment and all necessary parts and hardware are packed in one carton. Unpack the carton carefully to insure that all parts are present.

The sickle bar mower consists of the following: (Fig. 1)

- A. Basic Mower Assembly
- B. Main Frame
- C. Carrier
- D. Gearbox Assembly
- E. Pivot Pipe
- F. Drawbar Hitch
- G. Long V-belt
- H. Short V-belt

## TOOLS

With some tools you already own plus a few inexpensive items that can be purchased at your Sears store, set-up and maintenance can be accomplished quickly and accurately.

1. 9/16" open end wrench (2).
2. 3/4" open end wrench (2).
3. Grease Gun
4. Oil Can

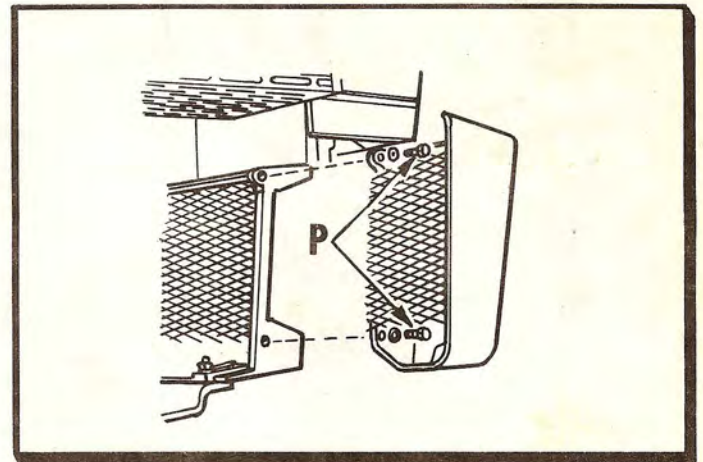

Fig. 2

## PREPARATION OF TRACTOR

1. Before beginning assembly of the sickle bar attachment, remove any other attachments on the tractor.
2. Remove right-hand grill side by removing bolts (P) shown in Fig. 2. Keep grill side and bolts so they may be replaced when sickle bar mower is removed.

# SET UP

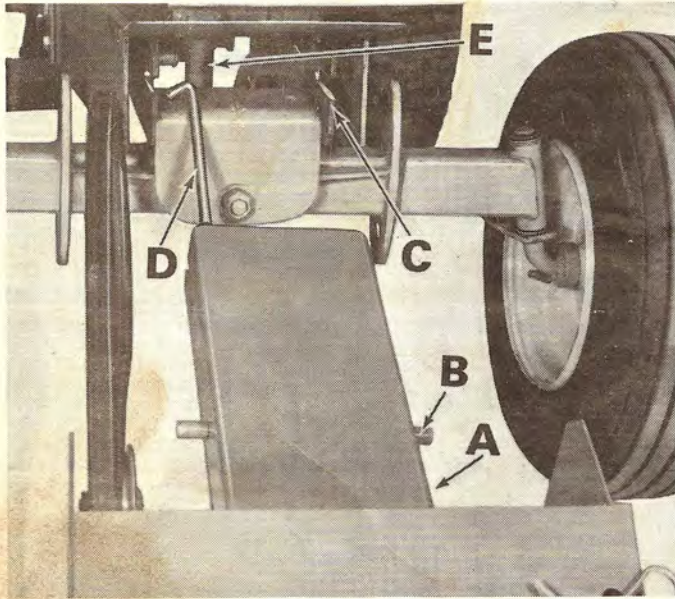

Fig. 3

## ATTACHMENT OF GEARBOX ASSEMBLY FIG. 3

Slide gearbox mounting frame (A) into tractor mounting channel until pins (B) reach rear of slots (C). Be sure that clutch adjusting rod (D) is to left of center bar (E). Install small V-belt (H, Fig. 1) onto gearbox pulley.

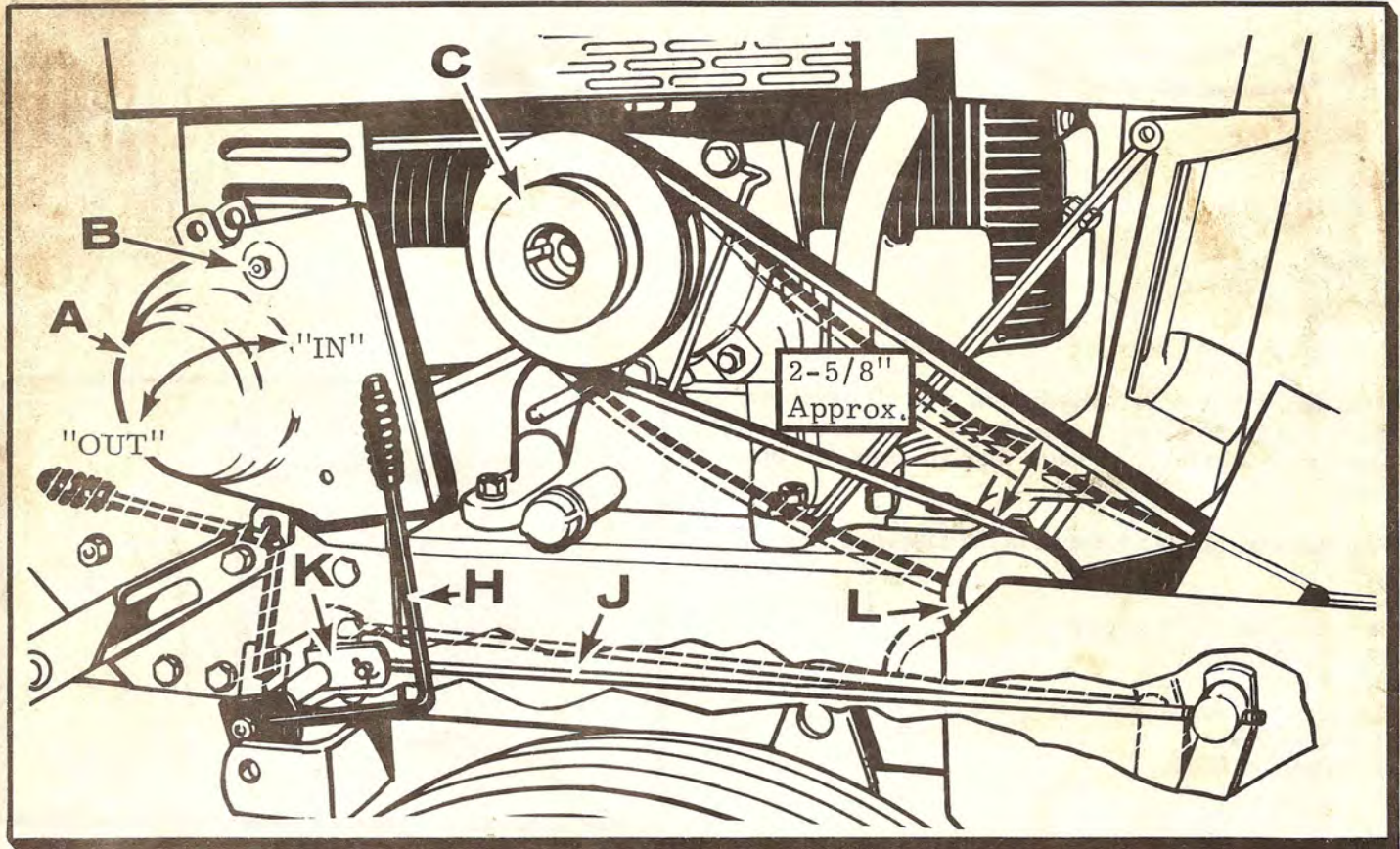

Fig. 4

## INSTALLATION OF SICKLE BAR CLUTCH BELT - FIG. 4

Remove pulley guard (A) and move belt guide (B) to top hole in guard marked "rotary mower". Hole marked "cutter bar mower" is not used. Place belt from gearbox around largest pulley shieve (C). Replace pulley guard, being sure that belt guide (B) is over the top of V-belt.

## ATTACHMENT OF CLUTCH ROD - FIG. 4

With the attachment clutch lever (H) in the "OUT" or disengaged position, connect rod (J) to strap (K) and secure with hair cotter pin. When attachment lever is engaged or in the "IN" position, the distance between the belt centers just above idler pulley (L) should be approximately 2-5/8" as shown. (See page 12 of "Operation" for belt adjustment.)

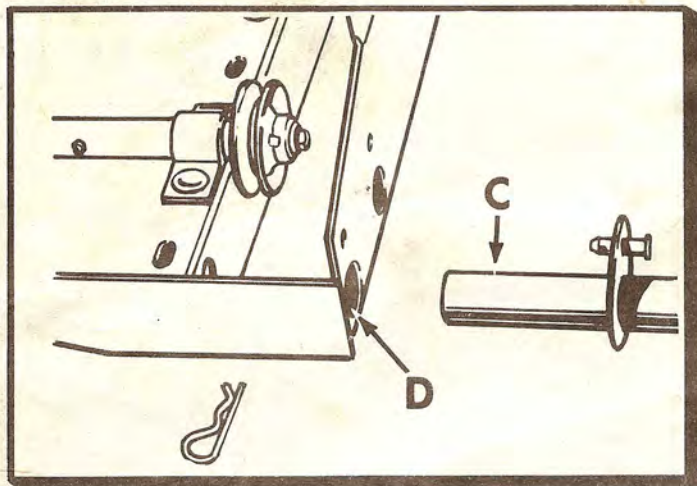

Fig. 5

## INSTALLATION OF MAIN FRAME TO TRACTOR FIG. 5

Slide main frame under tractor and center. Insert pivot pipe (C Fig. 5) into large outside hole (D) in main frame and locating peg into small hole. Secure with hair cotter pin through locating peg.

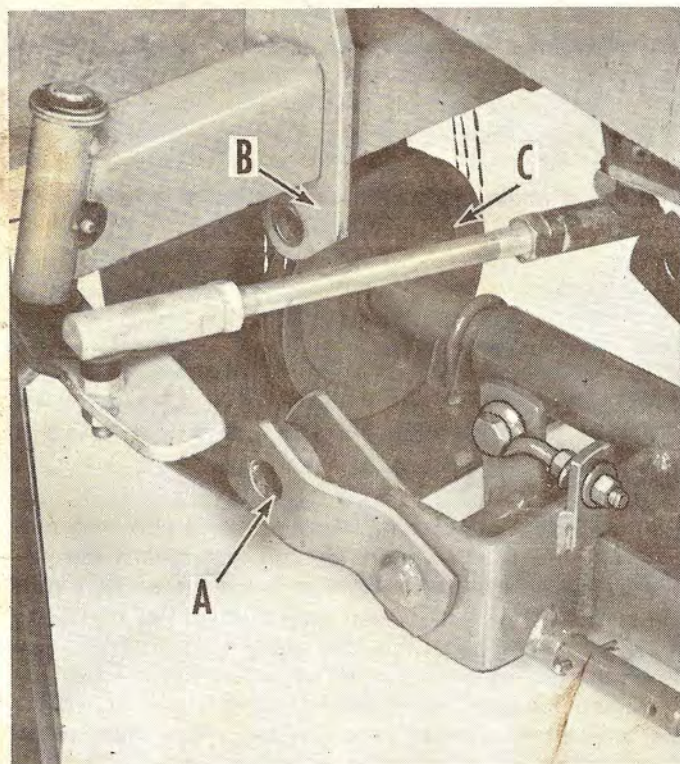

Fig. 6

Remove locating pins from front hanger straps (A). Fig. 6 : Note that left pin has washer and spring attached. Raise left side of main frame until tractor hanger bracket (B) is between hanger straps (A). Insert locating pin, add washer to pin and secure with hair cotter pin. Attach main frame to right side of axle in same manner using foot pedal for leverage in lifting. Place small gearbox belt around jackshaft pulley (C).

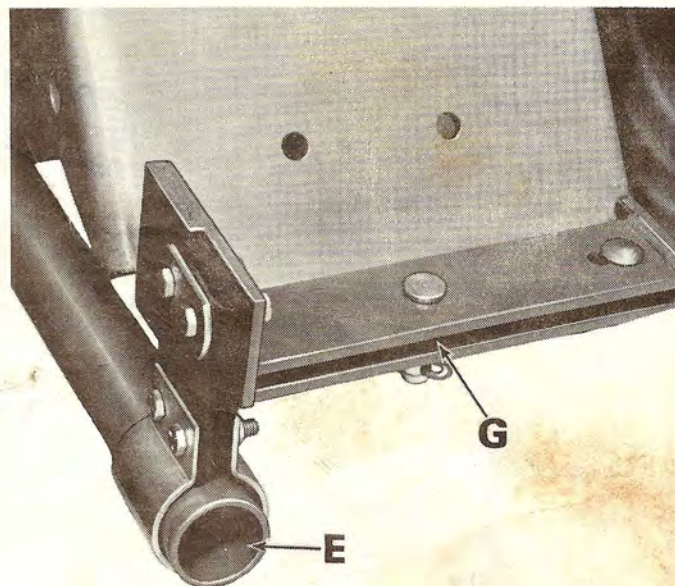

Fig. 7

Slide clamp shock absorber Fig. 7 (E, Fig. 1) onto pivot pipe (E). Remove clevis pin from drawbar hitch (G). Raise hitch and slide tractor drawbar plate between straps of drawbar hitch as shown in Fig. 7. Align holes in plate and hitch and insert pin. Secure with hair cotter pin.

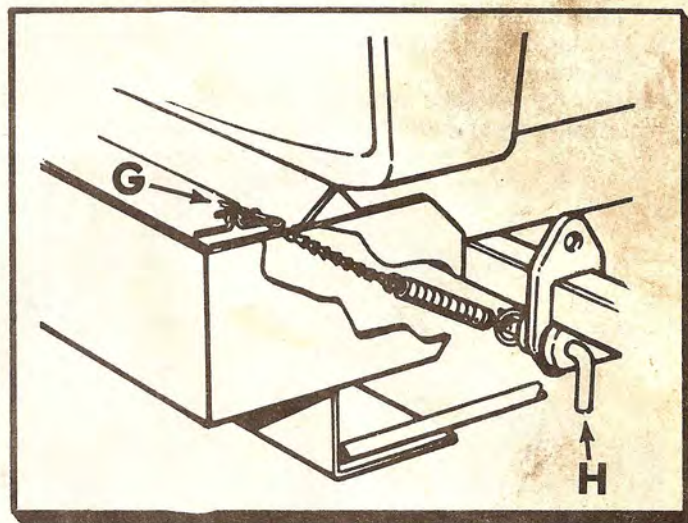

Fig. 8

## INSTALLATION OF GEARBOX RETAINER SPRING FIG. 8

To offset tension produced by the sickle bar clutching belt, a retaining spring must be added to the left side of the gearbox assembly. (Fig. 8 )

Remove hair pin from chain and toggle (G) Fig. 8. in upper left-hand corner of gearbox assembly, but leave chain in hole. Re-attach end of spring to washer on locating pin (H) and hook opposite end through last link of chain and toggle. Add tension to spring by pulling six to nine links out through hole in gearbox and secure by placing hair pin just above hole in gearbox assembly.

# SET UP

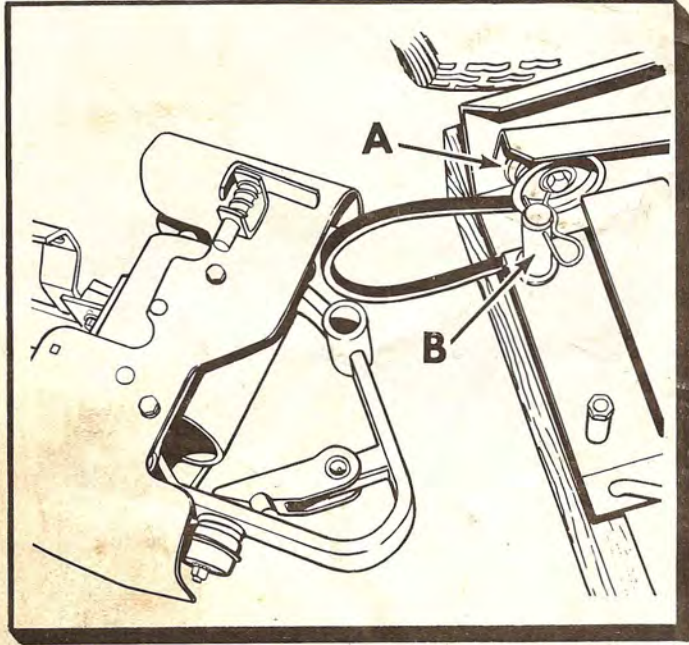

Fig. 9

## ATTACHMENT OF BASIC MOWER TO MAIN FRAME - FIG. 9

Prior to attaching basic mower to main frame:

1. Loop long belt over rear jackshaft pulley and under idler pulley (A). FIG. 9
2. Remove hair cotter pin and washer from peg (B) on main frame.

NOTE: For easiest installation of basic sickle, place wood two by four under main frame as shown in Fig. 9 .

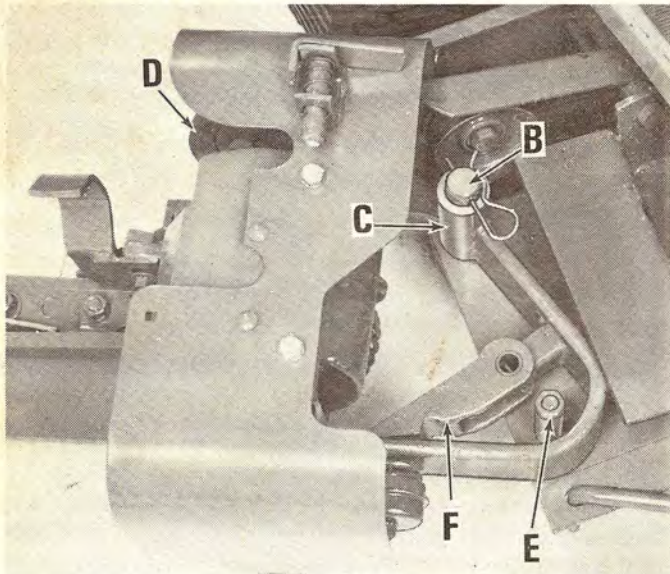

Fig. 10

Lift basic mower and place tube (C) over mounting peg (B). Put washer on peg and secure with hair cotter pin as shown in Fig. 10. Place jackshaft V-belt around flywheel pulley (D). The sickle bar is now in the break-back position. Lock it into operating position by pulling sharply forward on end of sickle bar until bolt (E) is securely in notch of latch (F).

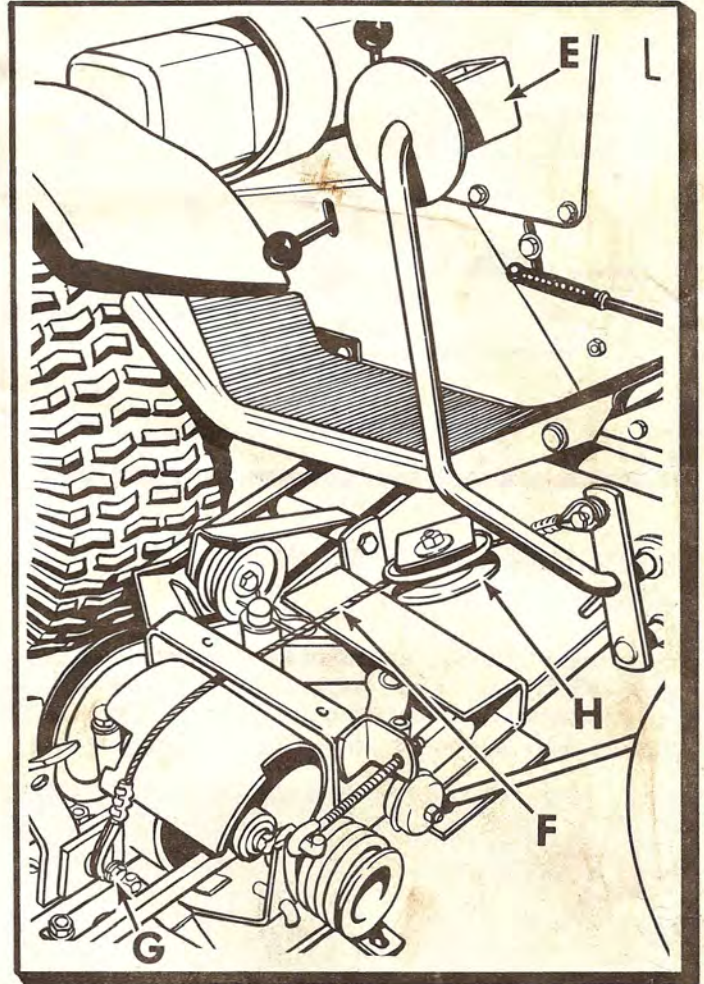

Fig. 11

## CONNECTION OF FOOT LIFT TO BASIC MOWER - FIG. 11

Pull foot lever (E) to rear of tractor and slip free end of braided wire (F) under housing stop guard assembly (removed for illustration) and loop over bolt (G). Be sure washer is between loop and end of bolt (Fig. 11). The distance of the foot pedal from the operator is controlled by slot in yoke of pulley (H). To adjust foot pedal nearer to operator, loosen nut on pulley (H) and move toward rear of slot. To adjust pedal farther from operator, move pulley to front of slot.

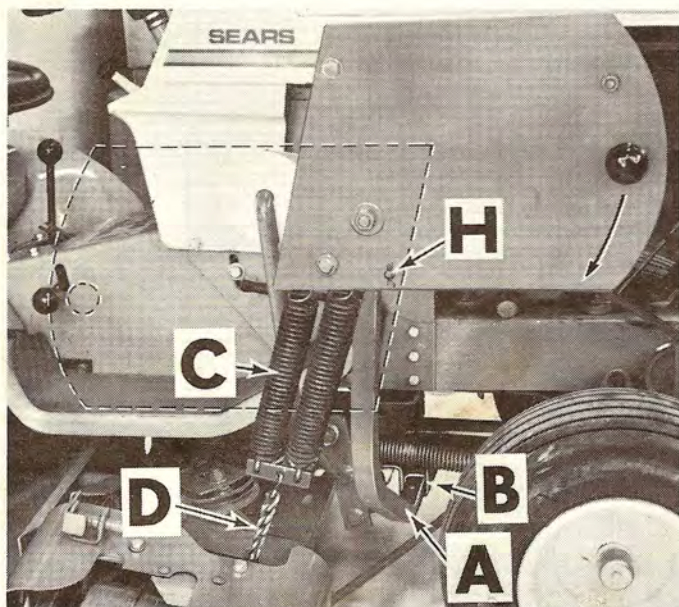

Fig. 12

## INSTALLATION OF CARRIER ARM

Insert end of carrier arm (A) into square pocket at (B). Remove safety clevis pin (H) and rotate carrier arm shield to position shown in Figure 12. Connect "S" hook of spring assembly (C) to fourth or fifth link in chain (D).

To apply tension to spring assembly (C), rotate shield 180 degrees to position shown by dotted line. Insert safety clevis pin and secure with hair cotter pin.

The inner shoe of the sickle should rest lightly on the ground allowing the inner shoe to "float" more easily over uneven terrain. For added clearance, drop additional links of chain to increase tension on lift spring (C).

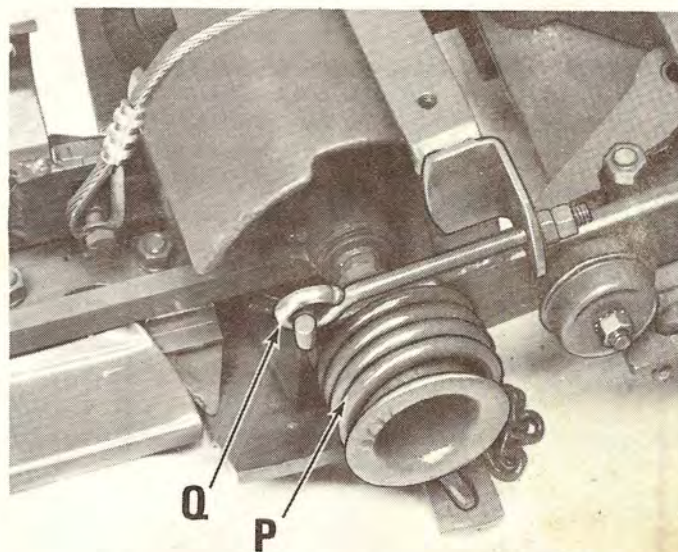

Fig. 13

## TORSION SPRING HOOK-UP - FIG. 13

The torsion spring (P) controls the weight on outer shoe of sickle bar. Raise sickle bar and slip eye bolt (Q) over spring end as shown.

To decrease weight on outer shoe, turn inside nut on eyebolt (Q) clockwise and lock in place with outside nut. To increase weight on outer shoe, turn outside nut counterclockwise and secure in place with inside nut.

**NOTE:** For adjustment of Small Gear Box V-Belt & Pitman Drive Belt see Page 13, Figures 19 & 20.



## CAUTION



Keep hands and feet away from the knives until the machine has come to a complete stop.

Always disengage the tractor attachment clutch before dismantling from the tractor. Before servicing machine, disengage power, shut off engine, and disconnect engine spark plug cable(s), remove key.

Do not allow anyone to walk alongside, in front of or behind the machine during operation.

Before mowing, check and remove sticks, stones or any other debris from area to be mowed. This will prevent possible mower damage as well as eliminate the possibility of blades picking up and throwing debris.

Always drive slowly over rough ground and on hillsides. Drive at speeds slow enough to insure your safety.

Always wear relatively tight and belted clothing when operating tractor. Loose jackets, shirt sleeves or other loose clothing should not be permitted because of the danger of catching them in moving parts or controls.

Refuel your tractor only when the engine has been shut off and cooled down. Never smoke while filling the fuel tank.

Never operate the tractor engine in a closed building.

Before leaving tractor seat, always disengage mower drive clutch and stop tractor.

# OPERATION

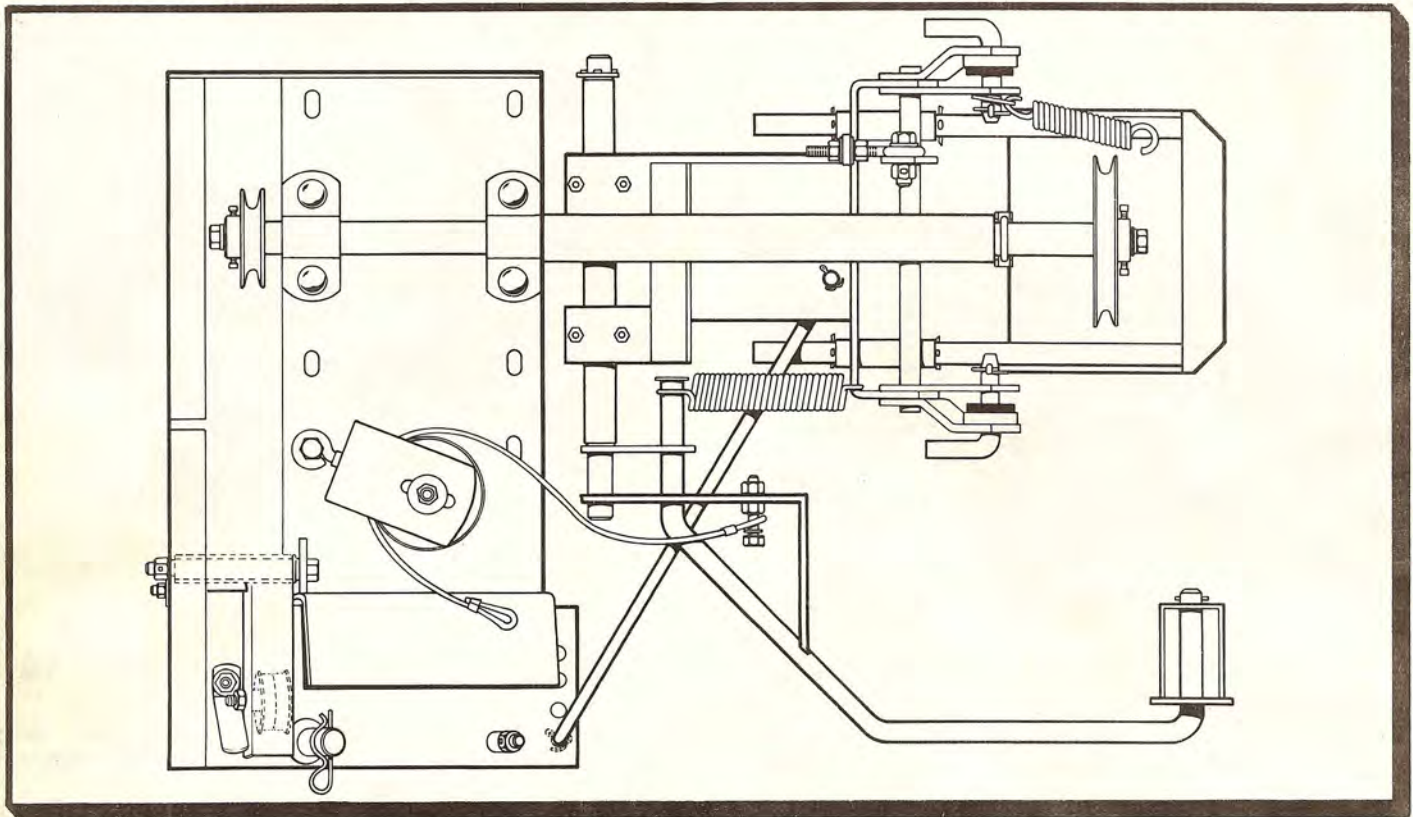

REFERENCE

## OPERATING THE MOWER:

### PRESTARTING INSPECTION:

1. Be sure mower has been properly assembled to tractor. Set-up instructions start on page 5.
2. Be sure mower is properly adjusted. See set up section.
3. Check condition of sickle sections. Keep them sharp.
4. Be sure sickle bar mower is lubricated. See "Lubrication" on page 16.

With tractor engine throttle set just above idle, engage tractor attachment clutch lever slowly. Advance throttle to  $\frac{3}{4}$  to full.

### METHOD OF MOWING:

Before mowing a new plot of grass, always stop to analyze the area for best mowing procedure. Consider also the height of grass to be mowed, type of terrain (level, hilly or pitted), as well as the presence of rocks or trash. Each condition will require certain adjustments or precautions, as outlined in the following pages.



### CAUTION



Before servicing machine, disengage sickle bar mower attachment clutch, set parking brake, stop engine, remove keys and disconnect engine spark plug cable(s).

Pick up all rocks, stones and other debris you can find before mowing in a new area. Enter the area cautiously.

Sickle bar mower can operate from 45 degree vertical to 45 degree below horizontal. It may be necessary to release some tension on the torsion spring to allow mower bar to drop to lowest angle. There should be a  $\frac{1}{32}$ " clearance between sickle sections and hold down clips. If several years of dead grass have accumulated in areas being cut, particularly on hills or slopes, it may be necessary to cut against the slope due to dead material leaning forward, thereby not allowing the sickle to cut cleanly.

Test pattern cutting will soon show you the most appropriate way to approach the task. Remember, the proper settings, a sharp sickle, correct forward speed, and good general maintenance will enable you to cut any reasonable patch of grass with satisfaction. Overlooking any one of the above points may detract from the machine's performance. A few points are listed below:

Exceptionally tall grass or weeds, uneven terrain, may require you to operate your tractor at a much slower speed than you would normally use. On the other hand, sparse weeds, etc., may enable you to operate at a higher rate of forward speed than would normally be used under ordinary cutting conditions.

Carrier arm shield in this position for operation. Rotate shield 180 degrees when detaching mower from tractor.

If torsion spring is loose, sickle bar will be hard to lift. If torsion spring is set too tight, outer end of sickle bar will have a tendency to bounce in operation.

Foot Lever

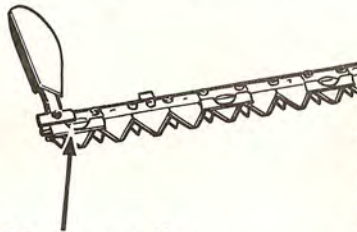

Hold down clips should have 1/32" clearance from sickle knife.

To increase tension on torsion spring, tighten bolt. Increased tension removes weight from outer shoe. Less tension adds weight to outer shoe.

Fig. 14

## TRANSPORTING MOWER FIG. 15

The operation of your Sears Sickle Bar Mower is controlled through the tractor attachment clutch lever. To start the sickle bar, push the clutch lever forward to the "In" position. To stop sickle bar mower, pull lever back to the "Out" position.

Stop tractor engine, place tractor attachment clutch lever in "Out" position, and set parking brake. Install sickle knife cover (A) using retaining strap (B) to secure cover to bar.

The sickle knife cover is provided to protect the operator and others from serious injury. It should be in place whenever the sickle bar is not in use or is being transported from one area to another.

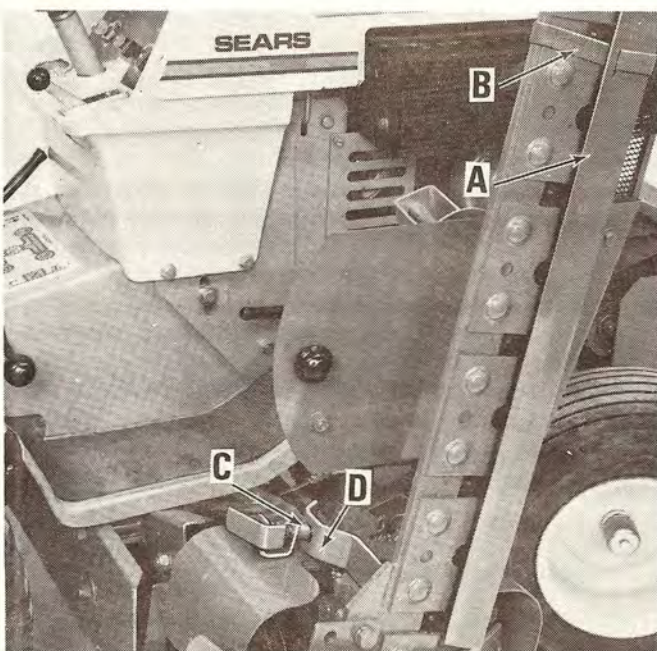

Fig. 15



**CAUTION**



Always stop tractor engine, declutch sickle bar, and set parking brake before dismounting from the tractor.

Raise mower bar until spring loaded pin (C) snaps into strap (D). Avoid sudden or sharp turns with mower in transport position.

# OPERATION

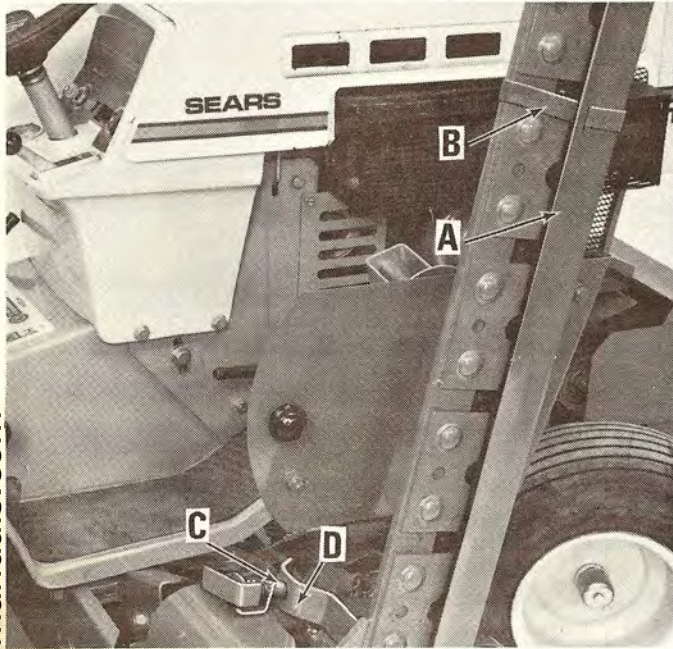

Fig. 16

## LOWERING SICKLE BAR MOWER FROM TRANSPORT POSITION TO MOWING POSITION FIG. 16

Stop tractor engine. Standing behind mower, push inward slightly on mower bar, slide transport pin (C) FIG. 16 out of strap and lower sickle bar to the ground. Loosen retaining strap (B) FIG. 16 and remove sickle knife cover. Always install sickle knife cover when mower is not in use or when transporting unit.

## WHEN CUTTING ON LEVEL GROUND

Before operation, check complete unit for any looseness which may have occurred in shipping. Unit should then be operated a short period to check for proper assembly and adjustments before actual cutting begins. Stop engine and recheck all parts after 30 minutes of operation. Also follow lubricating instructions under maintenance. Operate tractor at  $\frac{3}{4}$  to full throttle. It will be necessary to regulate tractor forward travel to meet existing cutting conditions, which can vary greatly, depending on material that is being cut. **RUN INNER SHOE APPROXIMATELY 4" AWAY FROM PREVIOUS SWATH EDGE FOR BEST PERFORMANCE.** Cutter bar has additional width of cut to compensate for overlay. Care must be exercised not to operate tractor at excessive ground speed when cutting rough terrain.

## AUTOMATIC BREAK-BACK - FIG. 17

The break-back automatically releases sickle bar into break-back position when hitting obstruction. The sickle mower unit should be immediately DE-CLUTCHED. Return sickle bar to normal cutting position, engaging break-back. This may be done by reversing tractor with sickle bar on ground, or manually. Unwarranted or frequent break-back releases indicate tension on the spring under cup (E) FIG. 17 should be increased. To disengage safety break-back manually, insert screw driver at (F) FIG. 17 and pry break-back pivot open; at same time push sickle bar back to release catch.

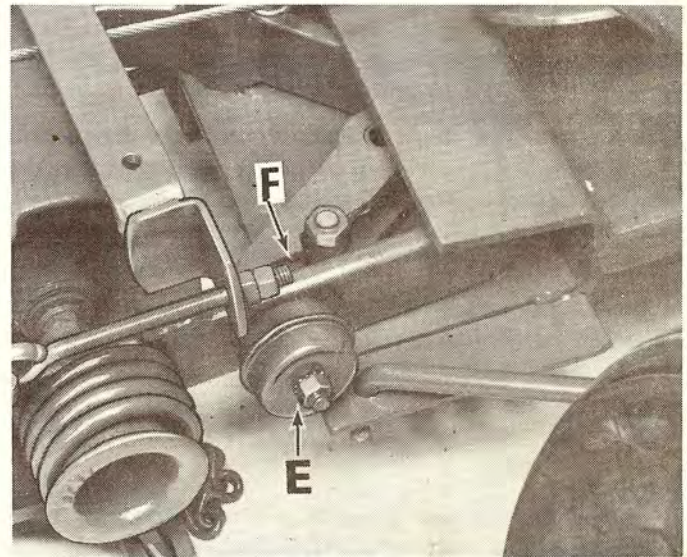

Fig. 17

## SICKLE BAR MOWER CLUTCHING V-BELT - FIG. 18

The sickle mower clutching V-belt (G) transmits power from the tractor engine to the sickle bar gearbox. The tractor attachment clutch lever (H) is connected to the gearbox by rod (J). With the attachment clutch lever engaged or in the "In" position, the inside distance between the belt above idler pulley (L) should be approximately 2-5/8" as shown in Figure 18

To increase tension on V-belt (G), remove hair pin from end of rod (J), disconnect rod from clutch attachment strap (K), and rotate the rod one complete revolution counterclockwise. Re-attach rod to tractor attachment clutch lever (H) and insert hair cotter pin. Repeat if necessary until there is a 2 5/8" distance as shown in Fig. 18

NOTE: It is important that the clutch rod (J) be reconnected as shown in Fig. 18.

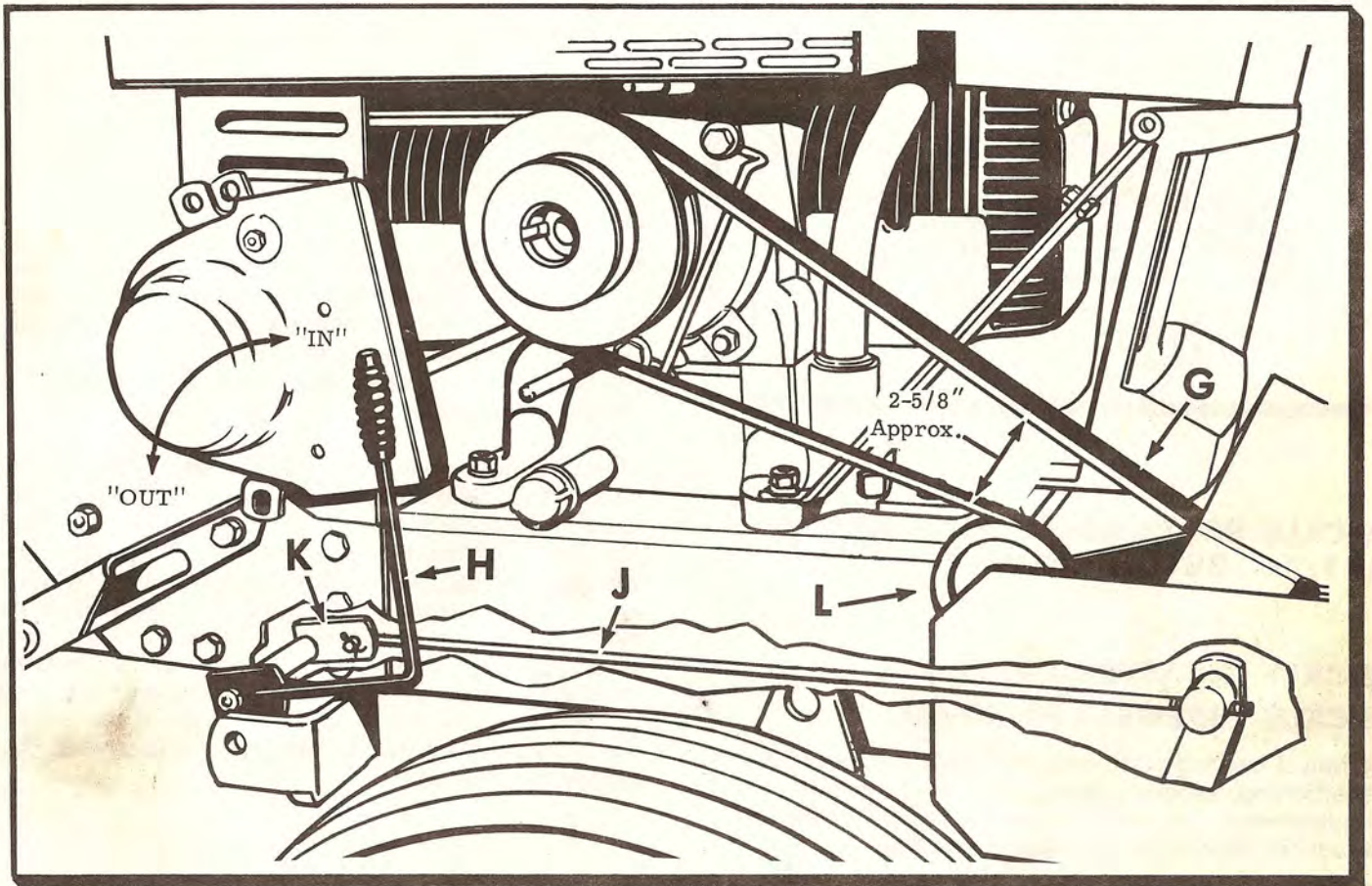

Fig. 18

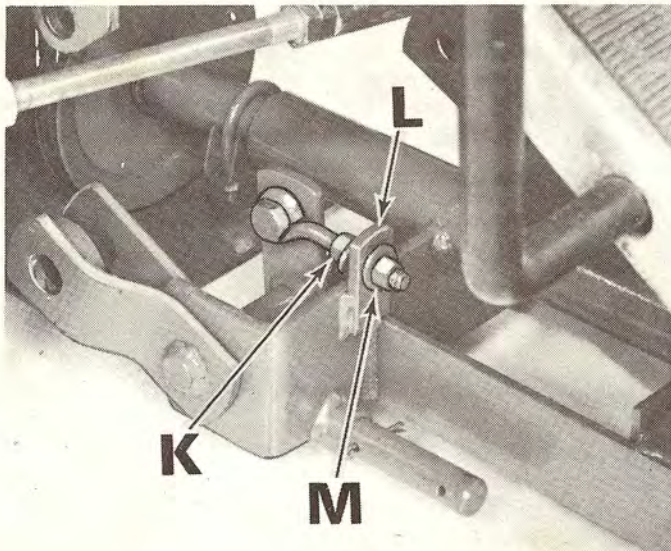

Fig. 19

### SMALL GEARBOX V-BELT FIG. 19

The small gearbox V-belt connects the gearbox output pulley to the front of sickle bar jackshaft. If belt slippage occurs, increase tension by backing nut (K) away from strap (L) and tightening nut (M) to hold strap in new position.

NOTE: The unit is shown unattached for clarity.

### ADJUSTMENT OF PITMAN DRIVE BELT (Fig. 20)

The pitman drive belt connects the rear jackshaft pulley to the basic mower assembly. If additional tension is needed on belt (O), loosen bolt (M) in mounting plate. Apply downward pressure on idler pulley (N) until excess slack in belt is taken up. Retighten bolt (M).

NOTE: Misalignment of pitman drive belt may be noticed; however, special grooved pulleys are designed to compensate for this misalignment.

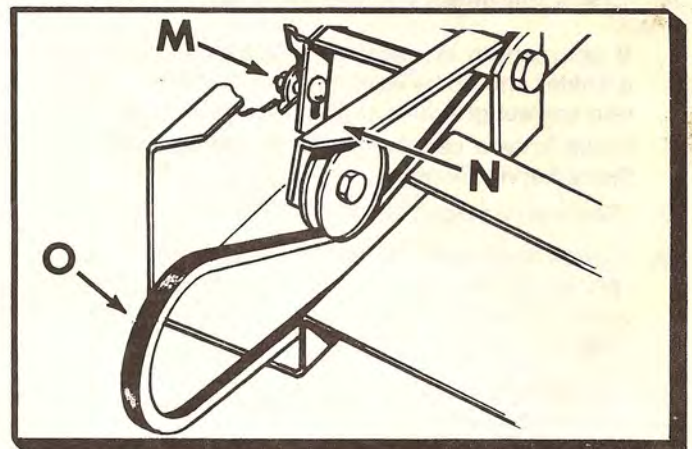

Fig. 20

# OPERATION

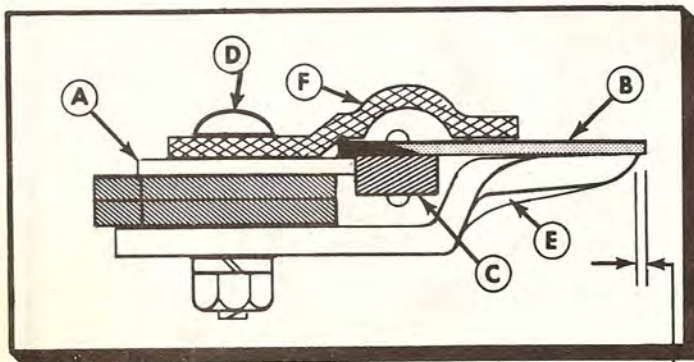

Fig. 21

**SICKLE SECTIONS TO PROTRUDE 1/32" TO 1/16" BEYOND GUARD**

## SICKLE CLEARANCE (FIG. 21)

### SICKLE ASSEMBLY REMOVAL

When it becomes necessary to remove the sickle for sharpening, section replacement or complete sickle replacement, remove the bolts holding the sickle head to bar and slide sickle out of guard assembly.

If the sickle fits too loosely, in most cases proper clearance can be obtained by tapping down or prying up the front end of the hold down clips (F).

Remove the sickle assembly. Reinsert sickle and adjust each hold down clip as it is reached by the sickle, so when sickle is fully inserted all hold down clips will have been adjusted.

The proper clearance to be maintained should not exceed 1/32". Fitting these clips too tightly will cause binding or scoring, excessive vibration and chatter. Lubricate freely.

## CUTTING FAILURE

A. Check sharpness of sickle sections.

1. If sharpening is necessary, a sickle grinder with a holder should be used for this operation to maintain correct grinding angle. (Same as original).

Sickle knives can be resharpened by your local Sears Service Store.

2. Replace damaged sickle sections.

B. Check fit of sickle sections to guards and wear plates. If the sickle sections are sharp, clean cutting is entirely dependent upon the following:

1. Alignment of guard surfaces.
2. Wear plate adjustment.
3. Straightness of cutter bar.

4. Pitch of guards.
5. Hold down clip clearance.
6. Proper lead setting of mower.
7. Improper speeds of sickle in relation to forward travel of tractor.

Be sure the sickle sections are sharp at all times and held close to the guards by the sickle clips. Be careful, however, of having them too tight as this will cause binding. Always lubricate well with oil at the point on the bar and guard assembly where the clips contact the sickle assembly.

Check the position of the forward ends of the sickle sections (B) to make sure that they protrude past the forward ends of the guards (E) FIG. 21 For cutting loose precut hay, dense, fine and loose under growths, etc.; without clogging, the sickle must contact the material ahead of any guard. 1/32" to 1/16" protrusion of the sickle beyond the guard is sufficient. If your "wear plates" (A) FIG. 21 are worn half-way through on the front edge, moving the wear plate forward will place the sickle in the proper position. If the wear plate is worn too much for making the proper adjustment, they should be replaced.

## ALIGNMENT OF CUTTING SURFACES

Remove the sickle assembly and check all guards for alignment of surfaces. The alignment may be checked by using a straight edge or drawing a string tightly across these surfaces. Any guard being too high will create excessive clearance between the guard and the sickle sections. Misalignment can be corrected by bending guards up or down, as required. Hammer only on solid portion of guard beyond the lip.

## WEAR PLATE ADJUSTMENT (Fig. 21)

The wear plates (A) support the back of the sickle sections (B) and guide the sickle bar in the guard recess. Wear plates have elongated holes for adjustment against the sickle bar (C) to prevent it from drifting forward and backward. Adjust by loosening the guard bolts (D) and sliding the wear plate forward against the sickle bar. Avoid a tight fit. Check the top surface of the wear plate with the guard surface (E). These two surfaces must be even.

## PROBLEM

## SOLUTION

1. Cutter bar outer shoe bounces or digs into ground surface.	Adjust torsion spring as indicated in Fig.13 , page 9 .
2. Inner shoe dragging on ground.	Raise inner shoe assembly by adjustment of life spring (Fig. 12, page 9 ). Make sure lift chain is properly assembled.
3. Mower does not cut cleanly, drags hay under sickle, cutting pattern shows blank or skipping points.	Adjust forward speed to coincide with sickle knife action. Check setting of hold-down clips (Page 14 ).
4. Bunching of cut material in front of inner shoe after adjustment of lift spring.	Inner shoe is being run too close to edge of previous swath. Allow approximately 4" overlap, on previous cut.
5. Failure to cut grass and weeds.	Check clearance between sickle knife and guards - fit should be snug, approximately 1/32". Tap metal hold-down clips with hammer to adjust. Sharpen sickle section if dull.

## SERVICE TIPS FOR SICKLE BAR MOWER OPERATION

Listed below are some of the tell-tale signs which will indicate when you are operating your tractor in too fast forward gear:

1. Jagged or uneven cutting indicates too fast a forward ground speed.
2. Plugging sickle assembly could be created by either excessive forward speed, improperly installed hold-down clips, or dull sickle knife.



## CAUTION



Never attempt to force the sickle bar mower to raise if the outer end of the bar is lodged or caught in foreign debris, dirt, or heavy underbrush. Give your tractor and equipment every possible opportunity to operate efficiently. Try to reverse tractor or move forward carefully until sickle bar is released from entanglement, or -- stop engine -- set parking brake, disengage attachment clutch lever, dismount from tractor and release mower bar from obstruction manually.

# MAINTENANCE

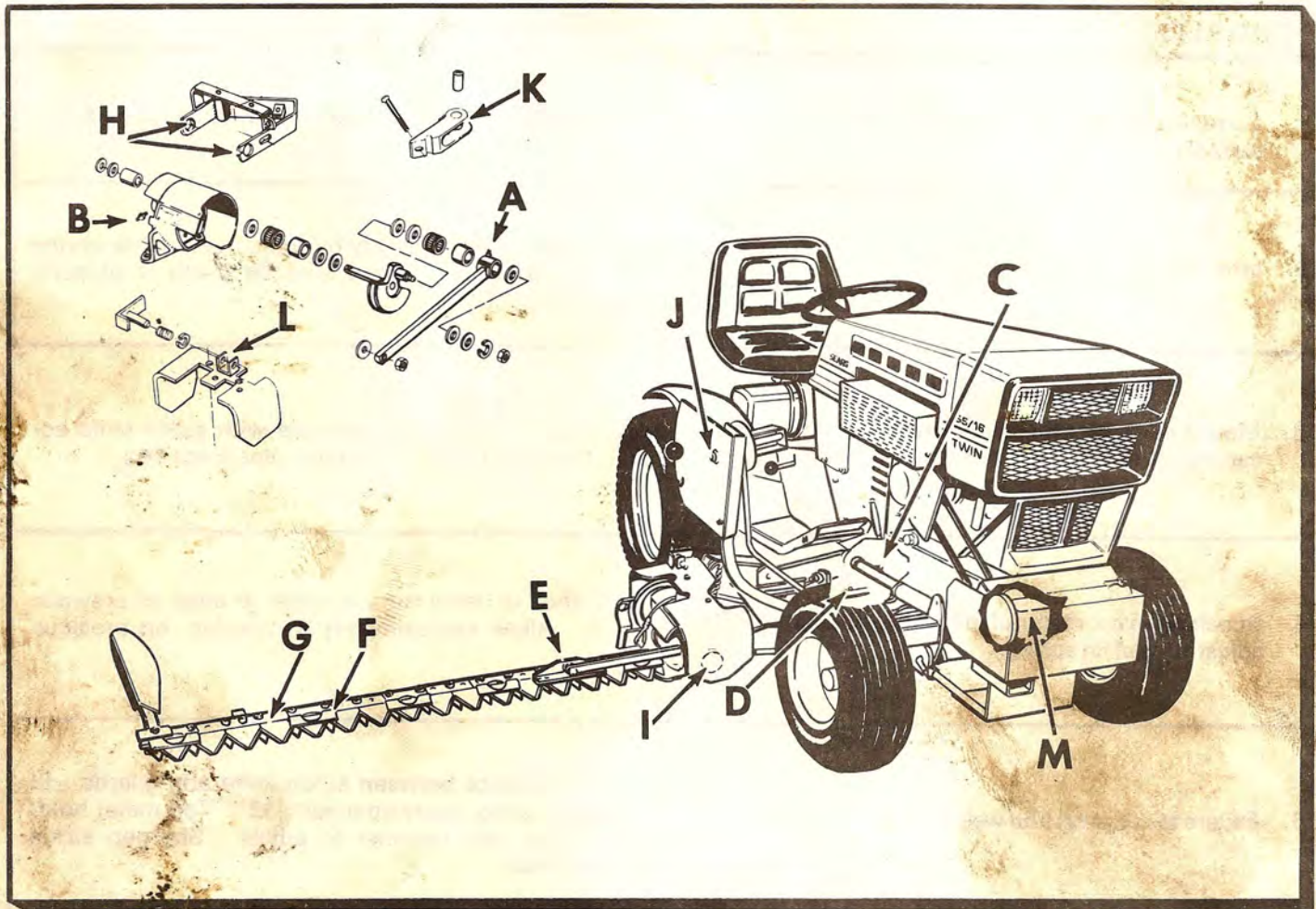

Fig. 22

## LUBRICATION FIG. 22

Before starting, it is important that the machine is thoroughly lubricated. Give each fitting a few shots of grease. Grease all points at one-hour intervals the first two days. Thereafter, entire unit should be greased at least once each four hours during continuous operation.

The following fittings require grease every four hours of machine operation:

- A. Pitman Crank Pin
- B. Crankshaft Assy.
- C. Jackshaft
- D. Foot Pedal Shaft

The following points require oil can lubrication as shown:

- Every two hours
- E. Pitman head
- F. Sickle Clips
- G. Wear Plates

Every eight hours

- H. Inner Shoe Pivots
- I. Torsional Life Spring
- J. Carrier Arm Shield Pivot
- K. Spring Release Pivot
- L. Quick Pin Assembly
- M. Gear Box: Each season remove plug from gear box and if necessary add enough all purpose grease to fill box.

## MAINTENANCE

Adjust belt tension as described under "V-belt Adjustments", page 12 and 13. Check V-belts for wear frequently. Replace worn belts when needed.

## CLEANING

For best results, the unit should have all dirt accumulations removed from sickle bar. Do not allow the machine to stand for long periods without cleaning. Inside storage will also prolong its operating life.

Before servicing machine, declutch attachment, stop engine, remove key, set parking brake, and disconnect engine spark plug cables.

# REPAIR PARTS LIST

**DO NOT ORDER REPAIR PARTS FROM ILLUSTRATIONS ONLY.**

**ALSO REFER TO THE DESCRIPTION OF THE PART.**

Always order repair parts by number and give the description of the part, where used, and whether it is a right or left hand part, model and serial numbers are also important.

We reserve the right to change specifications on design at any time without incurring the obligation to install such changes on machines previously manufactured.

## **DIRECTIONS FOR ORDERING PARTS:**

Select any parts needed from exploded view illustration. Obtain correct part number and part name from parts list. **DO NOT USE THE REFERENCE LETTER OR NUMBER WHEN ORDERING PARTS.**

Always order parts by part number. When ordering parts, be sure to include the following information:

1. Part number and part name shown on parts list
2. Quantity desired
3. The model number
4. Order parts from:                      Nearest SEARS Store

### **DESCRIPTION**

### **INDEX TO UNITS**

### **PAGE NO.**

Mounting Frame.....	18-19
Gearbox Assembly.....	20-21
Basic Sickle Bar.....	22-23

E 235

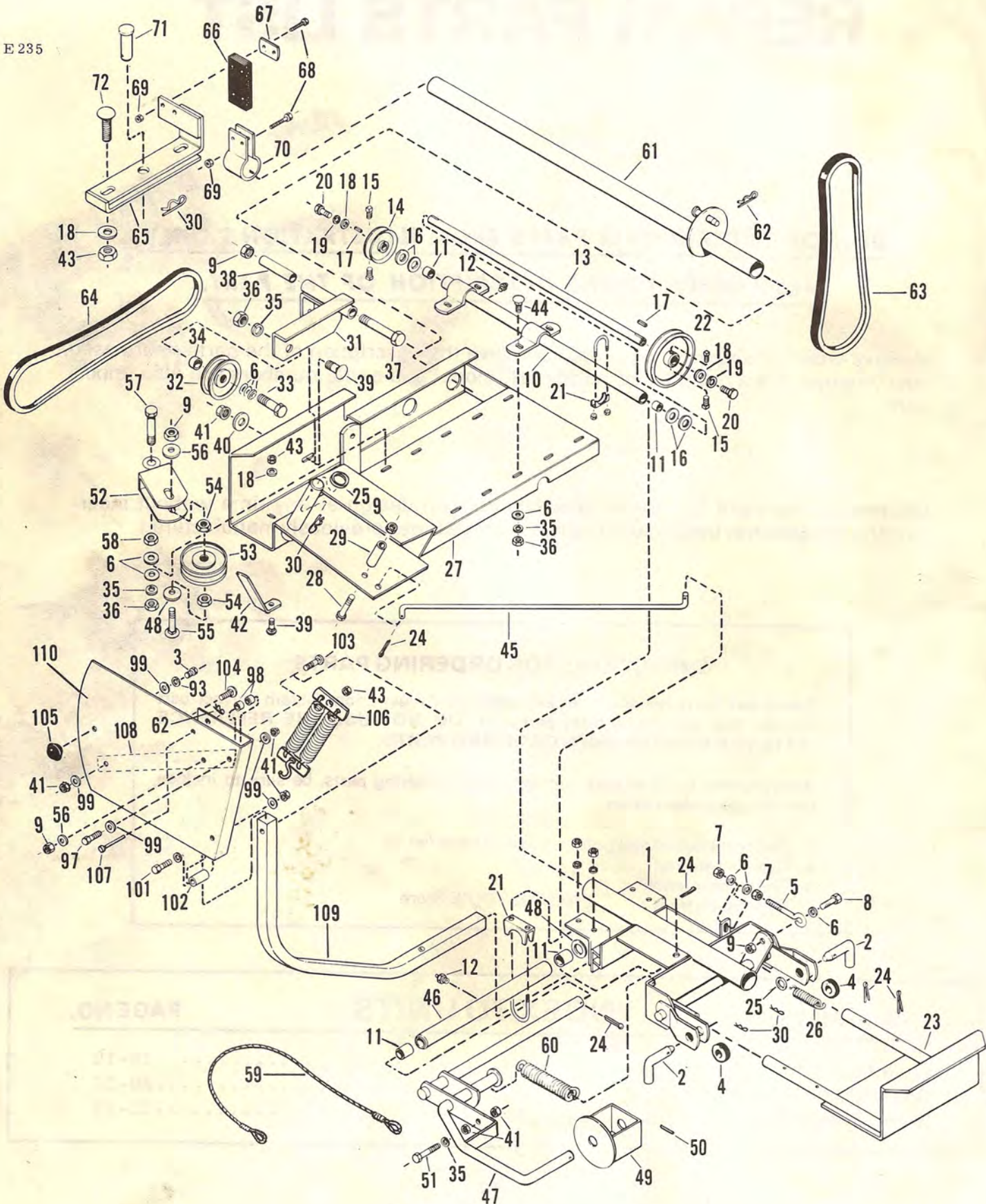

another free manual from [www.searstractormanuals.com](http://www.searstractormanuals.com)

Ref. No.	Part No.	Description	No. Req.	Ref. No.	Part No.	Description	No. Req.
1	9401	Assy - Main Frame	1	45	9439	Rod - Stabilizer	1
2	9415	Pin - Locating	2	46	9459	Assy - J'Shaft Housing & Bushings	1
3	*GM180077	Bolt - 5/16-18 x 3/4 Hex Head	1	47	9461	Assy - Bracket Lift Arm	1
4	4363	Washer - Rubber	2	48	GM456151	Washer - 3/4 Flat (13/16 x 1-1/2)	2
5	3058	Eye Bolt	1	49	9607	Pedal - Lift	1
6	*GM120396	Washer - 1/2 Flat (17/32 x 1-1/16)	10	50	*GM455481	Pin	1
7	*GM120377	Nut - 3/8-16 Lt. Hex.	2	51	GM180128	Bolt - 3/8-16 x 1-3/4 Hex Head	1
8	*GM180175	Bolt - 1/2-13 x 1-1/4 Hex Head	1	52	9467	Assy - Clevis Bracket	1
9	*GM9414074	Nut - 1/2-13 Hex Lock	5	53	3631	Assy - Pulley & Bearing	1
10	9417	Assy - J'Shaft Housing	1	54	*GM124847	Nut - 5/8-11 Half Hex.	2
11	3034	Bushing	4	55	*GM126509	Bolt - 1/2-13 x 2-1/4 Carr.	1
12	5074	Fitting - Grease	1	56	*GM120390	Washer - 1/2 Flat (9/16 x 1-3/8)	2
13	9420	Jackshaft	1	57	*GM180183	Bolt - 1/2-13 x 2-1/4 Hex Head	1
14	3970	Assy - Pulley & Hub (Hub out)	1	58	*GM120238	Nut - 1/2-13 Lt. Half Hex	1
15	*GM142671	Screw - Set (5/16-18 x 1/2 Sq. Head)	4	59	9470	Wire Rope Assy.	1
16	3396	Washer - 3/4 Flat (49/64 x 1-1/2)	3	60	3434	Spring	1
17	3259	Key	2	61	9436	Assy - Pipe Pivot	1
18	*GM120388	Washer - 3/8 Flat (7/16 x 1)	5	62	3090	Pin - Hair Cotter	2
19	*GM120382	Washer - 3/8 Med. Lock	2	63	9526	V-Belt - Short	1
20	GM180122	Bolt - 3/8-16 x 1 Hx. Hd.	2	64	9527	V-Belt - Long	1
21	5339	U-Clamp Assembly - Nuts	3	65	9499	Assy - Drawbar Hitch	1
22	3035	Assy - Pulley & Hub (Hub out)	1	66	3977	Absorber - Shock	1
23	9421	Assy - Pulley Guard	1	67	3978	Clamp	1
24	*GM120123	Pin - Cotter (1/8 x 1-1/4)	7	68	*GM180024	Bolt - 1/4-20 x 1-1/4 Hex Head	4
25	4143	Washer - 1-1/64 x 1-1/2 x 1/8 Flat	2	69	4119	Nut - 1/4-20 Hex Lock	4
26	4798	Spring	1	70	3976	Clamp	1
27	9424	Assy - Plate Pivot	1	71	3980	Pin	1
28	*GM180188	Bolt - 1/2-13 x 2-3/4 Hex Head	1	72	*GM126402	Bolt - 3/8-16 x 1-1/4 Carriage	2
29	3554	Spacer	1	93	*GM120214	Washer - 5/16 Med. Lock	1
30	3341	Pin - Hair Cotter	4	97	*GM180134	Bolt - 3/8-16 x 2-1/2 Hex Head	1
31	9432	Assy - Idler Bracket	1	98	3346	Spacer	2
32	3042	Assy - Idler Pulley	1	99	*GM446363	Washer - 5/16 Flat (3/8 x 7/8)	6
33	*GM180181	Bolt - 1/2-13 x 2 Hx. Hd.	1	101	*GM180130	Bolt - 3/8-16 x 2 Hx. Hd.	1
34	3346	Spacer	1	102	S-325	Spacer	1
35	*GM120384	Washer - 1/2 Med. Lock	7	103	*GM126504	Bolt - 1/2-13 x 2 Carr.	1
36	GM120378	Nut - 1/2-13 Lt. Hex.	6	104	*GM126227	Bolt - 3/8-16 x 3/4 Carr.	1
37	GM445608	Bolt - 1/2-13 x 5-1/2 Hex Head	1	105	3068	Knob	1
38	9430	Spacer	1	106	9656	Spring	1
39	GM120915	Bolt - 3/8-16 x 1 Carr.	2	107	4001	Pin - Clevis	1
40	4506	Washer - 13/32 Flat (13/32 x 1-1/2)	1	108	9519	Strap - Reinforcement	1
41	*GM271190	Nut & L'Washer Assy - 3/8-16 Hex	6	109	9517	Bar - Carrier	1
42	9138	Bracket	1	110	9518	Shield - Carrier	1
43	*GM9413534	Nut - 3/8-16 Hex. Lock	4		10147	Owner's Manual	1
44	GM126485	Bolt - 1/2-13 x 1-1/4 Carr	4				

\* Purchase from local source.

(Serial # 84101 &amp; up - )

E 237

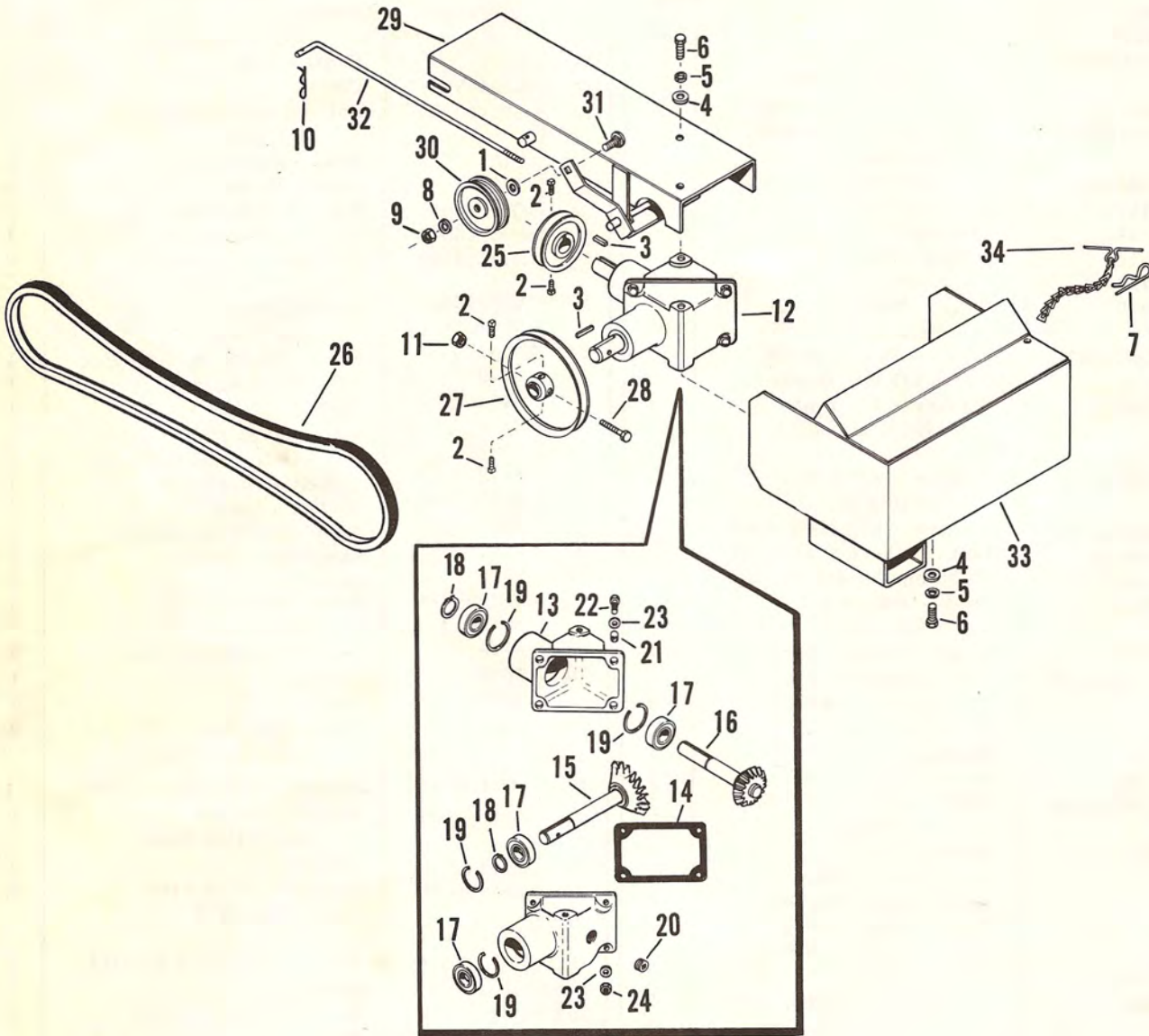

another free manual from [www.searstractormaterials.com](http://www.searstractormaterials.com)

Ref. No.	Part No.	Description	No. Req.	Ref. No.	Part No.	Description	No. Req.
1	*GM120396	Washer - 1/2 Flat (17/32 x 1-1/16)	1	19	4610	Ring - Snap	4
2	*GM142671	Screw - Set (5/16-18 x 1/2 Square Head)	4	20	7091	Plug - Pipe	2
3	3259	Key	2	21	4606	Bushing	4
4	*GM120388	Washer - 3/8 Flat (7/16x1)	4	22	*GM180081	Bolt - 5/16-18 x 1-1/4 Hex Head	4
5	*GM120382	Washer - 3/8 Med. Lock	4	23	*GM120386	Washer - 1/4 Flat (5/16 x 3/4)	8
6	*GM180122	Bolt - 3/8-16 x 1 Hex. Hd.	4	24	*GM271184	Nut & L'Washer Assy - 5/16-18 Hex.	4
7	3341	Pin - Hair Cotter	1	25	4469	Assy - Pulley & Hub	1
8	*GM120384	Washer - 1/2 Med. Lock	1	26	4352	V-Belt - Medium	1
9	*GM120378	Nut - 1/2-13 Lt. Hex	1	27	4638	Assy - Pulley & Hub	1
10	3090	Pin - Hair Cotter	1	28	*GM180042	Bolt - 1/4-20 x 1-3/4 Hex Head	1
11	4119	Nut - 1/4-20 Hex. Lock	1	29	9444	Assy - Gearbox Mtg.	1
12	4612	Assy - Gearbox	1	30	3042	Assy - Idler Pulley	1
13	4607	Gearbox - Right Angle	2	31	*GM120917	Bolt - 1/2-13 x 1-1/2 Carr.	1
14	4608	Gasket - Gearbox	1	32	9443	Rod - PTO	1
15	4586	Assy - Shaft & Gear	1	33	9447	Assy - Gearbox Cover	1
16	4587	Assy - Shaft & Pinion	1	34	5737	Assy - Chain & Toggle	1
17	4611	Bearing	4				
18	4609	Ring - Snap	2				

\*Purchase from local source

(Serial #84101 &amp; up - )

another free manual from www.searstractormanuals.com

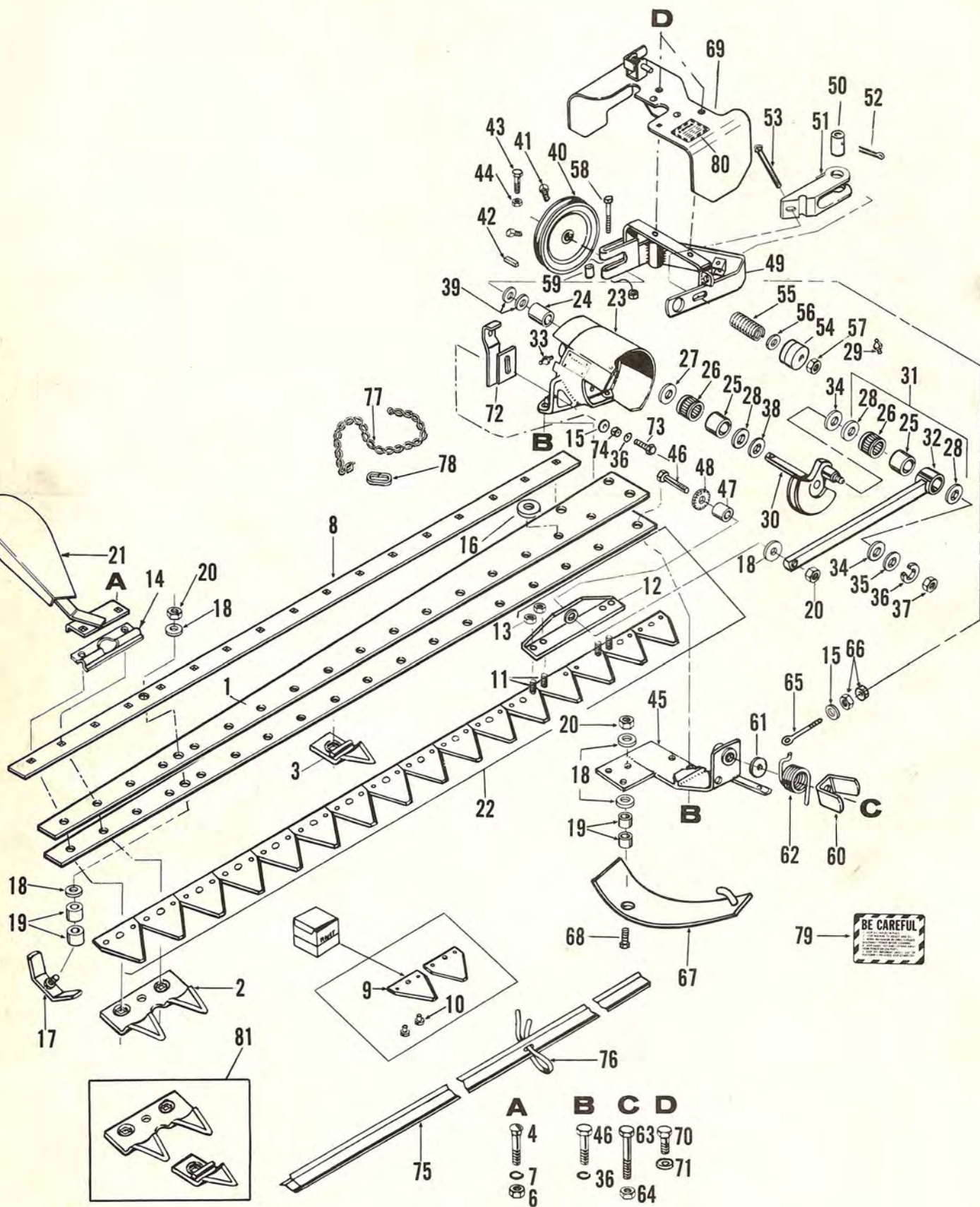

E258(6/22/74)

SICKLE BAR MOWER - MODEL NO. 842.26002

Ref. No.	Part No.	Description	No. Req.	Ref. No.	Part No.	Description	No. Req.
1	9614	Assy - Sickle Bar	2	42	3259	Key	1
2	6732	Finger - Shear	8	43	*GM180042	Bolt - 1/4-20 x 1-3/4Hx. Hd.	1
3	9654	Assy - Shear Finger	1	44	4119	Nut - 1/4-20 Hex. Lock	1
4	*GM126452	Bolt - 7/16-14 x 1-1/2Carr.	17	45	9474	Assy - Sickle Mtg. Bracket	1
6	*GM271501	Nut - 7/16-14 Lt. Hex	17	46	*GM180179	Bolt - 1/2-13 x 1-3/4Hx. Hd.	4
7	*GM120383	Washer - 7/16 Med. Lock	15	47	1094	Spacer	1
8	8996	Plate - Wear	1	48	*GM138549	Washer - 1/2 Shakeproof Lock	1
9	8030	Knife Kit - Box of 25	1	49	9482	Assy - Breakaway Bracket	1
10	8163	Box of Rivets	1	50	9489	Spacer	1
11	8904	Bolt	4	51	3562	Latch	1
12	8916	Assy - Knife Head	1	52	*GM120123	Pin - Cotter (1/8 x 1-1/4)	1
13	8928	Nut	4	53	8133	Bolt	1
14	3598-A	Clip - Knife	5	54	9394	Cap Plug	1
15	*GM120388	Washer - 3/8 Flat(7/16 x 1)	11	55	9396	Spring - Breakaway	1
16	*GM120389	Washer - 7/16 Flat (1/2 x 1-1/4)	1	56	4506	Washer - 13/32 Flat (13/32 x 1-1/2)	1
17	5571	Assy - Outer Shoe	1	57	*GM9413534	Nut - 3/8-16 Hex. Lock	1
18	*GM120396	Washer - 1/2 Flat (17/32 x 1-1/16)	5	58	*GM180192	Bolt - 1/2-13 x 3-1/2Hx. Hd.	1
19	3346	Spacer	6	59	3825	Spacer	1
20	*GM9414074	Nut - 1/2-13 Hex. Lock	4	60	4645	Retainer	1
21	4648	Assy - Grass Divider Board	1	61	9504	Spacer	1
22	8913	Sickle Knife Repair Kit	1	62	4655	Spring - Torsion	1
23	4707	Assy - Flywheel Housing	1	63	*GM271724	Bolt - 5/8-11 x 2-1/4Hx. Hd.	1
24	3034	Bushing	1	64	*GM124847	Nut - 5/8-11 Half Hex.	1
25	4683	Race - Bearing	2	65	3955	Eye Bolt	1
26	4684	Bearing - Roller	2	66	*GM120377	Nut - 5/16-18 Lt. Hex	2
27	4653	Washer - 15/16 x 1-5/16	1	67	9509	Assy - Inner Skid Shoe	1
28	4656	Seal - Bearing Oil	3	68	*GM180190	Bolt - 1/2-13 x 3 Hex Hd.	1
29	4123	Fitting - Grease	1	69	7820	Assy - Housing Stop & Quick Pin	1
30	4641	Assy - Crankshaft	1	70	*GM180120	Bolt - 3/8-16 x 3/4 Hex Hd.	2
31	4685	Assy - Pitman & Bearings	1	71	*GM120382	Washer - 3/8 Med. Lock	2
32	4629	Assy - Pitman	1	72	9496	Assy - Vertical Position Stop	1
33	5074	Fitting - Grease	1	73	*GM180128	Bolt - 3/8-16 x 1-3/4 Hex	1
34	4654	Washer - 15/16 x 1-1/2	2	74	*GM271190	Nut & Lock Washer Assy - 3/8-16 Hex.	1
35	*GM120390	Washer - 1/2 Flat (9/16 x 1-3/8)	1	75	4690	Guard - Sickle	1
36	*GM120384	Washer - 1/2 Med. Lock	5	76	4686	Assy - Guard Strap	1
37	*GM124934	Nut - 1/2-20 Half Hex.	1	77	9495	Chain - Transport	1
38	4719	Washer - 15/16 x 2	1	78	3436	Anchor - Chain	1
39	3396	Washer - 3/4 Flat (49/64 x 1-1/2)	AR	79	S-820	Decal - Caution	1
40	4638	Assy - Pulley & Hub (Hub Out)	1	80	6625	Decal - Caution	1
41	*GM142671	Screw - Set 5/16-18 x 1/2 Sq. Hd.	2	81	9281	Shear Finger Kit (8 dbl. 1 snl)	1

E259(6/22/740

(Serial #84, 550 & up- )

\*Purchase from local source

another free manual from www.seartractormaterials.com

Sears

owners  
manual

The Model Number is located on the pivot stabilizer anchor strap of the sickle bar mowers main frame.

All parts listed herein may be ordered from any SEARS, ROEBUCK and Co. or SIMPSON-SEARS LIMITED retail catalog store.

WHEN ORDERING REPAIR PARTS, ALWAYS GIVE THE FOLLOWING INFORMATION.

1. The PART NUMBER
2. The PART DESCRIPTION
3. The MODEL NUMBER  
842.26002
4. The NAME OF ITEM—  
SICKLE BAR MOWER

If the parts you need are not stocked locally, your order will be electronically transmitted to a Sears Repair Parts Distribution Center for "expedited handling."



When you buy merchandise from Sears you get an extra something that nobody else can offer . . . Sears Service .