

Sears

owners manual

# BULLDOZER-SNOWPLOW

FOR CUSTOM TRACTOR

MODEL NO.  
917.250550

**CAUTION:**  
Read Rules for  
Safe Operation  
and Instructions  
Carefully

- Assembly
- Operating
- Maintenance
- Repair Parts



SEARS, ROEBUCK AND CO. U.S.A.  
SIMPSONS-SEARS LIMITED, CANADA

Printed in U.S.A.

## INTRODUCTION

The Bulldozer-Snow Plow was especially designed for Sears Custom tractors. The principal use of this unit is to remove snow from sidewalks, cemented feeding lots, roads and driveways. It may also be used to level loose ground, gravel, sand etc.

Your Bulldozer-Snow Plow was shipped complete in one carton, Model Number 917.250550.

## PARTS IDENTIFICATION

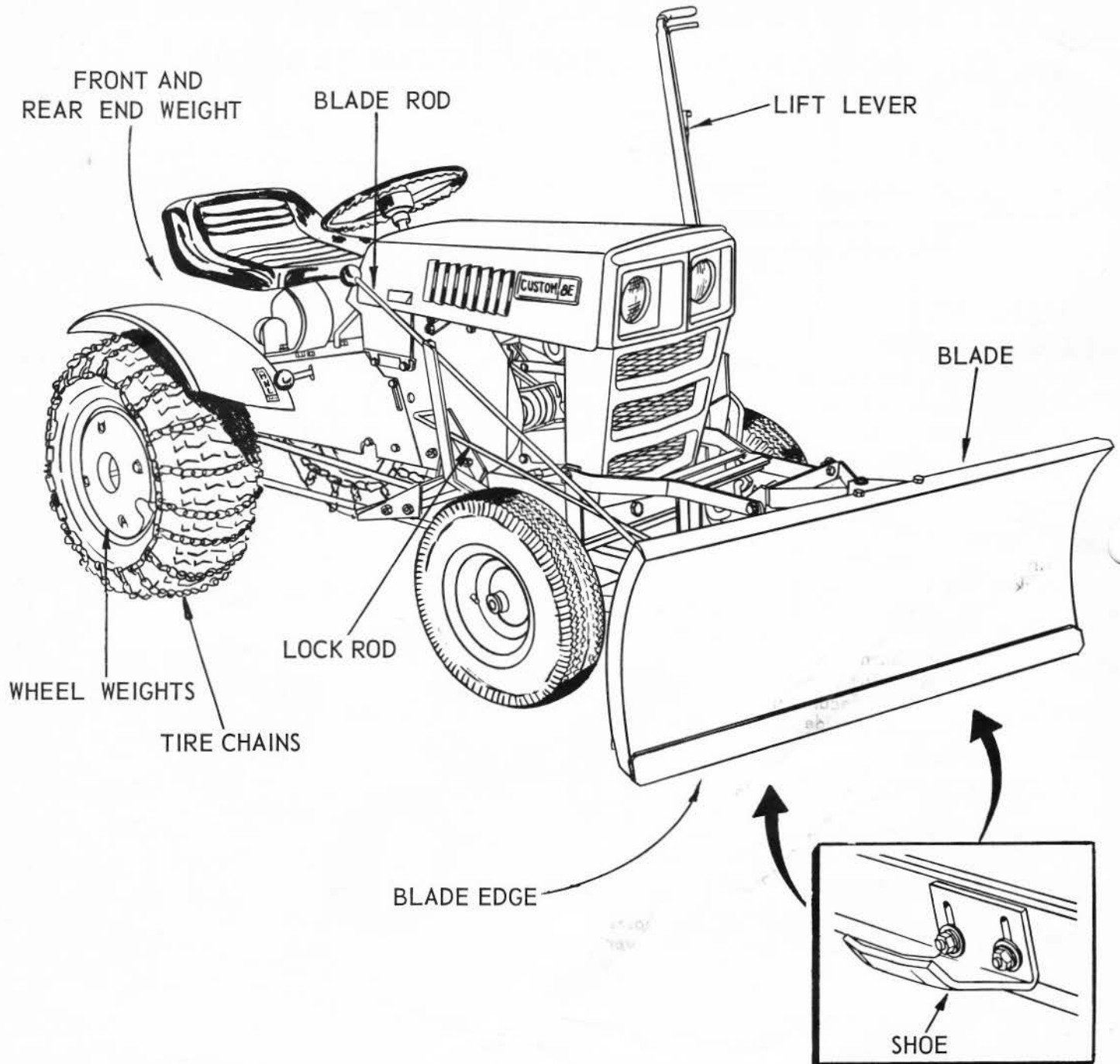

Setting up and operating Instructions should be studied very closely before beginning to assemble your Bulldozer-Snow Plow. When R.H. (Right Hand) and L.H. (Left Hand) are used, it should be understood to mean from a position behind and facing the Bulldozer-Snow Plow (or direction of travel).

A letter in the following instructions refers to an arrow in the adjoining Figure (Illustration), except when otherwise stated.

Wheel weights, and tire chains added to rear wheels will greatly improve the performance of the Bulldozer-Snow Plow.

# SETTING UP INSTRUCTIONS

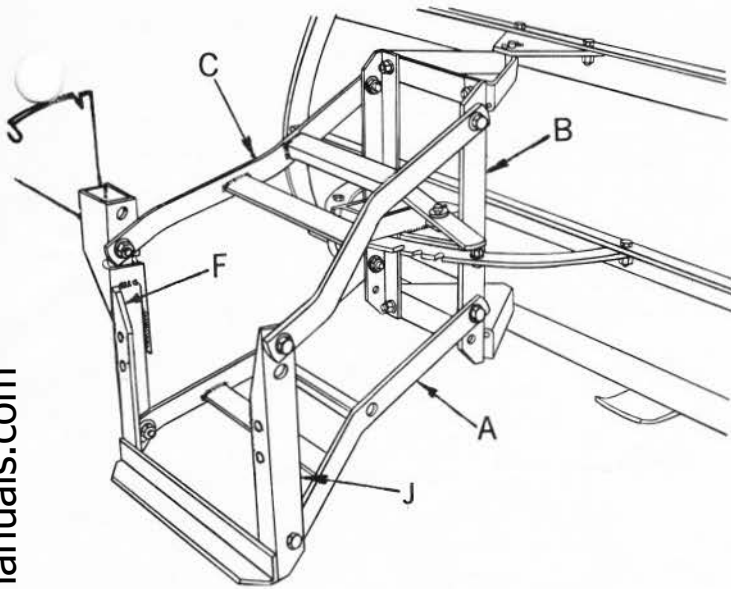

FIG. 1

1. Remove blade from carton and cut all wires, layout parts for assembly.
2. Refer to Figure 1. Assemble lower lift frame (A) to lower holes in mounting angles (F & J) as shown with two 7/16 x 1-1/4 hex bolts through mounting angles (F & J) then through lower lift frame (A). Slip bushing over bolt and into lower lift frame (A), add flat washer, and secure with lock nut. NOTE: Head of bolt to outside, and lift frame (A) is inside mounting angles (F & J).
3. Slip flat washer then bushing on bolt and insert bolt through upper lift frame (C) and into mounting angles (F & J). Secure with lock nut. Note: lift frame (C) is outside of mounting angles (F & J). See Figure 1.
4. Refer to Figure 1. Assemble lower lift frame (A) to second hole from bottom of front frame (B) as shown. Slip washer on bolt then bushing and insert through lower lift frame (A) and into front frame (B). Secure with locknut.
5. Assemble upper lift frame (C) to upper holes in front frame (B) in same manner as lower lift frame was assembled to front frame. Tighten all nuts securely.

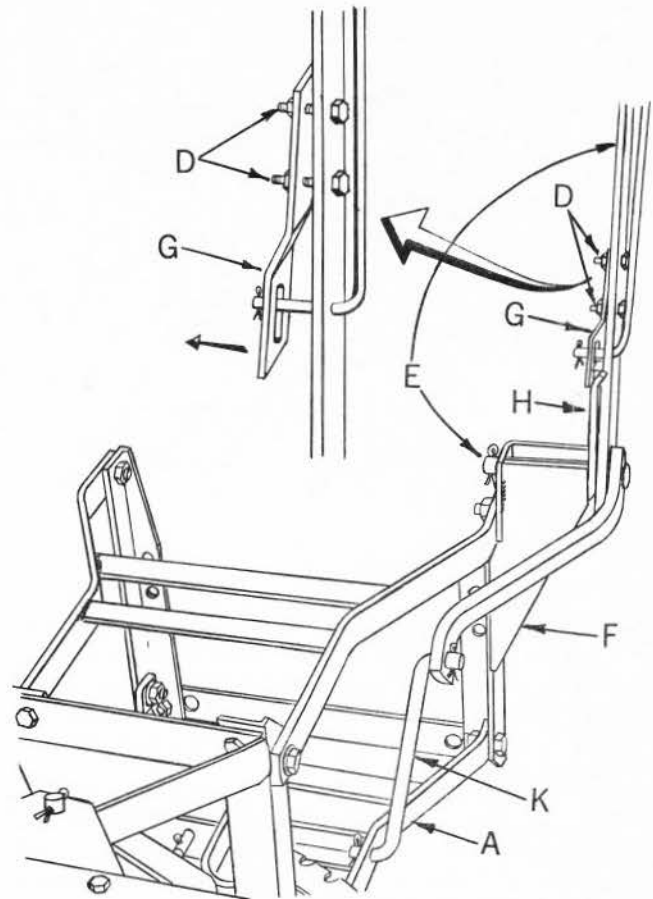

FIG. 2

6. Refer to Figure 2. Loosen two nuts (D) in lever and lever clip lower. Slide shaft of lever and arm assembly (E) into socket of mounting angle and quadrant assembly L.H. (F) and secure with 5/32 x 1 cotter pin found in plastic bag. NOTE: Be sure lever clip (G) straddles lever quadrant (H) as shown and retighten two nuts (D) securely.
7. Assemble lower end of lift rod (K) to lower lift frame (A) and secure with 5/32 x 1 cotter pin found in plastic bag. See Figure 2.

## SETTING UP INSTRUCTIONS – CONTINUED

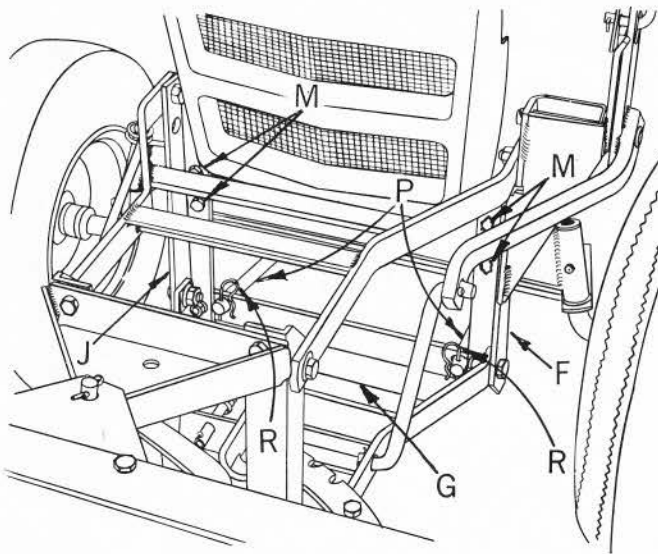

FIG. 3

8. Refer to Figure 3. Assemble mounting angle and quadrant assembly (F) and mounting angle R.H. (J) to rocker bar (L) as shown with four  $3/8 \times 1-1/4$  hex bolts, and gripco nuts (M) found in plastic bag. Leave bolts loose until push rods are installed.
9. Refer to Figure 3. Insert round ends of push rods (P) into holes in mounting angle brace (G) and secure with retainer springs (R). Retainer springs found in plastic bag.

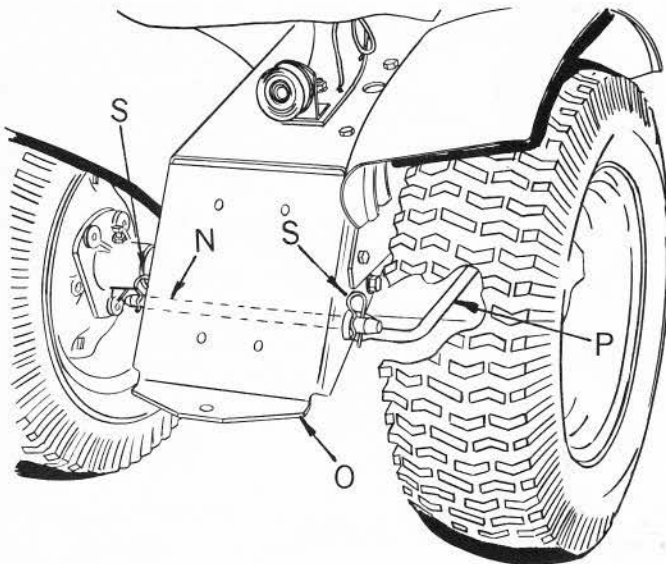

FIG. 4

10. Refer to Figure 4. Slip lower link pin (N), through holes in sides of tractor drawbar (O) as shown. NOTE: Insert and spread  $3/16 \times 1$  cotter pins in lower link pin (N) under and between sides of drawbar (O).

11. Refer to Figure 4. Slip rear of each push rod (P) over ends of lower links pin (N) as shown and secure with retainer springs (S), found in plastic bag.  
Tighten four bolts (M) in rocker bar and mounting angles. Refer to Figure 3.

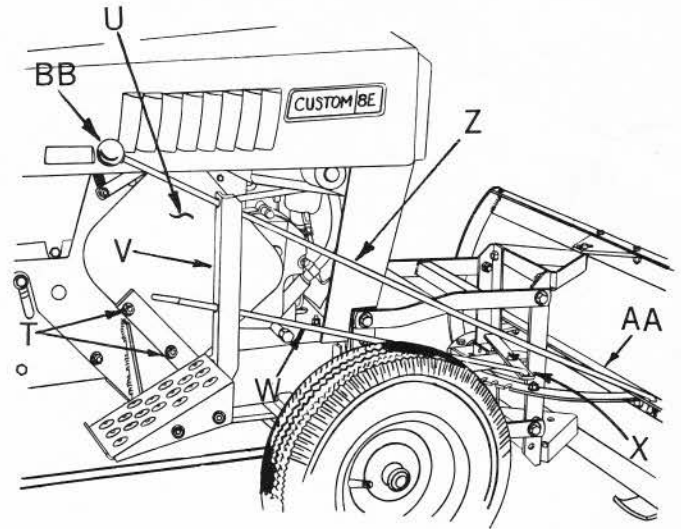

FIG. 5

12. Refer to Figure 5. Remove two bolts (T) from belt guard (U) and tractor, and assemble rod support and bracket (V) to belt guard (U) and tractor with two bolts (T) removed above. Tighten nuts securely.
13. Refer to Figure 5. Insert lock rod (W) into lower hole of rod support (V) with short bent end forward. Hook short bent end of lock rod (W) into hole of pivot arm weldment (X), and secure with  $1/8 \times 3/4$  cotter pin found in plastic bag. Spread cotter pin.
14. Refer to Figure 5. Insert blade rod (Z) (short bent end forward) through upper hole in rod support (V), and attach short bent end of rod in hole of center rail (AA) of blade and secure with  $1/8 \times 3/4$  cotter pin found in plastic bag. Spread cotter pin.
15. Refer to Figure 5. Screw knob (BB) found in plastic bag on rear (threaded) end of blade rod (Z) as shown.

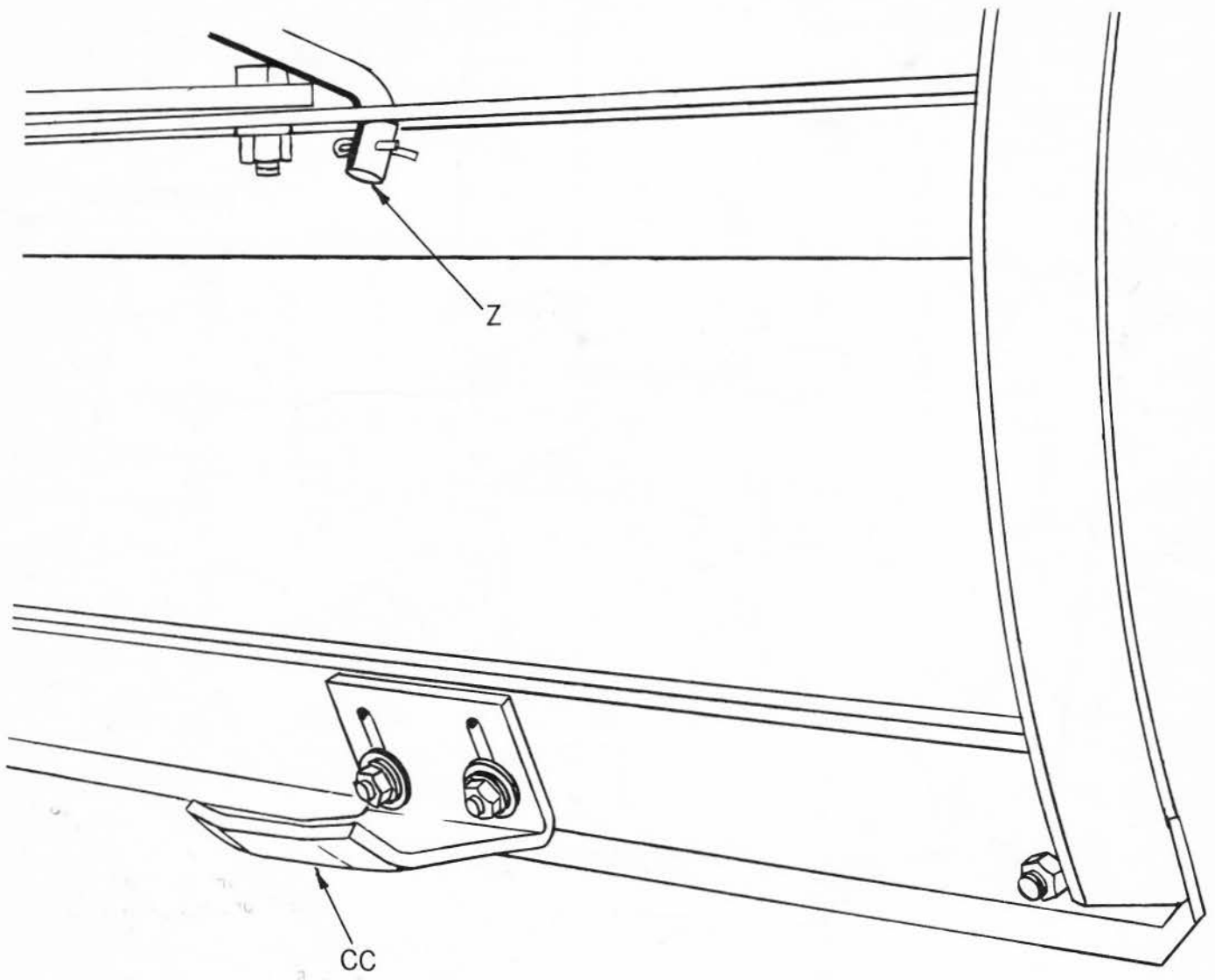

FIG. 6

To angle the bulldozer blade, push lock rod (W), Fig. 5 forward with foot which releases the latch and push or pull blade rod (Z), Fig 5, desired to blade position. Remove foot from lock rod to lock blade in proper position. There are seven blade positions: Straight across, three distinct angles to right, and three to the left.

### BLADE SHOES

The blade shoes (CC), Fig 6 are adjustable for raising or lowering blade edge. When moving material on rough or uneven surfaces, lower blade shoes thus raising the blade edge. After adjustment, always tighten nuts securely.

### MAINTENANCE AND SERVICE

During the operating season check all bolts and nuts and keep them tight. When Bulldozer-Snowplow is not being used, the blade should be coated with grease or rust preventative. Oil latch assembly and arch frequently to aid in swiveling. Also, oil pivot points of frame. This units life expectancy is practically indefinite if handled properly. Blade edge may be inverted when edge becomes worn.

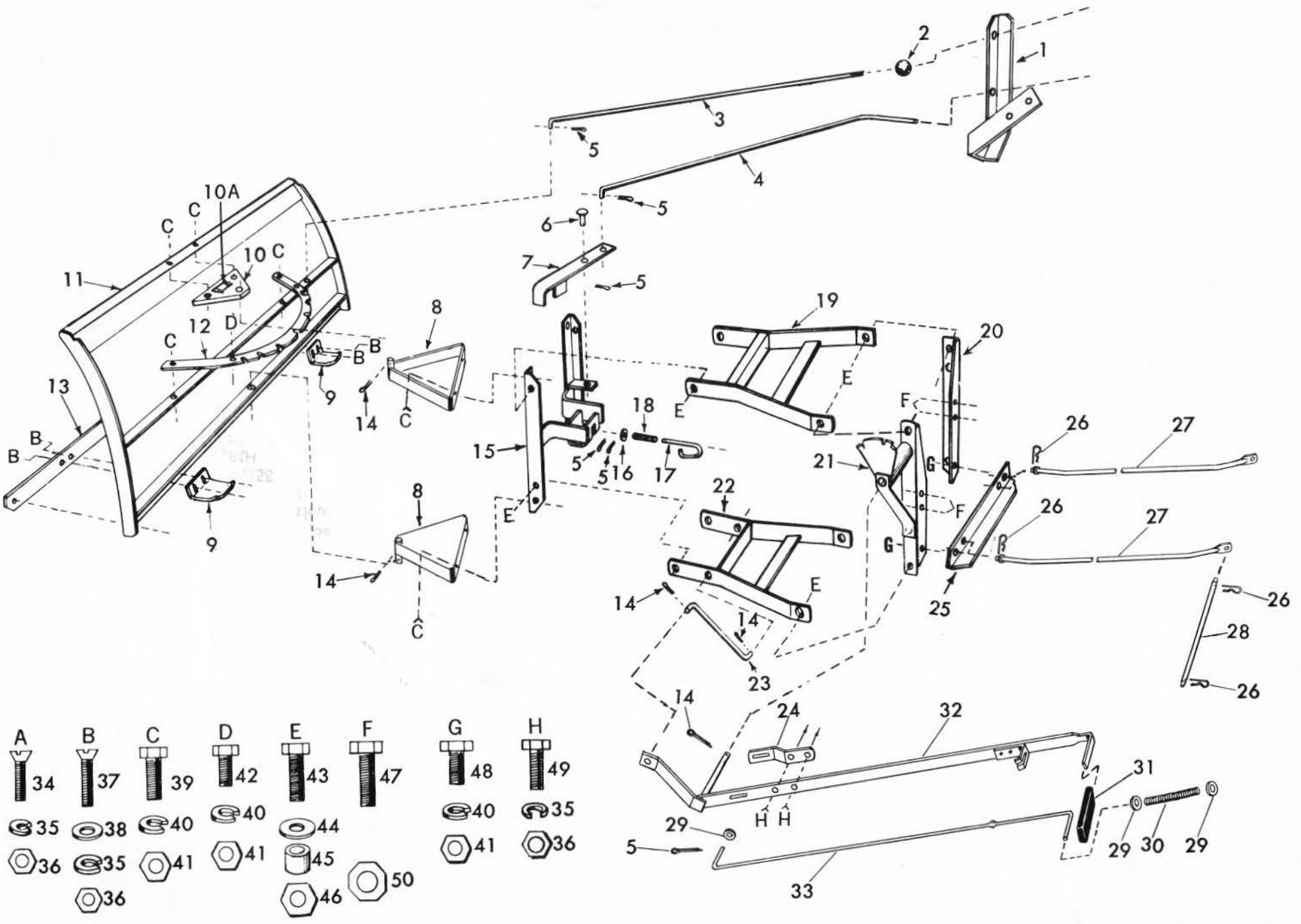

KEY NO.	PART NO.	DESCRIPTION	KEY NO.	PART NO.	DESCRIPTION
1	626A171	Rod support and bracket	26	4940M	Retainer Spring
2	6364H	Control knob	27	626A291	Push Rod
3	7704H	Blade Rod	28	1049R	Lower Link Pin
4	7952H	Lock Rod	29	1513P	Washer, 13/32 x 13/16 x 16 Ga.
5	2505P	Cotter pin 1/8 x 3/4	30	1539U1	Spring
6	7373H1	Pivot pin 3/8 R.H. rivet	31	8206H	Handle Grip
7	634A143	Pivot Arm Weldment	32	626A256	Lever and Arm
8	626A262	Fork	33	8200H	Lever Plunger
9	9026M	Shoe	34	3064P	Flat Head Screw 1/4-20 x 3/4
10	1411H	Upper Pivot Gusset	35	1002P	Lock Washer 1/4
10A	----	Model Plate	36	503P	Hex Nut 1/4 - 20
11	626A258	Blade	37	3130P	Flat Hd. Screw 1/4 - 20 x 1
12	8884H	Arch	38	1506P	Washer 9/32 x 5/8 x 16 Ga.
13	899R	Blade Edge	39	3023P	Hex Bolt 3/8 - 16 x 1
14	2501P	Cotter Pin 5/32 x 1	40	1004P	Lockwasher 3/8
15	606A97B	Front Frame	41	501P	Hex Nut 3/8 - 16
16	1517P	Washer 7/16 x 1 x 14 Ga.	42	3021P	Hex Bolt 3/8 - 16 x 3/4
17	6090M	Latch	43	3035P	Hex Bolt 7/16 - 14 x 1-1/4
18	7962H	Spring	44	1544P	Washer 15/32 x 59/64 x 16 Ga.
19	626A260	Upper Lift Frame	45	5222H	Bushing
20	5202H	Mounting Angle R.H.	46	7762H	Lock Nut 7/16-14
21	626A261	Mounting Angle and Quadrant Assembly L.H.	47	3025P	Hex Bolt 3/8-16 x 1-1/4
22	626A46A	Lower Lift Frame	48	3023P	Hex Bolt 3/8-16 x 1
23	8201H	Lift Rod	49	3003P	Hex Bolt 1/4-20 x 3/4
24	4338M	Lever Clip Lower	50	545P	Gripco Nut 3/8 - 16
25	5201H	Mounting Angle Brace.	51	910R	Instruction and parts book Model No. 917.250550

Sears

owners manual

# BULLDOZER-SNOWPLOW

## FOR CUSTOM TRACTOR

**MODEL NO.  
917.250550**

The Model Number will be found on a plate attached to the blade. Always mention the Model Number when requesting service or repair parts for your Bulldozer - Snowplow.

All parts listed herein may be ordered through SEARS, ROEBUCK AND CO. When ordering parts by mail, selling prices will be furnished on request or parts will be shipped at prevailing prices and you will be billed accordingly.

WHEN ORDERING REPAIR PARTS; ALWAYS GIVE THE FOLLOWING INFORMATION AS SHOWN IN THIS LIST.

1. The PART NUMBER
2. The PART DESCRIPTION
3. The MODEL NUMBER  
917.250550
4. The NAME OF ITEM -  
Bulldozer - Snowplow

Your Sears Merchandise takes on added value when you discover that Sears has over 2,000 Service Units throughout the country. Each is staffed by Sears-trained, professional technicians using Sears approved parts and methods.

**SEARS SERVICE  
IS AT YOUR SERVICE  
WHEREVER YOU LIVE  
OR MOVE  
IN THE U.S.A.**

**SEARS, ROEBUCK AND CO. U.S.A.**

SIMPSONS-SEARS LIMITED, CANADA