

ASSEMBLY, OPERATING INSTRUCTIONS
AND PARTS LIST FOR
SEARS
DISC HARROW
FOR SUBURBAN AND CUSTOM TRACTORS

Sears

MODEL NUMBER
917.251220

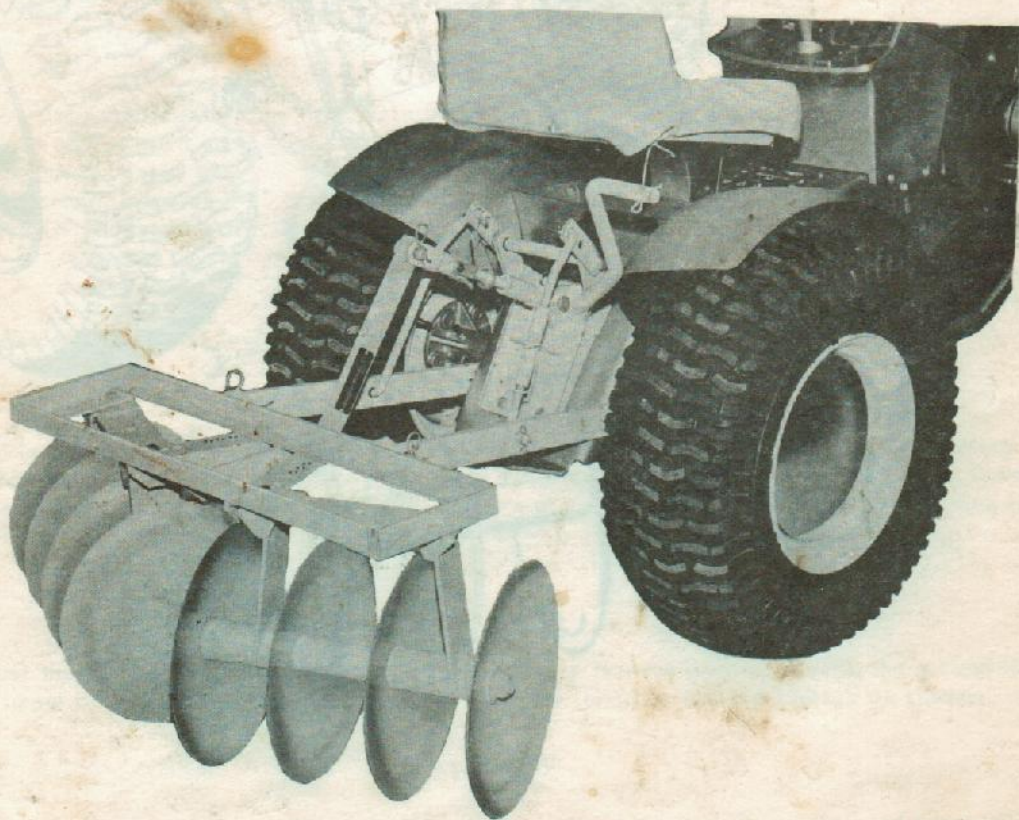

SEARS, ROEBUCK AND CO.—U.S.A.

SIMPSONS-SEARS LIMITED — CANADA

INSTRUCTION AND PARTS BOOK NO. 9251H

PRINTED IN U. S. A.

INTRODUCTION

Please study these instructions carefully before assembling Disc Harrow.

For Sears Suburban and Custom Riding Tractors. The Disc Harrow should be used immediately after plowing to break up the lumps of soil. It can be used on all jobs and purposes for which a large disc harrow is used, and will accomplish results highly desired for good seed bed preparation. It can also be used for cultivation between rows and leveling. By using the Disc Harrow in conjunction with the plow and drag harrow, a perfect seed bed can be prepared.

This Disc Harrow is packaged in one carton, Model Number 917.251220

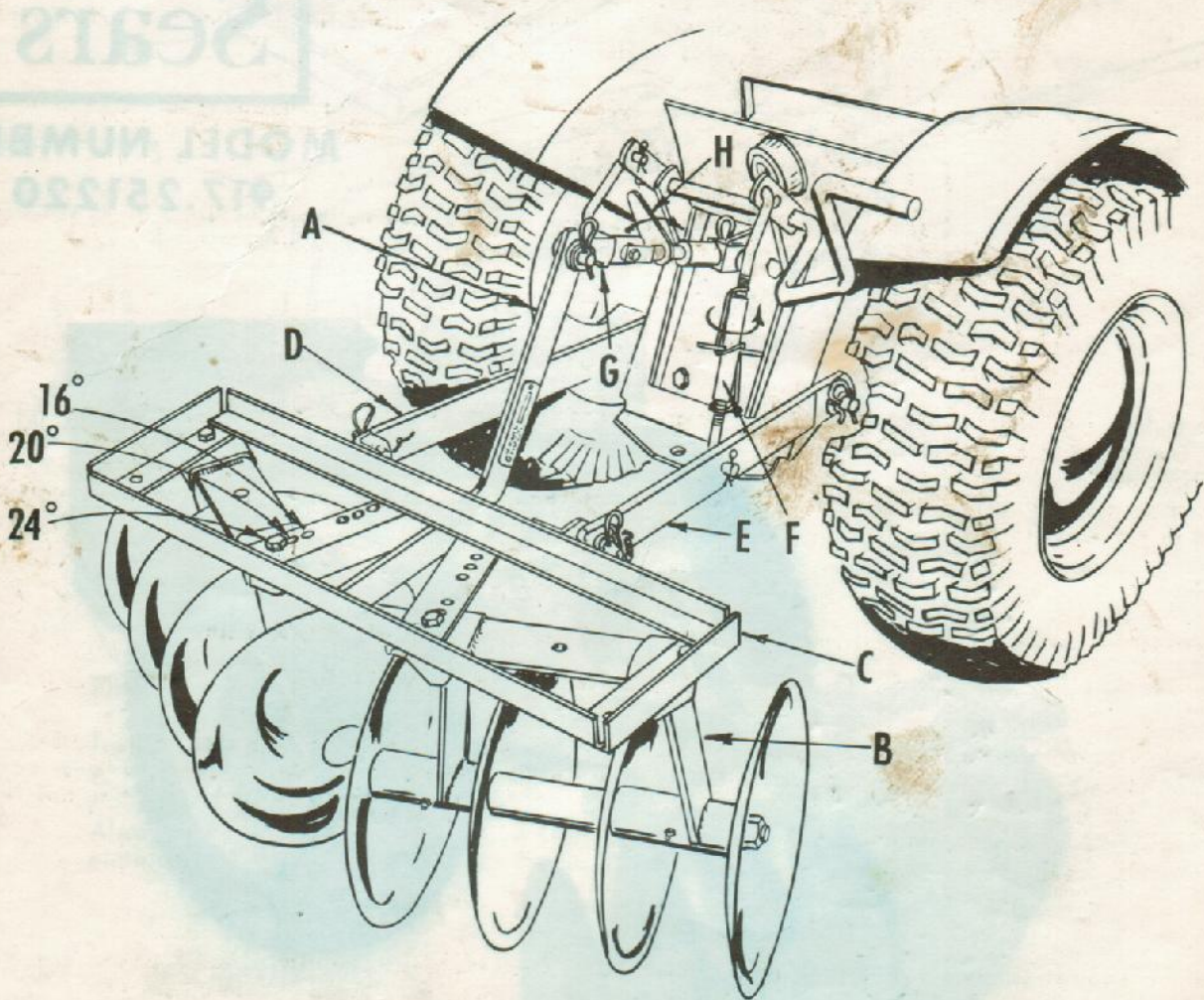

FIG. A

SETTING UP INSTRUCTIONS

A letter in the following instructions refer to an arrow in Fig. A, page 2. When R.H. (Right Hand), or L.H. (Left Hand) are used, it should be understood to mean from a position behind and facing the Disc Harrow, or direction of travel.

1. Position frame so that center bar (A), is pointed up as shown. Refer to Fig. A for degree of angle desired, and insert bolts in standard support and bearings (B), and one of the three rear holes of the frame (C). Secure with lockwashers and hex nuts. Tighten nuts securely. Center blades of each gang should touch each other slightly.

HOW TO ASSEMBLE DISC HARROW TO TRACTOR

NOTE: See Three Point Hitch Instruction Book for assembling Hitch to Tractor if purchased new with the Disc Harrow.

1. Back Tractor into position to attach Disc Harrow and slip L.H. lower hitch bar and bushings (D), over L.H. link pin on Disc Harrow. Secure with retainer spring.
2. Slip R.H. lower hitch bar and bushing (E), over R.H. link pin on Disc Harrow and secure with retainer spring. NOTE: R.H. lower hitch bar and bushings (E), is adjustable. Rotate side adjusting link (F), so that R.H. lower hitch bar and bushings (E), slides over R.H. link pin on Disc Harrow easily.

Assemble upper adjusting link (G), to frame center bar (C), of Disc Harrow as shown. Secure with retainer spring.

LUBRICATION

There are four places to lubricate on the Disc Harrow. Give each grease fitting (Key No. 5, page 4), two shots of grease every two hours of operation. Use Sears All-purpose Lithium gun grease or equivalent.

OPERATING INSTRUCTIONS

ANGLE OF CUT

There are three positions for angling of gangs. Note the three rear holes where each gang is bolted to the frame in the center. The rear hole angles each gang approximately 24° , the center hole approximately 20° and the front hole approximately 16° . Setting the gangs in the rear holes (24° angle), will cause the Disc to penetrate deeper, if the Disc does not penetrate deep enough, more weight can be placed on the frame. In loose or soft earth the angle should probably be reduced to prevent over loading the tractor.

DOUBLE DISCING

For best results, (more uniform and level preparation of soil) lap half the width of Disc path.

LEVELING DISC

There are turnbuckles on the linkage of the three point hitch for leveling the Disc. The side adjusting link (F), on the R.H. lower hitch bar and bushings (E), is used for leveling the Disc from side to side. Adjust R.H. lower hitch bar and bushing so that both ends of Disc Harrow touch level surface at the same time. Rotate side adjusting link from left to right to lengthen linkage as shown.

TOP LINK

When discing adjust the top link (G), so that the top frame of Disc Harrow is parallel with the ground from front to rear. Rotate handle on upper adjusting link to the right (clockwise), to lengthen the top linkage as shown.

STORAGE

When Disc Harrow is to be stored for any length of time, clean blades thoroughly and coat with grease or rust preventive.

SEARS DISC HARROW -- MODEL NO. 917.251220

606X4

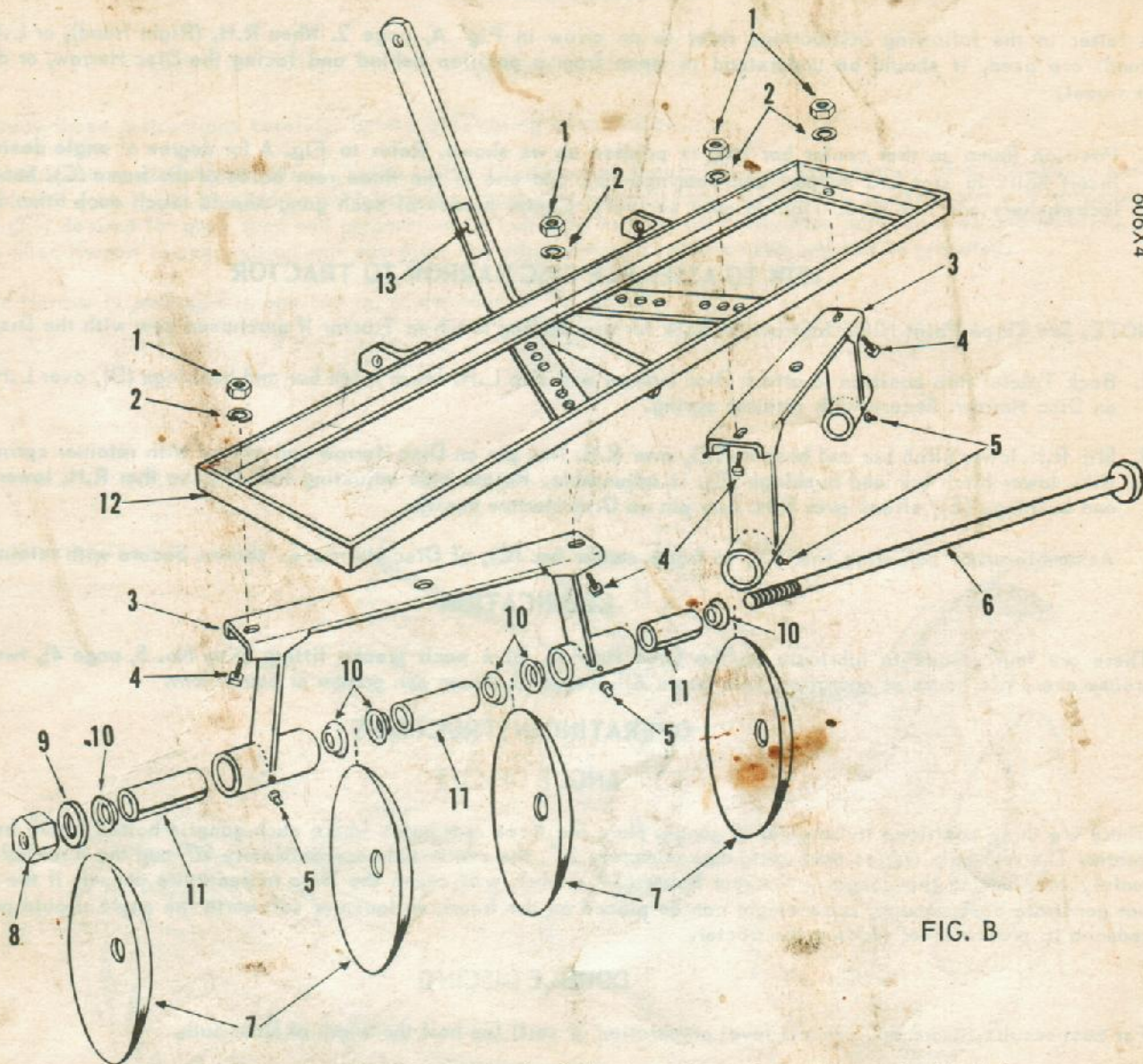

FIG. B

When ordering Repair Parts, always give the following information as shown in this list:

- 1. The PART NUMBER.
- 2. The PART NAME.
- 3. The MODEL NUMBER--917,251220.
- 4. The NAME of ITEM--DISC HARROW.

Always order by Part Number--not by Key Number. The Model Number will be found on a plate attached to the Drawbar of the Frame, Key Number 13, above.

PARTS LIST

KEY NO.	PART NO.	DESCRIPTION	KEY NO.	PART NO.	DESCRIPTION
1	271501	Hex Nut 7/16 - 14 pltd.	7	6844M	Disc Blade
2	121621	Lock Washer, Light Spring 7/16"	8	1187M	Lock Nut
3	606A44	Standard Support and Bearings	9	6817M	Outer Gang Bolt Washer
4	100146	Bolt, Hex 7/16 x 1" - 14 UNC	10	6833M	Spacer Cup
5	6855M	Grease Fitting	11	6829M	Spacer
6	575PA681	Gang Bolt and Inner Gang Bolt Washer	12	606A43	Frame
			13		Model Number Plate
			---	9251H	Instructions and Parts Book