

# FRONT MOUNTING BRACKET



## ASSEMBLY

To assemble your Front Mounting Bracket you will need a 3/4" Wrench.

Model No.  
917.253170

Install Front Mounting Bracket to Engine Mount Assembly using:



two Carriage Bolts, three Flat Washers, two Lockwashers and two Hex Nuts found in bag of parts.

1. Place Carriage Bolts in slotted front holes of Channel Brackets and Support. (Head of Bolts to outside). Next assemble a Flat Washer, Lockwasher and Nut to each bolt. Tighten hand tight.
2. Slide Channel Brackets and Support into slots of Engine Mount Assembly as far as it will go. Tighten Nuts securely. NOTE: If play is found at either side between Channel Bracket and Engine Mount Assembly; add a Flat Washer between Channel Bracket and Engine Mount Assembly. Replace Bolt, Flat Washer, Lockwasher and Nut.

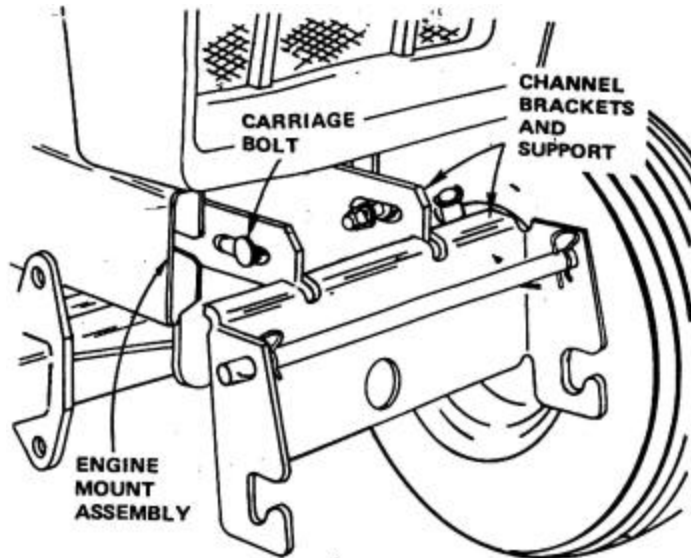

## REPAIR PARTS

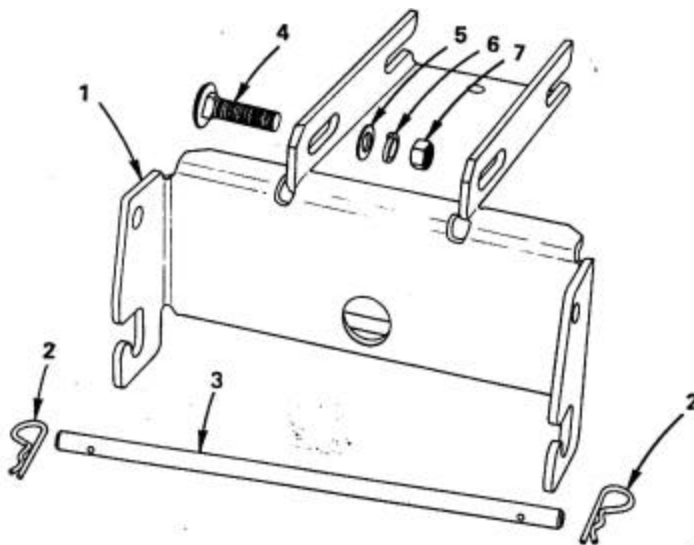

KEY NO.	PART NO.	DESCRIPTION
1	634A839	Channel Brackets and Support
2	4941M	Retainer Spring
3	27J	Mounting Rod
4	STD535012	*Carriage Bolt, Sq. Neck Short Shoulder 1/2 - 13 x 1 - 1/4
5	STD551050	*Washer, Flat 17/32 x 1 x 16 Ga.
6	STD551150	*Lockwasher 1/2
7	STD541050	*Hex Nut 1/2 - 13 UNC
---	9347R	Instruction Sheet

\*STANDARD HARDWARE - PURCHASE LOCALLY