

Sears
owners
manual

MODEL NO.
917.253250

48" price
42" price
639.99

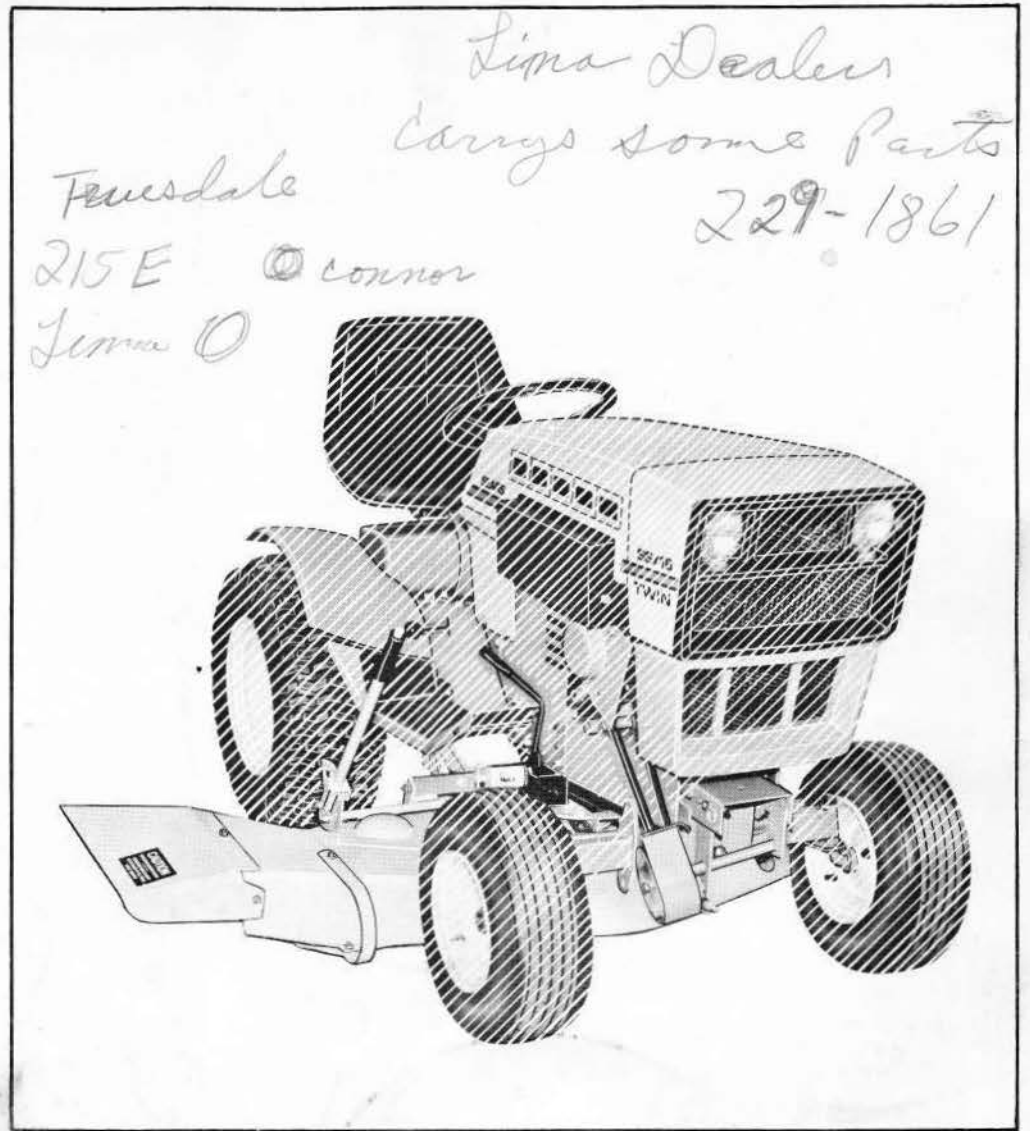

42 INCH ROTARY MOWER

- Assembly
- Operating
- Maintenance
- Repair Parts

*Sears - Lima
Toll Free*

~~1-800-877-3277~~

For Parts 1-800-366-7278

Sears, Roebuck and Co., Chicago, Ill. 60607 U.S.A.
and Simpsons Sears Limited, Toronto

GUARANTEE

During the first year, we will repair your mower free of charge if found defective in material or workmanship. This guarantee service is available by simply contacting any of our stores or service centers throughout the United States or Canada.

The guarantee is limited to 30 days if the item is used for commercial purposes.

SEARS, ROEBUCK AND CO. - SIMPSON-SEARS LTD.

SAFETY PAYS OFF

IMPORTANT

rules for safe operation

TRAINING

1. Read the Owners Manual carefully and fully familiarize yourself with the controls and proper use of your tractor and mowing attachment. Be prepared to stop the engine and blades on a second's notice. Only persons well acquainted with these Rules for Safe Operation should be allowed to use your tractor and mowing attachment.
2. Do not allow children or young teenagers to start or operate your tractor and mowing attachment.
3. Do not allow anyone in the area while cutting. Keep the children and pets in the back yard while mowing the front yard. Keep a wary eye out for children or passers-by. Place the blade control lever in the disengaged position and stop the engine while they are in the vicinity of your mower. Children, particularly, could get an extremity in the way of the revolving blade(s) and also, although the area to be mowed should be completely cleared of all foreign objects, a small object may have been overlooked and could be accidentally thrown by the mowing attachment.

PREPARATION

4. Thoroughly inspect your lawn and remove all foreign objects such as rocks, stones, wires, cans, boards, branches, bones and other foreign objects before each cutting. Do not strike any roots or other foreign objects as they may be propelled by the blades causing injury to the operator, a bystander or a pet or damage to other property, the tractor or the mowing attachment itself.
5. Do not operate the tractor and mowing attachment when barefoot or wearing open sandals. Always wear substantial footwear, preferably steel-toed shoes. Also, do not wear loose fitting clothing that could get caught in moving parts.

6. Check your fuel supply before each use. Never remove the gas cap or fill the gasoline tank when the engine is running or while it is hot. When filling the fuel tank, leave space for expansion, do not fill it to the brim and keep in mind that the heat of the sun can cause the gasoline to expand. Wipe off any spilled gasoline before starting the engine. Remember, gasoline is highly flammable and must always be handled with extreme care.
7. A tractor with a mowing attachment is a precision piece of lawn care equipment, not a plaything, therefore, extreme caution must be exercised at all times.
8. Never attempt to operate a damaged tractor or mowing attachment, always repair any damage before attempting to start or operate your tractor or mowing attachment.
9. Never attempt to carry any passengers, their safety as well as your safety will be endangered.
10. Your tractor with the mowing attachment in place is equipped with an engine interlock system. This system will prevent the engine from starting if the operator tries to start the engine while the transmission is in gear and/or the blade control lever is in the engaged position. Before attempting to start the engine make sure the gear shift lever is in neutral and the blade control lever is in the disengaged position, then firmly apply the foot brake. The parking brake must always be disengaged when you put the tractor in motion. If the tractor is operated with the parking brake engaged, serious damage may result.
11. Each time before leaving the operator's seat, be absolutely sure the blade control lever is in the disengaged position, the parking brake is engaged, the gear shift lever is in neutral, the engine is shut off, the blades and all moving parts have stopped and the ignition key is removed. Never leave the operator's seat with

the engine or blades running. Always get on or off your tractor with the mowing attachment in place from the operator's left-hand side. This will reduce exposure to the discharge area.

12. Always mow in daylight or good artificial light, only.
13. Never operate your tractor in wet or slippery grass, where traction is unsure or at a speed which could cause a skid.

OPERATION

14. Do not attempt to change the governor setting or overspeed the engine. The governor controls the engine speed and protects the engine from damaging, excessive speeds. Excessive engine speeds are dangerous.
15. When starting your engine on tractors equipped with a pull starter, stand firm and make sure your feet are well away from the mowing attachment.
16. Never place your hands or feet under the mowing attachment, in the discharge chute or near any moving parts while the tractor or mower are running. Always keep clear of the discharge chute.
17. Always place the blade control lever in the disengaged position, set the parking brake, shift into neutral, shut off the engine, make absolutely sure the blades and all moving parts have come to a stop and remove the ignition key each time you dismount your tractor, even for a second. Children, yourself, other persons or pets may be endangered.
18. If your tractor or mowing attachment should inadvertently strike a foreign object, immediately place the blade control lever in the disengaged position, set the parking brake, shift into neutral, shut off the engine, make absolutely sure the blades and all moving parts have completely stopped, remove the ignition key, disconnect the spark plug wire from the spark plug(s) and keep the wire away from the plug(s) to prevent injury or accidental starting, then thoroughly inspect the tractor and mowing attachment for any damage. Such damage must be repaired before restarting and operating the tractor and mowing attachment.
19. If the tractor or mowing attachment should start to vibrate abnormally, place the blade control lever in the disengaged position, set the parking brake, shift into neutral, shut off the engine, make absolutely sure the blades and all moving parts have completely stopped, remove the ignition key, disconnect the spark plug wire from the spark plug(s) and keep it away from the plug(s) to prevent injury or accidental starting, then check immediately for the cause of this vibration as vibration is generally a warning of trouble.
20. Before clearing the discharge chute, adjusting, cleaning, repairing, or inspecting your tractor or mowing attachment, place the blade control lever in the disengaged position, set the parking brake, shut off the engine, make absolutely sure the blade(s) and all moving parts have completely stopped, remove the ignition key, disconnect the spark plug wire from the spark plug(s) and keep it away from the spark plug(s)

and keep it away from the spark plug(s) to prevent injury or accidental starting.

21. Do not run the engine indoors because the engine exhaust fumes contain carbon monoxide which is a tasteless, odorless, deadly poison.
22. Never mow a terrace, slope, or incline that is too steep to preserve good stability and control in order to prevent tipping or sideways upsets. Always mow up and down such an incline, at a slow speed when using a tractor, do not mow across.
23. Do not start or stop suddenly when going up or down a terrace, slope or incline. If it is necessary to stop your tractor upon an incline, do so firmly to prevent the tractor from picking up speed during declutching and before reaching the brake position. Do not shift gears while going up or down inclines. Choose a gear low enough to negotiate the incline without stopping and shifting gears. To reduce the speed of the tractor on an incline move throttle lever to slow.
24. Never attempt to operate your tractor or mowing attachment without the proper shields, guards, plates or other protective devices in place and fully functioning.
25. Be absolutely sure that the discharge shield is used at all times when the mowing attachment is operating in order to minimize the possibility of injury or damage from a thrown object.
26. Before and while attempting to back up, look carefully to be absolutely sure that children, bystanders, pets, foreign objects or obstacles of any kind are not behind you.
27. Never direct grass clippings from the discharge chute toward bystanders or pets nor allow anyone near the tractor while it is operating.
28. Be sure to exercise special care when mowing around fixed objects in order to prevent the blades from striking them. Never deliberately run a tractor or mowing attachment into or over any foreign objects.
29. Never shift gears to reverse your direction of travel until the tractor comes to a complete stop.
30. Always stay alert to avoid holes in the terrain and other hidden hazards. Tipping or sideways upsets can happen easily in holes or ditches. Use low gear on unfamiliar ground. If the tractor or mowing attachment becomes stuck in a hole, always place the blade control lever in the disengaged position before attempting to free it.
31. Be ready to start mowing before you start the engine of your tractor, place the blade control lever in the engaged position or shift into gear. The use of any precision piece of power equipment requires your full concentration and attention to the job being done in order to prevent injury or damage.
32. Always place the blade control lever in the disengaged position when not cutting grass such as when crossing a gravel drive, sidewalk, or roadway or when transporting the tractor.
33. Watch out for traffic when crossing or near roadways.

rules for safe operation (cont.)

MAINTENANCE

34. Keep all nuts, bolts and screws tight in order to be sure that the tractor and mowing attachment are in safe working condition. Be sure the brake and mowing attachment controls are always in proper adjustment and repair. Check the blade and engine mounting bolts at frequent intervals for proper tightness. Before performing any maintenance, always place the blade control lever in the disengaged position, set the parking brake, shift into neutral, shut off the engine, make absolutely sure the blades and all moving parts have completely stopped, remove the ignition key, disconnect the spark plug wire from the spark plug(s) and keep it away from the plug(s) to prevent injury or accidental starting.
35. Keep the engine free from accumulations of grass, leaves or excessive grease as these accumulations are combustible and could result in a fire. Always keep your tractor and mowing attachment in good operating condition and make sure that all shields, guards, plates and other protective devices are in place. Give your tractor and mowing attachment the regular maintenance they need and have a competent serviceman make a thorough inspection of the tractor and mowing attachment at least once a year.
36. Do not store your tractor for prolonged periods (more than 30 days) with gasoline in the tank. Do not store your tractor or a gasoline container inside a building where fumes may reach an open flame or spark, they should be stored in a cool, dry place. Be sure to let the engine cool before storing in any enclosure. Always use an approved gasoline container for storing gasoline and keep your tractor, mowing attachment and gasoline container in locked storage to prevent children from playing and tampering with them.

introduction

This tractor or attachment has been designed, engineered and manufactured to give you the best possible dependability and performance.

Should you experience any problem you cannot easily remedy, please contact your nearest Sears Roebuck or Simpsons-Sears, Ltd. Service Dept. They have well qualified, competent trained technicians and the proper tools to service or repair this unit.

It is important that the operator ALWAYS OBSERVES THE "RULES FOR SAFE OPERATION" as well as other instructions contained in these manuals.

Your new Rotary Mower Attachment utilizes multiple sharp cutting blades rotating about vertical shafts within the housing. These blades rotate at 14,000 feet per minute. The blades slice grass at approximately 158 miles per hour to provide a uniformly cut lawn. Grass clippings are exhausted through the mower discharge area by the fast flow of air created by the revolving blades.

The Rotary Mower has been shipped from the factory partially assembled, for shipping purposes. All parts necessary to complete assembly are included in plastic bag within the carton. The bag of parts include the following items:

2	adjusting pins	2	carriage bolts
4	retainer springs	10	flat washers
2	bushings	6	lockwashers
1	spring	6	hex nuts
2	hex bolts	1	instruction sheet

table of contents

GUARANTEE	1
ASSEMBLY INSTRUCTIONS	4-9
OPERATING INSTRUCTIONS	9-10
MAINTENANCE INSTRUCTIONS	10-12
REPAIR PARTS	13-17

reference drawing for assembly and instructions

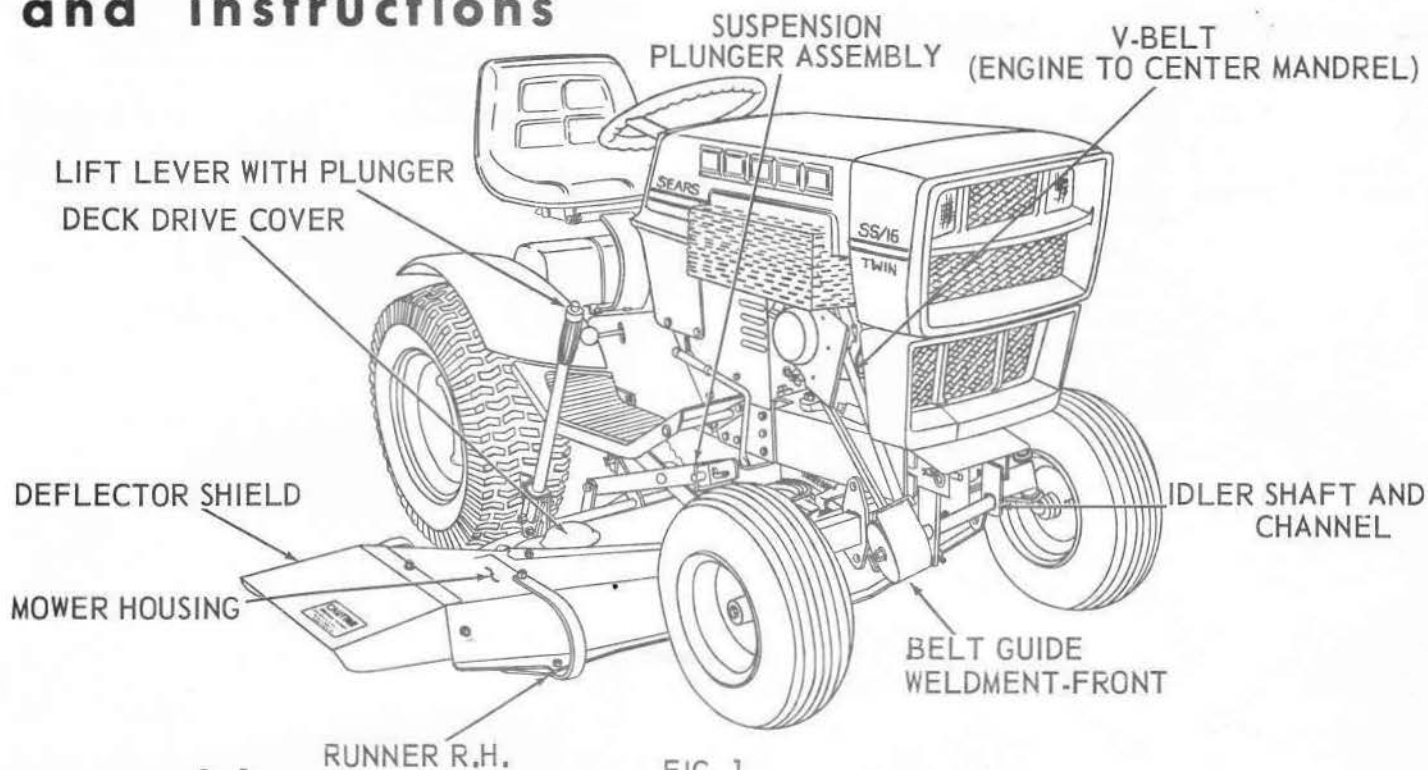

FIG. 1

assembly

Assembly as well as all of the different sections of this Owners Manual should be studied very closely before beginning to assemble your Rotary Mower.

A letter in parenthesis in the following instructions refers to an arrow in an adjoining Figure (illustration), unless otherwise stated. When R.H. (Right Hand) or L.H. (Left Hand) is used, it means from a position behind the steering wheel as if one were seated on the tractor seat and facing forward.

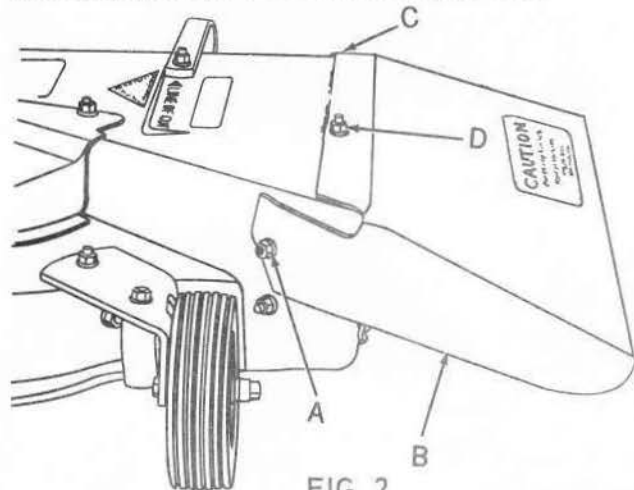

FIG. 2

1. Cut all wires, and remove mower, plastic bag, and other parts from carton. Plastic bag contains parts, and hardware necessary for the assembly of the mower. Lay out parts for assembly, and separate bolts etc. according to size.
2. Remove top bolt (A) from rear of mower (discharge end).
3. Make sure chain links are not kinked, and slip shield (B) over discharge end of mower housing as shown. Replace bolt (A) (head to inside)

3722R-7.2.73

4. Insert a 5/16 x 3/4 carriage bolt (C) (head to inside) through front of mower housing and shield (B). Slip a 11/32 x 11/16 x 16 Ga. washer (found in plastic bag) on bolt and secure with lockwasher, and hex nut, which was previously removed. Leave bolt loose.
5. Insert a 5/16 x 3/4 bolt (D) (head to inside) through top center of housing, and shield, in same manner as step 4 above. Tighten all 3 bolts in shield securely.

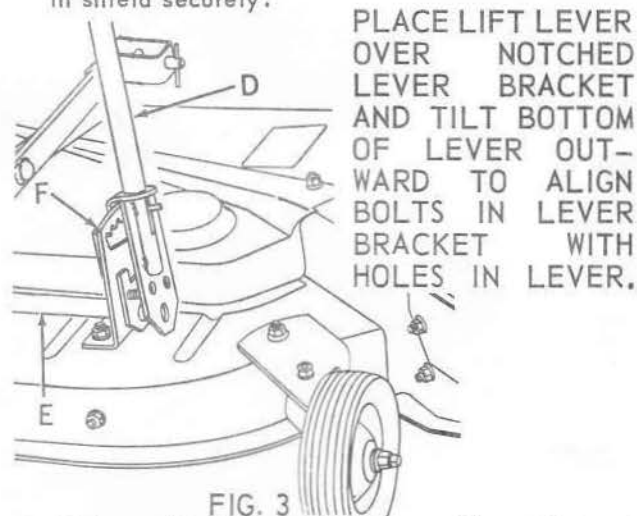

FIG. 3

6. Refer to Fig. 3. Install lift lever (D), to R.H. end of lift shaft (E). Be sure notched lever bracket (F), is between lever and lever clip, and that lever fits on end of lift shaft (E). Secure with flat washers 13/32 x 7/8 x 14 Ga., lockwashers, and hex nuts shipped in plastic bag. Tighten nuts securely.

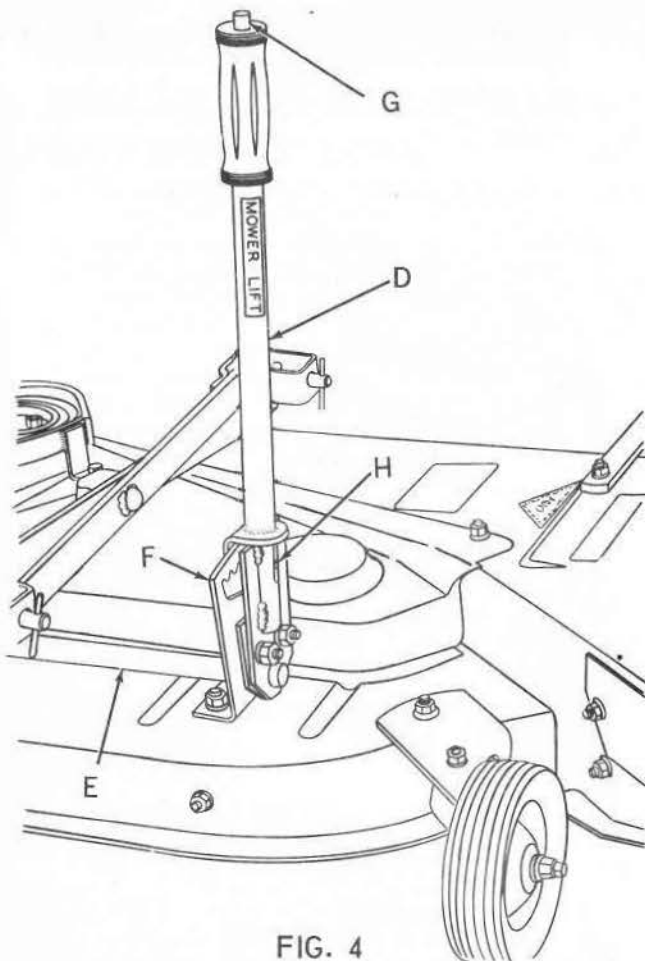

FIG. 4

7. Depress lever plunger (G). Move lever to approximately middle of notched lever bracket (F). Drive roll pin (H), thru lever, notched lever bracket, and lever clip. Refer to Fig. 4.

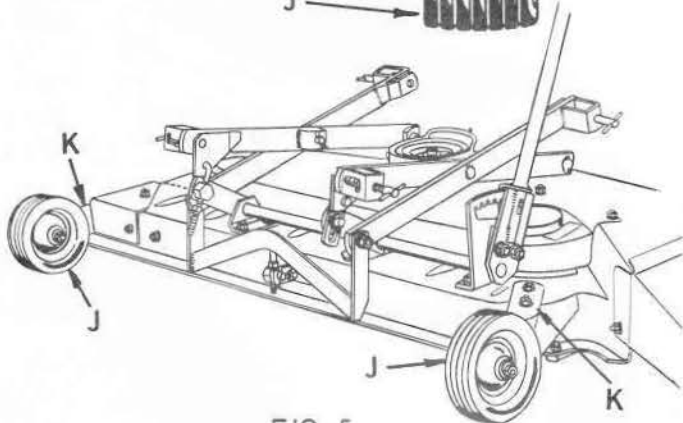
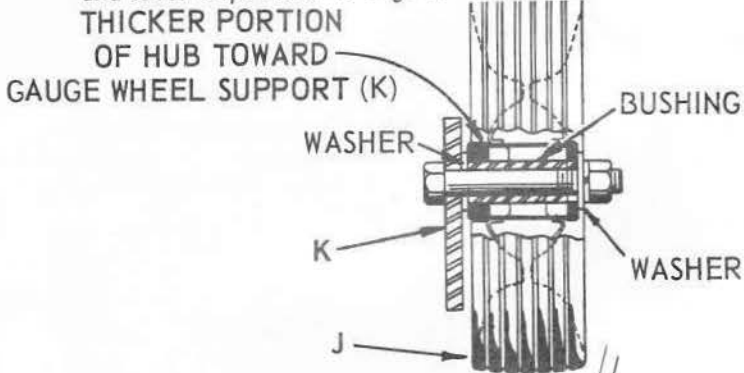

FIG. 5

8. Refer to Fig. 5. Assemble gauge wheels (J) to R.H. side of each gauge wheel support (K). NOTE: A bushing must be inside each wheel hub, and a 13/32 x 7/8 x 14 Ga. washer must

be on each side of wheel. Secure with 3/8 x 2 3/4 hex bolt, lockwasher, and hex nut. Use top hole in each bracket (K) to mount wheels. Tighten nuts securely.

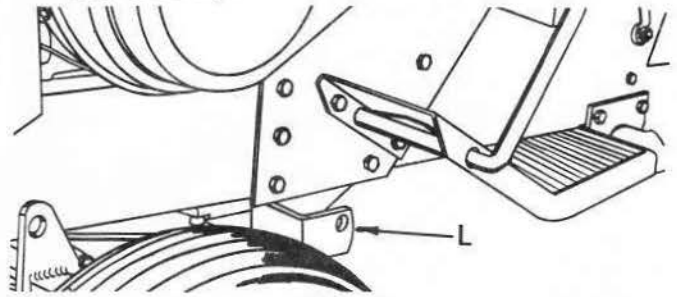

FIG. 6

9. Refer to Fig. 6. Install L.H. front hanger (L), to tractor as shown. Use bolts in tractor. If tractor is equipped with L.H. front hanger disregard the above instructions.

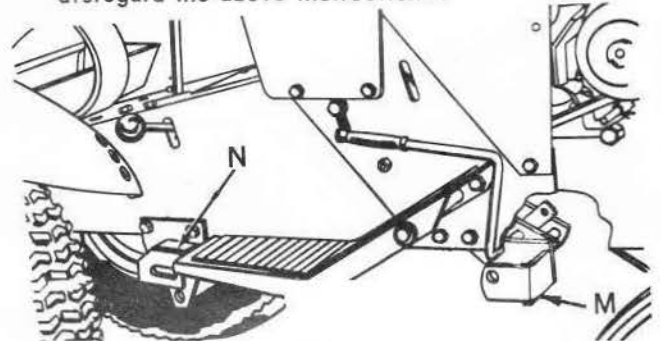

FIG. 7

10. Refer to Fig. 7. Install belt tightener lever and hanger weldment (M) to R.H. side of tractor, as shown. Front attaching bolt is in tractor frame. Rear attaching hex bolt 3/8 x 1 1/4, lockwasher, and hex nut will be found in plastic bag. If your tractor came equipped with a belt tightener lever, disregard the above instructions. NOTE: Lever and hanger weldment L.H. front is not included with mower.
11. If your tractor does not have rear hanger weldment equipped with attaching brackets (N); Remove the one that is on the tractor, and replace with new style. Order cat. no. 25391 for Suburban, or cat. no. 25392 for Hydro-trac tractors.

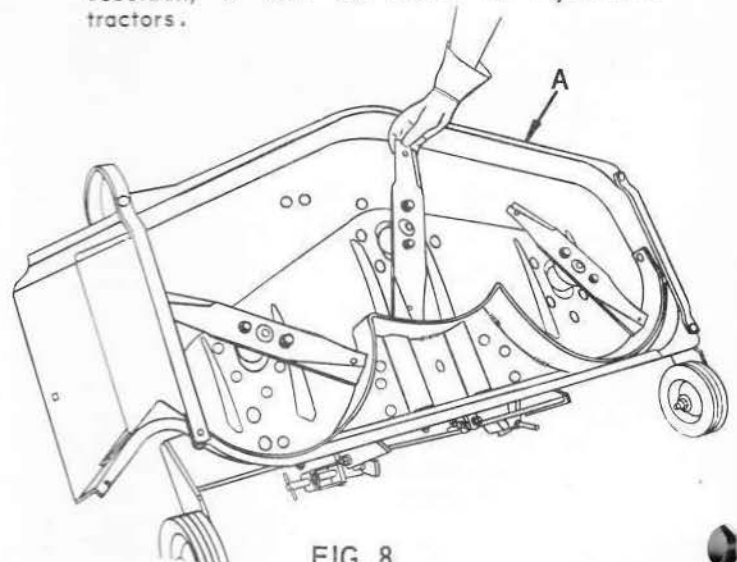

FIG. 8

12. Refer to Fig. 8. Tip mower (A) on its back edge as shown. Rotate blades to be sure that every thing clears. CAUTION: Blades are sharp.
13. Make sure all bolts, nuts etc. are tightened securely.

attaching instructions

1. Check tire pressure making sure it coincides with recommended pressures - See owners manual or maintenance decal on underside of tractor hood.
2. Place tractor on smooth level surface.

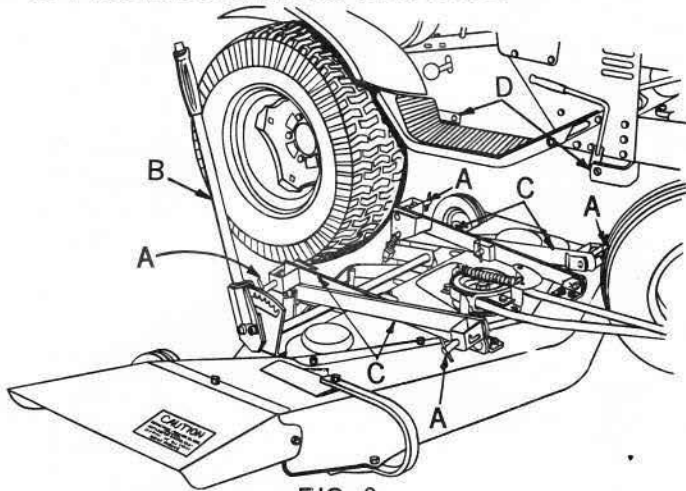

FIG. 9

3. Position mower on R.H. side of tractor as shown.
4. Turn tractor steering wheel to the extreme left.
5. Lock all four attaching plungers (A), in the "out" position.
6. Move lift lever (B), to the extreme rear position.
7. Slide mower under tractor until suspension arms (C), are directly beneath hanger brackets (D).

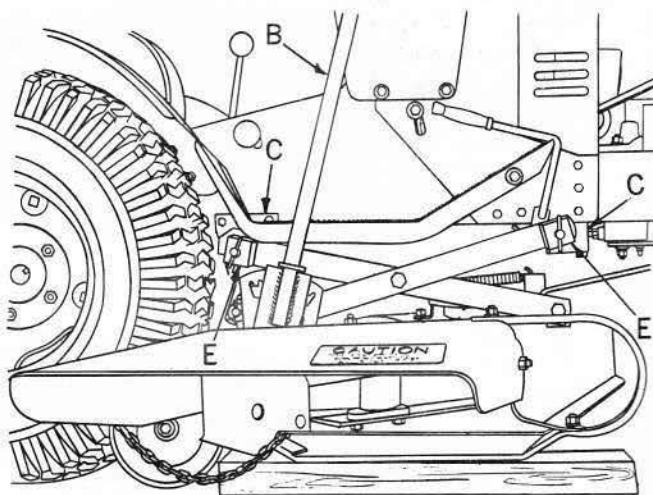

FIG. 10

8. For ease in attaching mower to tractor. Place a two foot long 2 x 4 flat wise (or similar object) under each end of mower.
9. Place lift lever (B), in extreme forward position.
10. Refer to Fig. 10. Grasp suspension arms by spring boxes (E). Raise R.H. suspension arms and align with holes in front and rear hanger brackets (C).
11. Release front plunger, so that plunger enters hole in R.H. front mounting hanger.

3722R-7.2.73

12. Release rear plunger, so that plunger enters slot in R.H. rear mounting hanger.
13. Repeat steps 10, 11, and 12 for L.H. side of mower.
14. Pull lift lever (B) back to lift mower.
15. If you have used 2 x 4's or similar objects under each end of mower--as suggested in step 8, they should be removed at this time.

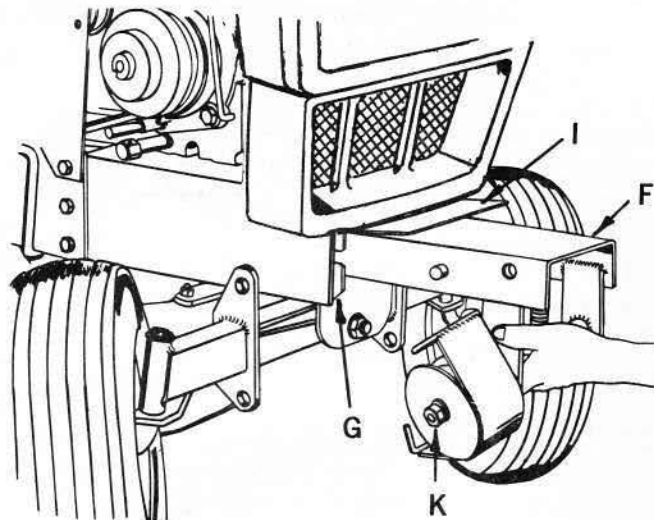

FIG. 11

16. Raise front channel cover (I), and slide idler shaft assembly (F), into front of tractor channel (G). Refer to Fig. 11.

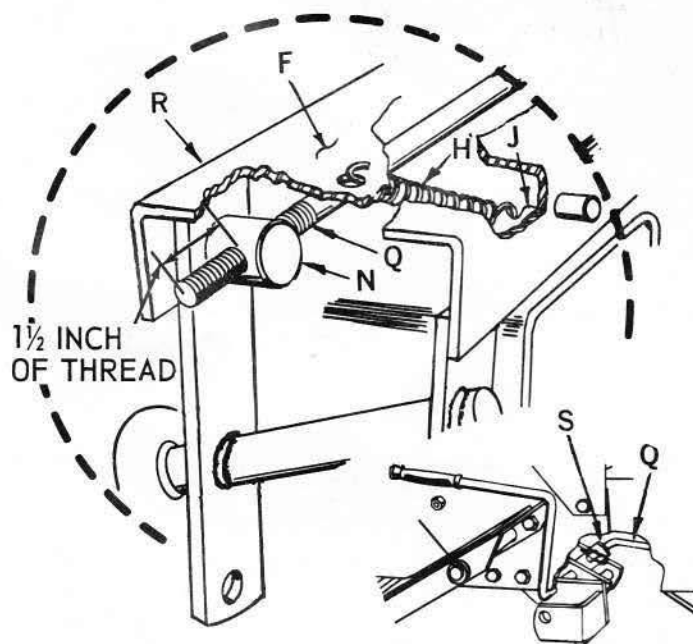

FIG. 12

17. Hook offset loop of spring (H), into hole in rear of front axle bracket (J), and other loop of spring in hole in front of frame of idler shaft assembly (F).

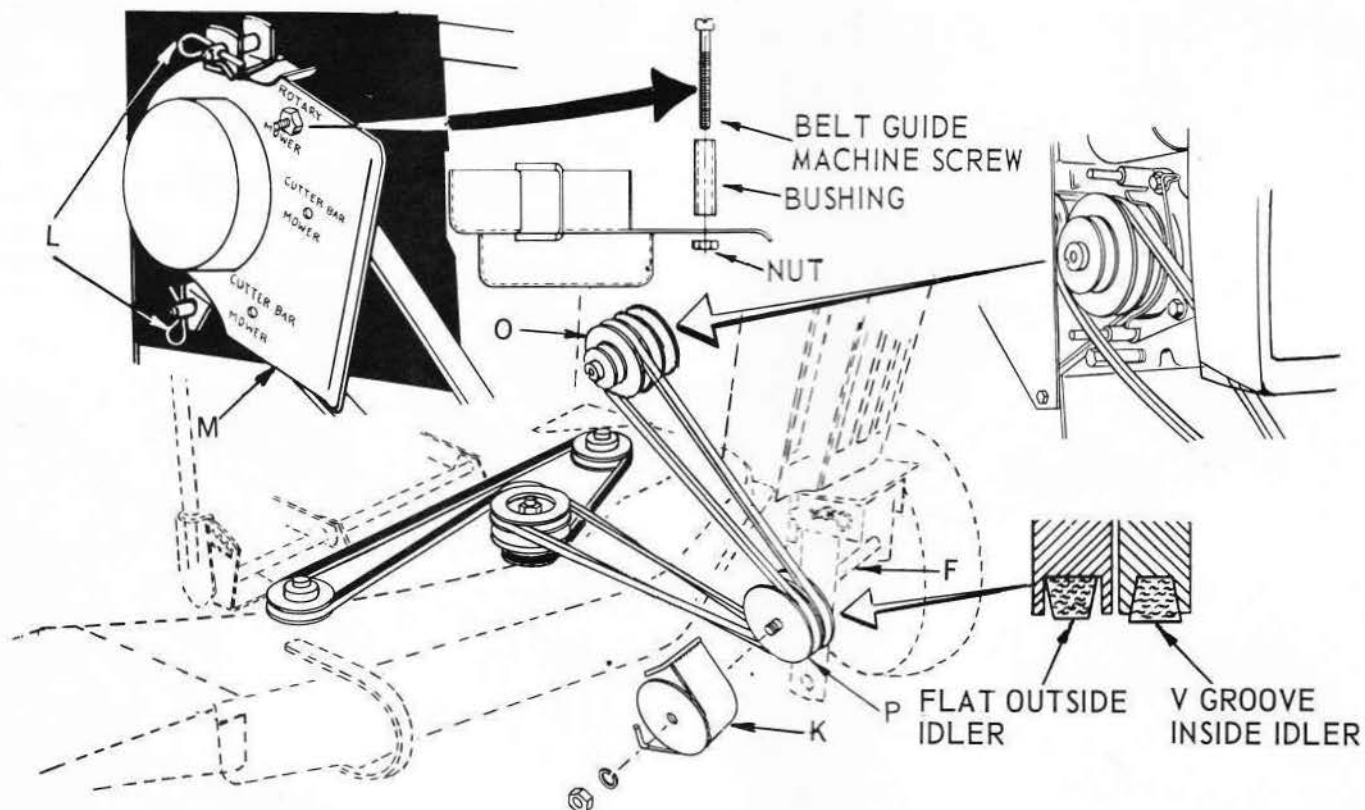

FIG. 13

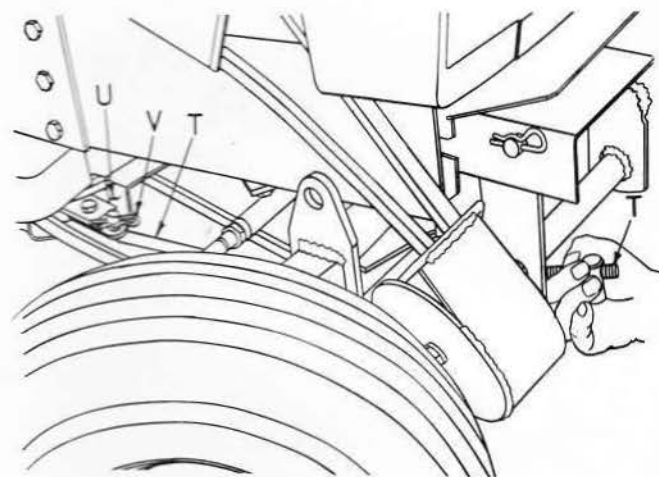

FIG. 14

18. Remove the two retainer springs (L) and engine belt guard (M). Screw, bushing and nut were shipped in place with tractor.
19. Remove nut, lockwasher, and belt guard (K), from front of idler shaft assembly (F). Place belt on idler sheaves (P) and on engine pulley (O), as shown. NOTE: See insert for proper way of installing belts on idler pulleys (P). Backside (outside) of belt must be placed in flat (outside) idler. Belt must be placed in largest groove on engine pulley (O).
20. Refer to Fig. 12. Assemble adjusting pin (N), to threaded end of belt tightener link (Q). Pin will be found in plastic bag.
21. See Fig. 12. Install belt tightener link (Q) thru opening in idler shaft assembly (F). Attach bent end of link (Q) to rear end of belt tightener lever arm (S). Secure with smallest retainer spring. Spring retainers will be found in plastic bag.
22. Refer to Fig. 12. Attach adjusting pin (N), to idler frame (R) with largest spring retainer. Refer to "Belt Adjustment", page 8.
23. Refer to Fig. 13. Replace belt guide (K) on front idler shaft (F) adjust belt guide (K) so that it clears belt by 1/16 to 1/8 inch, when belt is tight (clutch engaged) and mower is in lowest cutting position. Then raise mower to highest cutting position and check belt guide (K) to make certain it clears the belt by 1/16 to 1/8 inch at top.
24. Reinstall engine belt guard (M) on engine, and secure with two retainer springs (L).
25. Adjust belt see Page 8 for belt adjustment.

26. Refer to Fig. 14. After adjusting belt, assemble snubber pull rod (T) to snubber weldment (U), as shown in Fig. 14, and secure with retainer spring (V) found in plastic bag.

ALWAYS GET ON OR OFF TRACTOR FROM THE L.H. SIDE. THIS WILL REDUCE EXPOSURE TO DISCHARGE AREA AND AVOID THE POSSIBLE OBSTRUCTION OF LIFT LEVER IN THE OPERATOR'S PATH.

ALWAYS KEEP ALL SHIELDS, AND SAFETY DEVICES IN PLACE. NEVER DIRECT DISCHARGE OF MATERIAL TOWARD BYSTANDERS, OR BUILDINGS. NEVER ALLOW ANYONE NEAR MACHINE, WHILE IN OPERATION.

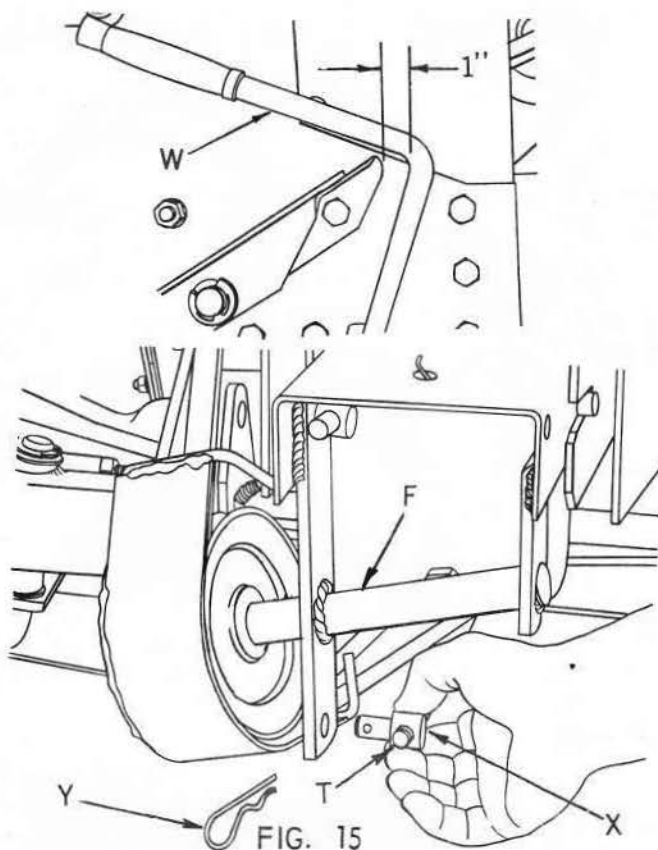

27. Refer to Fig. 15. Place mower clutch lever (W) approximately 1" away from front edge of R.H. foot rest.
28. Thread adjusting pin (X) on snubber pull rod (T) until adjusting pin will enter lower hole in idler shaft assembly (F). Remove adjusting pin from hole and slip a 9/16 x 15/16 x 11 Ga. flat washers on pin (X) against shoulder. Reinsert pin with washers in lower hole of idler shaft assy (F). Secure with retainer spring (Y).

instructions before operating belt adjustment

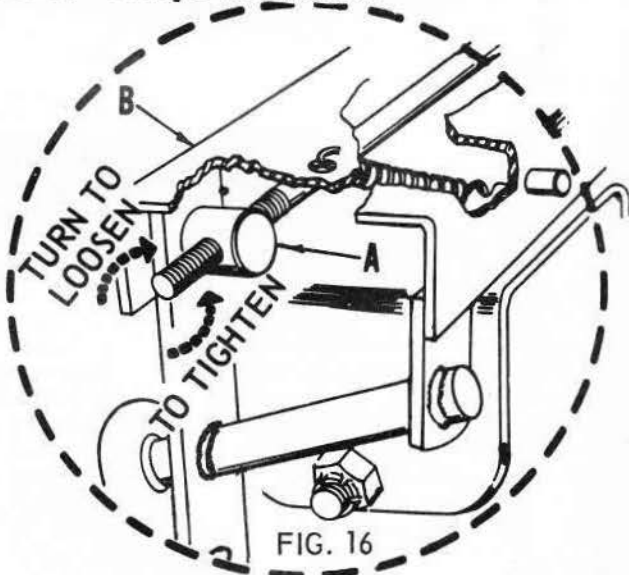

Remove retainer spring from adjusting pin (A). Remove adjusting pin (A) from idler frame (B). Turn adjusting pin counter-clockwise, to tighten

3723R-5.3.73

belt, clockwise to loosen belt. See Fig. 16. Engage clutch lever (push forward). Belt is properly adjusted when belt can be squeezed together with thumb and fore finger (without undue pressure) midway between engine and idler pulleys. After 2 hours use recheck belt for proper tension. Replace retainer spring in adjusting pin (A). Belt from center to outside mandrels is spring loaded and no adjustment is necessary.

adjustment of snubber (brake for mandrels)

Refer to Fig. 15. After belt has been properly adjusted, adjust adjusting pin on snubber pull rod as stated below. Remove retainer spring (Y) holding adjusting pin (X) in idler shaft assembly (F). Remove adjusting pin from idler shaft assembly. Position clutch lever (W) so that it is approximately 1" from front of R.H. foot rest as shown. Turn adjusting pin (X) on snubber pull rod (T) until adjusting pin will enter hole in idler shaft assembly. Secure with retainer spring (Y). When clutch is fully disengaged (lever pulled back against foot rest) blades should stop quickly. **CAUTION:** Make sure that brake is not against mandrel pulley when mower is engaged (lever pushed forward).

Do not shift gears while going up steep hills. Choose a low enough gear to climb hill without stopping and shifting gears. If it is necessary to stop while going up hill, do so quickly to prevent tractor rolling backward. When starting tractor in motion going up an incline, use one of the lowest gears, reduce engine speed and engage clutch gradually to prevent tractor from "rearing up".

level mower from side to side

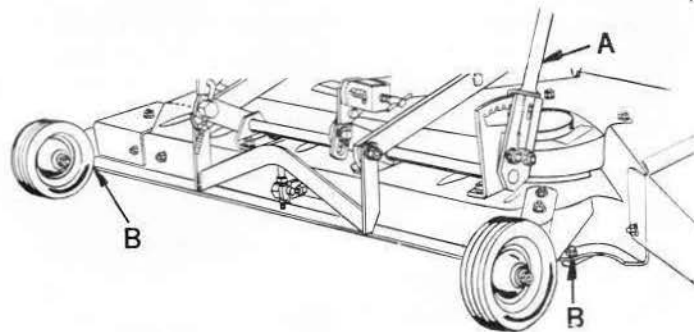

1. Refer to Fig. 17. Place tractor, with mower mounted on a smooth level surface. Lift Mower with lift lever (A) until runners and gauge wheels are off the level surface. Measure the distance from rear of housing (B) (at rear runner attaching points) to level surface. Distance from housing to level surface at each end of mower must be the same. If not mower will not cut level from side to side.

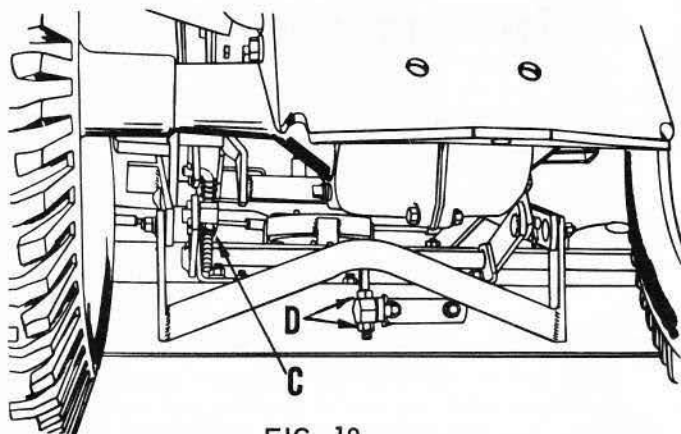

FIG. 18

2. Adjust nut (C), on hanger link at L.H. side to level mower. Shorten this link to raise L.H. side of mower - lengthen this link to lower L.H. side of mower. Refer to Fig. 18.

adjust mower from front to rear

1. Refer to Fig. 18. The mower should cut approximately $\frac{3}{16}$ " lower at front than at the rear. After mower has been leveled from side to side - adjust for pitch from back to front. Place tractor, with tires properly inflated on a smooth level surface. Raise mower until mower and wheels are in a floating position. Position R.H. mower blade, so that it is in line with the length of blade - rotate blade one-half turn and measure height of tip of rear. The front tip must be approximately $\frac{3}{16}$ inch lower at front than at rear.

Adjust nuts (D) up or down to obtain the above pitch or difference from front to rear. Adjusting nuts up will raise the rear of mower - lowering nuts will lower rear of mower. Tighten the two nuts securely against leveling pin.

THE MAIN DRIVE BELT (ENGINE TO CENTER MANDREL) MUST BE PROPERLY ADJUSTED BEFORE OPERATING. A DRIVE BELT NOT PROPERLY ADJUSTED CAN BE RUINED IN JUST A FEW MINUTES OF OPERATION. THE MOWER MUST BE LEVELED FROM SIDE TO SIDE, AND FROM FRONT TO BACK, BEFORE OPERATING. THIS IS NECESSARY FOR LEVEL, AND EFFICIENT MOWING.

operating instructions

READ THE "SAFETY PRECAUTIONS" ON PAGE 1 CAREFULLY BEFORE OPERATING YOUR MOWER.

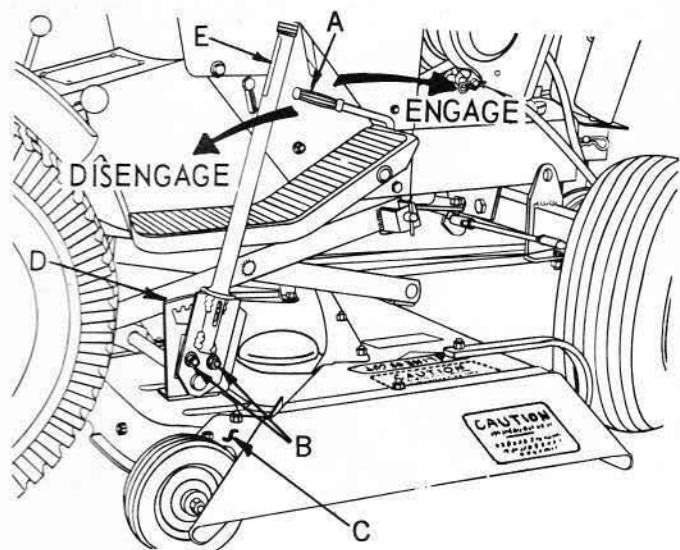

FIG. 19

CAUTION: Place tractor shift lever in neutral. Disengage clutch and be sure mower belt tightener lever (A), is disengaged before starting tractor engine.

1. Set engine speed to about $\frac{1}{3}$ to $\frac{1}{2}$ throttle before engaging or disengaging mower. In either case, engage or disengage mower belt tightener lever (A), slowly. After mower is engaged, set to full throttle. **CAUTION:** Never engage mower except when sitting on tractor seat.
2. Start mowing in a low range and increase ground speed as conditions will permit. Average cutting height is approximately $2\frac{1}{2}$ to $2\frac{3}{4}$ inches. Height of cut can be adjusted by means of the lift lever (E). Moving the lever forward lowers the mower. Moving it backwards raises the mower. The lever latch is actuated by depressing the latch button at the top of the lever handle. Each notch changes the height of cut approximately $\frac{1}{2}$ inch, refer to Fig. 20, page 10.
3. Should some intermediate height be desired. Loosen the two nuts (B), at the bottom of the lift lever. Rotate the lever forward or backward relative to the lift shaft. Forward movement will raise the height of cut. Rearward movement will lower the height of cut. This adjustment will raise or lower the cutting range approximately $\frac{1}{2}$ inch the equivalent of one-half notch on the lift lever quadrant (D). Retighten nuts (B), securely.
4. There are four holes in the R.H. and L.H. gauge wheel supports (C, Fig. 19). With lift lever set to give desired height of cut and with tractor and mower on level ground. Adjust gauge wheels to one of the holes in gauge wheel supports so that they clear the ground by approximately $\frac{3}{4}$ inch.

height of cut adjustment

FOR INTERMEDIATE HEIGHT
ADJUSTMENT - REFER TO
STEP 3, PAGE 9

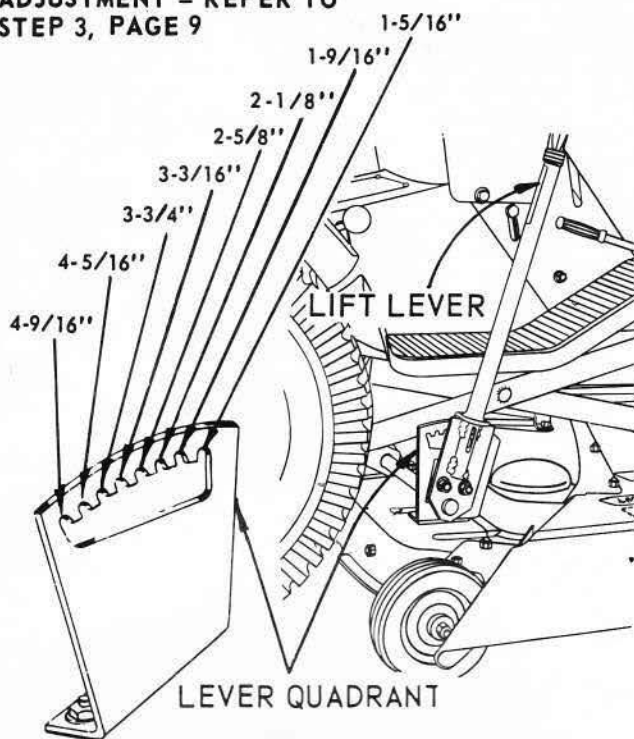

FIG. 20

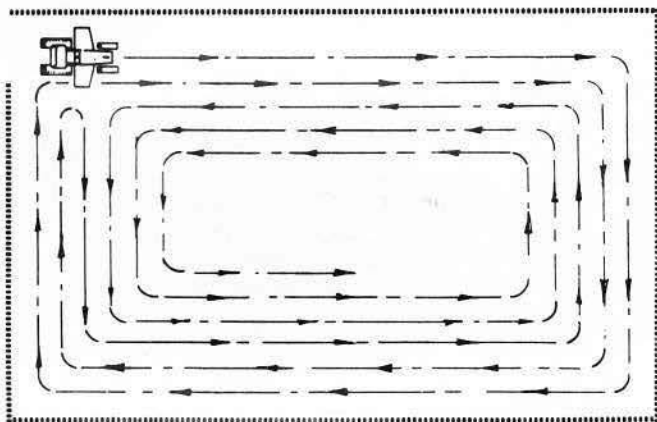

FIG. 21

5. Drive so that clippings are discharged onto the area that has been cut. See Fig. 21 for line of cut on right hand side of mower. Have the cut area to the right of the machine. This will result in a more even distribution of clippings and more uniform cutting. When mowing large areas, start by turning to the right so that the clippings will be discharged away from shrubs, fences, driveways, etc. After two or three rounds mow in the opposite direction making left hand turns until finished. If grass is extremely tall, it should be mowed twice. The first time, cut relatively high. The second time to the desired height. The L.H. end of mower should be used for trimming.

maintenance

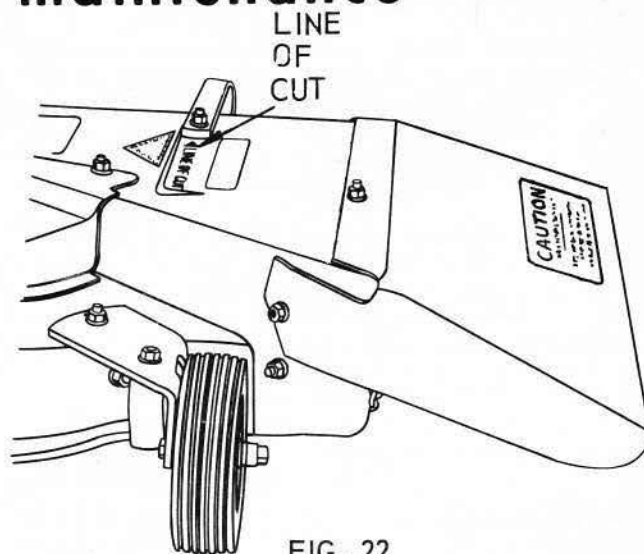

FIG. 22

lubrication

Mandrels are equipped with grease retainers and should require no lubrication during a seasons use. See instructions under storage page 12.

Periodically apply a few drops of motor oil to all pivot points of lift and suspension linkage, lever plunger and belt tightener lever.

blade care

For best results, cutting blade must be kept sharp. The blade can be sharpened with a few strokes of a file, or on a grinding wheel. Do not attempt to sharpen while on mower.

When grinding, care should be taken to maintain blade balance and the blade should be checked for proper balance before re-installation on mower. Unbalance or bent blade will cause excessive vibration when running, and eventual damage to mower or engine. Replace bent or damaged blades.

To insure satisfactory operation, it is recommended that before the start of each mowing season, the old blades be discarded and replaced with new blades. Mower blades can be purchased at all Sears retail stores and mail order outlets.

CAUTION: BE SURE MOWER CLUTCH IS DIS-ENGAGED, AND REMOVE ENGINE SPARK PLUG WIRE BEFORE ATTEMPTING TO REMOVE BLADE.

BEFORE CUTTING AN UNFAMILIAR PLOT OF GRASS, ALWAYS STOP TO ANALYZE THE LAWN OR FIELD FOR BEST MOWING PROCEDURE. CONSIDER ALSO THE HEIGHT OF GRASS TO BE MOWED, TYPE OF TERRAIN (LEVEL, HILLY OR PITTED), AS WELL AS THE PRESENCE OF ROCK OR TRASH. EACH CONDITION WILL REQUIRE CERTAIN ADJUSTMENTS OR PRECAUTIONS AS OUTLINED IN THIS MANUAL.

blade replacement

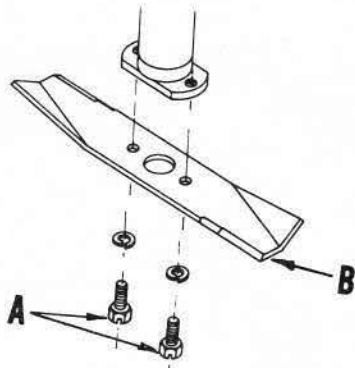

FIG. 23

It is not necessary to remove tractor mower for blade replacement. Raising mower lift lever to highest position will permit access to blades. Raising front of tractor upon blocks or substantial support will also aid in replacement.

1. Remove the two hex head Heat Treated bolts (A), to detach old blade (B). ALWAYS USE HEAT TREATED BOLTS TO ATTACH BLADES.
2. Install new blade with SHARP EDGE DOWN and secure with two Heat Treated hex bolts and lockwashers. TIGHTEN SECURELY.
3. Check blades occasionally to make sure bolts in blades are tight.

cleaning mower

Raise front end of tractor using Sears riding tractor jack, or block up each front wheel. Be sure there is no way tractor can fall off blocks or jack. Place tractor in gear, and set parking brake. Clean underside of mower with a putty knife or similar tool. Mower may be removed from tractor for cleaning.

Water pressure from a garden hose will remove fresh clippings from underside of mower. Clean mower after each mowing.

daily maintenance

Make sure all nuts on bolts are tight and cotters spread. Keep blades sharp. Observe all safety precautions. Keep mower well lubricated.

YOUR TRACTOR MOWER IS A PRECISION PIECE OF POWER EQUIPMENT, NOT A PLAYTHING. THEREFORE, EXERCISE EXTREME CAUTION AT ALL TIMES.

Do not operate the tractor in high gear going down hill, and do not turn sharp corners while going down hill. If it is necessary to stop tractor while going down hill, do so quickly to prevent tractor from picking up speed during the de-clutching to braking operation. NOTE: The engine produces considerable braking action when throttled back to idling speed without de-clutching, and this procedure is recommended before applying brake.

3722R-7.2.73

to remove mower from tractor

1. Remove engine belt guard (M) Fig. 13.
2. Remove belt from engine pulley (O, Fig. 13).
3. Refer to Fig. 15. Remove spring retainer (Y) holding adjusting pin (X) to idler shaft assembly (F). Remove adjusting pin (X) from idler shaft assembly (F).
4. Refer to Fig. 14. Remove spring retainer (V) holding snubber pull rod (T) to snubber weldment (U), and remove snubber pull rod.
5. Refer to Fig. 12. Remove spring retainer from adjusting pin (N). Unhook spring (H), from idler frame (R), and front axle bracket (J), and remove idler shaft assembly (F), from front of tractor and place on ground between front wheels.
6. Lower mower by means of the lift lever (B), Fig. 9, to its extreme low position.
7. Pull four suspension arm plungers (A, Fig. 9), outward to detach mower from tractor.
8. Turn front wheels to left and, slide mower out from under R.H. side of tractor.
9. Belt tightener lever and hanger weldment (M, Fig. 7), must be removed from tractor when attaching a bulldozer. If tractor has a safety switch on belt tightener lever, just the lever may be removed. See tractor book for more details. L.H. front hanger (L, Fig. 6), and rear hanger weldment (N, Fig. 7), can be left on the tractor.

mower main drive belt

1. See Fig. 24. Remove belt guide (A), at center mandrel by removing 3 nuts (B).
2. Refer to Fig. 11. Remove nut and lockwasher from idler shaft assembly (F), and remove belt guide (K), and belt.
3. Install new belt and replace belt guides. Adjust guides for 1/16 to 1/8 inch clearance of belt when belt is tight and mower is in lowest cutting position. Then raise mower to highest cutting position and check belt guard to make certain it clears at top guide by 1/16 to 1/8 inch.

belt replacement

OUTER BLADES DRIVE BELT
(CENTER TO OUTER MANDRELS)

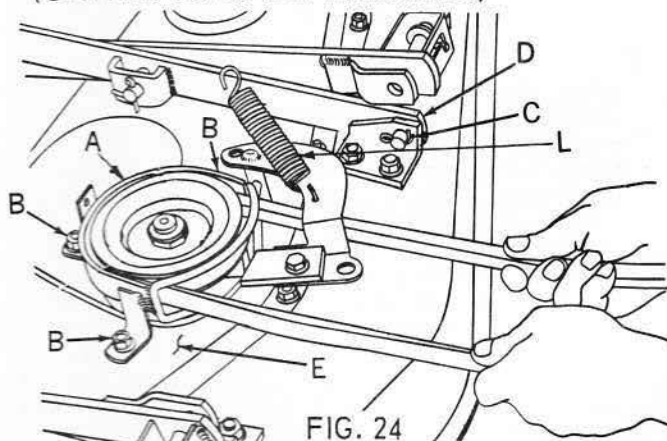

FIG. 24

1. Remove mower from tractor.
2. Unhook spring (L) from rear of belt guide (A). Remove belt guide (A), at center mandrel by

removing the three nuts (B) lockwashers, and flat washers.

3. Remove cotter pins (C), at front of lower suspension arms (D), and move suspension linkage outward and swing to rear--both R.H. and L.H. sides.
4. Remove mower deck drive cover (E).
5. Remove belt guide (No. 27, page 15), at L.H. mandrel sheave.
6. Remove old belt.
7. Clean away any dirt and grass which may have accumulated around sheaves and idler arm.

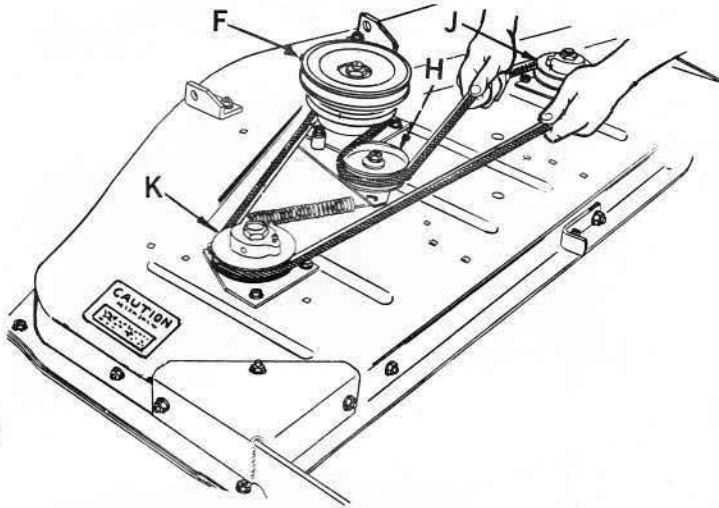

FIG. 25

8. Install new belt in lower groove of center mandrel (F), and around flat idler (H). From a position at discharge end of mower, grasp rearmost strand of belt in left hand and pull belt coming from idler (H), with right hand until it will go into groove of R.H. mandrel sheave (J).
9. Rotate center mandrel (F), by hand to make sure belt is running in the grooves properly.
10. Replace belt guide at L.H. mandrel (K), and adjust so that there is 1/16 to 3/32 inch clearance between it and the belt all around.
11. Replace mower deck drive cover (E).
12. With main drive belt in position, replace belt guide and snubber at center mandrel (F), and adjust so that there is 1/16 to 1/8 inch clearance between it and the sheave. Adjust drive belt and snubber.
13. Replace suspension arms in their original position and secure with cotter pins (C).

storage

Remove mower from tractor, before processing for winter storage. When mower is to be stored for a period of time, clean it thoroughly, remove all dirt, grass, leaves, etc. Give blades and underside of housing a good coat of grease or rust preventative. Store in a clean dry area.

Each mandrel should be filled annually with grease thru the zerk located between mower blade and underside of the mower housing. "Use high performance, extreme pressure lubricating grease, Amdex No. 1 EP (American Oil Co. - Standard Oil or equivalent). This grease may be obtained by ordering thru - your nearest Sears repair parts department. Part No. 2557R. Add grease until it is found out around the cap above the blade, or under the sheave. This will not damage the grease retainer.



SAFETY Pays Off

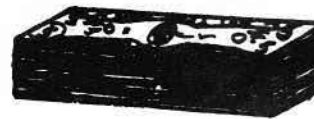

Sears, Roebuck and Co. or Simpsons-Sears Ltd. in Canada reserves the right to make any changes in design or improvements without imposing any obligation to install the same upon its items heretofore manufactured.

BECOME FULLY FAMILIAR WITH THE RULES FOR SAFETY AND INSTRUCTIONS IN THIS MANUAL. YOUR SEARS TRACTOR AND MOWER WILL PROVIDE MANY LEISURE HOURS.

repair parts 42" ROTARY MOWER--MODEL NUMBER 917.253250

another free manual from www.searstractormanuals.com

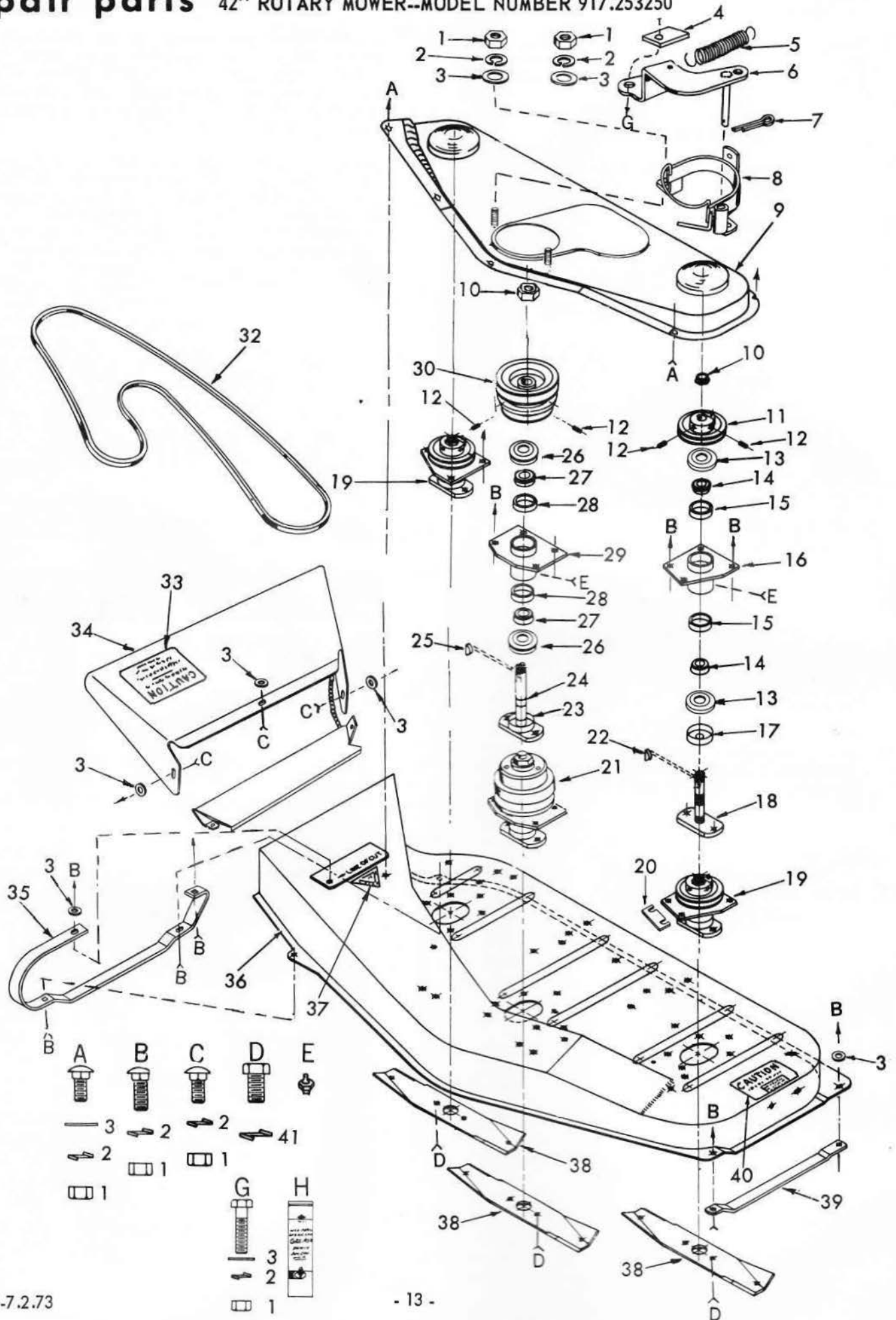

repair parts

42" ROTARY MOWER--MODEL NUMBER 917.253250

KEY NO.	PART NO.	DESCRIPTION	KEY NO.	PART NO.	DESCRIPTION
1	504P	Hex Nut 5/16-18	25	880R	Woodruff Key 1/4 x 1.7 H.T.
2	1003P	Lockwasher 5/16	26	882R	Metallic Seal 3.99
3	1537P	Washer 11/32 x 11/16 x 16 Ga.	27	9494H	Bearing Cone 7.99
4	2629R	Brake Shoe	28	888R	Bearing Cup
5	3770R	Spring	29	634A427	Mandrel Tube & Cups- <i>NOT</i>
6	<i>634</i> 623A590	Snubber Weldment	30	634A481	Mandrel Sheave-Center w/Set Screw
7	2503P	Cotter Pin 3/32 x 3/4	32	3716R	V-Belt (Center to Outer Mandrels)
8	<i>634</i> 623A588	Belt Guide Weldment-Center	33	3538R	Deflector-Caution Decal
9	634A482	Deck Drive Cover & Weld Bolts	34	634A498	Deflector Shield w/Chain Runner R.H.
10	4831H	Elastic Stop Nut 3/4-16	35	3724R	Mower Housing
11	634A417	Mandrel Sheave-Outer w/Set Screws	36	3863R	Safety Standards Sticker
12	4515P	Hex Socket Headless Set Screw 3/8-16 x 5/8	37	3239R	Blade
13	881R	Metallic Seal	38	9484H	Runner L.H.
14	1554H	Bearing Cone	39	2070R	Instruction-Caution Decal
15	1553H	Bearing Cup	40	3539R	Lockwasher 7/16
16	634A431	Mandrel Tube & Cups Outer	41	1001P	Carriage Bolt 5/16-18 x 3/4
17	9458H	Mandrel Cap	A	16P	Carriage Bolt 5/16-18 x 1
18	634A315	Shaft & Flange-Outer	B	17P	Carriage Bolt 5/16-18 x 3/4
19	634A423	Mandrel Assembly <i>NOT</i> w/Sheave Outer	C	16P	Hex Bolt 7/16 x 14 x 3/4
20	739R	Mandrel Shim-L.H.	D	3204P	H.T. Grade 5 Grease Fitting
21	634A485	Mandrel Assembly w/Sheave-Center	E	6855M	Hex Bolt 5/16-18 x 1
22	8330H	Woodruff Key 1/4-1 H.T.	G	3011P	Amdex No. 1 E.P.
23	1036R	Mandrel Cap Center	H	2557R	Grease Not Furnished with Mower (For Service Only)
24	634A426	Shaft & Flange-Center <i>49.39</i>			

248.00
No 36 Part 3863R

another free manual from www.searstractormanuals.com

repair parts

42" ROTARY MOWER--MODEL NUMBER 917.253250

KEY NO.	PART NO.	DESCRIPTION	KEY NO.	PART NO.	DESCRIPTION
1	634A339	Lever Plunger & Button	32	2289R	Discharge Cutoff Plate
2	9465M	Roll Pin 3/16 x 1½	33	3544R	Suspension Bracket- Front L.H.
3	2876H	Spring	33A	3543R	Suspension Bracket- Front R.H.
4	1556P	Washer 13/32 x 7/8 x 14 Ga.	34	2073R	Wheel Support R.H.
5	634A373	Lift Lever	35	3714R	Model Plate
5A	1053R	Decal	36	1556P	Washer 13/32 x 7/8 x 14 Ga.
6	2895H	Handle Grip	37	7375H	Bushing
7	280M1	Bushing	38	9536H	Gauge Wheel
8	634A358	Pitch Adjustment Weldment	39	634A329	Blade Shield Assembly
9	9426H	Bracket	40	634A480	Gauge Wheel Support Assy. L.H.
10	515P	Hex Nut 3/8-24	41	1004P	Lockwasher 3/8
11	9420H	Leveling Pin	42	501P	Hex Nut 3/8-16
12	2511P	Cotter Pin 3/16 x 1	43	1003P	Lockwasher 3/8-16
13	634A345	Suspension Arm Weldment Outer	44	504P	Hex Nut 5/16-18
14	634A344	Suspension Arm Weldment Inner R.H.	45	1556P	Washer 13/32 x 7/8 x 14 Ga.
15	634A479	Lift Shaft Weldment	46	508P	Hex Jam Nut 3/8-16
16	929R	Lift Link	47	1537P	Washer 11/32 x 11/16 x 16 Ga.
17	9412H	Hanger Link	A	21P	Sq. Neck Carriage Bolt 3/8-16 x 1¼
18	2505P	Cotter Pin 1/8 x 3/4	B	3023P	Hex Bolt 3/8-16 x 1
19	9535H	Spring	C	20P	Sq. Neck Carriage Bolt 3/8-16 x 1
20	9833E	Bushing	D	28P	Carriage Bolt Short Shoulder 3/8-16 x 1 Grade 5 H.T.
21	9505H	Elastic Stop Nut 3/8-24	E	3025P	Hex Bolt 3/8-16 x 1¼
22	634A343	Suspension Arm Weldment Inner L.H.	F	16P	Sq. Neck Carriage Bolt Short Shoulder 5/16-18-3/4
23	1500P	Washer 17/32 x 1-1/16 x 13 Ga.	G	3027P	Hex Bolt 3/8-16 x 1½
24	3720R	Spring	H	7P	Carriage Bolt 5/16-18 x 2½
25	9416H	Plunger	J	16P	Carriage Bolt 5/16-18 x ¾
26	9504H	Roll Pin 3/16 x 2	K	3199P	Hex Bolt 3/8-24 x 2¾ Grade 5
27	634A334	Belt Guide Assembly	L	17P	Carriage Bolt 5/16-18 x 1
28	634A477	Idler Assembly	---	3722R	Owners Manual
29	9503H	Spring			
30	2083R	Flat Idler			
31	4969H	Bushing			

another free manual from www.searstractormanuals.com

repair parts

42" ROTARY MOWER--MODEL NUMBER 917.253250

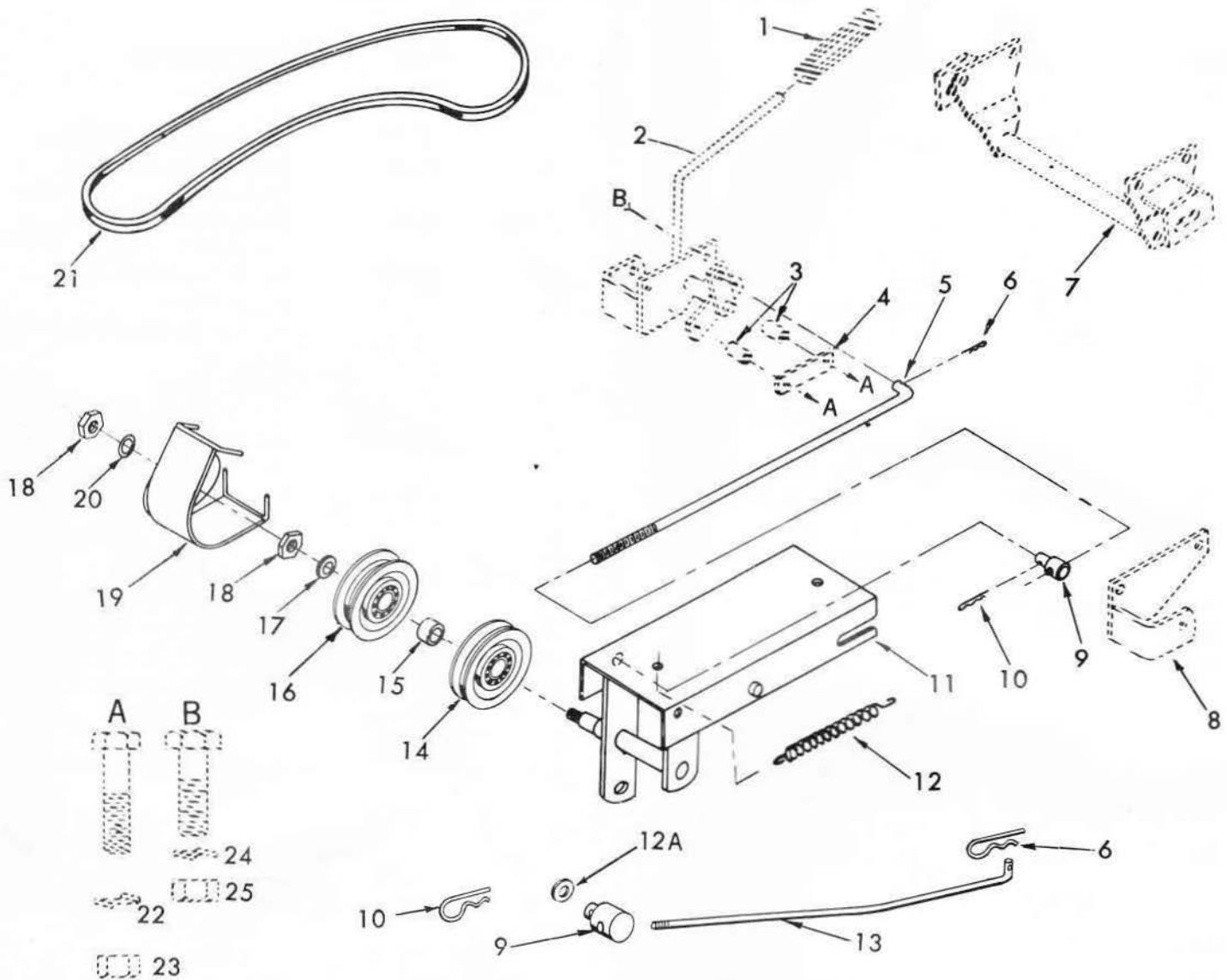

Items shown in phantom do not come with the mower. If you have a tractor that does not have these items mounted on tractor, you will have to purchase these items separately.

KEY NO.	PART NO.	DESCRIPTION	KEY NO.	PART NO.	DESCRIPTION
1	4379H	Handle Grip	13	3766R	Snubber Pull Rod
2	634A357	Lever and Hanger Weldment	14	634A565	Inside Idler
3	1689E	Bushing	15	5386H	Bushing
4	6508H	Lever Stop Strap	16	634A566	Outside Idler
5	3705R	Belt Tightener Link	17	1519P	Washer 15/32 x 1 x 12 Ga.
6	4939M	Retainer Spring	18	516P	Hex Nut 7/16-20
7	634A362	Hanger Rear (For 1966 and Later Suburban Tractors)	19	634A587	Belt Guide Weldment-Front
7	634A363	Hanger Rear (For Hydro Trac Tractor)	20	1001P	Lockwasher 7/16
8	634A355	Hanger Front Weldment L.H. Front	21	3555R	V-Belt (Mower Main Drive Belt)
9	3707R	Adjusting Pin	22	1003P	Lockwasher 5/16
10	4940M	Retainer Spring	23	504P	Hex Nut 5/16-18
11	634A589	Idler Shaft Assembly	24	1004P	Lockwasher 3/8
12	9503H	Spring	25	501P	Hex Nut 3/8-16
12A	1569P	Washer 9/16 x 15/16 x 11 Ga.	A	3013P	Hex Bolt 5/16-18 x 1 1/2
			B	3025P	Hex Bolt 3/8-16 x 1 1/4

notes

634x138

another free manual from www.searstractormanuals.com

Sears

owners manual

The Model Number will be found on a plate attached to the top of the Gauge Wheel Support Assembly L.H. Always mention the Model Number when requesting service or repair parts for your 42" ROTARY MOWER.

All parts listed herein may be ordered through SEARS, ROEBUCK AND CO. or SIMPSONS-SEARS LIMITED. When ordering parts by mail, selling prices will be furnished on request or parts will be shipped at prevailing prices and you will be billed accordingly.

WHEN ORDERING REPAIR PARTS, ALWAYS GIVE THE FOLLOWING INFORMATION AS SHOWN IN THIS LIST.

1. The PART NUMBER
2. The PART DESCRIPTION
3. The MODEL NUMBER
917.253250
4. The NAME OF ITEM—
Rotary Mower



When you buy merchandise from Sears you get an extra something that nobody else can offer . . . Sears Service.

Across town or across the country, wherever you live or move in the U.S.A., Sears Service follows you, providing trustworthy, competent service technicians using only Sears specified factory parts.

SEARS SERVICE
IS AT YOUR SERVICE
WHEREVER YOU LIVE
OR MOVE
IN THE U.S.A.

Sears, Roebuck and Co., Chicago, Ill. 60607 U.S.A.
and Simpsons Sears Limited, Toronto