



**MODEL NO.
917.253311**

OWNER'S MANUAL

**Assembly
Operation**

**Maintenance
Repair Parts**

46 INCH DOZER BLADE

**ATTACHMENT
FOR SEARS
GARDEN TRACTORS**

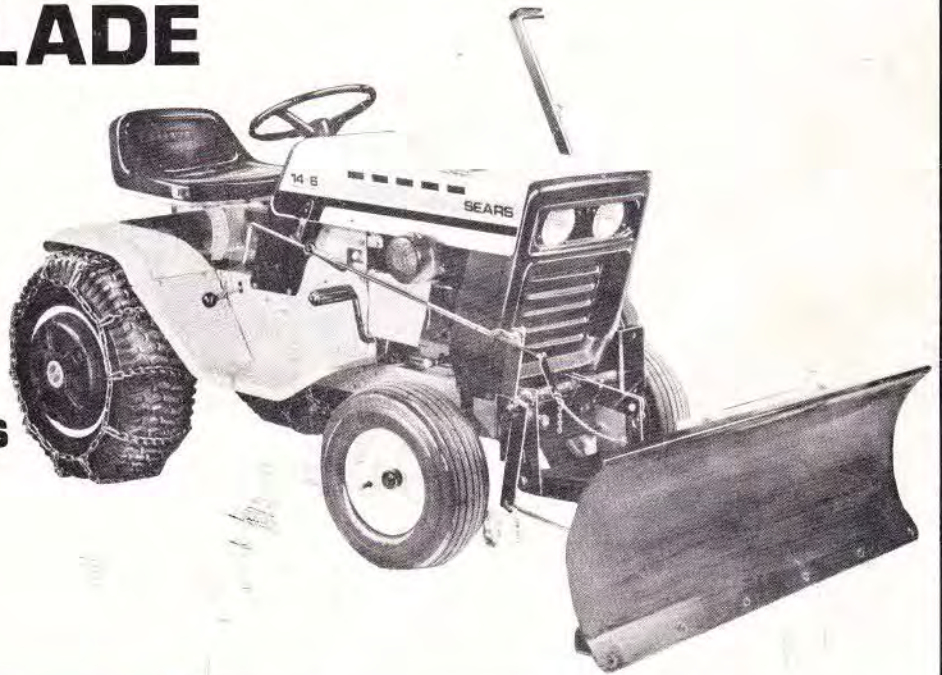

**IMPORTANT:
READ RULES FOR
SAFE OPERATION
AND INSTRUCTIONS
CAREFULLY**

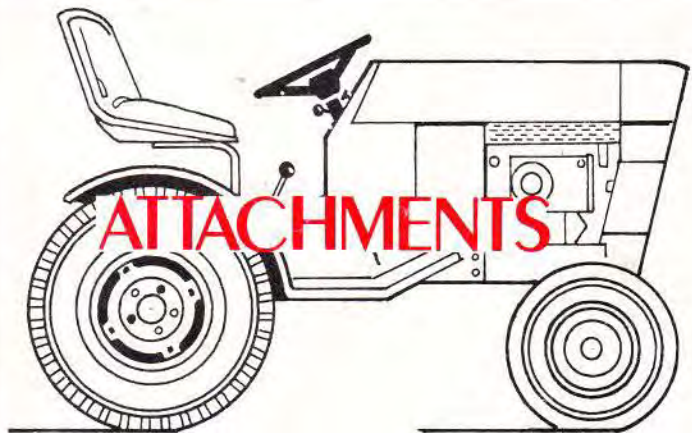

another free manual from www.searstractormanuals.com

TABLE OF CONTENTS

ASSEMBLY INSTRUCTIONS	1	MAINTENANCE INSTRUCTIONS	4
OPERATION INSTRUCTIONS	4	REPAIR PARTS	5

WARRANTY

FULL ONE YEAR WARRANTY

For one year from date of purchase, Sears will repair any defect in material or workmanship in this tractor attachment, at no charge.

If the tractor attachment is used for commercial or rental purposes, this warranty applies for only thirty days from date of purchase.

Warranty service is available by simply contacting your nearest Sears store throughout the United States.

This warranty gives you specific legal rights, and you may have other rights which vary from state to state.

SEARS, ROEBUCK AND CO.

Sears Tower

BSC 41-3

Chicago, IL 60684

RULES FOR SAFE OPERATION

1. Know the controls and how to stop quickly. READ THE OWNER'S MANUAL.
2. Do not allow children to operate the vehicle. Do not allow adults to operate it without proper instruction.
3. Do not carry passengers. Keep children and pets a safe distance away.
4. Always wear substantial footwear. Do not wear loose fitting clothing that could get caught in moving parts.
5. Keep your eyes and mind on your tractor, mower and the area being cut. Don't let other interests distract you.
6. Do not attempt to operate your tractor or mower when not in drivers seat.
7. Always get on or off your tractor from the operators left hand side.
8. Clear the work area of objects which might be picked up and thrown.
9. Disengage all attachment clutches and shift into neutral before attempting to start the engine.
10. Disengage power to attachments and stop the engine before leaving the operator's position.
11. Disengage power to mower, stop the engine and disconnect spark plug wire(s) from spark plug(s) before cleaning, making an adjustment or repairs.
12. Disengage power to attachments when transporting or not in use. Drive slowly when front or rear mounted attachment is in transport position.
13. Take all possible precautions when leaving the vehicle unattended, such as disengaging the power-take-off, lowering the attachments, shifting into neutral, setting the parking brake, stopping the engine, and removing the key.
14. Do not stop or start suddenly when going uphill or downhill. Mow up and down the face of slopes (not greater than 15°); never across the face.
15. Reduce speed on slopes and make turns gradually to prevent tipping or loss of control. Exercise extreme caution when changing direction on slopes.
16. Do not shift gears while going up or down slopes. Choose a gear low enough to negotiate the slope without stopping and shifting gears. To reduce speed, move throttle lever to slow.
17. Never mow in wet or slippery grass, when traction is unsure or at a speed which could cause a skid.
18. Stay alert for holes in the terrain and other hidden hazards.
19. Do not drive too close to creeks, ditches and public highways.
20. Exercise special care when mowing around fixed objects in order to prevent the blades from striking them. Never deliberately run tractor or mower into or over any foreign object.
21. Never shift gears until tractor comes to a stop.
22. Never place hands or feet under the mower, in the deflector (discharge chute) or near any moving parts while tractor or mower are running. Always keep clear of discharge chute.
23. Use care when pulling loads or using heavy equipment.
 - a. Use only approved drawbar hitch points.
 - b. Limit loads to those you can safely control.
 - c. Do not turn sharply. Use care when backing.
 - d. Use counterweights or wheel weights and tire chains when suggested in this owner's manual.
 - e. Never run Dozer Blade into heavy material at high speeds. It was designed for light work and should not be used for heavy dozing.
24. Watch out for traffic when crossing or near roadways.
25. When using any attachments, never direct discharge of material toward bystanders nor allow anyone near the vehicle while in operation.
26. Handle gasoline with care - it is highly flammable.
 - a. Use approved gasoline containers.
 - b. Never remove the cap of the fuel tank or add gasoline to a running or hot engine, or fill the fuel tank indoors. Wipe up spilled gasoline.
 - c. Open doors if the engine is run in the garage - exhaust fumes are dangerous. Do not run the engine indoors.
27. Keep the vehicle and attachments in good operating condition, and keep safety devices in place. When using Three Point Hitch remove attachment from hitch before making any repairs on attachment or hitch.
28. Keep all nuts, bolts and screws tight, all cotter pins and retainer springs in place to be sure the equipment is in safe working condition.
29. Never store the equipment with gasoline in the tank inside a building where fumes may reach an open flame or spark. Allow the engine to cool before storing in any enclosure.
30. To reduce fire hazard, keep the engine free of grass, leaves or excessive grease.
31. The vehicle and attachments should be stopped and inspected for damage after striking a foreign object, and the damage should be repaired before restarting and operating the equipment.
32. Do not change the engine governor settings or overspeed the engine.
33. When using the vehicle with mower, proceed as follows:
 - a. Mow only in daylight or in good artificial light.
 - b. Never make a cutting height adjustment while the engine is running if the operator must dismount to do so.
 - c. Shut the engine off when removing the grass catcher or unclogging chute.
 - d. Check the blade mounting bolts for proper tightness at frequent intervals.
34. Check the grass catcher bags frequently for wear or deterioration. Replace with new bags for safety protection.



LOOK FOR THIS SYMBOL TO POINT OUT IMPORTANT SAFETY PRECAUTIONS. IT MEANS--ATTENTION! BECOME ALERT! YOUR SAFETY IS INVOLVED.

YOUR DOZER BLADE MUST BE ATTACHED WITH FRONT MOUNTING BRACKET 25314 OR 25317.

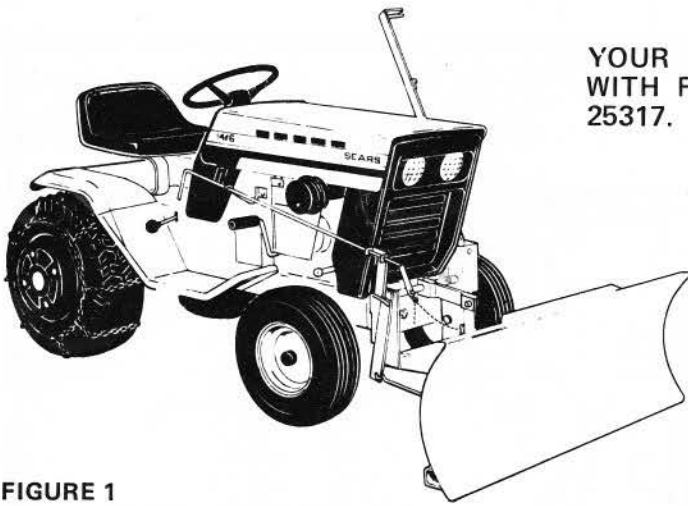

FIGURE 1
ASSEMBLY

1. Remove shipping wires, channel, blade, and lever assemblies and Bag of Parts from carton.

To assemble your Dozer you will need:

- | | |
|---------------------|------------------------|
| (2) 1/2" Wrenches | (1) 5/32" Allen Wrench |
| (2) 9/16" Wrenches | (1) Pliers |
| (2) 15/16" Wrenches | (1) Hammer |

NOTE: Right Hand (R.H.) and Left Hand (L.H.) are determined from operator's position.

IF YOUR TRACTOR IS A ONE-PIECE REAR FENDER MODEL SHOWN IN FIG. 1, BEGIN ASSEMBLY WITH STEP 2.

- OR -

IF YOUR TRACTOR IS A TWIN CYLINDER MODEL, BEGIN ASSEMBLY WITH STEP 3.

- OR -

FOR ALL OTHER TRACTOR MODELS, BEGIN ASSEMBLY WITH STEP 4.

2. Assemble Control Rod Guide (shipped in Bag of Parts) to Tractor using:

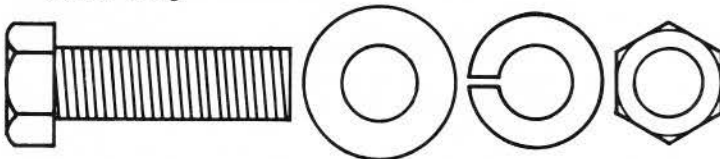

Hex Bolt, Flat Washer, Lockwasher and Hex Nut (shown full size above) found in Bag of Parts.

- a. Remove Engine Pulley Cover (Fig. 2).
 - b. Insert Hex Bolt through Chassis Channel from the inside.
 - c. Place Control Rod Guide, Flat Washer, Lockwasher and Hex Nut on Bolt and tighten securely.
 - d. Replace Engine Pulley Cover and Complete Dozer assembly starting with step 5, page 2.
3. Assemble Control Rod Guide to Tractor:
 - a. Remove Cover (Fig. 3).
 - b. Loosen Muffler Guard Bracket Bolt.
 - c. Place Control Rod Guide on Bolt between Flat Washer and Bracket and tighten securely.
 - d. Replace Cover and complete Dozer assembly starting with step 5, page 2.
 4. Assemble Control Rod Guide to Tractor:
 - a. Remove Cover (Fig. 4).
 - b. Loosen Hex Bolt.
 - c. Place Control Rod on Bolt between Flat Washer and Chassis Channel and tighten securely.
 - d. Replace Cover and complete Dozer assembly starting with step 5, page 2.

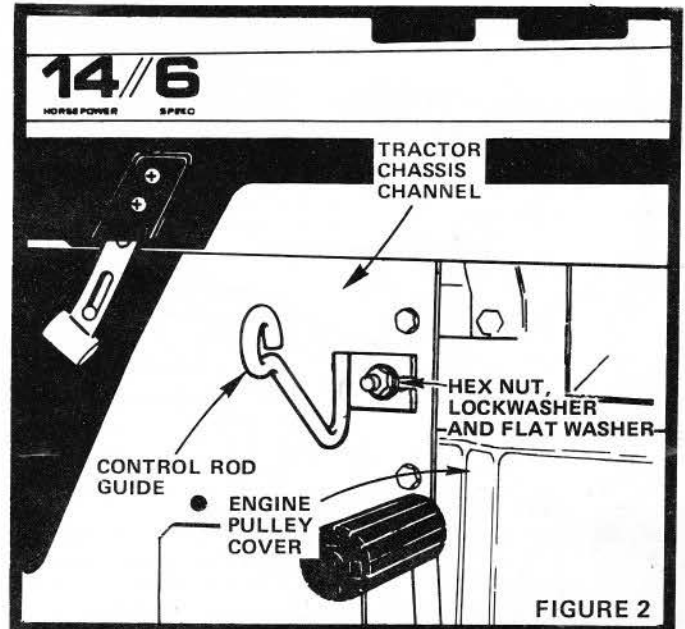

FIGURE 2

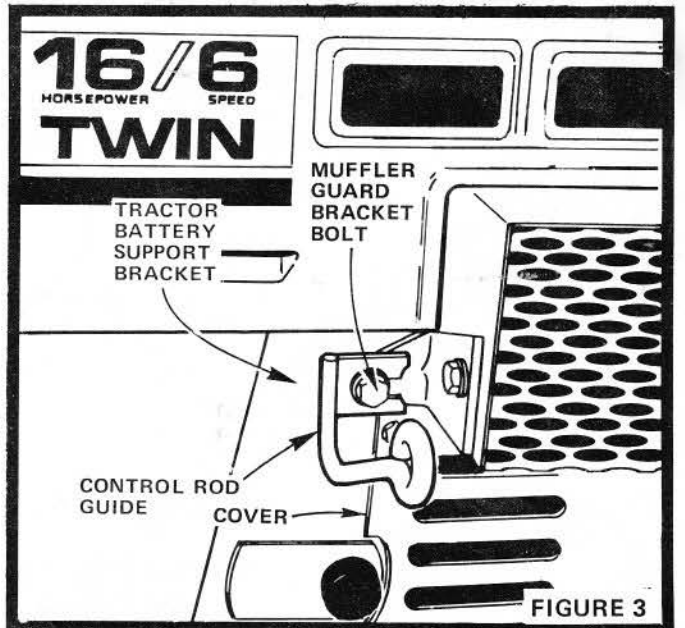

FIGURE 3

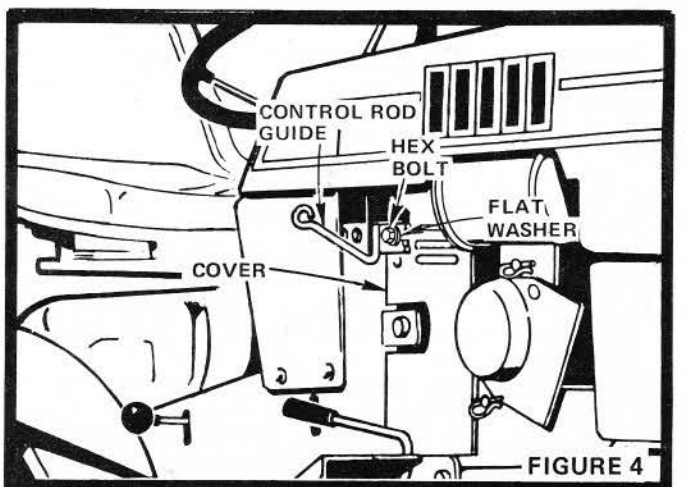

FIGURE 4

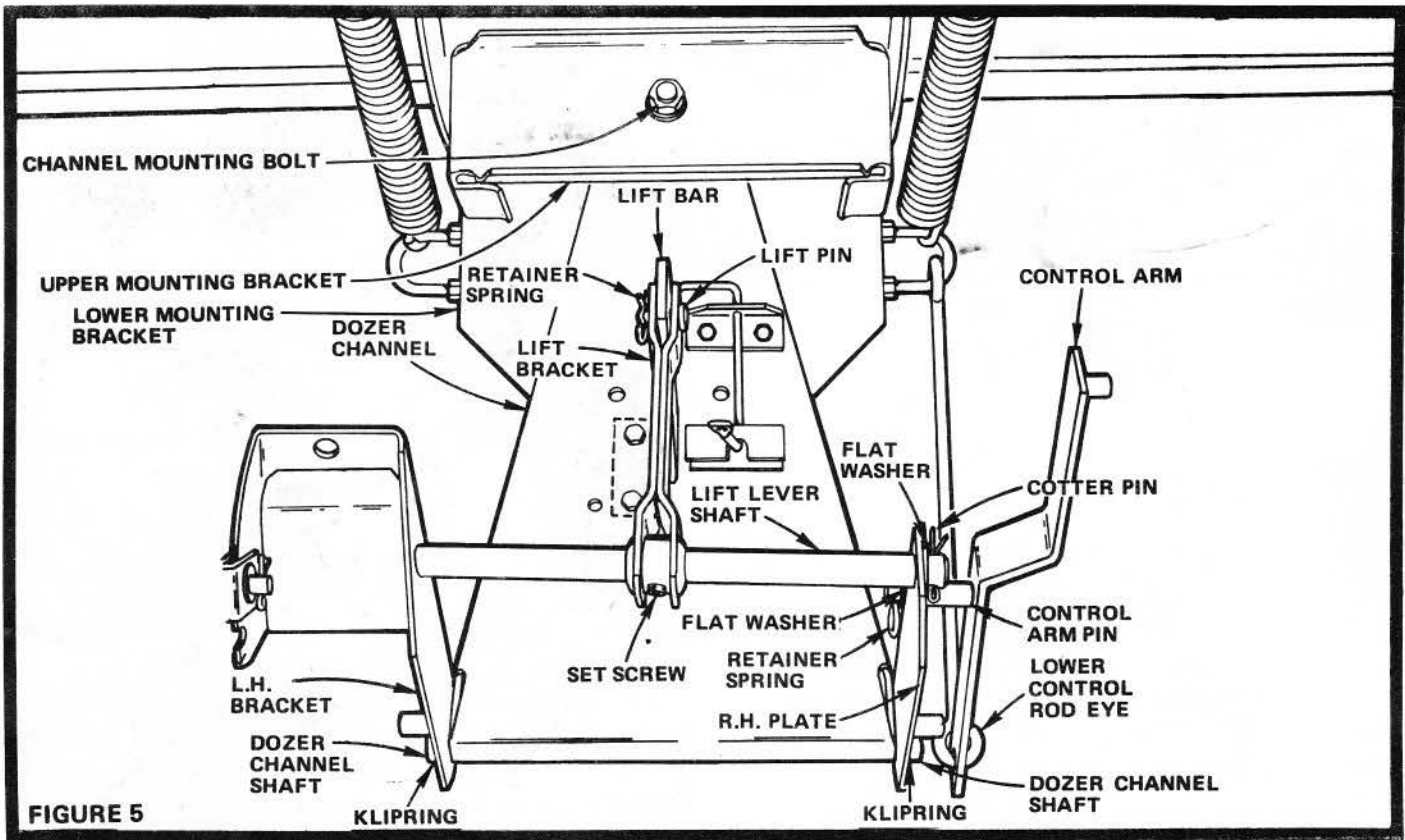
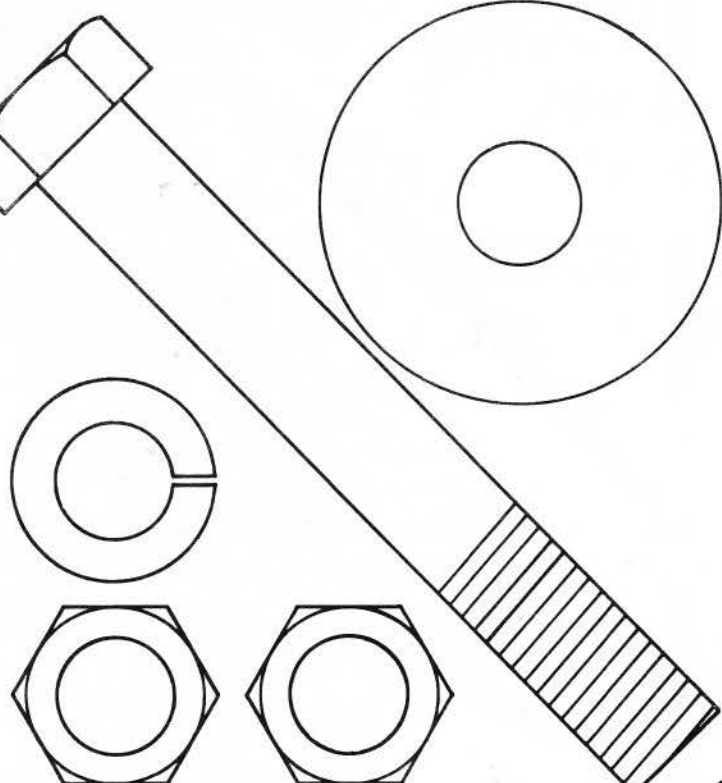

FIGURE 5

5. Assemble Dozer Channel to Mounting Bracket using:



Hex Bolt, Flat Washer, Lockwasher and two Hex Nuts (shown full size above) found in Bag of Parts.

- Start Hex Bolt from under Lower Mounting Bracket just far enough to hold Flat Washer on top side of Lower Mounting Bracket.
- Insert Dozer Channel between Upper and Lower Mounting Brackets and slide Hex Bolt through.
- Add Lockwasher and one Hex Nut and tighten securely (Back Nut off slightly if necessary to allow Channel to rotate freely).
- Add second Hex Nut and tighten securely.

6. Assemble R.H. Plate and L.H. Bracket to ends of Dozer Channel Shaft using:



two Kliprings (shown full size above) found in Bag of Parts (Fig. 5).

7. Assemble Lift Lever Shaft to R.H. Plate using:

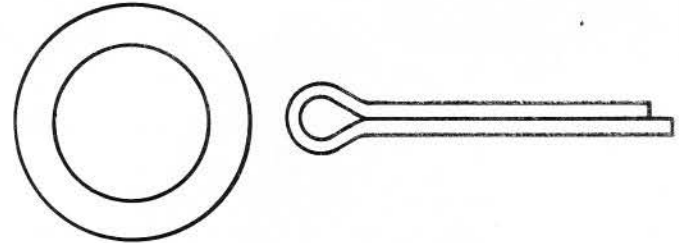

Flat Washer and Cotter Pin (shown full size above) found in Bag of Parts. Swing R.H. Plate up and position on Lift Lever Shaft, place Flat Washer over shaft and secure with Cotter Pin.

8. Assemble Lift Bracket on Lift Bar using:



Lift Pin and Retainer Spring (shown full size above) found in Bag of Parts. Insert Lift Pin through Lift Bracket holes and Lift Bar slot and secure with Retainer Spring (Fig. 5).

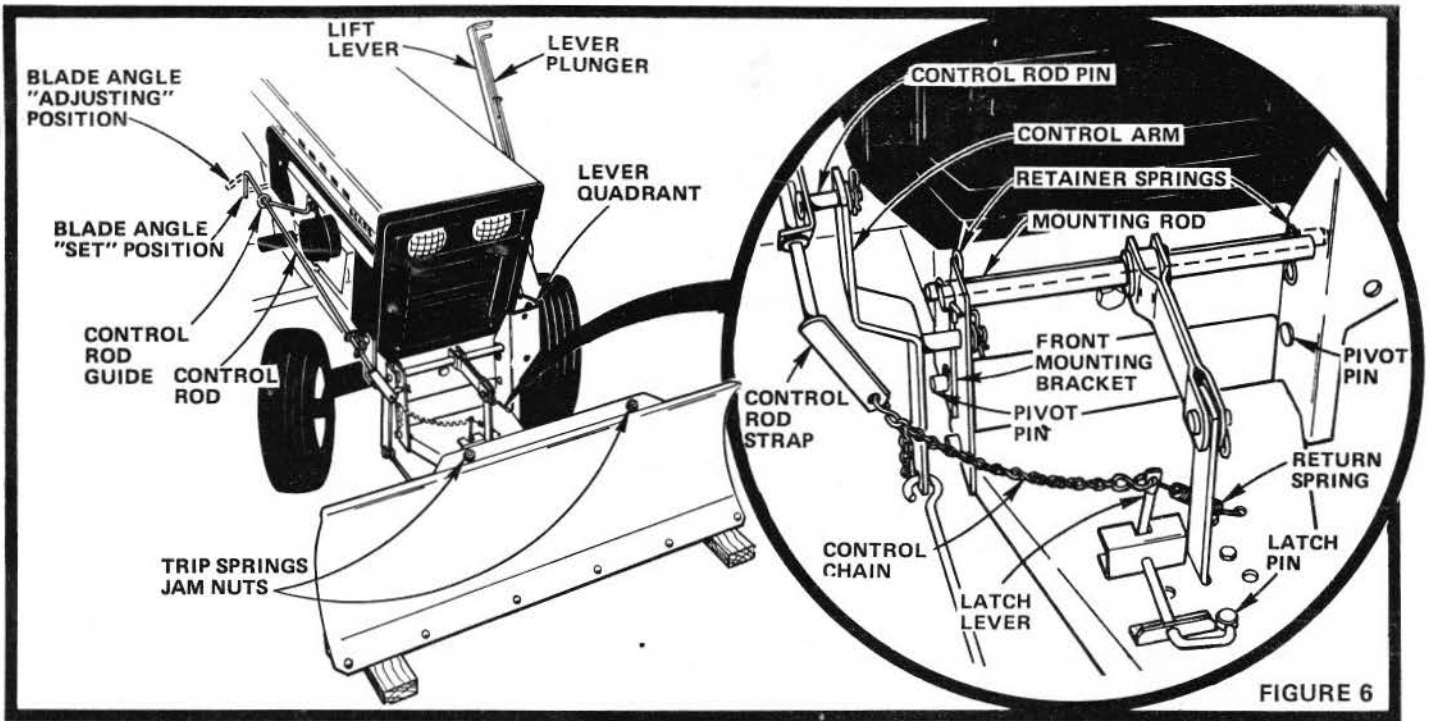

FIGURE 6

10. Assemble Control Arm to R.H. Plate using:



Flat Washer and Retainer Springs (shown full size above) found in Bag of Parts. Insert Control Arm Pin into R.H. Plate, place Flat Washer on Pin and secure with Retainer Spring (Fig. 5).

11. If necessary, loosen Set Screws to position Lift Bracket on Lift Lever Shaft so that Bracket lines up with Lift Bar. Tighten both Set Screws securely.
12. Place a 2 x 4 or similar object flatwise beneath each end of Blade (Fig. 6).
13. Insert Pivot Pins of R.H. Plate and L.H. Bracket into Front Mounting Bracket slots (Fig. 6 - Inset).
14. Turn front tractor wheels to the right to assemble Mounting Rod and Retainer Spring (furnished with Front Mounting Bracket) thru holes in R.H. Plate, L.H. Bracket and Front Mounting Bracket. Secure with Retainer Springs to the inside (Fig. 6 - Inset).
15. Install Control Rod using:

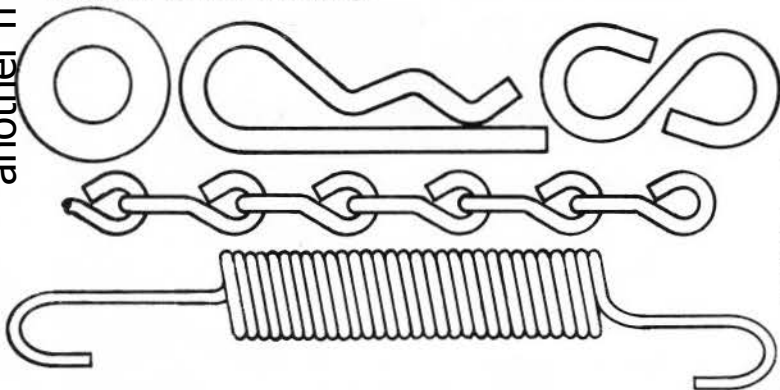

- Flat Washer, Retainer Spring, two Hooks, Control Chain, and Return Spring found in Bag of Parts.
- a. Insert Control Rod into eye of Control Rod Guide (Fig. 6).
 - b. Place Control Rod Pin into Control Arm Bushing, place washer over Pin and secure with Retainer Spring (Fig. 6 - Inset).
 - c. Assemble two Hooks into Latch Lever and Control Rod Strap (Fig. 6 - Inset).
 - d. Connect Control Chain to hooks (Fig. 6 - Inset).
 - e. Assemble Return Spring to Latch Lever and Dozer Channel (Fig. 6 - Inset).

16. Remove 2 x 4's from beneath Blade.
17. Adjust Control Chain.
 - a. With Control Rod handle in Blade Angle "Set" Position (Fig. 6). Chain must be long enough to allow Return Spring to pull Latch Pin into Blade Angle Adjustment holes directly below (Fig. 6 - Inset).
 - b. With Control Rod handle in Blade Angle "Adjusting" Position (Fig. 6), Chain must be short enough to pull Latch Pin from Blade Angle Adjustment holes (Fig. 6 - Inset).
18. Tighten Jam Nuts shipped on Trip Spring Bolts until a slight spring tension is achieved and enough threads are exposed to add:

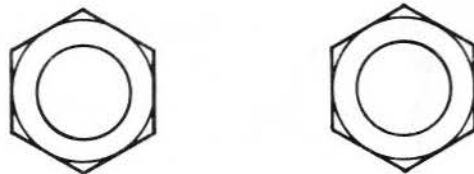

Jam Nuts (shown full size above) found in Bag of Parts. Tighten securely.

ADJUSTMENTS

1. LIFT BLADE

Lift Blade from ground before changing blade angle or transporting.

- a. Squeeze Lever Plunger (Fig. 6).
- b. Move Lever to Lowest position on Lever Quadrant and release Plunger to hold this position.

2. ANGLE BLADE

There are five blade positions; straight ahead, and two distinct angles to the right or left. ALWAYS LIFT BLADE FROM GROUND TO CHANGE ANGLE PREVENTING STRAIN ON ANGLE CONTROL LINKAGE.

- a. Turn Control Rod to Blade Angle "Adjusting" Position (Fig. 6).
- b. Push or Pull Rod to desired angle.
- c. Turn Control Rod to Blade Angle "Set" Position. Make sure Latch Pin catches in one of the five Blade Angle Adjusting Holes (Fig. 6 - Inset).

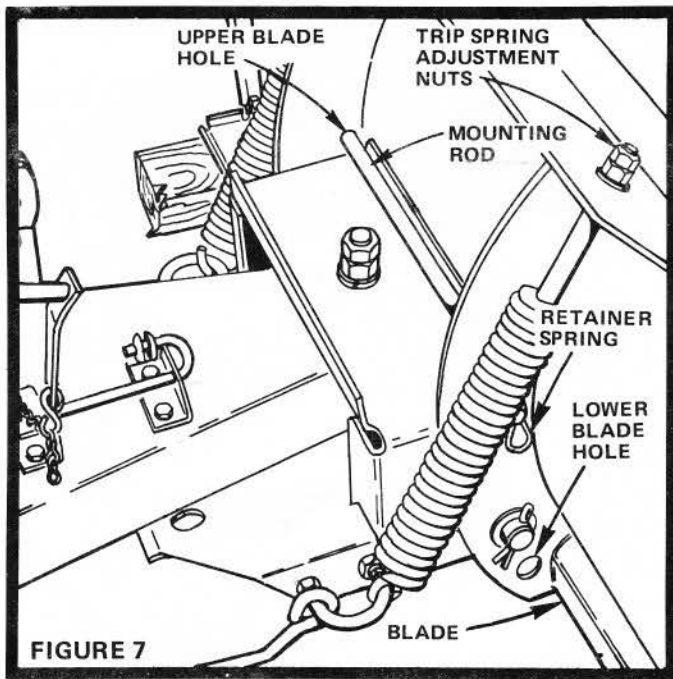

FIGURE 7

3. IMPROVE TRACTION

Wheel weights and tire chains should be used with your Dozer Blade to improve traction. These accessories are available at your nearest Sears store or catalog desk.

4. ADJUST TRIP SPRING

Trip Springs have been adjusted at the factory to provide only a slight tension which is all that is normally necessary. To change spring tension, adjust the nuts at the upper end of the Trip Springs (Fig. 7).

5. ADJUSTMENT TO SMOOTH OR UNEVEN SURFACES

Blade Shoes on ends of blade may be positioned at "0" Mark for close dozing on smooth surfaces (Fig. 8) or moved to "1" or "2" Inch Mark which will raise the Blade to work on rough or uneven areas. Make sure both Shoes are set evenly and Nuts tightened securely.

6. ADJUST TO SNOW OR SAND/GRAVEL REMOVAL

Your Dozer Blade has been designed primarily for light work such as snow removal, but it will also work satisfactorily, if carefully used, in light soil, sand or similar material.

- a. When moving snow or other light material, place the Mounting Rod in the Lower Blade Hole (Fig. 7). This frees the Blade to spring trip and return if a heavy obstacle is encountered.



KNOW THE TERRAIN. AVOID EXCEPTIONALLY SHARP SLOPES OR DROP OFFS WHICH MAY BE HIDDEN BY THE SNOW.

- b. When heavier material must be moved place the Mounting Rod in the Upper Blade Hole (Fig. 7). This places the blade in rigid operating position.



NEVER RUN THE BLADE INTO HEAVY MATERIAL AT HIGH SPEED.

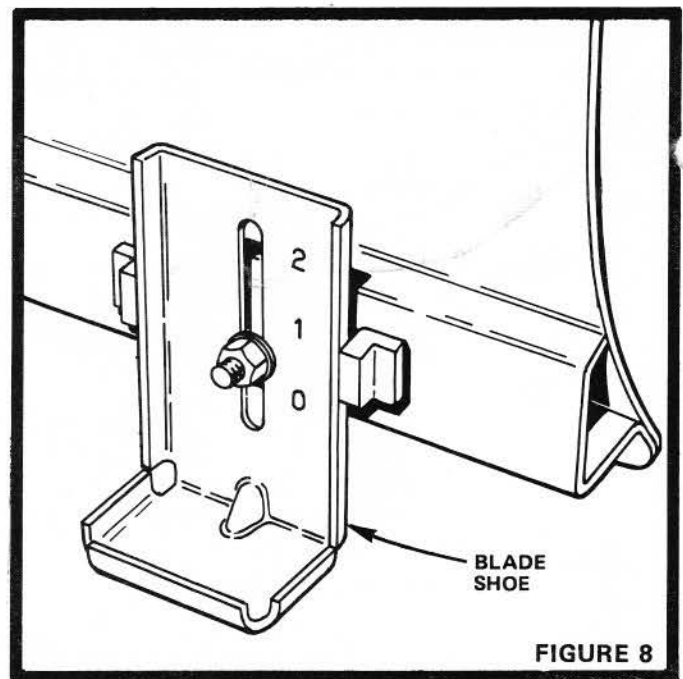

FIGURE 8

OPERATION



INSPECT THE AREA TO BE WORKED CAREFULLY BEFORE OPERATING THE DOZER BLADE. AVOID PIPES, ROOTS, CURBS OR OTHER HEAVY OBSTRUCTIONS.

1. Start tractor engine and raise the blade to the highest "transport" position. Move blade to desired angle and lower blade to ground.
2. Shift the Hi-Lo Range Shift Lever to Low Range, the Tractor Shift Lever to Low and ease into the material to be moved. Increase tractor speed gradually to suit working conditions and operation being performed.



ALWAYS LOWER BLADE TO GROUND BEFORE LEAVING TRACTOR.

LUBRICATION

No lubrication is required other than occasional oiling of pivot points if they do not work freely.

TO REMOVE DOZER BLADE FROM TRACTOR

1. Remove Hook with Chain attached from Control Rod (Fig. 6).
2. Remove Retainer Spring and Washer from Control Rod Pin and remove Control Rod from Control Arm (Fig. 6).
3. Remove Control Rod from eye of Control Rod Guide (Fig. 6).
4. Turn tractor front wheels to the right.
5. Remove Retainer Springs from Mounting Rod (Fig. 6). Remove Rod from Front Mounting Bracket.

STORAGE

When the Dozer is not being used, remove all dirt and rust and touch up with paint.

Apply a light coat of grease or rust preventative to the blade and grease pivot points.

- 4 - Store in an area where it is protected from weather.

REPAIR PARTS

DOZER BLADE--MODEL NUMBER 917.253311

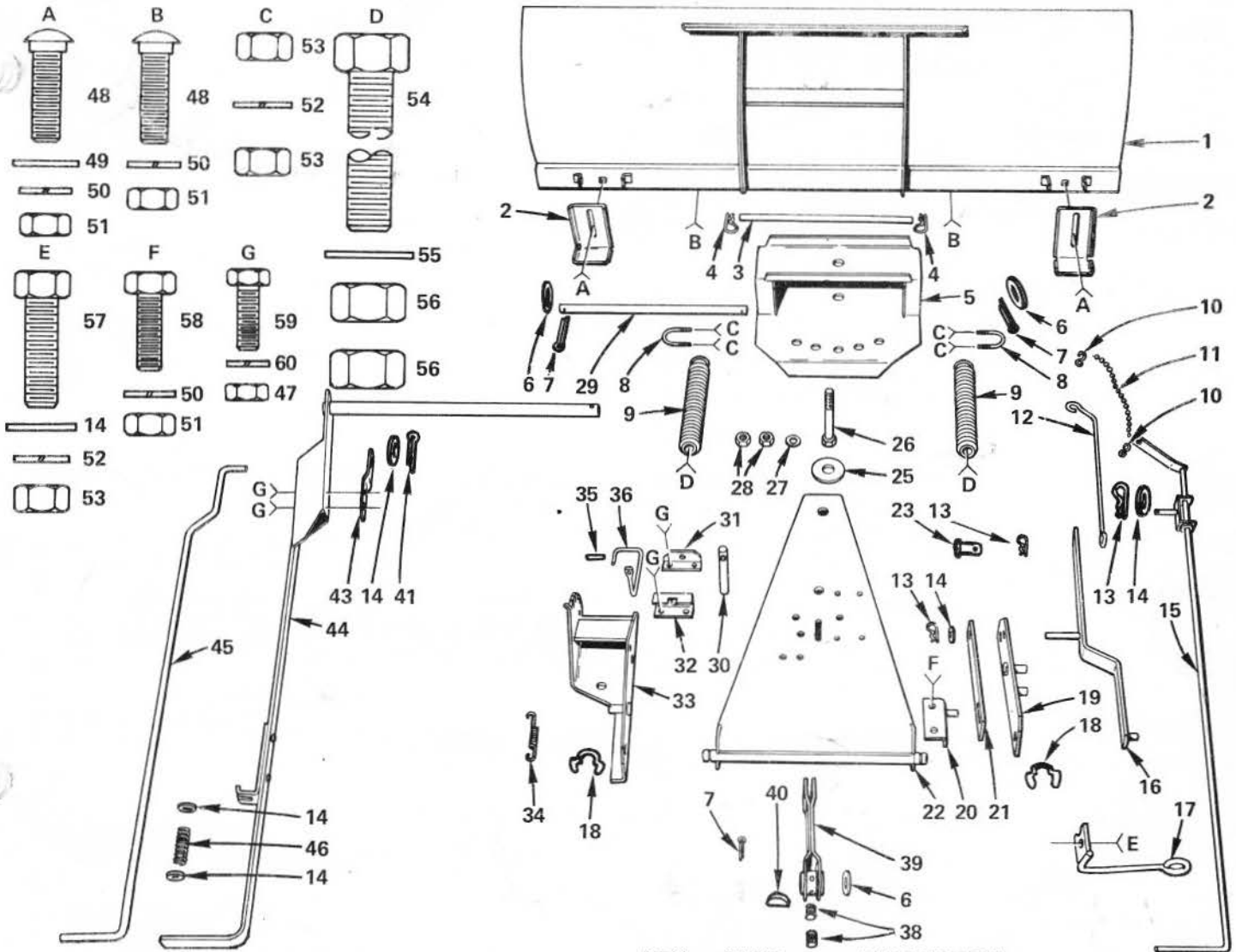

KEY NO.	PART NO.	DESCRIPTION
1	673A72	Blade Weldment
2	9359R	Shoe
3	9273R	Mounting Rod
4	4941M	Retainer Spring
5	673A71	Mounting Brackets Upper and Lower
6	1590P	Washer 27/32 x 1 - 1/4 x 16 Ga.
7	2521P	Cotter Pin 3/16 x 1 - 1/2
8	9463R	U-Bolt
9	9466R	Trip Spring
10	9464R	"8" Hook
11	70J	Control Chain
12	9440R	Control Rod Lower
13	4939M	Retainer Spring
14	STD551037	*Washer 13/32 x 13/16 x 16 Ga.
15	673A90	Control Rod Weldment
16	673A88	Control Arm Weldment
17	673A101	Control Rod Guide
18	5845R	Klipring
19	673A83	Plate Weldment - R.H.
20	673A87	Pin and Bracket Weldment
21	9451R	Lift Bar
22	673A73	Channel Weldment
23	9462R	Drilled Lift Pin
25	1570P	Washer 21/32 x 2 - 1/8 x 16 Ga.
26	3050P	Hex Bolt 5/8 - 11 UNC x 4 - 1/2
27	STD551162	*Lockwasher 5/8
28	STD541062	*Hex Nut 5/8 - 11 UNC
29	9446R	Trip Shaft
30	9445R	Latch Pin
31	9841R	Pin Bracket - R.H.

KEY NO.	PART NO.	DESCRIPTION
32	9842R	Pin Bracket - L.H.
33	673A84	Bracket L.H. Weldment
34	9436R	Return Spring
35	9906R	Roll Pin
36	9843R	Latch Pin Lever
38	4502P	Set Screw, Hex Socket Hdless. - C.P. 5/16 - 18 UNC x 5/16
39	673A82	Lift Bracket
40	2228M	Woodruff Key 3/16 x 3/4
41	2505P	Cotter Pin 1/8 x 3/4
43	4338M	Lever Clip - Lower
44	673A129	Lift Lever and Shaft
45	29J	Lever Plunger
46	1539U1	Compression Spring
47	STD541025	*Hex Nut 1/4 - 20 UNC
48	STD533110	*Carriage Bolt, Sq. Neck Sht. Shoulder 5/16 - 18 UNC x 1
49	STD551031	*Washer 11/32 x 11/16 x 16 Ga.
50	STD551131	*Lockwasher 5/16
51	STD541031	*Hex Nut 5/16 - 18 UNC
52	STD551137	*Lockwasher 3/8
53	STD541037	*Hex Nut 3/8 - 16 UNC
54	3352P	Hex Bolt 1/2 - 13 UNC x 4 - 1/2
55	STD551050	*Washer 17/32 x 1 x 16 Ga.
56	STD541050	*Hex Nut 1/2 - 13 UNC
57	STD523712	*Hex Bolt 3/8 - 16 UNC x 1 - 1/4
58	STD523108	*Hex Bolt 5/16 - 18 UNC x 7/8
59	STD522507	*Hex Bolt 1/4 - 20 UNC x 3/4
60	STD551125	*Lockwasher 1/4
...	9912R	Warranty Tag
...	32J	Owners Manual

*STANDARD HARDWARE--PURCHASE LOCALLY

Sears

**MODEL NO.
917.253311**

HOW TO ORDER REPAIR PARTS

MODEL NUMBER

The Model Number will be found on a plate on the left side, attached to the Lift Bracket. Always mention the Model Number when requesting service or repair parts for your Dozer Blade.

REPAIR PARTS

All parts listed herein may be ordered from any SEARS, ROEBUCK AND CO. or SIMPSONS-SEARS LIMITED retail or catalog store.

WHEN ORDERING REPAIR PARTS, ALWAYS GIVE THE FOLLOWING INFORMATION:

- THE PART NUMBER
- THE PART DESCRIPTION
- THE MODEL NUMBER
- THE NAME OF MERCHANDISE

If the parts you need are not stocked locally, your order will be electronically transmitted to a Sears Repair Parts Distribution Center for "expedited handling".

**Sears, Roebuck and Co., Chicago, Ill. 60684, U.S.A.
and Simpsons Sears Limited, Toronto, Canada**