

**Sears**  
owners  
manual



MODEL NO  
917.253480

## SUBURBAN TRACTOR SHREDDER/BAGGER ATTACHMENT

- Assembly
- Operating
- Maintenance
- Repair Parts

Sears, Roebuck and Co., Chicago, Ill. 60684 U.S.A.  
and Simpsons Sears Limited, Toronto

## GUARANTEE

During the first year, we will repair your Tractor Shredder/Bagger Attachment free of charge, if found defective in material or workmanship. This Guarantee service is available by simply returning the Tractor Shredder/Bagger Attachment to any of our stores or service centers throughout the United States or Canada. Guarantee is limited to 30 days if used for commercial purposes.

SEARS, ROEBUCK AND CO. – SIMPSONS-SEARS, LTD.

## IMPORTANT RULES FOR SAFE OPERATION

### TRAINING

1. Read the Owners Manual carefully and fully familiarize yourself with the controls and proper use of your tractor and Shredder/Bagger attachment. Be prepared to stop the engine and attachment blades on a second's notice. Only persons well acquainted with these Rules for Safe Operation should be allowed to use your tractor and Shredder/Bagger attachment.
2. Do not allow children or young teenagers to start or operate your tractor and Shredder/Bagger attachment.
3. Do not allow anyone in the area while shredding. Keep the children and pets away from the shredding area. Keep a wary eye out for children or passers-by. Place the blade control lever in the disengaged position and stop the engine while they are in the vicinity of your Tractor Shredder. Children, particularly, could get an extremity in the way of the revolving blades.

### PREPARATION

4. Thoroughly inspect the material to be shredded and remove all foreign objects such as rocks, stones, wires, cans, boards, large branches, bones and other foreign objects before shredding. Foreign objects may be propelled by the attachment blades causing injury to the operator, a bystander or a pet or damage to other property, the tractor or the Shredder attachment itself.
5. Do not operate the tractor and Shredder/Bagger attachment when barefoot or wearing open sandals. Always wear safety glasses. Also, do not wear loose fitting clothing that could get caught in moving parts.
6. Check your fuel supply before each use. Never remove the gas cap or fill the gasoline tank when the engine is running or while it is hot. When filling the fuel tank, leave space for expansion, do not fill it to the brim and keep in mind that the heat of the sun can cause the gasoline to expand. Wipe off any spilled gasoline before starting the engine. Remember, gasoline is highly flammable and must always be handled with extreme care.
7. A tractor with a Tractor Shredder/Bagger attachment is a precision piece of equipment, not a plaything, therefore, extreme caution must be exercised at all times.

8. Never attempt to operate a damaged tractor or Tractor Shredder/Bagger attachment, always repair any damage before attempting to start or operate your tractor or Shredder/Bagger attachment.
9. Never attempt to carry any passengers, their safety as well as your safety will be endangered.
10. Your tractor with the Tractor Shredder attachment in place is equipped with an engine interlock system. The tractor Shredder attachment also has an interlock switch (Figure 1) mounted on the engine pad that prevents engine being started without bottom 4578R (see repair parts exploded view) securely locked in place in engine pad. This system will prevent the engine from starting if the operator tries to start the engine while the transmission is in gear, bottom not installed in engine pad and/or the attachment clutch lever is in the engaged position. Before attempting to start the engine make sure the gear shift lever is in neutral and the belt tightener lever is in the disengaged position, then firmly apply the foot brake. The parking brake must always be disengaged when you put the tractor in motion. If the tractor is operated with the parking brake engaged, serious damage may result.
11. Pick a level area to do your Shredding. Be sure your work area is free of holes, rocks or other debris so that you will not stumble or fall, when operating your shredder attachment. Serious injury could occur should you stumble or fall into any moving parts, rocks or other debris.

### OPERATION

12. Never place your hands or feet in or under the Tractor Shredder attachment, in the discharge chute or near any moving parts while the tractor or Tractor Shredder attachment is running. If bagger attachment is not being used always keep clear of the discharge chute. Deflector must be free to move up and down when Bagger Attachment is removed.
13. Keep your face and body back from the hopper opening in order to avoid any bounceback of material from the hopper.
14. Do not allow an accumulation of shredded material in the discharge area or bag to become full as this will prevent proper discharge.

- 15 Do not overload the hopper of this Tractor Shredder. If it becomes necessary to push material into the hopper, use only a long piece of soft wood such as plastering lath, or sticks approximately 3/4" in diameter. Never use your hands, large pieces of wood, thick plastic material or the like.
- 16 If the tractor or Tractor Shredder attachment should start to vibrate abnormally, pull back (disengage) belt tightener lever all the way back against footrest. Shut off the tractor engine and remove the ignition key. Check immediately for cause of this vibration.
17. Before clearing the discharge chute, adjusting, cleaning, repairing, or inspecting your tractor or Tractor Shredder attachment, place the belt tightener lever in the disengaged position, shut off the engine and remove the ignition key, disconnect the spark plug wire from the spark plug(s) and keep it away from the spark plug(s) to prevent injury or accidental starting.
18. Do not run the engine indoors because the engine exhaust fumes contain carbon monoxide which is a tasteless, odorless, deadly poison.
19. Do not start or stop suddenly when going up or down a terrace, slope or incline. If it is necessary to stop your tractor upon an incline, do so firmly to prevent the tractor from picking up speed during declutching and before reaching the brake position. Do not shift gears while going up or down inclines. Choose a gear low enough to negotiate the incline without stopping and shifting gears. To reduce the speed of the tractor on an incline move throttle lever to slow.
20. Never attempt to operate your tractor or Tractor Shredder attachment without the proper shields, guards, plates or other protective devices in place and fully functioning.
21. Be absolutely sure that the discharge deflector is used at all times when the Tractor Shredder attachment is operating in order to minimize the possibility of injury or damage from a thrown object or tearing of collector bag.
22. Before and while attempting to back up, look carefully to be absolutely sure that children, bystanders, pets, foreign objects or obstacles of any kind are not behind you.
23. Never direct shredded material from the discharge chute toward bystanders or pets nor allow anyone near the tractor while it is operating. Use of the bagger attachment reduces possibilities of injury to bystanders.
24. Be ready to start shredding before you start the engine of your tractor. Shift tractor into neutral, set parking brake, before engaging belt tightener lever. The use of any precision piece of power equipment requires your full concentration and attention to the job being done in order to prevent injury or damage.

## MAINTENANCE

25. Keep all nuts, bolts and screws tight in order to be sure that the tractor and Shredder/Bagger attachment are in safe working condition. Be sure the brake and Shredder attachment controls are always in proper adjustment and repair. Check to see that blade and gear box mounting bolts are secure. Before performing any maintenance, always place the belt tightener lever in the disengaged position, set the parking brake, shift into neutral, shut off the engine and remove the ignition key, disconnect the spark plug wire from the spark plug(s) and keep it away from the plug(s) to prevent injury or accidental starting.
26. Keep the engine free from accumulations of grass, leaves or excessive grease as these accumulations are combustible and could result in a fire. Always keep your tractor and Tractor Shredder attachment in good operating condition and make sure that all shields, guards, plates and other protective devices are in place. Give your tractor and Tractor Shredder attachment the regular maintenance they need and have a competent serviceman make a thorough inspection of the tractor and shredder attachment at least once a year.
27. Do not store your tractor for prolonged periods (more than 30 days) with gasoline in the tank. Do not store your tractor or a gasoline container inside a building where fumes may reach an open flame or spark, they should be stored in a cool, dry place. Be sure to let the engine cool before storing in any enclosure. Always use an approved gasoline container for storing gasoline and keep your tractor, Shredder attachment and gasoline container in locked storage to prevent children from playing and tampering with them.

## table of contents

GUARANTEE	1
RULES FOR SAFE OPERATION	1-2
ASSEMBLY INSTRUCTIONS	3-7
OPERATING INSTRUCTIONS	8
MAINTENANCE INSTRUCTIONS	9-10
REPAIR PARTS	11-13

# Introduction

Your new Sears Tractor Shredder/Bagger Attachment utilizes 3 sharp, cutting blades rotating about the vertical shaft within the blade housing. In order to shred material fast and efficiently, the tip of the blades rotate at a speed of approximately 15,260 feet per minute or almost 174 miles per hour when the attachment clutch lever is in the engaged position. The blades cut material through the use of such force coupled with the sharpness and speed of the blades. Obviously, such a force constitutes a potential danger if the Shredder is not properly used and maintained. It is therefore, imperative in its use and maintenance that the operator always follow the normal precautions stated in the RULES FOR SAFE OPERATION as well as other instructions contained in the Owners Manual in order to prevent injury or damage.

This Shredder/Bagger Attachment has been designed, engineered and manufactured to give you the best dependability and performance. Should you experience any problem which cannot be easily remedied, please return your Shredder to your nearest Sears, Roebuck and Co. store or service center. They have well qualified, competent, trained technicians and proper tools to service or repair this unit. NEVER ATTEMPT TO SERVICE OR REPAIR YOUR SHREDDER UNLESS YOU ARE FULLY QUALIFIED TO DO SO.

Your Shredder/Bagger Attachment has been shipped from the factory partially assembled. All parts such as bolts, nuts, washers, etc. necessary to complete assembly of the Tractor Shredder Attachment have been included in a plastic bag.

Bag of parts include the following items:

QTY.	DESCRIPTION	LOCATION REF.	QTY.	DESCRIPTION	LOCATION REF.
2	Carriage Bolt 3/8-16 x 3/4"	F, Fig. 1	1	Belt Guide	EE, Fig. 5
2	Lockwasher 3/8"	F, Fig. 1	1	Hex Bolt 1/4-20 x 3/4"	FF, Fig. 5
2	Hex Nut 3/8-16	F, Fig. 1	1	Plain Washer 5/16 x 3/4" x 16 Ga.	FF, Fig. 5
1	Adjustable Deflector Stop	H, Fig. 1	1	Lockwasher 1/4"	FF, Fig. 5
2	Deflector Stop Bushing	G, Fig. 1	1	Hex Nut 1/4-20	FF, Fig. 5
2	Slotted Truss hd. mach. Screw 3/8-16 x 1"	J, Fig. 1	3	Retainer Springs	A, Fig. 18
2	Lockwasher 3/8"	J, Fig. 1	1	Spring	O, Fig. 8
2	Hex Nut 3/8-16	J, Fig. 1	1	Shorting Wire Rear	W, Fig. 13
2	Plain Washer 13/32 x 13/16 x 16 Ga.	J, Fig. 1	1	Self-Tapping Tap Connector	Y, Fig. 13
			1	Plastic Tie	BB, Fig. 13

NOTE: If your tractor is 1972 or older it will be necessary to purchase a Belt Tightener Kit, Cat. No. 25349 from your nearest Sears Store and install it on your tractor.

NOTE: If your tractor is not equipped for a lawn mower attachment, it will be necessary to purchase and install Belt Tightener Link (H, Fig. 6) Part No. 634x171 from your nearest Sears Store.

## assembly

A letter in parenthesis in the following instructions refers to an arrow in an adjoining Figure (Illustration), unless otherwise stated.

When R.H. (Right Hand) or L.H. (Left Hand) is used, it should be understood to mean from the drivers' position on the tractor.

1. Remove leaf ramp, shredder/bagger attachment, shredder and plastic bag from carton.
2. In a small carton is the deflector (A, Fig. 1) and adjustable deflector (B). Remove one bolt (C), lockwasher and nut from interlock switch bracket

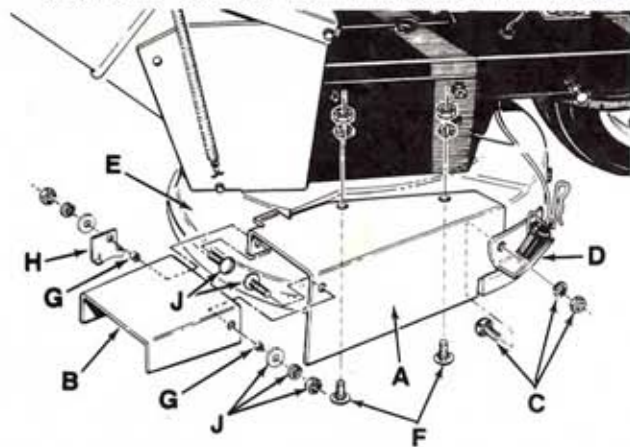

FIG. 1

(D). Slide end of deflector (A) under switch bracket (D) (between bracket and engine pad (E) and align hole in deflector with switch bracket hole. Reinstall bracket bolt (C), lockwasher and nut. NOTE: Heads of bolts go inside engine pad (E). Align holes in top of deflector (A) with holes in engine pad and secure with 2-3/8 x 3/4" carriage bolts (F), lockwashers and nuts from plastic bag.

3. Position adjustable deflector (B, Fig. 1) over end of deflector (A) and align holes. Insert bushings (G) into holes and position deflector stop (H) against deflector (A) and secure with 2-3/8 x 1" truss head machine screws, plain washers, lock-

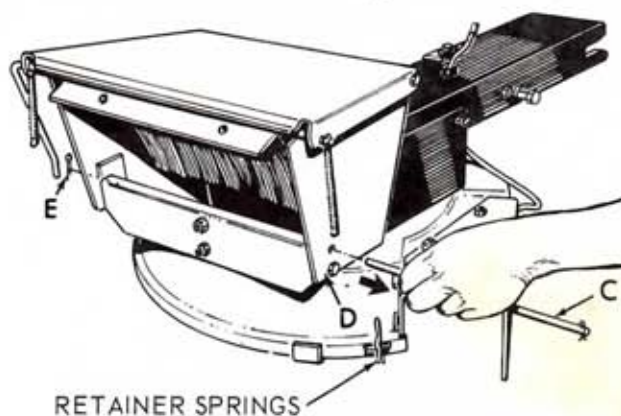

FIG. 2

# assembly (cont.)

washers and hex nuts found in plastic bag. NOTE: Head of screws go inside discharge chute.

4. Refer to Fig. 2. Remove partially spread cotter pin (E) from end of rod (C) and withdraw rod from hopper wrapper (D). Leave spread cotter pin in place on other end of rod (C).

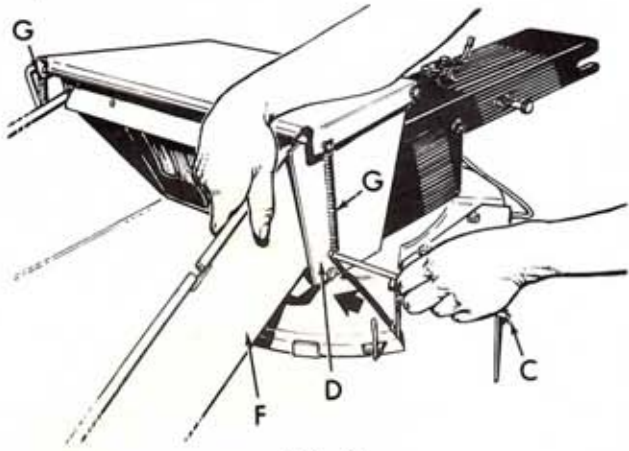

FIG. 3

5. Refer to Fig. 3. Position narrow end of ramp (F) inside hopper (D). Align holes in sides of hopper (D) with hinge on bottom of ramp (F). Insert end of rod (C) into loose end of spring (G), then into hole on side of hopper, through ramp hinge and out the other side of hopper (D). Pull loose end of second spring (G) (on far side of hopper) over the end of rod (C). Secure spring with cotter pin (E, Fig. 2).
6. Lift up on wide end of ramp until notches in sides of ramp lock onto deflector pivot, see Fig. 7.
7. Refer to Fig. 18. Install 3 retainer springs (A) (furnished in plastic bag) into holes of latches (B) to secure bottom (C) in place.

## assembly of shredder to tractor

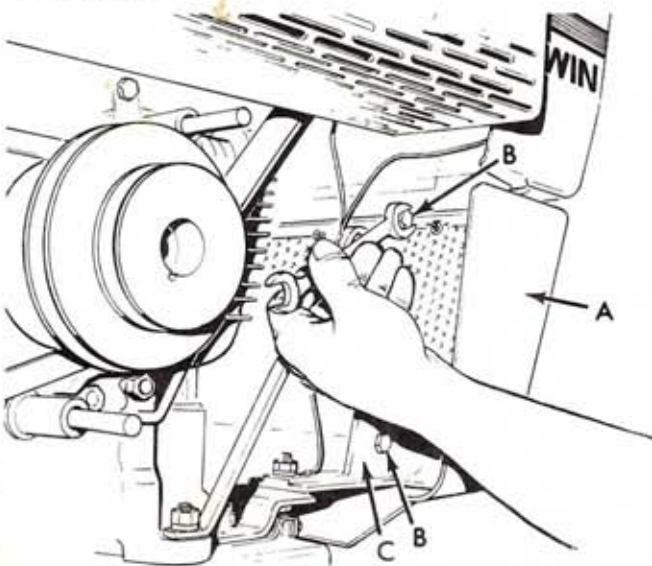

FIG. 4

4973R-1.11.73

1. Refer to Fig. 4. Remove R.H. grill side (A) by removing two bolts (B) holding grill side to grill (C). Keep grill side and bolts so that they can be replaced when Shredder is removed.

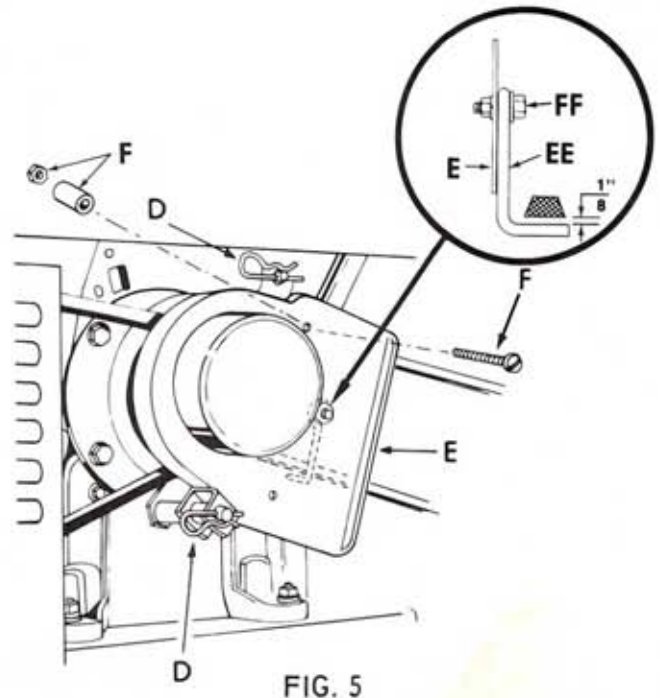

FIG. 5

2. Refer to Fig. 5 (only on 1968 and newer models). Pull the 2 retainer springs (D) holding belt guard (E) to tractor. Remove belt guard (E) from engine. Remove bolt, bushing and nut (F) from belt guard (E). Install belt guide (EE) to belt guard (E) using bolt (FF), washer, lockwasher and nut. NOTE: Place bolt in UPPER "Cutter Bar Mower" hole of belt guard (E). Position belt guide (EE) to clear bottom of V-Belt (approx. 1/8") when belt tightener lever is engaged.

Models older than 1973 may require removal of this flap if bolt in belt tightener bracket interferes.

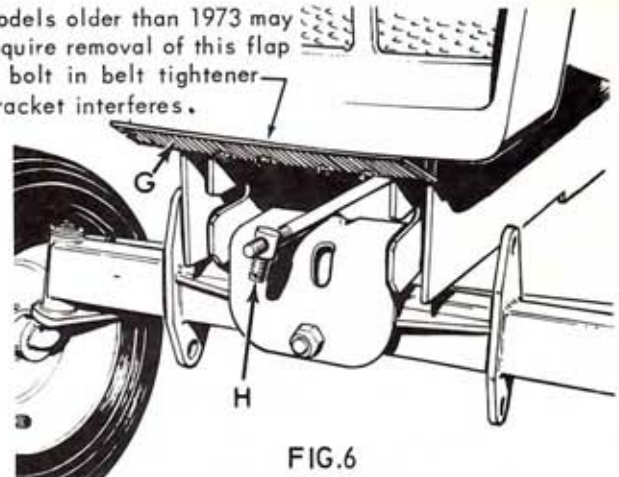

FIG. 6

3. Refer to Fig. 6. Raise front channel cover (G). Install belt tightener link 6499H (instructions for link installation are furnished with Belt Tightener Kit 25349). Place link (H) in center of tractor frame opening. NOTE: If your tractor is not equipped with a lawn mower attachment, it will be necessary to purchase and install Belt Tightener Link 634x171.

# assembly (cont.)

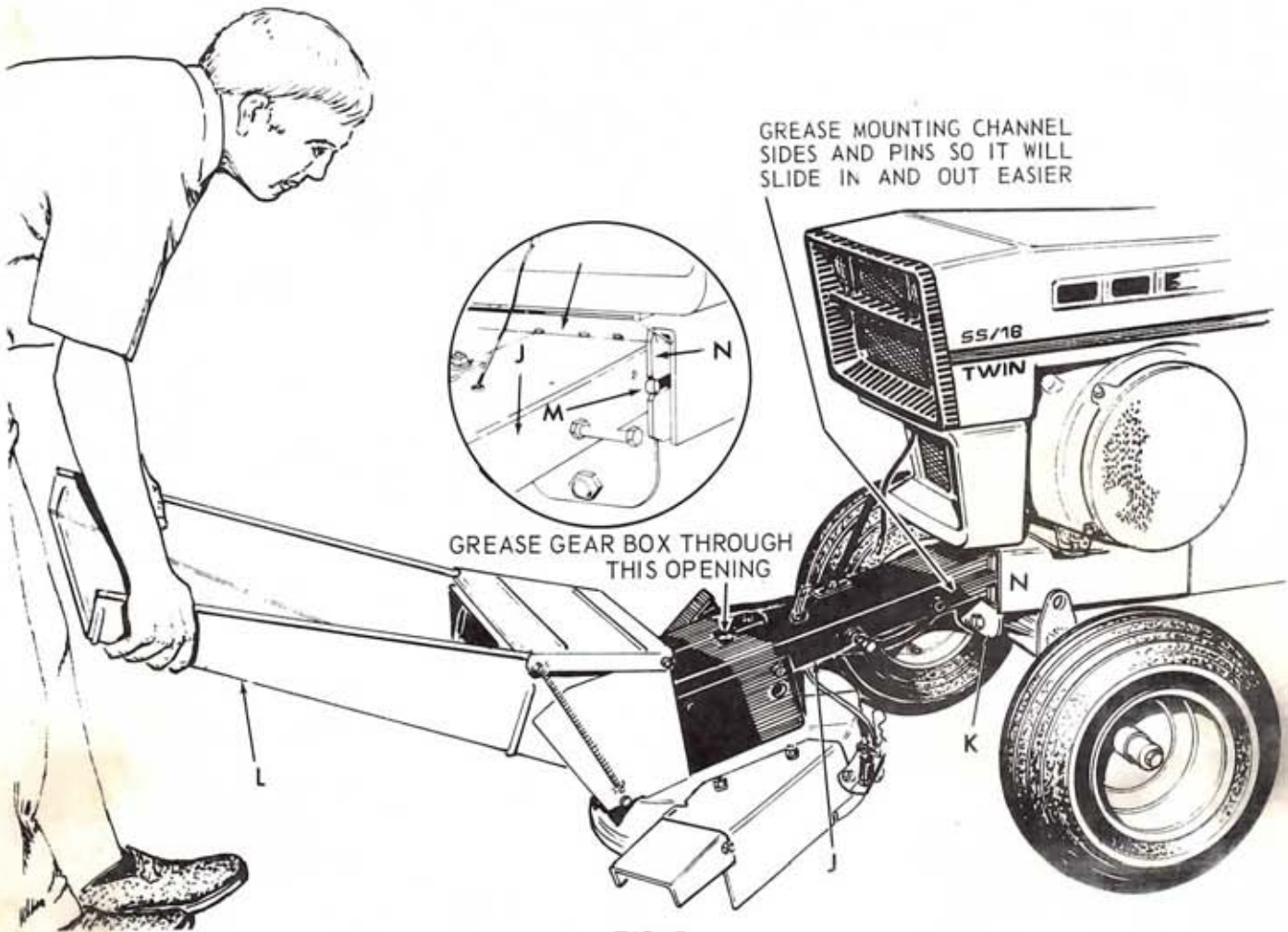

FIG. 7

4. Refer to Fig. 7. Lift rear end of mounting channel (J) and position it on top of front axle bracket (K). Lift up on front end of ramp (L) and slide channel (J) toward tractor. Pins (M) on mounting channel (J) must enter slots in tractor frame (N).

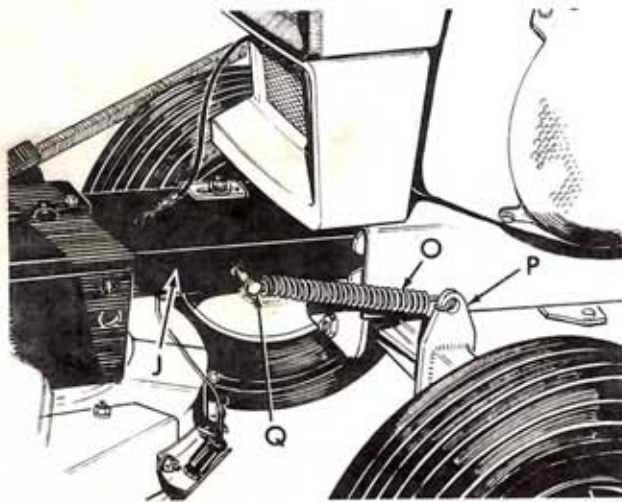

FIG. 8

5. Refer to Fig. 8. Hook spring (O) (shipped in plastic bag) from hole in L.H. side of shredder mounting channel (J). A pair of pliers or a heavy wire loop will be required to attach spring to bolt (Q).

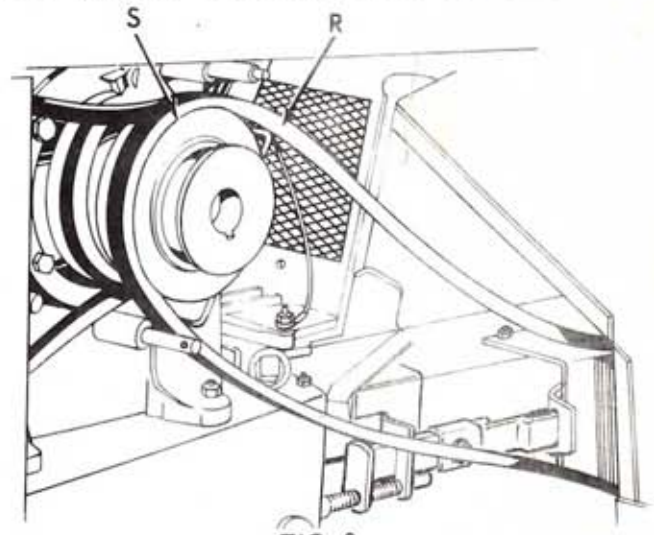

FIG. 9

6. Refer to Fig. 9. With tractor belt tensing lever in "Out" position, place shredder drive belt (R) in largest groove of engine pulley (S) (second groove from outside.)
7. Replace belt guard removed in step 2 and secure with two retainer springs. See Fig 5.

# assembly (cont.)

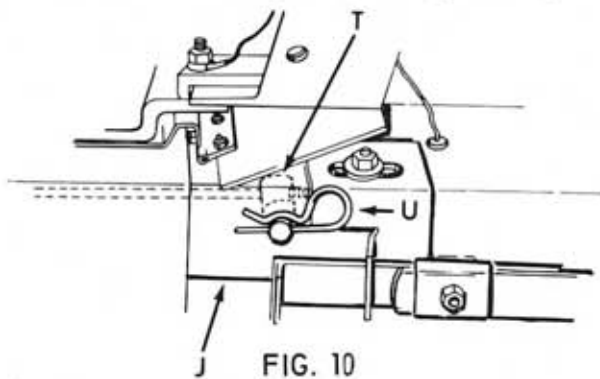

FIG. 10

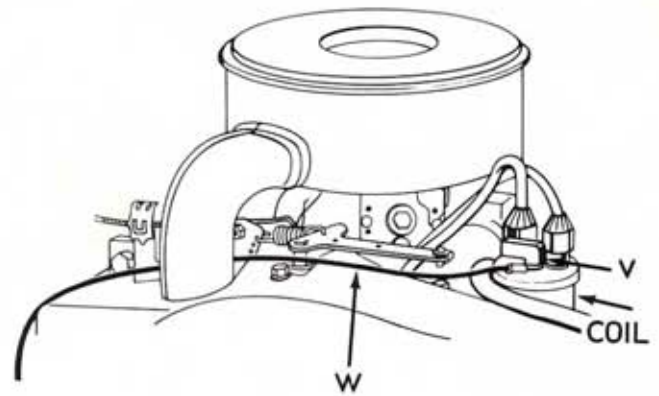

FIG. 11

8. Refer to Fig. 10. Attach front end of belt tightener link 6499H, adjusting pin (T) in hole on R.H. side of mounting channel (J). Secure with retainer spring (U).
9. Adjust brake, see Brake Adjustment page 9.

2. Lay wire (W) on top of engine near fan housing and down in front of engine, under grill and connect to wire (X) protruding from top shredder mounting channel. See Figure 12.

## For safety switch hook up For 16H.P. twin cylinder engine

1. For 16 H.P. Twin Cylinder engine lift up on terminal (V) to remove from coil (Figure 11.) Place shorting wire terminal eyelet (W) (wire found in plastic shipping bag) on stud of coil. Now replace terminal (V) on coil stud.

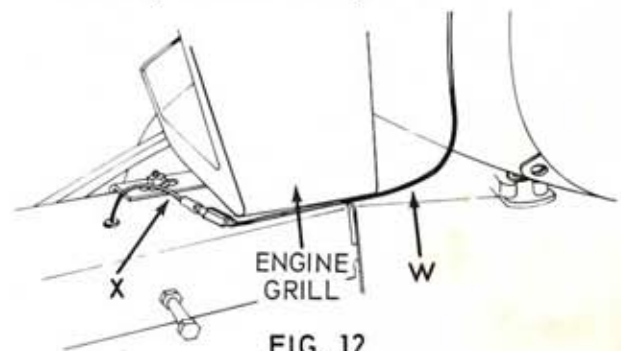

FIG. 12

## For 12H.P. and 16H.P. single cylinder engines For 1973 and newer tractors

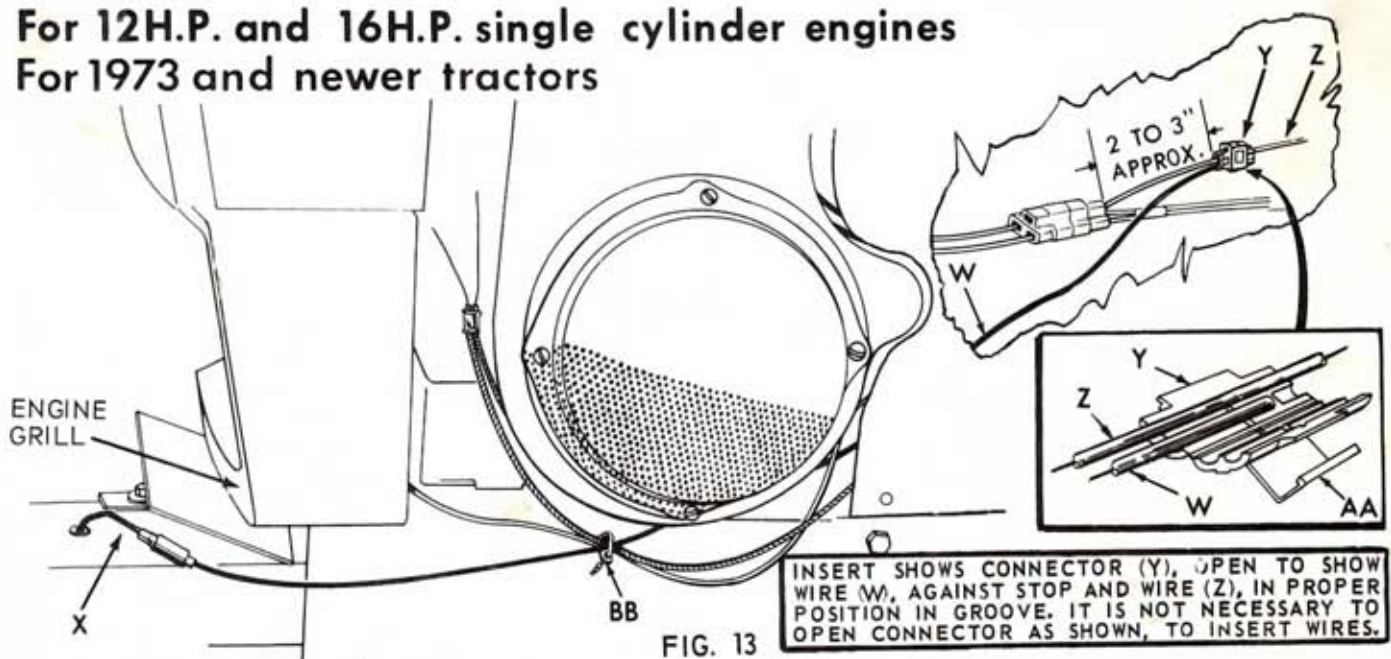

FIG. 13

INSERT SHOWS CONNECTOR (Y), OPEN TO SHOW WIRE (W), AGAINST STOP AND WIRE (Z), IN PROPER POSITION IN GROOVE. IT IS NOT NECESSARY TO OPEN CONNECTOR AS SHOWN, TO INSERT WIRES.

3. To perform the following step, connection access may be accomplished from under the tractor, or by removing left-hand cover located directly below the gas tank.
4. For 12 and 16 HP single cylinder engines: Cut off wire (W) ( found in plastic bag) and terminal eyelet approximately 6" from end of eyelet. Place connector (Y) over single wire (Z) inserting wire into first groove from open side of connector as illustrated above. Insert cut off end of wire (W) into open end of connector (Y). Make sure wire touches the stop in connector. Use pliers to squeeze metal plunger flush with body of connector, then fold tab(AA) over and lock on body of connector.
5. Run wire (W) under flywheel housing of engine and under grill, connect wire (W) to wire (X).
6. Use tie (BB) provided in plastic bag and attach rear wire to throttle cable .

# assembly (cont.)

For 1972 and older tractors

BRIGGS & STRATTON ENGINE

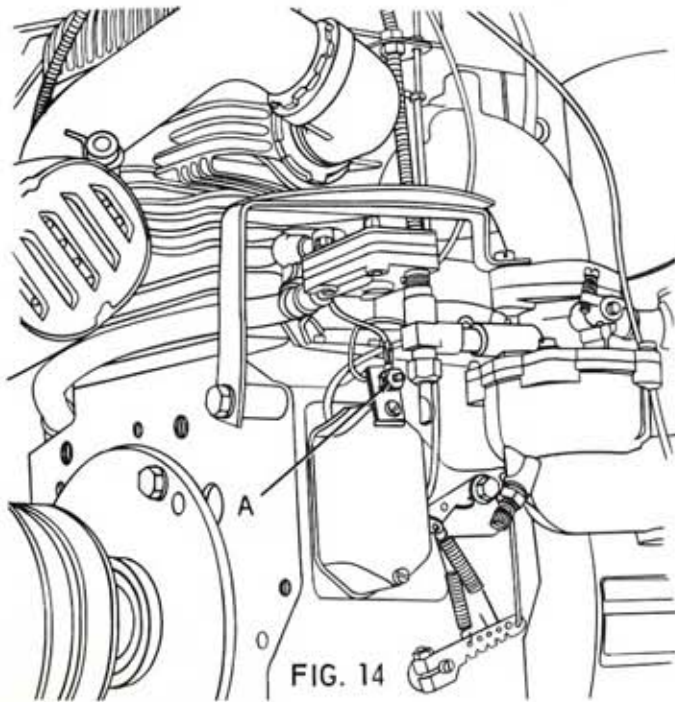

FIG. 14

7. Attach eyelet of shorting wire from shredder Attachment to terminal (A) on Briggs engine, to breaker box as shown above. See (Fig. 14).

CRAFTSMAN ENGINE

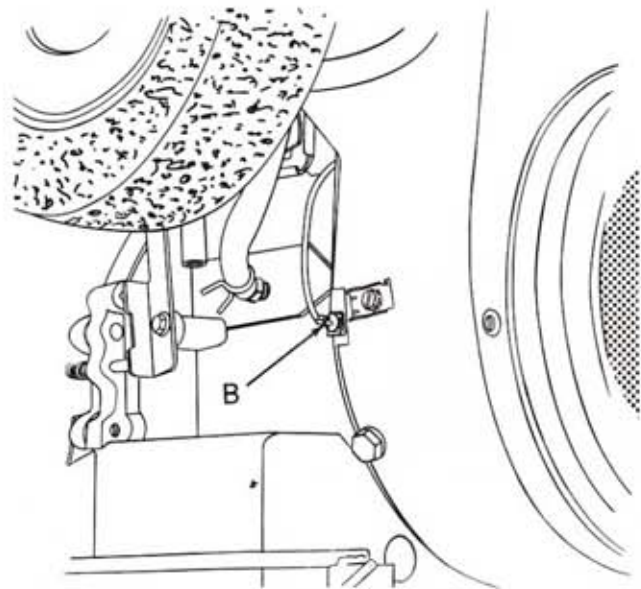

FIG. 15

8. Attach eyelet of shorting wire from shredder attachment to terminal (B) on Craftsman engine. Front of blower housing as shown above. See (Fig. 15).

## WARNING

If your tractor is not equipped with a safety switch on the belt tightener lever, the shredder attachment will operate when lever is forward. Always make certain lever is back, against footrest, before starting tractor engine.

# assembly of bagger

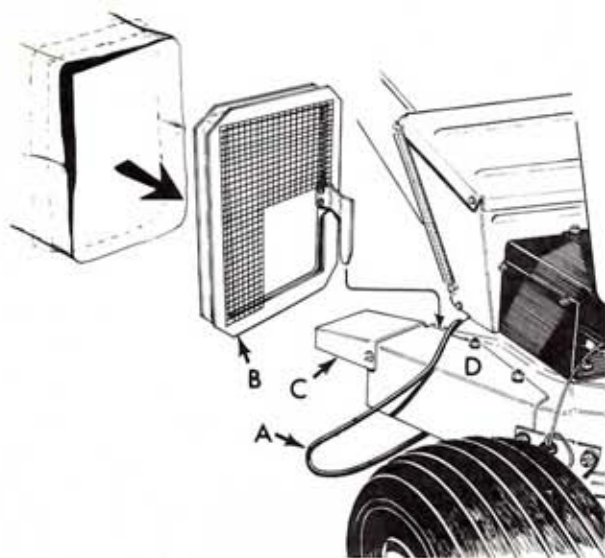

FIG. 16

1. Refer to Fig. 16. Lay bag retainer O-Ring (A) over end of discharge chute. Assemble bagger attachment screen (B) over end of discharge deflector (C) and insert screen bracket into rectangular holes on inboard side of discharge chute (D). Stretch bag over four corners of screen bracket about 3" to 4". Stretch bag retainer band (A) around screen bracket and fold front of bag back over retainer O-Ring.

2. Refer to Fig. 18. Insert the 3 retainer springs (A), shipped in bag of parts, into holes in end of latches (B) to lock bottom cover in place.

## preface to operating

There are several gardening applications for your powerful new TRACTOR SHREDDER/BAGGER. Probably your initial use of this unit will be to reduce lawn and garden bulk by shredding it and bagging it for disposal pick-up. Air pollution ordinances in many areas have made it illegal to burn this bulk, however your TRACTOR SHREDDER/BAGGER will allow you to dispose of it properly.

Another prime use for your SHREDDER/BAGGER will be in the preparation of a compost pile. Shredding accelerates the decomposition process. Compost is of special value for potting house plants, use in greenhouses, gardens and the like. Some other uses are for flower beds, rose beds, and as a top dressing for lawns. The ingredients which go into the preparation of a compost pile vary depending upon the materials available, but they usually consist of sod, grass clippings, weeds, leaves, corn stalk, discarded vegetable greens such as carrot tops, etc. Many local libraries have fine books on gardening and flower bed preparation and maintenance dealing with the preparation of compost piles which will apply to your particular climate, soil conditions and use for the compost pile.

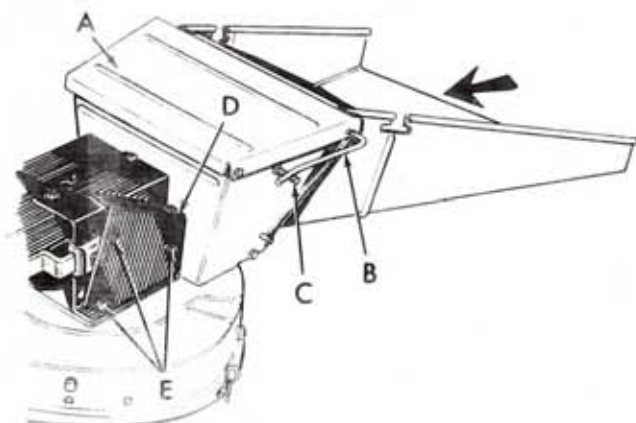

FIG. 17

For ease in shredding or bagging leaves, the shredder ramp may be left in the down position (see Fig. 3) and the leaves raked up the ramp into the shredder. Refer to Fig. 17. Lift hopper cover (A) and rest deflector pivot handle (B) on stud (C). This raises rubber deflector strips in hopper to allow leaves to be raked into hopper.

In order to make your TRACTOR SHREDDER/ATTACHMENT a more versatile piece of equipment, Sears offers a Lawn Cleanup Cart.

## operating instructions

BE AWARE OF ALL THE "RULES FOR SAFE OPERATION" LISTED ON PAGE 1. PUT ON YOUR SAFETY GLASSES.

4973R-1.11.73

## operating instructions (cont.)

1. Position tractor, with TRACTOR SHREDDER ATTACHMENT on level ground, away from any debris such as rocks, cans, stumps etc. This is to give you a clear area in which to work.
2. Set parking brake on tractor and start tractor engine (half throttle). Engage (forward) belt tightener lever on tractor to engage SHREDDER ATTACHMENT.
3. After SHREDDER ATTACHMENT is running, advance throttle on tractor to  $\frac{3}{4}$  to "Fast" position (full throttle).
4. To stop shredder, reduce throttle on tractor to about half throttle, then pull back (disengage) belt tightener lever all the way against foot rest. Hold down on lever until brake stops drive sheave on gear box. Turn ignition on tractor to "off" position. Remove key.

TRACTOR SHREDDER was designed for best operation at full "fast" throttle. Be sure discharge chute deflector is angled downward so that all shredded material is diverted to discharge toward the ground. Stalks, long heavy weeds, small branches, etc. can be hand fed into the hopper. This way the rate of feed can be controlled to prevent stalling the engine. However, when this material becomes so short as to be level with the top of hopper, let go, and material will feed itself. DO NOT lower hands inside the hopper.

If it becomes necessary to push material down in hopper, use only a piece of soft wood. A plastering lath, or  $\frac{3}{4}$ " diameter stick are good examples of what to use. Occasionally there may be a bounce back of material from blades, therefore keep face away from hopper opening.

When feeding material into hopper, always feed so that (throat) bottom of hopper is not completely covered. This is necessary so that air will mix with material for proper discharge. More material can be shredded when hopper is not completely filled. If fed too fast engine may stall. It will take experience to determine the proper rate of each material fed into the Shredder for best performance.

It is not necessary to shred all material to a uniform size. Remember, the main purpose of the Shredder is to reduce the bulk.

**IMPORTANT:** When shredding materials with high moisture content, which may have a tendency to plug, mix in some dry material such as corn cobs, brush trimmings, etc. The percentage of dry material added will vary with moisture content and condition of material to be shredded. Generally more dry material will be needed with higher moisture material. A continuous mixture will also help. Experience will teach you the proper mixtures and rate of feed needed to prevent plugging.

When shredded material builds up at discharge area, disengage belt tightener lever, and stop tractor engine. Rake material away from discharge area. If bagger attachment is being used, remove bagger screen and let shredded material fall to bottom of bag. If bag is full then replace it with a new Sears bag. Restart tractor engine, and engage belt tightener lever.

# maintenance flow of material obstructed

1. Move tractor throttle lever to slow position. Disengage belt tightener lever (all the way back against foot rest).
2. Turn ignition switch to "OFF" position on tractor. Remove ignition key.
3. Check to see if discharge opening is clogged. Use a stick or small board to clean out opening.
4. Check that there is not some large obstruction in the mill housing. Remove with a stick.

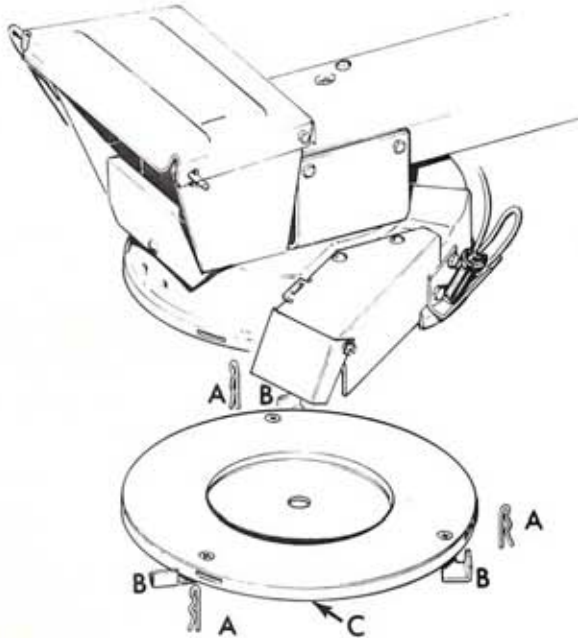

FIG. 18

5. Refer to Fig. 18. Remove 3 retainer springs (A) from latches (B). Pull latches (B) out and drop bottom (C) from engine pad. Look up into blade area for obstructions. Remove obstruction and replace bottom (C) in engine pad. Lock latches in place and secure with retainer springs (A).
6. Restart engine and engage belt tightener lever.

## brake adjustment

Refer to Fig. 19. The purpose of the brake is to stop the blades quickly. With belt tightener lever engaged (lever pushed all the way forward) hold brake shoe (A) tight against groove in sheave (B). Then loosen bolt (C) in brake bar from (D) and rear brake bar weldment (E). Adjust brake bars so that push rod (F) clears front of tractor frame (G) by  $1/16''$ . Retighten nut securely. Adjust rear brake bar bracket (H) so that front spring is compressed to about  $1-7/8''$  long. Tighten nut (J) securely.

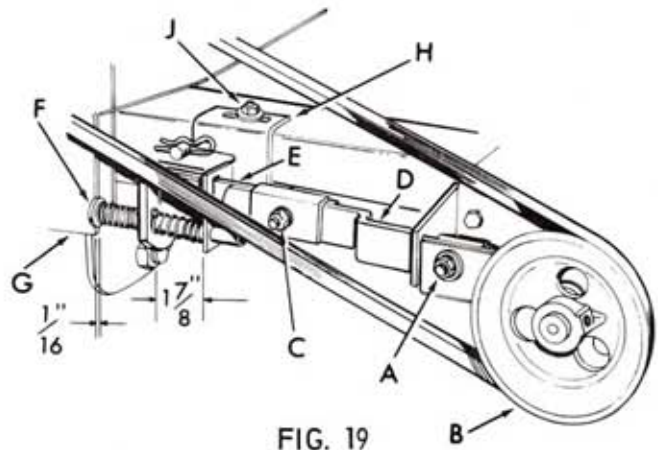

FIG. 19

Refer to Fig. 19. Disengage clutch, start engine, and engage and disengage attachment clutch lever several times to make sure brake is stopping blades properly. If it does not, lengthen brake bars front (D) and rear (E) and tighten nut (C) securely.

NOTE: Brake shoe (A) must not rub sheave (B) when Shredder is running (clutch engaged).

## belt replacement

Disengage belt tightener lever on tractor. Remove two retainer springs (D, Fig. 5) holding belt guard (E) to tractor and remove guard. Remove bolts, lockwashers and split spacers (E, Fig. 17) and remove belt guard (D). Slip V-belt off both sheaves. Install new V-belt and replace guards (E, Fig. 5 and D, Fig. 17). Adjust belt tension, see "belt adjustment".

## belt adjustment

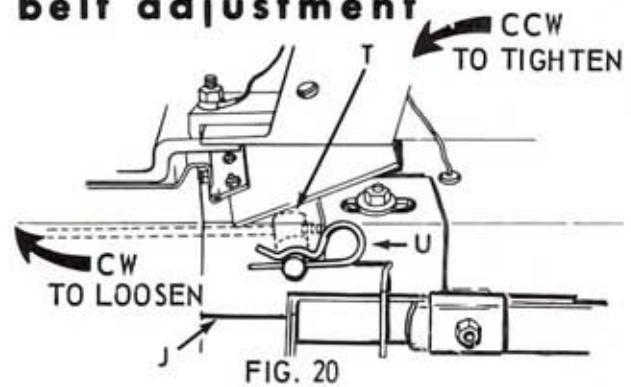

FIG. 20

Remove retainer spring (U) from adjusting pin (T). Remove adjusting pin (T), from support channel (J). Turn adjusting pin (T), clockwise to loosen belt; counterclockwise to tighten belt. Replace adjusting pin (T), in hole of support channel (J). Engage clutch lever (push forward). Squeeze belt with thumb and fore finger midway between engine pulley and Shredder pulley. Belt is properly adjusted when there is a 3" (outside) space between belt when squeezed (without undue pressure). Replace retainer spring (U), in adjusting pin (T). After two (2) hours use, recheck belt for adjustment.

## lubrication

Lubricate gear box once a season. To grease, place nozzle of grease gun through hole in top of front end of support channel (see Fig. 7). Pump ten (10) shots of moly E.P. lithium grease through grease fitting into gear box.

# **maintenance (cont.)**

## **service instructions**

It is probable that the blades will never need sharpening. Certain owner maintenance must be performed to obtain longest life and trouble free use of your shredder. Servicing of the air cleaner on tractor regularly is of the utmost importance, especially when shredding dry material.

## **how to clean**

When you are through operating the Shredder for the day, remove bagger attachment, flush out the residue that has collected inside the machine. Run some water down the ramp with a garden hose while the blades are running at "slow" speed. CAUTION: Do NOT place hose inside the hopper. Avoid getting water on tractor engine. Run shredder again so that air flow will dry out mill housing. Clean the engine, refer to tractor manual.

## **removal of unit from tractor**

Disconnect spring (Fig. 8, page 5), shorting wire at connector (Fig. 12, page 6), belt tightener link (Fig. 10, page 6), and belt at engine pulley (Fig. 9, page 5). Reverse step 4 page 5, steps 2 and 1 page 4.

## **storage**

In the event your Shredder is to be inoperative for periods in excess of 30 days – prepare for storage as outlined below:

1. Completely clean inside, and outside of shredder, after each time it is used. It is easier to clean then, and will work more efficiently next time it is used.
2. Apply a light coat of grease or rust preventive to ramp, blades and inside walls of mill housing.
3. Store in a clean, dry building.

# repair parts

TRACTOR SHREDDER/BAGGER ATTACHMENT  
MODEL NUMBER 917.253480

another free manual from www.searstractormanuals.com

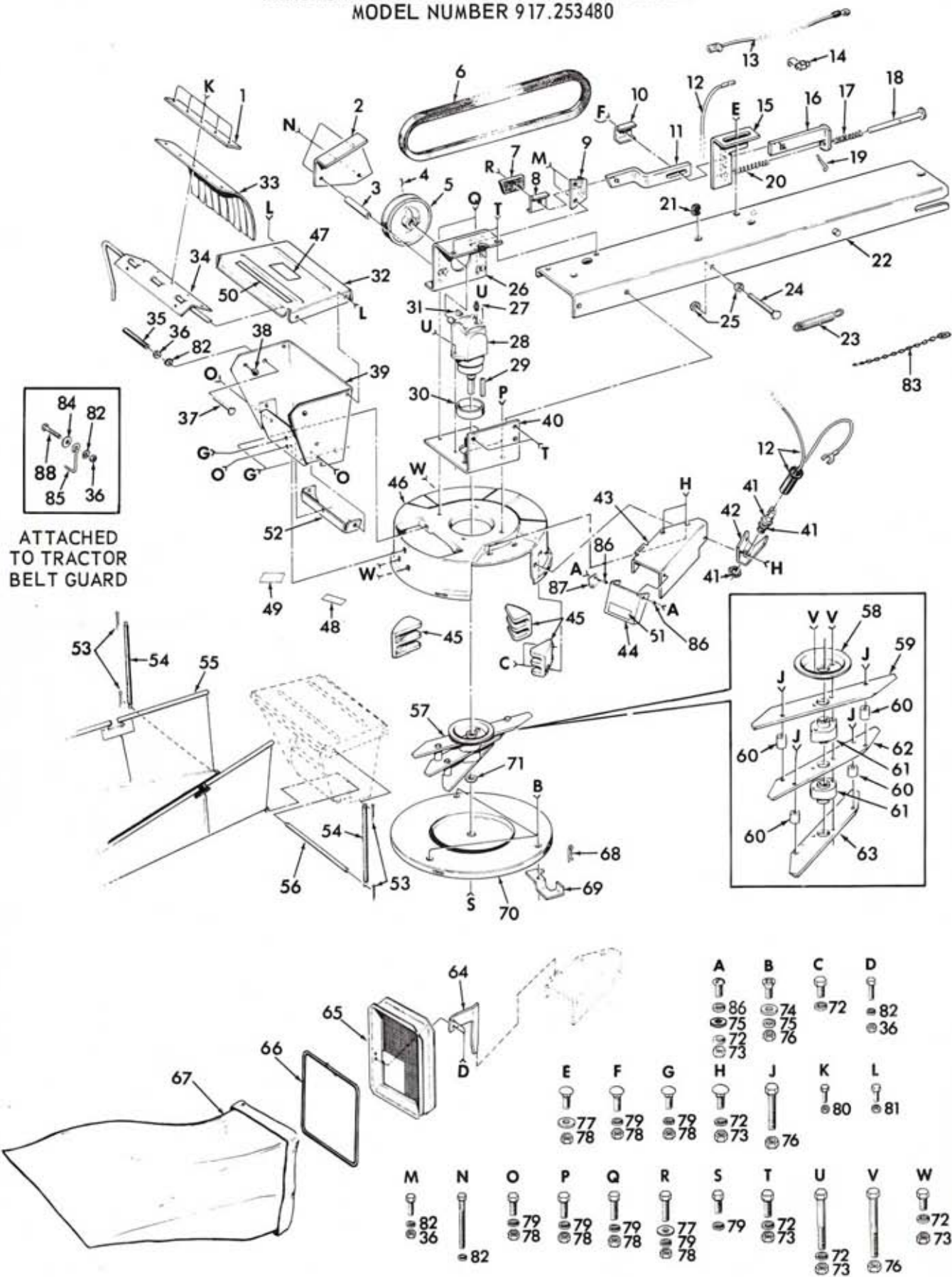

ATTACHED TO TRACTOR BELT GUARD

- |          |          |          |          |
|----------|----------|----------|----------|
| <b>A</b> | <b>B</b> | <b>C</b> | <b>D</b> |
| ⊕ 86     | ⊕ 74     | ⊕ 72     | ⊕ 82     |
| ⊕ 75     | ⊕ 75     |          | ⊕ 36     |
| ⊕ 72     | ⊕ 76     |          |          |
| ⊕ 73     |          |          |          |
| <b>E</b> | <b>F</b> | <b>G</b> | <b>H</b> |
| ⊕ 77     | ⊕ 79     | ⊕ 79     | ⊕ 72     |
| ⊕ 78     | ⊕ 78     | ⊕ 78     | ⊕ 73     |
|          |          |          | ⊕ 76     |
| <b>J</b> | <b>K</b> | <b>L</b> |          |
| ⊕ 76     | ⊕ 80     | ⊕ 81     |          |
| <b>M</b> | <b>N</b> | <b>O</b> | <b>P</b> |
| ⊕ 82     | ⊕ 82     | ⊕ 79     | ⊕ 79     |
| ⊕ 36     |          | ⊕ 78     | ⊕ 78     |
|          |          | ⊕ 78     | ⊕ 78     |
|          |          |          | ⊕ 78     |
|          |          |          | ⊕ 77     |
|          |          |          | ⊕ 79     |
|          |          |          | ⊕ 73     |
|          |          |          | ⊕ 76     |
|          |          |          | ⊕ 72     |
|          |          |          | ⊕ 73     |
|          |          |          | ⊕ 76     |

# repair parts

## TRACTOR SHREDDER/BAGGER ATTACHMENT MODEL NUMBER 917.253480

KEY NO.	PART NO.	DESCRIPTION	KEY NO.	PART NO.	DESCRIPTION
1	4619R	Deflector Strap	58	4562R	Seal Protector
2	4953R	Belt Guard	59	4659R	Blade
3	4964R	Split Spacer	60	4551R	Blade Spacer
4	4523P	Hex Soc. Hd. Setscrew Serr. Cup Pt. 5/16-24 x 3/8"	61	4566R	Blade Support
5	4689H1	Sheave	62	4660R	Blade
6	4965R	V-Belt	63	4661R	Blade
7	2629R	Brake Shoe	64	4927R	Hoop Support
8	2620R	Brake Shoe Holder	65	658A96	Bagging Attachment
9	2621R	Brake Bar Bracket-Front	66	6232R	Bag Band
10	4955R	Brake Bar Clamp	67	2710R	Plastic Bag
11	4950R	Brake Bar - Front	68	4940M	Retainer Spring
12	5612R	Safety Switch Wire Assembly	69	4570R	Latch
13	2633R	Shorting Wire - Rear	70	4578R	Bottom
14	2711R	Self-Stripping Tap Connector	71	2966R	Mandrel Washer
15	2622R	Brake Bar Bracket - Rear	72	1004P	* Lockwasher 3/8"
16	634A632	Brake Bar Weldment - Rear	73	501P	* Hex Nut 3/8-16
17	2877H	Spring	74	1528P	Washer 13/16 x 1-1/4 x 14 Ga.
18	2626R	Push Rod	75	1513P	* Washer 13/32 x 13/16 x 16 Ga.
19	2505P	Cotter 1/8 x 3/4"	76	5394H	Locknut 3/8-16
20	2876H	Spring	77	1511P	Washer 3/8 x 7/8 x 14 Ga.
21	2634R	Grommet	78	504P	* Hex Nut 5/16-18
22	634A633	Support Channel & Weld Pins	79	1003P	* Lockwasher 5/16"
23	5105H	Spring	80	4632H	Locknut #10-24
24	3031P	* Hex Bolt 3/8-16 x 2-1/2"	81	1605H	Locknut 1/4-20
25	501P	* Hex Nut 3/8-16	82	1002P	* Lockwasher 1/4"
26	634A635	Hanger Bracket - R.H. & Weld Nuts	83	2777R	Plastic Tie
27	2707R	Safety Vent Grease Fitting	84	1509P	Washer 5/16 x 3/4 x 16 Ga.
28	634A636	Right Angle Gear Box	85	6142R	Belt Guide
29	4552R	Square Key 3/16 x 3/16 x 2"	86	6067R	Adjustable Deflector Bushing
30	2619R	Gear Box Spacer	87	6071R	Adjustable Deflector Stop
31	2228M	Woodruff Key 3/16 x 3/4"	88	3003P	* Hex Bolt 1/4-20 x 3/4"
32	4648R	Cover	A	3264P	Truss Hd. Slotted Mach. Screw 3/8-16 x 1"
33	4628R	Rubber Deflector	B	3285P	Flat Hd. Slotted Mach. Screw 3/8-16 x 3/4"
34	658A74	Deflector Weldment	C	3020P	Hex Bolt 3/8-16 x 5/8"
35	4966R	Tubing for Bolt	D	3114P	* Hex Bolt 1/4-20 x 1/2"
36	503P	* Hex Nut 1/4-20	E	16P	* Carriage Bolt 5/16-18 x 3/4"
37	3287P	Hex Bolt 1/4-20 x 2"	F	17P	* Carriage Bolt 5/16-18 x 1"
38	4967R	Grommet	G	16P	* Carriage Bolt 5/16-18 x 3/4"
39	658A73	Hopper Weldment	H	19P	* Carriage Bolt 3/8-16 x 3/4"
40	4957R	Hanger Bracket - L.H.	J	3095P	Hex Bolt 3/8-16 x 1 1/4" GR5
41	2329R	Safety Switch & Nut	K	3218P	Hex Hd. Mach. Screw #10-24 x 1/2"
42	4954R	Safety Switch Bracket	L	3114P	* Hex Bolt 1/4-20 x 1/2"
43	4656R	Deflector	M	3115P	* Hex Bolt 1/4-20 x 5/8"
44	6763R	Adjustable Deflector	N	3283P	Hex Bolt 1/4-20 x 2-1/2"
45	4581R	Heavy Breaker	O	3009P	* Hex Bolt 5/16-18 x 5/8"
46	4674R	Engine Pad	P	3010P	* Hex Bolt 5/16-18 x 3/4"
47	5326R	Scotchcal (Nameplate)	Q	3011P	* Hex Bolt 5/16-18 x 1"
48	1415R	Decal (Patent Pending)	R	3011P	* Hex Bolt 5/16-18 x 1"
49	4959R	Model Plate (917.253480)	S	3263P	Hex Bolt 5/16-24 x 1 1/2" GR5
50	4961R	Decal (Caution)	T	3022P	Hex Bolt 3/8-16 x 7/8"
51	4960R	Decal (Caution)	U	3031P	* Hex Bolt 3/8-16 x 2 1/2"
52	4627R	Hopper Wrapper Gusset	V	3259P	Hex Bolt 3/8-16 x 3" GR5
53	2502P	Cotter Pin 3/32 x 1/2"	W	3020P	Hex Bolt 3/8-16 x 5/8"
54	4963R	Spring		4973R	Owner's Manual
55	634A634	Ramp Weldment			
56	4610R	Ramp Pivot Pin			
57	658A82	Blade Assembly			

4973R-21. 5. 74

# repair parts

## TRACTOR SHREDDER/BAGGER ATTACHMENT MODEL NUMBER 917.253480

Model No. 2929-P9I  
Service No. 794163

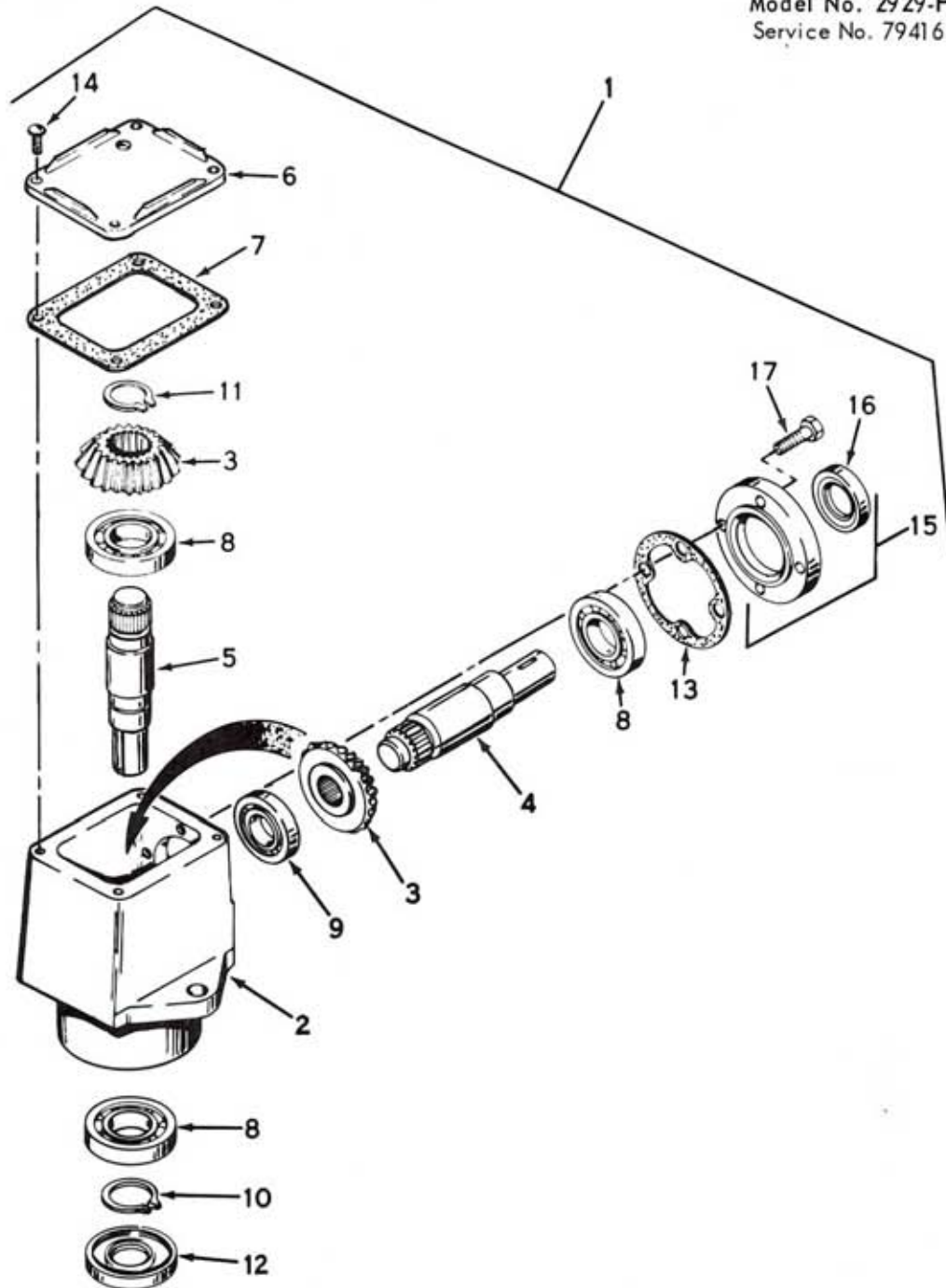

KEY NO.	PART NO.	DESCRIPTION	KEY NO.	PART NO.	DESCRIPTION
1	794163	Head Assy., Left Hand (Incl. Nos. 2 thru 15)	11	792018	Ring, Snap
2	770026	Housing, Right Angle Drive	12	788029	Seal, Oil
3	778046	Gear, Miter	13	788030	Gasket, Cap
4	776150	Shaft, Input	14	792025	Screw, Rd. Hd. Self Tap, 10-24 x 1/2
5	776163	Shaft, Output	15	786029	Cap & Seal Assy., Retainer (Incl. Nos. 16 & 17)
6	772067	Cover	16	788031	Seal, Oil
7	788028	Gasket, Cover	17	792026	Screw, Hex Hd. 1/4-20 x 7/8
8	780034	Bearing, Ball			
9	780024	Bearing, Ball			
10	788019	Ring, Snap			

notes

634W169

another free manual from [www.searstractormanuals.com](http://www.searstractormanuals.com)

**Sears**  
owners  
manual

The Model Number will be found on a plate attached to the Mill Housing. Always mention the Model Number when requesting service or repair parts for your Tractor Shredder/Bagger Attachment.

All parts listed herein may be ordered through SEARS, ROEBUCK AND CO. or SIMPSONS-SEARS LIMITED. When ordering parts by mail, selling prices will be furnished on request or parts will be shipped at prevailing prices and will be billed accordingly.

WHEN ORDERING REPAIR PARTS, ALWAYS GIVE THE FOLLOWING INFORMATION AS SHOWN IN THIS LIST.

1. The PART NUMBER
2. The PART DESCRIPTION
3. The MODEL NUMBER  
917.253480
4. The NAME OF ITEM—  
TRACTOR SHREDDER/  
BAGGER ATTACHMENT



When you buy merchandise from Sears you get an extra something that nobody else can offer . . . Sears Service.

Across town or across the country, wherever you live or move in the U.S.A., Sears Service follows you, providing trustworthy, competent service technicians using only Sears specified factory parts.

SEARS SERVICE  
IS AT YOUR SERVICE  
WHEREVER YOU LIVE  
OR MOVE  
IN THE U.S.A.