

Sears

owners manual

MOWER CHUTE

MODEL NO.
917.253630

CAUTION:
Read Instructions
Carefully

- Assembly
- Repair Parts



SEARS, ROEBUCK AND CO. U.S.A.

SIMPSONS-SEARS LIMITED, CANADA

PRINTED IN U. S. A.

VACUUM COLLECTOR CHUTE
 MODEL NO. 917.253630
 FOR
 CUSTOM TRACTOR 38" MOWERS
 WITH CAST ALUMINUM HOUSINGS

assembly

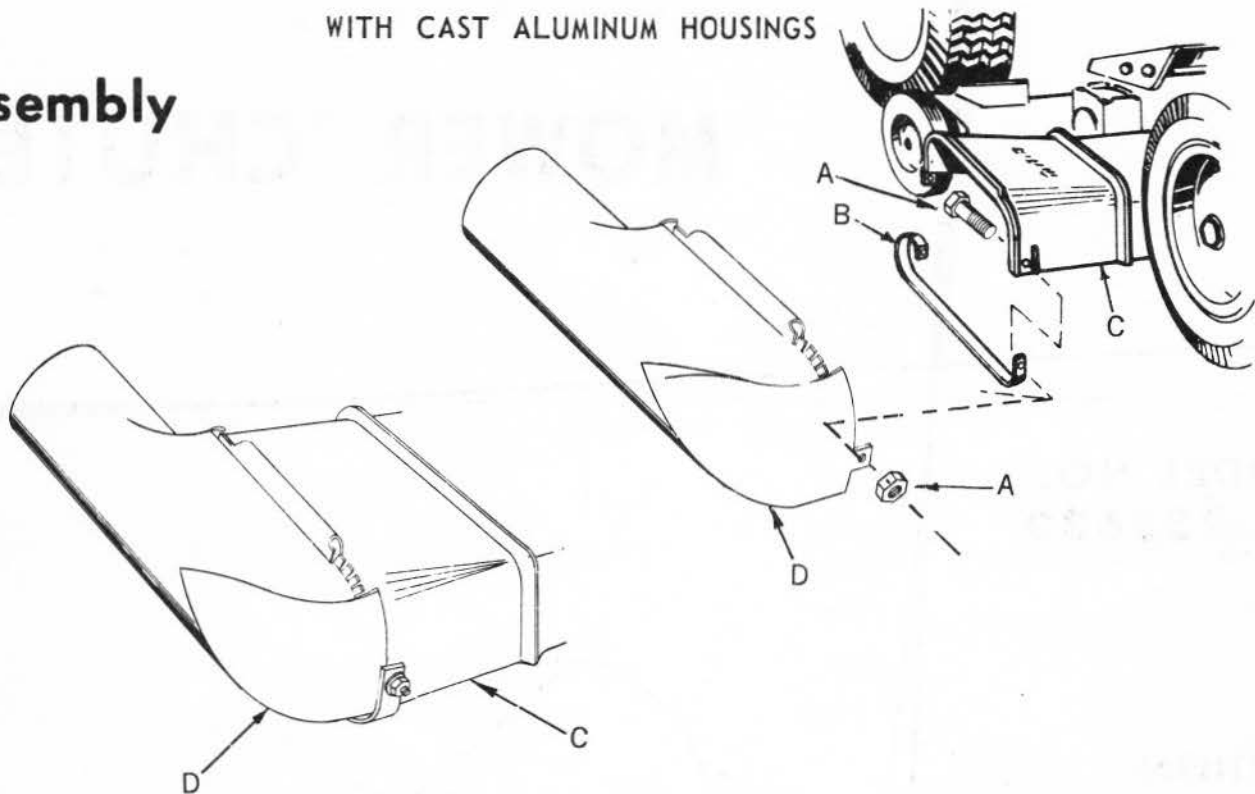

1. Remove nuts and machine screws (A), holding horn guard (B), to mower housing (C). Save and replace machine screws and nuts when mower Chute is removed.
2. Using the machine screws, nuts and lockwashers furnished with this Chute, assemble horn guard (B), and Chute (D), to mower housing (C). Head of machine screws to inside. Tighten nuts securely.
3. Refer to Vacuum Collector Manual for assembly of Vacuum Collector.

repair parts

KEY NO.	PART NO.	DESCRIPTION
1	7950H	Mower Chute
2	3011P	Machine Screw, Hex Hd. 5 16 - 18 UNC x 1
3	504P	Nut, Hex 5 16 - 18 UNC
4	1003P	Lockwasher 5 16
----	2297R	Owners Manual

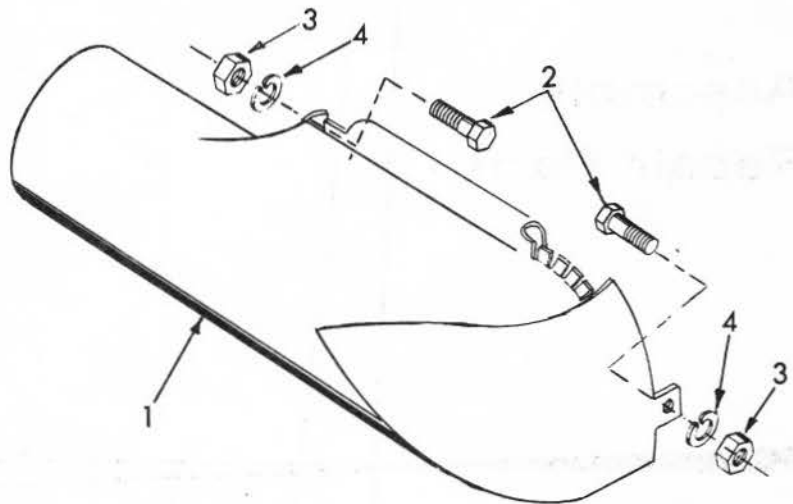

*Standard Hardware Items--May be Purchased Locally-Specify Plated

Keep this sheet with your Vacuum Collector Owners Manual for future use.

Sears, Roebuck and Co. or Simpsons-Sears Limited in Canada reserves the right to make any changes in design or improvements without imposing any obligation to install the same upon its items heretofore manufactured.