



**MODEL NO.
917.2540 10**

OWNER'S MANUAL

**Assembly
Operation**

**Maintenance
Repair Parts**

TOTE BOX

**IMPORTANT:
READ RULES FOR
SAFE OPERATION
AND INSTRUCTIONS
CAREFULLY**

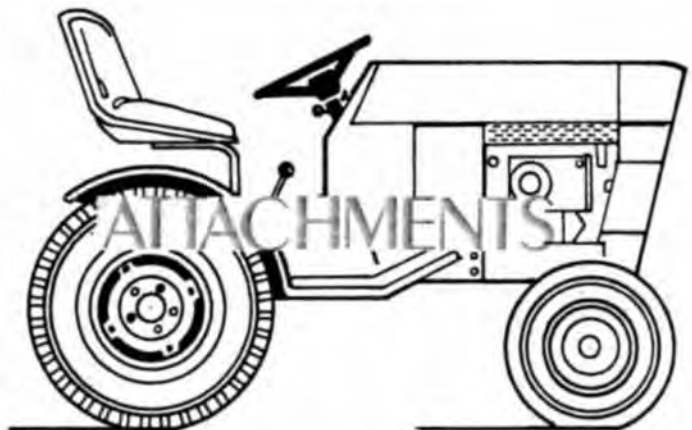

TABLE OF CONTENTS

ASSEMBLY INSTRUCTIONS	2
OPERATION INSTRUCTIONS	3
REPAIR PARTS	4

RULES FOR SAFE OPERATION

1. Know the controls and how to stop quickly. READ THE OWNER'S MANUAL.
2. Do not allow children to operate the vehicle. Do not allow adults to operate it without proper instruction.
3. Do not carry passengers. Keep children and pets a safe distance away.
4. Always wear substantial footwear. Do not wear loose fitting clothing that could get caught in moving parts.
5. Keep your eyes and mind on your tractor, mower and the area being cut. Don't let other interests distract you.
6. Do not attempt to operate your tractor or mower when not in drivers seat.
7. Always get on or off your tractor from the operators left hand side.
8. Clear the work area of objects which might be picked up and thrown.
9. Disengage all attachment clutches and shift into neutral before attempting to start the engine.
10. Disengage power to attachments and stop the engine before leaving the operator's position.
11. Disengage power to mower, stop the engine and disconnect spark plug wire(s) from spark plug(s) before cleaning, making an adjustment or repairs.
12. Disengage power to attachments when transporting or not in use. Drive slowly when attachment is in transport position.
13. Take all possible precautions when leaving the vehicle unattended, such as disengaging the power-take-off, lowering the attachments, shifting into neutral, setting the parking brake, stopping the engine, and removing the key.
14. Do not stop or start suddenly when going uphill or downhill. Mow up and down the face of slopes (not greater than 15°); never across the face.
15. Reduce speed on slopes and make turns gradually to prevent tipping or loss of control. Exercise extreme caution when changing direction on slopes.
16. Do not shift gears while going up or down slopes. Choose a gear low enough to negotiate the slope without stopping and shifting gears. To reduce speed, move throttle lever to slow.
17. Never mow in wet or slippery grass, when traction is unsure or at a speed which could cause a skid.
18. Stay alert for holes in the terrain and other hidden hazards.
19. Do not drive too close to creeks, ditches and public highways.
20. Exercise special care when mowing around fixed objects in order to prevent the blades from striking them. Never deliberately run tractor or mower into or over any foreign object.
21. Never shift gears until tractor comes to a stop.
22. Never place hands or feet under the mower, in the deflector (discharge chute) or near any moving parts while tractor or mower are running. Always keep clear of discharge chute.
23. Use care when pulling loads or using heavy equipment.
 - a. Use only approved drawbar hitch points.
 - b. Limit loads to those you can safely control.
 - c. Do not turn sharply. Use care when backing.
 - d. Use counterweights or wheel weights when suggested in this owner's manual.
24. Watch out for traffic when crossing or near roadways.
25. When using any attachments, never direct discharge of material toward bystanders nor allow anyone near the vehicle while in operation.
26. Handle gasoline with care - it is highly flammable.
 - a. Use approved gasoline containers.
 - b. Never remove the cap of the fuel tank or add gasoline to a running or hot engine, or fill the fuel tank indoors. Wipe up spilled gasoline.
 - c. Open doors if the engine is run in the garage - exhaust fumes are dangerous. Do not run the engine indoors.
27. Keep the vehicle and attachments in good operating condition, and keep safety devices in place. When using Three Point Hitch remove attachment from hitch before making any repairs on attachment or hitch.
28. Keep all nuts, bolts and screws tight, all cotter pins and retainer springs in place to be sure the equipment is in safe working condition.
29. Never store the equipment with gasoline in the tank inside a building where fumes may reach an open flame or spark. Allow the engine to cool before storing in any enclosure.
30. To reduce fire hazard, keep the engine free of grass, leaves or excessive grease.
31. The vehicle and attachments should be stopped and inspected for damage after striking a foreign object, and the damage should be repaired before restarting and operating the equipment.
32. Do not change the engine governor settings or overspeed the engine.
33. When using the vehicle with mower, proceed as follows:
 - a. Mow only in daylight or in good artificial light.
 - b. Never make a cutting height adjustment while the engine is running if the operator must dismount to do so.
 - c. Shut the engine off when removing the grass catcher or unclogging chute.
 - d. Check the blade mounting bolts for proper tightness at frequent intervals.
34. Check the grass catcher bags frequently for wear or deterioration. Replace with new bags for safety protection.
35. Do not fill Tote Box over a volume of 2 - 1/2 cubic feet (level full) or a capacity of 200 lbs.
For Example: Limestone - fill Box 1/2 full.
Wet Sand - fill Box 2/3 full.



LOOK FOR THIS SYMBOL TO POINT OUT IMPORTANT SAFETY PRECAUTIONS. IT MEANS-ATTENTION! BECOME ALERT! YOUR SAFETY IS INVOLVED.

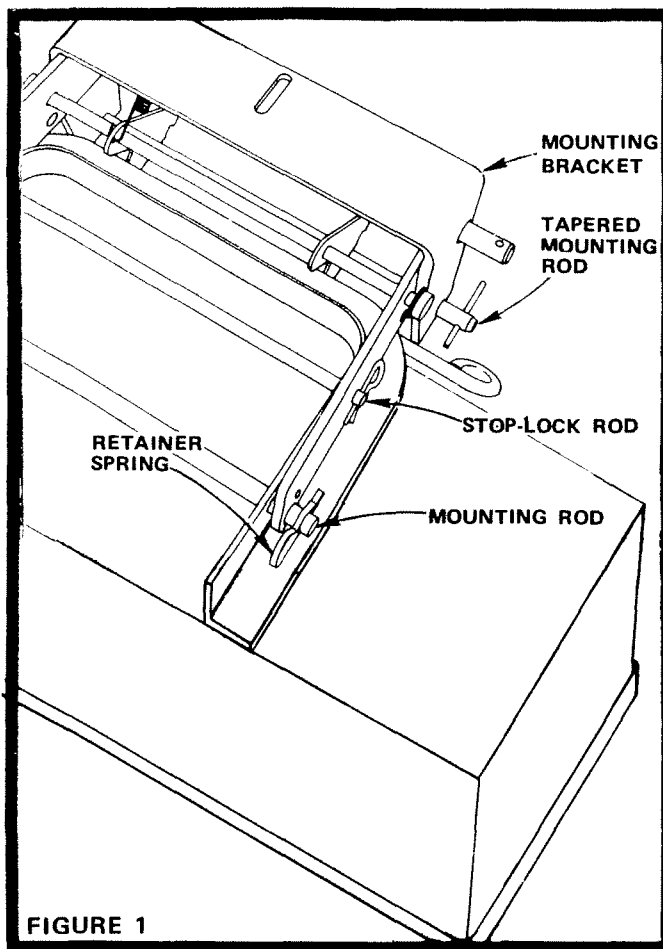

FIGURE 1

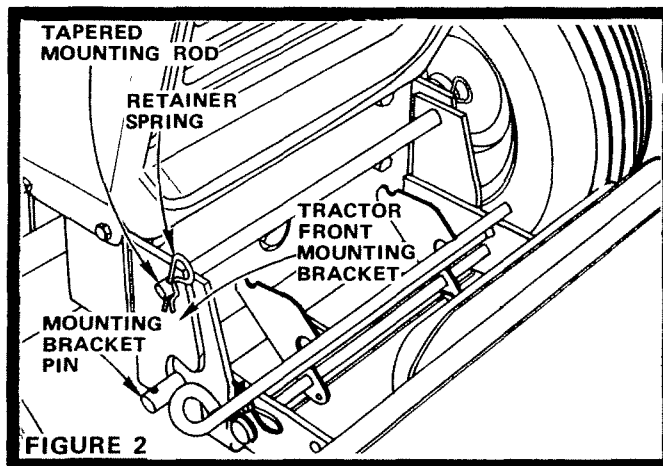
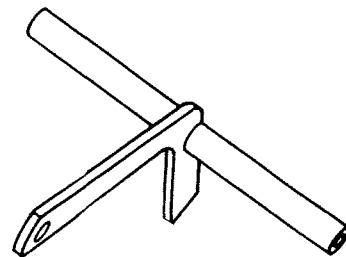

FIGURE 2

ASSEMBLY MOUNTING TO TRACTOR FRONT

1. Assemble your Tractor Front Mounting Bracket (Fig. 2) to tractor per instructions with Bracket. Save Mounting Rod and Retainer Springs for other applications.
2. Position Tote Box upside down on floor (Fig. 1).
3. Remove Retainer Springs from Mounting Rod and remove Rod.
4. Rotate Mounting Bracket 180° to position shown in Fig. 1. Insert Mounting Rod in same location removed in step 3 and secure with Retainer Springs.
5. Set Tote Box upright and slide Mounting Bracket Pins into slots of Tractor Front Mounting Bracket (Fig. 2).
6. Remove Retainer Springs from Tapered Mounting Rod (Fig. 1) and remove Rod.
7. Line up upper holes in Tractor Front Mounting Bracket with holes in Mounting Bracket, insert Tapered Mounting Rod (removed in step 6) thru holes and secure with Retainer Springs (Fig. 2).
8. Save Hitch Mast and Tube (shown below) for use when mounting Tote Box to tractor rear.



MOUNTING TO TRACTOR REAR

1. Assemble your Manual or Electric Three Point Hitch to tractor per instructions with Hitch.
2. Position Tote Box upside down on floor (Fig. 1).
3. Remove Retainer Springs from Mounting Rod and remove Rod.
4. Rotate Mounting Bracket 180° to position shown in Fig. 1. Insert Mounting Rod in same location removed in step 3 and secure with Retainer Springs.
5. Set box upright.
6. Remove Retainer Springs from Tapered Mounting Rod (Fig. 1) and remove Rod.
7. Position Hitch Mast and Tube in Mounting Bracket (Fig. 3) with end of Hitch Mast (without hole) inserted into slot of Mounting Bracket. Line up holes in Tube with holes in Mounting Bracket, insert Tapered Mounting Rod and secure with Retainer Springs.
8. Place Hitch Mast in Three Point Hitch Clevis and secure with Clevis Pin and Retainer Spring.
9. Position Lower Hitch Bars of Three Point Hitch over Mounting Bracket Pins and secure with Retainer Springs.
10. Level Box from side to side.
 - a. Loosen Lift Link Locknut (Fig. 3).
 - b. Turn Link Adjustment Sleeve counterclockwise to lengthen linkage.
 - c. After adjusting, tighten Locknut against Link Adjustment Sleeve.
11. Level Box from front to rear.
 - a. Loosen Adjusting Screw Locknut located against Tractor Clevis.
 - b. Turn Adjusting Screw clockwise to lengthen the top linkage.
 - c. After adjusting, tighten the Adjusting Screw Locknut against the Tractor Clevis.

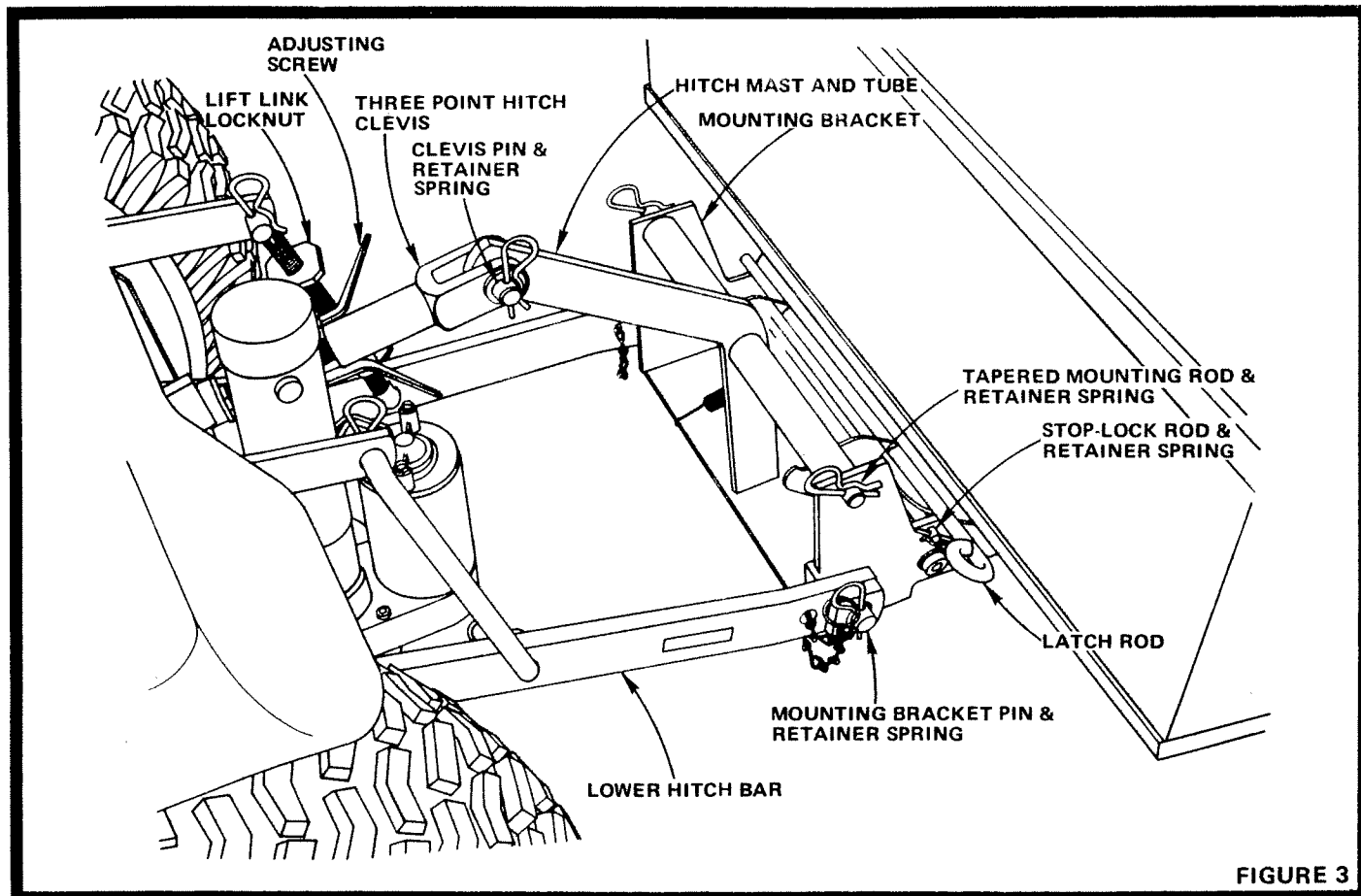

FIGURE 3

INSTRUCTIONS BEFORE OPERATION



DO NOT FILL THE TOTE BOX OVER A VOLUME OF 2 - 1/2 CUBIC FEET (LEVEL FULL) OR A CAPACITY OF 200 LBS. FOR EXAMPLE:

LIMESTONE-FILL BOX 1/2 FULL.
WET SAND-FILL BOX 2/3 FULL.



FOR ADDED STABILITY USE WEIGHTS ON THE REAR OF THE TRACTOR WHEN TOTE BOX IS MOUNTED TO FRONT OR WEIGHTS ADDED TO FRONT OF TRACTOR WHEN TOTE BOX IS MOUNTED TO REAR.

Make sure all Retainer Springs are secure.

OPERATION

FOR DUMPING OPERATION

1. Leave the Stop-Lock Rod in shipping position and make sure the two smallest Retainer Springs are placed as shown (Fig. 3) to prevent interference in dumping Tote Box.
2. Pull Latch Rod toward tractor to dump box (Fig. 3). A rope (Owner furnished) can be attached to the Latch Rod so that box can be dumped without dismounting from tractor.

FOR RIGID OPERATION

Reposition the Stop-Lock Rod in the holding position shown (Fig. 1) in Mounting Bracket. Secure with Retainer Springs.

TO REMOVE FRONT MOUNTED TOTE BOX

1. Remove Retainer Springs from Mounting Rod and remove Rod (Fig. 2).
2. Raise Box upward and outward.

TO REMOVE REAR MOUNTED TOTE BOX

1. Lower Tote Box to its lowest position.
2. Remove Retainer Spring from Clevis Pin and remove Pin (Fig. 3).
3. Remove Retainer Springs from Pins of Mounting Bracket. Pull Lower Hitch Bars from Pins.

STORAGE

When Tote Box is not being used, remove all dirt and rust and touch up with paint.

Apply a light coat of grease or oil to all pivot points.

Store in an area protected from the weather.

Sears, Roebuck and Co. and Simpsons-Sears Limited reserves the right to make any changes in design or improvements without imposing any obligation to install the same upon its items heretofore manufactured.

TOTE BOX--MODEL NUMBER 917.254010

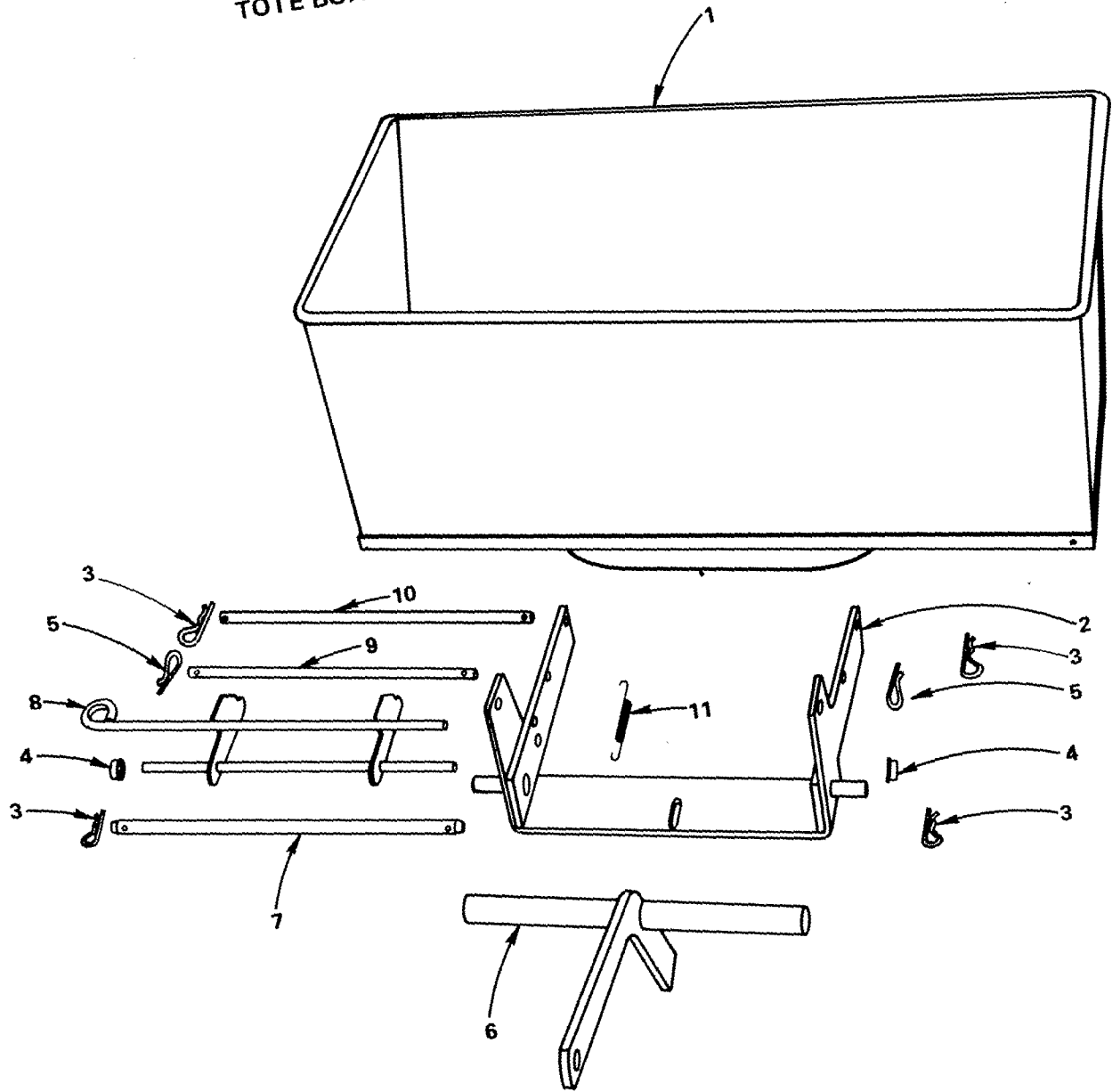

another free manual from www.searstractormanuals.com

KEY NO.	PART NO.	DESCRIPTION
1	673A141	Box Assembly
2	673A77	Mounting Bracket Weldment
3	4940M	Retainer Spring
4	9423R	Push Nut
5	4921H	Retainer
6	673A78	Stop - Lock Rod
7	9273R	Mounting Rod
8	673A79	Return Spring
9	9390R	Owner's Manual
10	9388R	
11	221J	
--	9604R	

Sears

**MODEL NO.
917.254010**

HOW TO ORDER REPAIR PARTS

MODEL NUMBER

The Model Number will be found on the Model Plate attached to the Mounting Bracket Weldment. Always mention the Model Number when requesting service or repair parts for your Tote Box.

REPAIR PARTS

All parts listed herein may be ordered from any SEARS, ROEBUCK AND CO. or SIMPSONS-SEARS LIMITED retail or catalog store.

WHEN ORDERING REPAIR PARTS, ALWAYS GIVE THE FOLLOWING INFORMATION:

- THE PART NUMBER
- THE PART DESCRIPTION
- THE MODEL NUMBER
- THE NAME OF MERCHANDISE

If the parts you need are not stocked locally, your order will be electronically transmitted to a Sears Repair Parts Distribution Center for "expedited handling".

Roebuck and Co., Chicago, Ill. 60684, U.S.A.
Simpsons Sears Limited, Toronto, Canada