

ASSEMBLY, OPERATING INSTRUCTIONS  
AND PARTS LIST FOR

**SEARS**  
**CULTIVATOR**  
FOR SEARS SUBURBAN OR  
CUSTOM RIDING TRACTOR

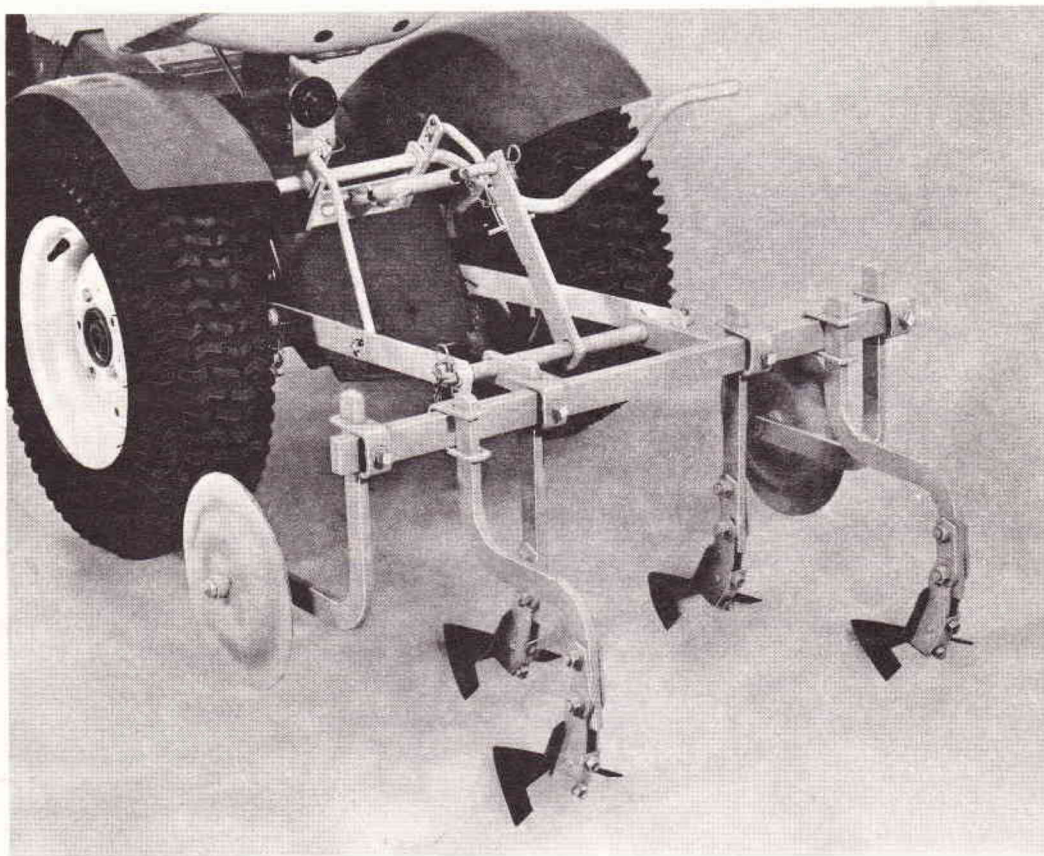

MODEL NUMBER  
917.60605



**SEARS, ROEBUCK AND CO.—U.S.A.**

SIMPSONS-SEARS LIMITED — CANADA

7623H

PRINTED IN U. S. A.

## INTRODUCTION

Setting Up and Operating Instructions should be studied very closely before beginning to assemble your Cultivator. A number at the beginning of a paragraph in the following instructions refers to an arrow in the adjoining figure except when otherwise stated. When R.H. (Right Hand) and L.H. (Left Hand) are used, it should be understood to mean from a position behind and facing the Cultivator (or direction of travel).

Your shipment consists of the following packages, depending upon how the Cultivator was ordered.

### STANDARD EQUIPMENT

Stock No. 32-25124 Cultivator with Sweeps

or

Stock No. 32-25125 Cultivator with Shovels

### OPTIONAL EQUIPMENT

Stock No. 32-25127 Pair of Weeding Hoes with Shanks

Stock No. 32-25128 Pair of Hillers with Shanks

Stock No. 32-25126 Sweep 6" with Shank

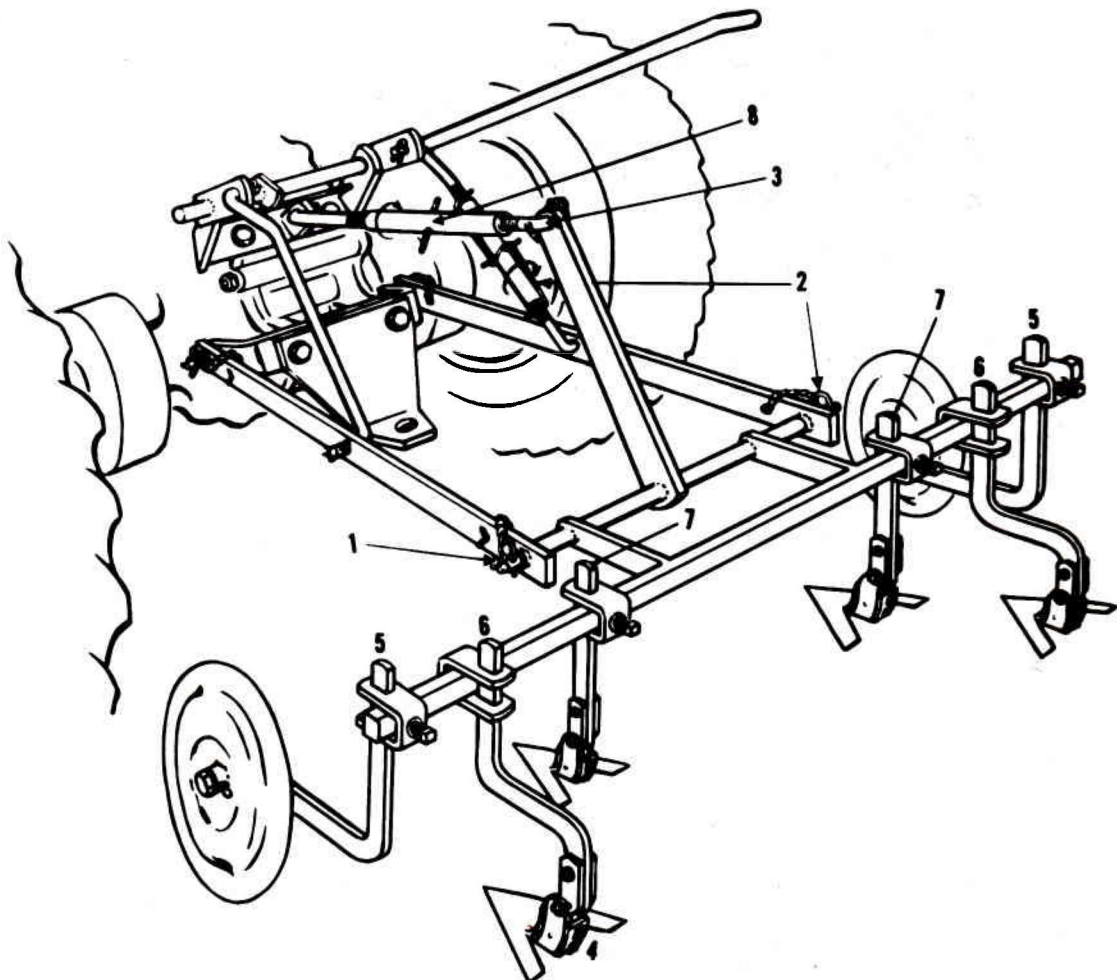

FIG. A

## SETTING UP INSTRUCTIONS

Cut wires holding the group of sweeps or shovels together in shipping position. Loosen set screws in shank clamps, refer to Fig. D, Illustration 13, and remove complete assemblies, Fig. A, Illustrations 5, 6, and 7 from frame bar.

### INSTRUCTIONS FOR ASSEMBLING CULTIVATOR FRAME TO TRACTOR

Cut all wires.

NOTE: See Three Point Hitch Instruction Book for assembling Three Point Hitch.

1. Refer to Illustration 1. Position frame bar as shown. Back tractor into position to attach Cultivator and slip L.H. link over L.H. link pin on Cultivator and secure with spring retainer.

2. Refer to Illustration 2. Slip R.H. link over R.H. link pin on Cultivator and secure with spring retainer.

NOTE: R.H. lift link is adjustable. Rotate turnbuckle so that R.H. bottom link slides over R.H. link pin on Cultivator easily and frame is level.

3. Refer to Illustration 3. Assemble top link to Cultivator as shown and secure with spring retainer.

### INSTRUCTIONS BEFORE ASSEMBLING CULTIVATOR

NOTE: Check tires to see that they are properly inflated. It is important that set-ups be done on level ground. An ideal situation would be a cement driveway, a cement platform, etc.

For general field cultivation before planting, refer to pages 4 and 5.

It is recommended that two settings be used to cultivate your land after planting. Straddle Row Cultivating (Assembly instructions below), will clean out the weeds next to your plants. Between Row Cultivating (Assembly instructions on page 4), will clean out the weeds in the center of the rows. It is possible that you will want to cultivate twice with the Straddle Row Setting before changing your Cultivator to the Between Row Setting.

### INSTRUCTIONS FOR STRADDLE ROW SETTING

Refer to Fig. A, Page 2.

Handles rows from 20" to 30" apart.

1. Illustration 4. Mount sweeps or shovels to shanks by means of the bolts and washer plate shipped in place in shank side assembly. Heads of bolts to sweep or shovel.
2. Illustration 5. Position and secure shank clamp with shank and gauge wheel attached to R.H. and L.H. ends of frame bar.
3. Illustration 6. Position and secure shank clamp, with offset shank and sweep or shovel attached, to frame bar as shown.
4. Illustration 7. Position and secure shank clamp, with straight shank and sweep or shovel attached, to frame bar as shown.
5. Be sure all sweeps or shovels touch level surface at the same time. Now move gauge wheels with shanks so that they are 1" higher or that shovels or sweeps will penetrate to desired depth.
6. Tighten all set screws in shank clamps securely.

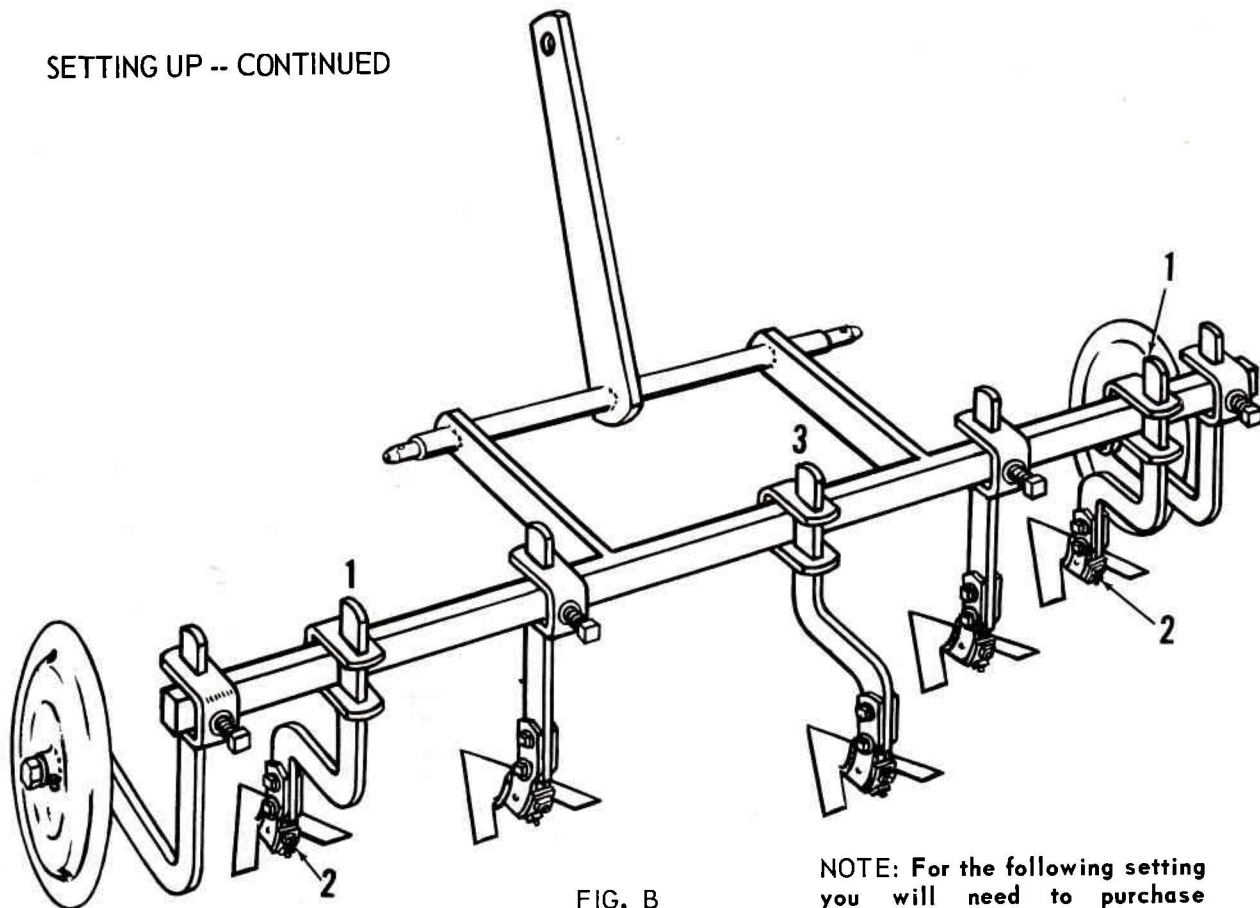

FIG. B

### INSTRUCTIONS FOR BETWEEN ROW SETTING

Handles rows 36" wide or wider.

1. Illustration 1. Loosen set screw in shank clamps of offset shanks and remove shank with sweep or shovel attached from shank clamps.
2. Illustration 2. Remove (575PA272) - shank side assembly, by removing two bolts (square neck carriage bolt 7/16" x 1-1/2" - 14 NC) - see parts list. Position 575PA272 as shown and tighten. Reassemble offset shanks in shank clamps as shown.
3. Illustration 3. Position and secure shank clamp, with offset shank and sweep attached, to center of frame bar as shown. This unit is sold as optional equipment.
4. Be sure all sweeps or shovels touch level surface at the same time. If not, adjust shanks up or down in shank clamps. Also, refer to "Leveling the Cultivator", Page 6. Adjust gauge wheel height to meet your requirements.
5. Tighten all set screws in shank clamps securely.

NOTE: For the following setting you will need to purchase Stock No. 32-25126. See "Optional Equipment", Page 2.

### GENERAL FIELD CULTIVATION BEFORE PLANTING

Refer to Fig. C, Page 5.

Only early, frequent and persistent cultivation will kill noxious weeds. For low cost eradication of these weeds, we suggest the cultivator setting as shown in Fig. C. In regions of low average rainfall it not only kills weeds quickly, but leaves a roughened surface that holds snow, absorbs moisture, and effectively retards evaporation. Under most conditions, even though the surface soil may be quite dry and pulverized, the sweeps or shovels dig deep enough to bring clods of dirt to the surface. The valuable loose top soil sifts down below the clods where there is much less possibility of its being carried away by wind or water.

This means of cultivation will do a job similar to a spring tooth harrow and is very effective in preparing seedbeds. The lifting action of the sweeps or shovels is particularly beneficial in a late, cold spring, breaking clods and stirring the soil after discing, so that air can circulate throughout the seedbed.

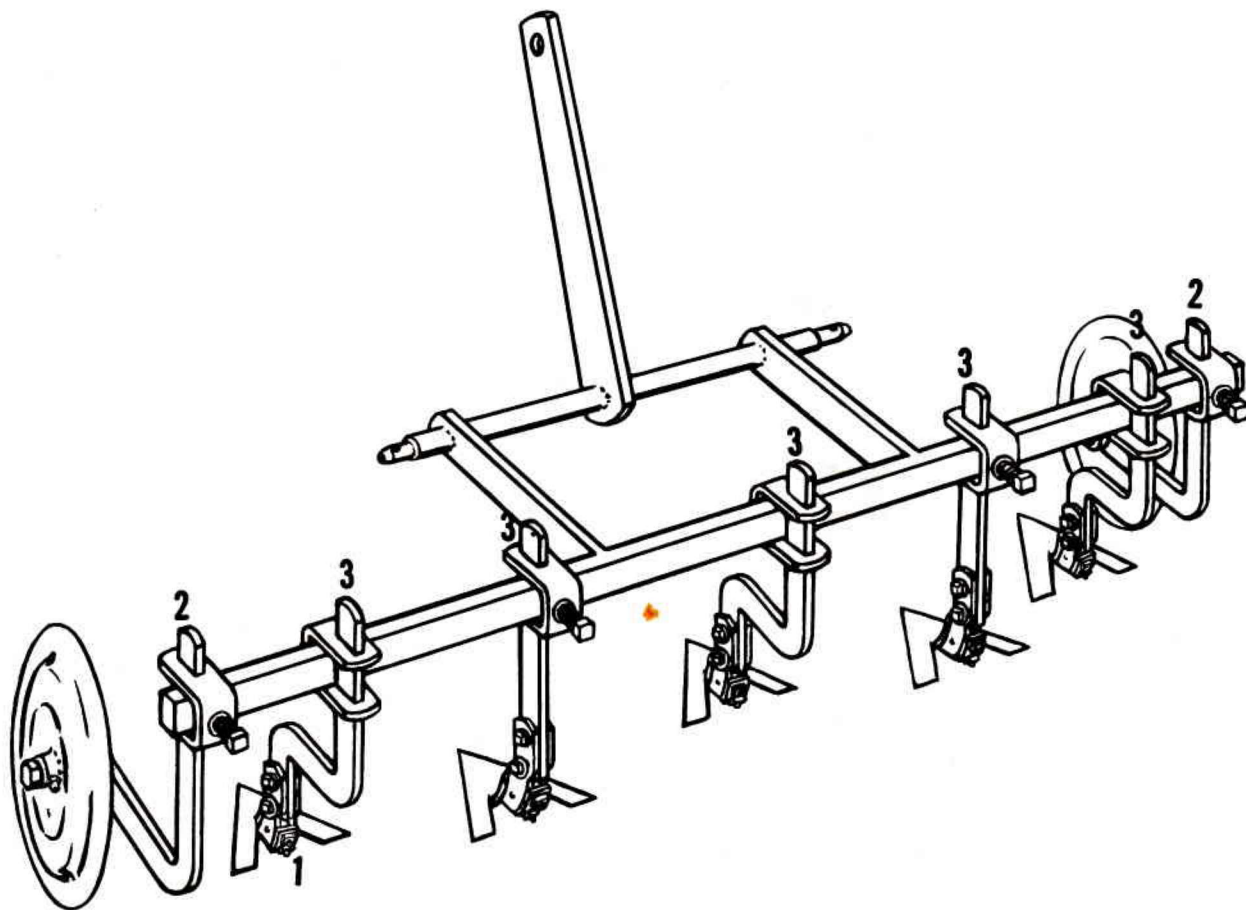

FIG. C

NOTE: For the following setting you will need to purchase Stock No. 32-25126. See "Optional Equipment", Page 2.

### GENERAL FIELD CULTIVATION

1. Attach cultivator frame to tractor, refer to "Instructions for Assembling Cultivator Frame to Tractor", Page 3.
2. Illustration 1. Mount sweeps or shovels to shanks by means of the bolts and washer plate shipped in place in shank side assembly. Heads of bolts to sweep or shovel.
3. Illustration 2. Position and secure shank clamp with shank and gauge wheel attached to R.H. and L.H. ends of frame bar.
4. Illustration 3. Position and secure the five shank clamps with shanks and sweeps or shovels attached, to frame bar as shown.
5. Be sure sweeps or shovels touch level surface at the same time. If not, adjust shanks up or down in shank clamps. Also refer to "Leveling the Cultivator", Page 6. Adjust gauge wheel height to meet your requirements for proper penetration of sweeps or shovels.
6. Tighten all set screws in shank clamps securely.

## OPERATING INSTRUCTIONS

### WEEDING HOES AND SHANKS

For use on the first cultivation or for any small and tender plants. They permit cultivating close to small plants without covering them with soil. Attach by removing front sweep and shank and replacing with weeding hoe and shank. May also be used without sweeps or shovel or in more than one pair at any position on the frame bar as desired.

### HILLERS AND SHANKS

Hillers are usually used in place of the front sweep and shank for hilling any kind of plant. Attach by removing the front sweep and shank and replacing with hiller and shank. They may be moved to any desired position on the beam and up or down to the desired height. They may also be used with or without sweeps or shovels. By reversing the hillers and setting them together, they may be used as furrow openers.

### LEVELING CULTIVATOR

There are turnbuckles on the linkage of the Three Point Hitch for leveling the Cultivator. The turnbuckle (Illustration 2, Fig. A, Page 2), on the R.H. lift link, is used for leveling the Cultivator from side to side. Adjust R.H. lift link so that the sweeps or shovels of the Cultivator touch level surface at the same time. Rotate turnbuckle from left to right to lengthen linkage as shown.

### TOP LINK

When cultivating, adjust the top link (Illustration 8, Fig. A, Page 2) so that the frame of the Cultivator is parallel with the ground from front to rear. Rotate turnbuckle to the right (clockwise) to lengthen the top linkage as shown.

### SWEEP ADJUSTMENT

Refer to Fig. D. The angle or suck of the shovels or sweeps can be adjusted by loosening the bolts (Illustration 18), in the shank sides (Illustration 11), and moving the point of the shovel or sweep forward or backward to desired position and retightening bolts.

## MAINTENANCE AND SERVICE INSTRUCTIONS

At least every four hours, tighten all bolts, nuts and set screws. Grease gauge wheels by means of one grease fitting in each wheel (Illustration 7, Fig. D).

When Cultivator is to be stored for any long period of time, it should be thoroughly cleaned and all shovels, sweeps, etc. given a good coat of grease or rust preventative.

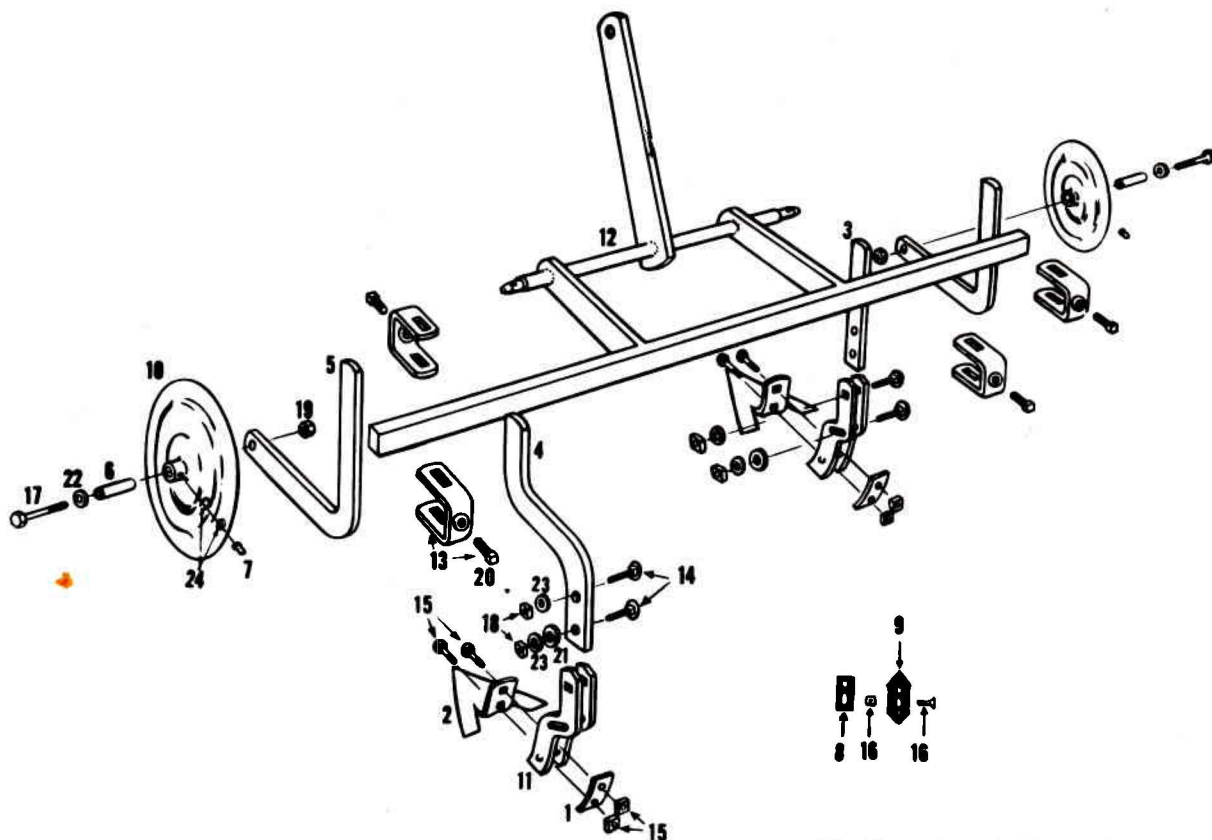

FIG. D

All Unnumbered Parts Interchangeable with Opposite Side

WHEN ORDERING REPAIR PARTS, ALWAYS GIVE THE FOLLOWING INFORMATION AS SHOWN IN THIS LIST:

1. The PART NUMBER.
2. The PART NAME.
3. The MODEL NUMBER -- 917.60605.
4. The NAME OF ITEM -- CULTIVATOR.

PARTS LIST

Do not use Key Numbers when ordering repair parts, always use Part Numbers.

| Key No. | Part No. | Description   | Key No. | Part No. | Description                                     |
|---------|----------|---|---------|----------|---|
| 1       | 361H     | Washer Plate  | 15      | 02450618 | Bolt, Sq. Neck Plow 3/8 x 2 1/4-16 NC with Nut  |
| 2       | 365H     | Sweep   | 16      | 02450720 | Bolt, Sq. Neck Plow 7/16 x 2 1/2-14 NC with Nut |
| 3       | 1333H    | Shank - Straight  | 17      | 04010852 | Cap Screw, Hex Hd. 1/2 x 3 1/2 ASRU-13 NC       |
| 4       | 1334H    | Shank - Offset  | 18      | 03010700 | Nut, 7/16-14 NC                                 |
| 5       | 1335H    | Wheel Shank   | 19      | 03030800 | Nut, Hex 1/2-13 NC                              |
| 6       | 1337H    | Wheel Bearing   | 20      | 04440816 | Set Screw, Sq. Head Oval Point 1/2 x 1-20 NF    |
| 7       | 6855M    | Grease Fitting  | 21      | 08162014 | Washer, Flat 1/2 x 1 1/4 x 14 Ga.               |
| 8       | 8149M    | Washer Plate  | 22      | 08171713 | Washer, Flat 17/32 x 1-1/16 x 13 Ga.            |
| 9       | 8153M    | Double Point Shovel   | 23      | 10030700 | Washer, Lock 7/16                               |
| 10      | 575PA35  | Gauge Wheel   | 24      | 1899H    | Washer, Flat                                    |
| 11      | 575PA272 | Shank Side Assembly   | ---     | 7623H    | Instruction and Parts Book                      |
| 12      | 606A46   | Frame   |         |          |   |
| 13      | 606A121  | Shank Clamp with Set Screw                                    |         |          |   |
| 14      | 02440712 | Bolt, Sq. Neck Carriage 7/16 x 1 1/2-14 NC with 3/16 Shoulder |         |          |   |

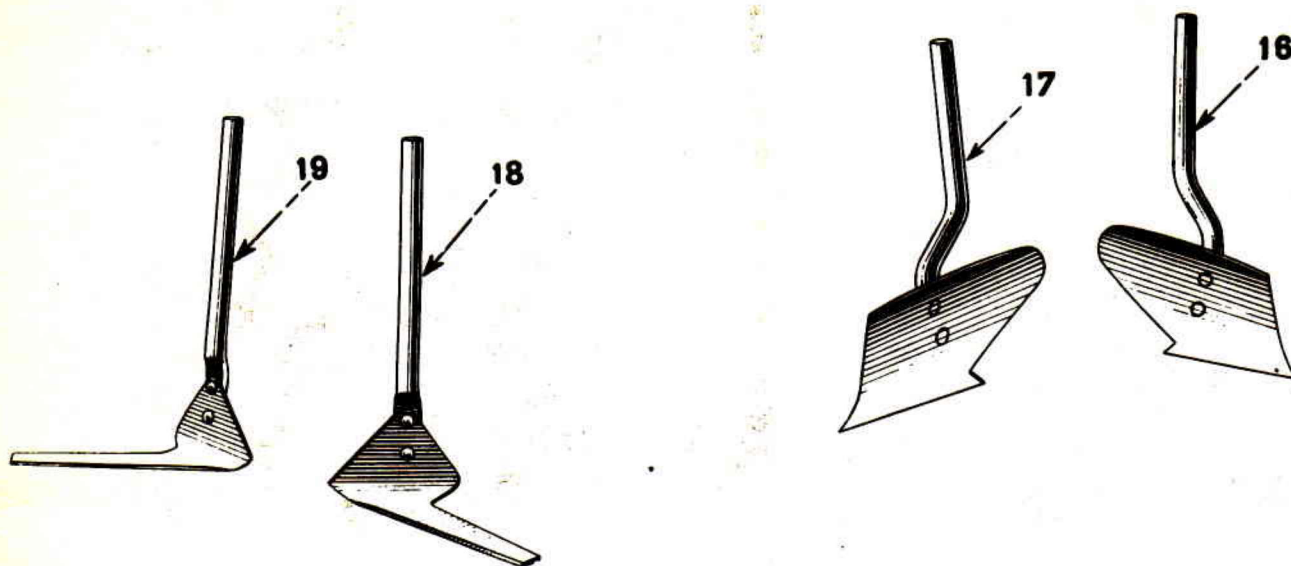

WEEDING HOES

HILLERS

FIG. E

WHEN ORDERING REPAIR PARTS, ALWAYS GIVE THE FOLLOWING INFORMATION AS SHOWN IN THIS LIST:

1. The PART NUMBER.
2. The PART NAME.
3. The MODEL NUMBER -- 917.60605.
4. The NAME OF ITEM -- CULTIVATOR.

PARTS LIST

| Key No. | Part No. | Description             |
|---------|----------|-------------------------|
| 16      | 606A118  | Shank and Hiller - L.H. |
| 17      | 606A119  | Shank and Hiller - R.H. |
| 18      | 606A116  | Shank and Hoe - L.H.    |
| 19      | 606A117  | Shank and Hoe - R.H.    |