

471
215

OWNERS MAN



**SEARS
SUBURBAN 725
RIDING TRACTOR**

**MODEL NUMBERS
917.60633
AND
917.60634**

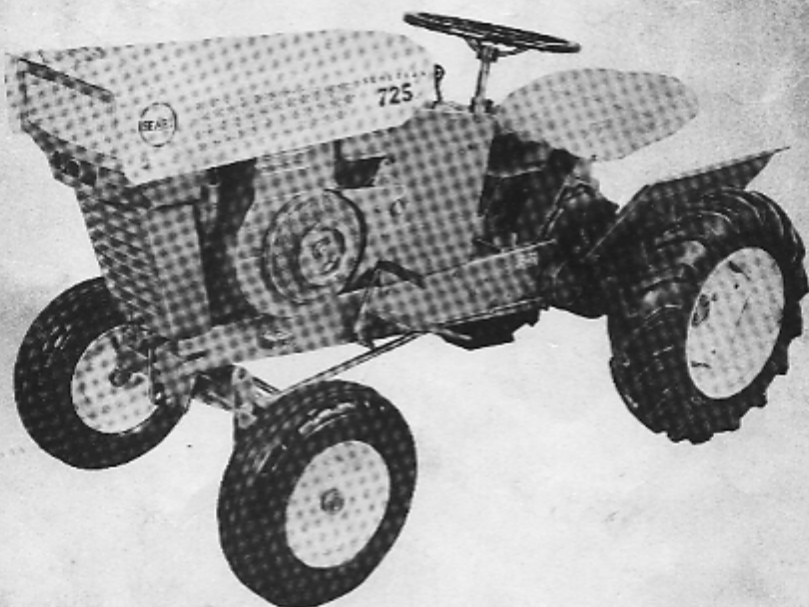

another free manual from www.searstractormanuals.com

SEARS, ROEBUCK AND CO. - U.S.A.
SIMPSONS-SEARS LIMITED - CANADA

INTRODUCTION

DESCRIPTION	PAGE	DESCRIPTION	PAGE
GENERAL INFORMATION	3	MAINTENANCE AND SERVICE	
OPTIONAL EQUIPMENT	3	INSTRUCTIONS	8 thru 13
SETTING UP INSTRUCTIONS	4	Care of Battery	8
LUBRICATION CHART	5	Battery Storage	8
OPERATING INSTRUCTIONS	6 and 7	Winter Storage of Tractor	8
Cold Weather Starting with		Belt Tightener	8
12 Volt Starter	6	Adjust Speed	9
Starting and Stopping Engine ...	6	Clutch Throwout Plate	10
Driving the Tractor	7	Clutch Adjustment	10
Towing Tractor	7	Adjust Clutch Lever Lock	11
Brake	7	Reverse Adjustment	12
Reverse	7	Adjust Brake	13
Variable Speed	7	Seat	13
Tires	7	Wheel Adjustment	13
Wheel Weights	7	HOW TO ORDER REPAIR PARTS ..	13
		PARTS LIST	15 thru 27

another free manual from www.seartractormanuals.com

INTRODUCTION

Your tractor is ruggedly built for plenty of stamina and long life. You will be delighted with its ease in maneuvering. The design of your tractor will give you the superior performance you have a right to demand of any tractor of this size. Properly adjusted, maintained and operated, it will respond to every reasonable demand you make upon it, and will give you reliable service for years.

GENERAL INFORMATION

Keep this book handy at all times, familiarize yourself with the operating instructions before beginning to operate your tractor.

Each tractor is given a thorough inspection before shipment, however, it is important that it be again thoroughly checked at the time of receipt, to ascertain if any damage has occurred in transit.

Your tractor is shipped complete.

- 1 Carton 606 x 50 Tractor with Recoil Starter or
- 1 Carton 606 x 49 Tractor with 12 Volt Starter and Generator

OPTIONAL EQUIPMENT

Catalog Number 9959	Three Point Hitch
Catalog Number 9805	Pair of Rear Wheel Weights
Catalog Number 99828	Dual Wheels
Catalog Number 9830	Front End Weight
Catalog Number 9860	Electric Starter Conversion Kit for Tractors with Recoil Starters
Catalog Number 9887	Pair of Front Wheel Tire Chains

Sears, Roebuck and Co. or Simpsons-Sears Limited in Canada reserves the right to make any changes in design and changes or improvements on its implements without imposing any obligation to install the same upon its implements heretofore manufactured.

SETTING UP INSTRUCTIONS

A number at the beginning of a paragraph in the following instructions refers to an arrow in the adjoining figure except when otherwise stated. When R.H. (Right Hand) and L.H. (Left Hand) are used, it should be understood to mean from a position behind and facing the tractor (or direction of travel). Reference to "front" indicates the engine and hood end of tractor, and the "rear" the transmission.

1. Remove carton from around tractor.
2. Cut banding holding tractor to crate bottom.
3. Check tire pressure, front tires 15 pounds, rear 8 pounds.
4. This tractor is completely assembled, therefore, lubricating the tractor and adding fuel is all that is necessary before starting tractor.

NOTE: Use a good grade of regular, clean, fresh gasoline. Do not mix oil with gasoline. See Lubrication Chart.

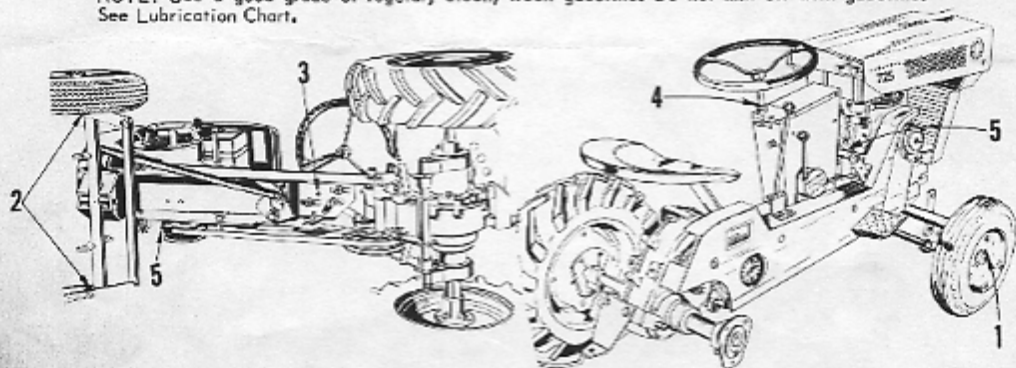
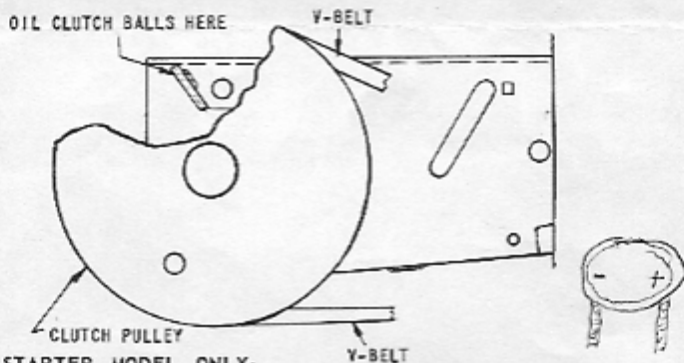
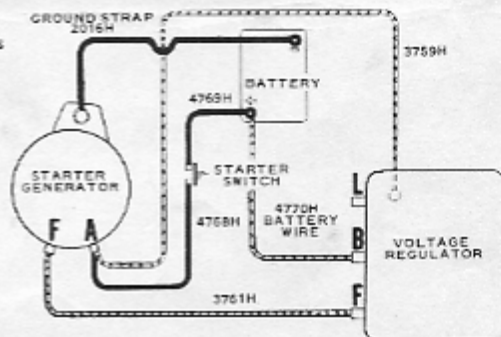

FIGURE A



FOR ELECTRIC STARTER MODEL ONLY:

1. Fill battery with electrolyte as outlined in instructions in battery container.
2. Install battery in battery box so that + terminal is to rear of tractor. Tighten bolts in battery box to hold battery securely.
3. Connect starter switch cable to positive (+) terminal.
4. Connect ground strap to negative (-) terminal.



LUBRICATION CHART

NOTE: Study this Instruction Book and Maintenance Schedule very closely. Before lubricating the tractor, clean all dirt from fittings and filler plugs. Always use recommended grades of good, clean oil. Always have tractor on level ground for checking oil level.

TIME	OPERATION	LOCATION
STARTING EACH DAY	<p>ENGINE CRANKCASE - Capacity 3 pints. Starting each day, check oil in crankcase and fill to top of filler plug. We recommend Sears Allstate All Weather Motor Oil, 10W 30 or other high quality detergent oil for service M.S.</p> <p>AIR CLEANER - Remove the wing nut and lift air cleaner cover and element from carburetor. Remove screen from inside element. Wash element in kerosene or solvent. Squeeze dry and reoil with 3 or 4 tablespoons of engine oil. Squeeze again to spread oil thru foam. Assemble screen inside element and replace element and cover to carburetor. Secure with wing nut.</p> <p>Clean and reoil element every few hours under extremely dusty conditions.</p> <p>GASOLINE FILTER - Check for water or foreign material in filter. If necessary, remove, wash in clean gasoline, blow thru in reverse direction to clean out dirt etc. Reassemble to gas lines being sure flow direction is the same, so dirt will not get to carburetor.</p> <p>FLYWHEEL HOUSING SCREEN AND CYLINDER FINS - Remove any dirt or grass that may have accumulated on the flywheel housing screen or cylinder fins, as this may interfere with the cooling of the engine.</p>	<p>Oil Filler Plug is located on top of the ENGINE Base, directly below the carburetor.</p> <p>The Gasoline Filter is located directly under the Gas Tank in the Fuel Line.</p>
EVERY TWO HOURS	<p>SPEED CHANGER - Grease fitting on spindle for speed changer sheaves. Grease sparingly, one shot with grease gun. Be sure that grease does not get on belts, as grease is very detrimental to rubber.</p>	
EVERY FIVE HOURS	<p>ENGINE CRANKCASE - After each 5 hours of operation, check the oil in the crankcase and fill to overflowing.</p> <p>CLUTCH - Place four or five drops twice daily on clutch shifter blocks. Use No. 20 Allstate or any other high grade oil.</p> <p>CLUTCH BALLS - With clutch disengaged and engine stopped, place 4 or 5 drops of oil twice daily in top of oil tube. See diagram at left.</p> <p>SEE DRAWINGS FOR LOCATIONS - Figure A, Page 4.</p> <ol style="list-style-type: none"> 1. Front wheels, grease fitting in each hub, 2 shots of grease. 2. Front spindles, grease fitting on front axle at spindle, 2 shots of grease. 3. Clutch throwout plate and pin grease fitting located under tractor on clutch throwout plate, 2 shots of grease. 4. Steering post - several drops of oil in hole in steering post cap and in hole in side of steering post. 5. Speed changer pivot - several drops of oil in speed changer bracket. 	<p>The Oil Tube is located at R.H. rear of main frame above transmission input shaft.</p>
EVERY 25 HOURS	<p>ENGINE CRANKCASE - Remove the oil DRAIN PLUG and completely drain the crankcase. DO NOT flush with kerosene or do not remove the Engine from the Mounting Frame. Replace the drain plug and refill with proper grade of oil as recommended in this chart under OPERATION, STARTING EACH DAY.</p> <p>TRANSMISSION - Remove the Oil Filler Plug and check oil. Refill as needed so that the oil level comes up to the filler plug.</p>	<p>The Drain Plug is located at the front end of the Engine Base.</p> <p>The Filler Plug is located directly above the L.H. Brake Drum.</p>
EVERY THIRTY DAYS	<p>At least once each month, tighten all bolts, cap screws, and set screws. Inspect and replace all wearing parts showing excessive wear.</p> <p>STARTER GENERATOR - If generator does not have oil cups lubricate bearings when changing brushes.</p>	
EVERY 500 HOURS	<p>TRANSMISSION - Capacity 2 quarts (4 lbs). Every 500 hours remove the Drain Plug from the Transmission and drain all oil. Replace Drain Plug and fill to the level of the Oil Filler Plug. Use Allstate or other high grade E.P. Gear Lubricant S.A.E. No. 90.</p>	<p>The Drain Plug is located on the L. H. lower side of the Transmission Case, directly below the axle.</p>

OPERATING INSTRUCTIONS

COLD WEATHER ELECTRIC STARTING INSTRUCTIONS:

1. Mix 1/2 pint kerosene to 2-1/2 pints 10W oil for crankcase in temperatures of 15 degrees Fahrenheit and lower.
 2. Keep battery in a warm room since a warm battery delivers more current.
 3. Use premium grade gasoline for easier starting in cold weather. However, we recommend regular grade gasoline in warm weather.
 4. Do not run the starter motor continuously for more than thirty seconds at a time. If the engine does not start after two or three attempts, open the choke wide, wait several minutes, then repeat. If starter motor stops turning engine over, wait several minutes before attempting to restart engine. This prevents starter motor from overheating.
 5. NOTE: Do not spill or drain solution from battery.
- CAUTION: Do not use fast charge on battery. We recommend a slow charge only.

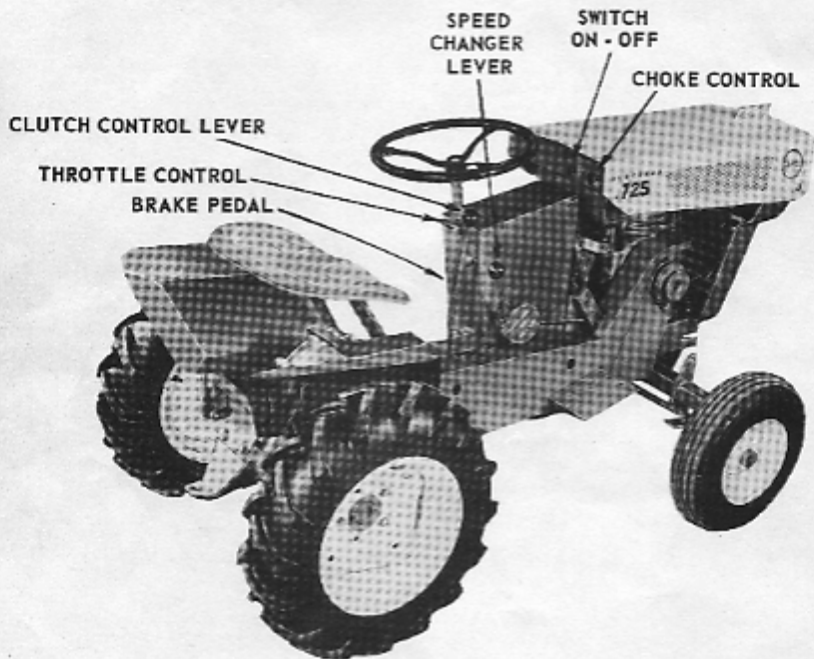

FIGURE B

STARTING AND STOPPING ENGINE:

After engine and tractor have been service (lubricated and fueled) it can now be started.

Place clutch in neutral position.

Pull out choke control and advance (push forward) throttle about halfway.

Pull rope slowly until starter clutch engages, then pull until resistance of compression is felt, continue slowly about 2 or 3 more inches until compression ceases. Allow starter rope to recoil, and again pull out slowly until starter clutch engages. Then pull with a quick, full arm stroke. Hold starter grip, while allowing rope to recoil. Repeat if necessary; after a couple of pulls, if engine does not start, open choke.

To stop engine, push the starting switch which is located on right hand side of dash panel.

NOTE: Before stopping engine, move speed changer lever back to low range. This will make it easier to start engine because of less belt drag.

OPERATING -- CONTINUED

DRIVING THE TRACTOR:

This tractor has only one lever for forward, neutral and reverse. It is called the clutch lever.

To go forward advance throttle enough for the load, and push clutch lever forward until it is engaged.

This is an over center clutch, and it is necessary to force the lever forward until a slight snap is felt.

To stop tractor, merely pull back on clutch lever until clutch snaps out of engagement.

TOWING TRACTOR:

WARNING: Do not tow tractor at more than 4 M.P.H. due to possible damage to transmission.

BRAKE:

This tractor is equipped with a brake. The brake pedal is located on the L.H. side just above L.H. foot rest. Disengage clutch lever and depress brake pedal to stop.

NOTE: There is a brake lock located on rear end of brake rod. To lock brake depress pedal and push brake lock into a notch in brake rod.

Brake lock is automatically released when brake pedal is depressed.

REVERSE:

To reverse the tractor, disengage clutch, then force clutch lever to the left rear lug on the clutch lever lock out of the lock notch and pull to the rear.

VARIABLE SPEED:

This tractor is equipped with a quick speed change. The forward speed can be varied from 2.1 M.P.H. to 4.6 M.P.H., and reverse from 1.26 to 2.83 M.P.H. at engine speed of 3600 R.P.M., while tractor is in motion. If the load on the tractor becomes too great, or is too fast for the attachment, the speed can be reduced from 4.6 to 2.1 M.P.H. or at any point in between without stopping the tractor. This speed changer lever is located just ahead of the clutch lever. With this variable speed changer, the speed can quickly and easily be changed to meet the demand. **IMPORTANT: DO NOT MOVE SPEED CHANGER LEVER WHEN THE ENGINE IS NOT RUNNING, AS THIS WILL STRETCH THE BELTS.**

NOTE: Pushing speed changer lever forward to a higher number increases ground travel speed, and pulling back to a lower number decreases speed.

TIRES:

Keep front tires inflated to 15 pounds and rear tires to 8 pounds. Underinflation will damage the tire cord body, and may cause the tire to slip on the rim and tear the valve stem. Overinflation results in excessive slippage, causing rapid tire wear. This is especially true on the rear tires. The rear tires should flex so that they are self cleaning.

WHEEL WEIGHTS:

Rear wheel weights are available where extra draw bar pull is desired. When attaching weight to the wheels the convex side should be out. Insert the bolts from the outside through the holes which have a deep recess on the concave (inner) side, and holes in wheel disc. Another wheel weight can be added by placing nut in hex recess of first weight and bolt second weight to first.

MAINTENANCE AND SERVICE INSTRUCTIONS

CARE OF BATTERY:

This tractor is equipped with a generator, therefore, it is not necessary to charge the battery unless tractor is operated for short periods of time. We suggest a trickle charger if extra charging is necessary.

Failure of storage battery can be attributed to four causes:

1. Corrosion at connections.
2. Loose connections.
3. Low water level in cells.
4. Discharged battery.

Therefore, to prevent the above conditions:

1. Clean terminals with soda and water solution and coat terminals with vasoline. Wash off all acid, which may have spilled on tractor, with soda water.

IMPORTANT: Do not get soda in battery cells.

2. Keep connections tight.
3. Add distilled water just before charging.

NOTE: In winter, if not charged after adding water, the battery will freeze.

4. Check with hydrometer very often when in use and once a month when in storage. The specific gravity of a fully charged battery is between 1250 and 1300.

BATTERY STORAGE: A DISCHARGED BATTERY will freeze.

If tractor is not used in Winter, remove battery and store in a cool place to avoid freezing. It should also be charged one hour once a month with a trickle charger. A battery loses its charge even when not being used. A battery kept charged will last longer than a battery that has become dead and recharged.

WINTER STORAGE OF TRACTOR:

Drain gasoline from tank and carburetor and see engine manual for proper winter storage of engine. Jack up tractor so that tires are not touching floor or ground. Remove battery and store in cool place; but where it cannot freeze. See Battery Storage above.

WARNING: Tractor should be stored in an enclosed building for the winter. If no building is available order Catalog No. 9881 canvas cover. This is a snug fitting cover and will protect tractor from ice, snow, sleet etc. Even in Summer your tractor will need less maintenance if properly housed or covered.

BELT TIGHTENER:

The belt tightener is spring loaded, therefore, no adjustment is necessary. When removing belt, simply roll belt out from under belt tightener pulley.

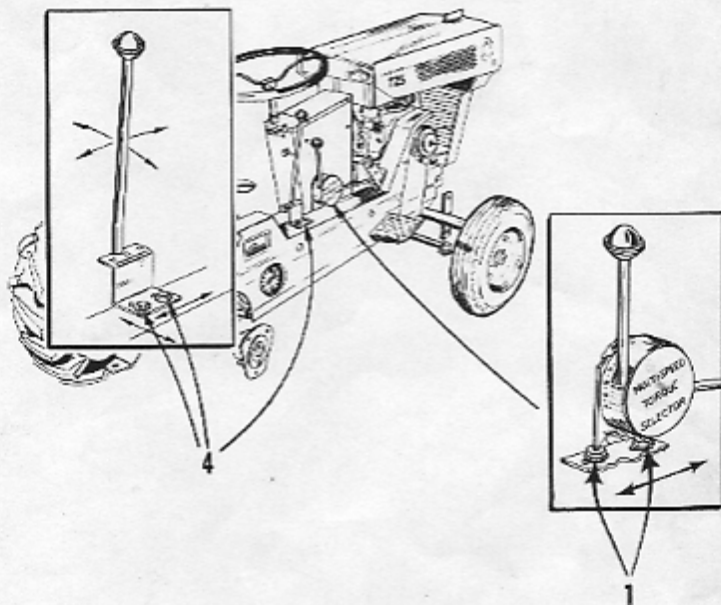

FIGURE C

ADJUST SPEED:

When your tractor is in the high speed range (speed changer lever pushed forward) the outside of the belt (speed changer to transmission) must be flush with the outside of that changer sheave.

Close adjustment can be made by loosening nuts on bolts (1) so that speed changer bracket (606A203) is loose on frame (606A225) and start engine. You will note that the engine to changer belt will travel to the bottom of the changer sheave and that the belt from the changer sheave to transmission will be to the top of that changer sheave. Rotate speed changer lever forward and push speed changer bracket and stop forward as far as possible and tighten nuts (1) securely. Start engine and rotate speed changer lever (606A204) backward and forward to check if the belts are centered in their range. This will prevent stretching of either belt.

The speed changer lever has a spring washer and hex slotted nut on L.H. side. If speed changer lever does not remain in position set, remove cotter from hex slotted nut and tighten nut one notch. Replace cotter.

NOTE: If nut is too tight lever will be difficult to move.

CLUTCH THROWOUT PLATE:

1. Push clutch lever forward, if clutch does not fully engage, push or pry clutch throwout yoke (606A57 - refer to Page 24, Illustration 13), to the right until clutch is fully engaged.
2. Loosen two nuts, Illustration 2 (under frame of tractor), on clutch throwout plate (606A58).
3. Position clutch throwout plate so that roller on clutch throwout yoke is approximately 1/4" from front end of slot in clutch throwout plate. Square clutch throwout plate parallel with frame and tighten nuts. Check to see that clutch lever engages and disengages clutch. If clutch does not engage, loosen two nuts and move clutch throwout plate slightly to the right, retighten nuts and recheck engaging and disengaging. If clutch does not disengage, move plate slightly to the left.

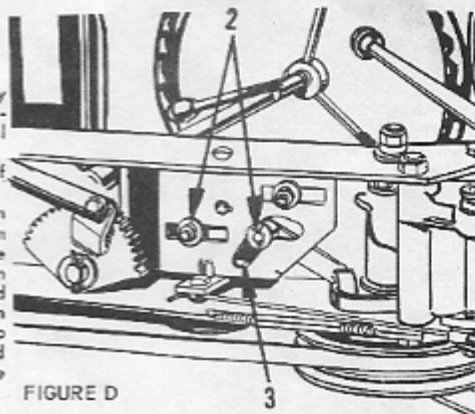

FIGURE D

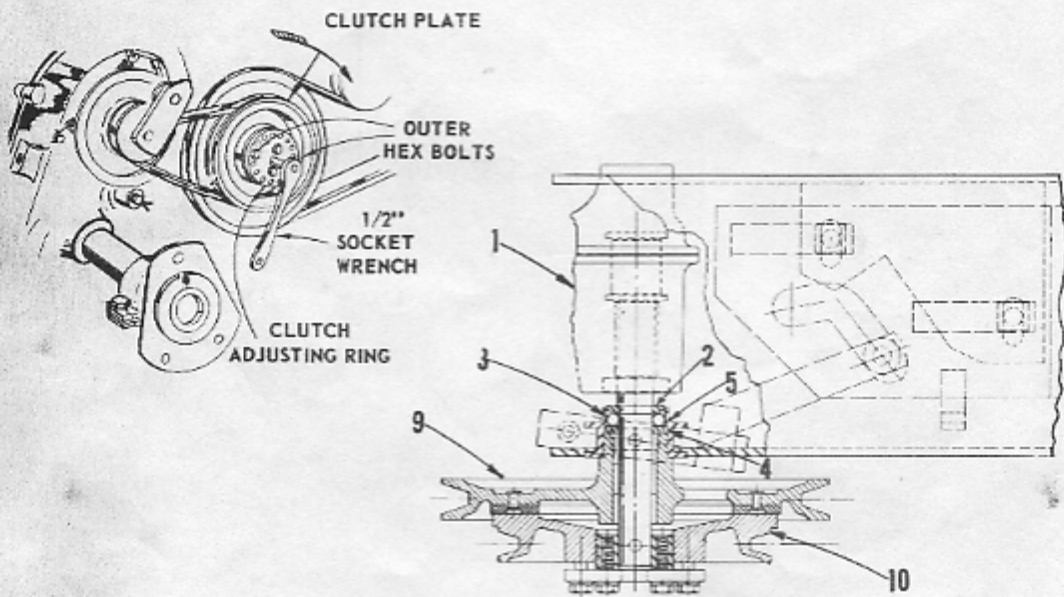

FIGURE E

CLUTCH ADJUSTMENT:

This clutch is a ball lock clutch. When clutch is engaged, clutch pressure ring (5) is moved to transmission pulley (9) as shown in drawing. The smaller inside diameter of clutch pressure ring (5) forces steel balls (3) in on thrust collar (2). This forces clutch pressure washer (4) and transmission pulley (9) against clutch plate (10). If clutch slips, remove two outer hex bolts (13) and turn clutch plate (10) clockwise 30° (one hole). Occasionally it may take one more hole, another 30° to tighten clutch properly.

When clutch is disengaged clutch pressure ring (5) is moved toward transmission (1). Steel balls move to larger inside diameter of clutch pressure ring, which releases clutch.

To tighten, remove two outer hex bolts in clutch adjusting ring, rotate clutch plate 30° (one hole) clockwise, while holding clutch adjusting ring stationary.

If clutch plate turns hard insert drive lug of 1/2" socket wrench in square hole in center of adjusting ring, which will hold ring while turning clutch plate. Replace two hex bolts and tighten securely.

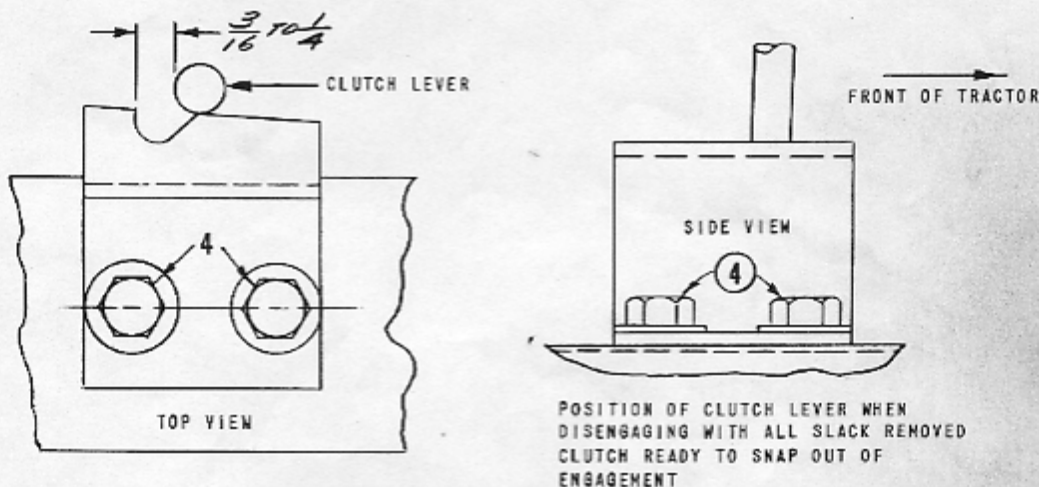

FIGURE F

ADJUST CLUTCH LEVER LOCK:

After clutch throwout plate and clutch have been adjusted properly, as per instructions above, adjust clutch lever lock.

The clutch lever lock is adjustable both forward, backwards and sideways. Loosen the two cap screws (4) as shown in Figures F and C and move clutch lever lock so the clutch lever is $\frac{3}{16}$ " to $\frac{1}{4}$ " from back lug of lever lock, when clutch lever is pulled back (all slack removed) but not disengaged. Mark this position on belt guard, then disengage clutch. Move clutch lever lock to the left on the mark made on belt guard. When properly located, clutch lever is held in notch of clutch lever lock, and it is necessary to force clutch lever to the left to pull back into reverse. Tighten two nuts securely. Check to see if clutch engages and disengages.

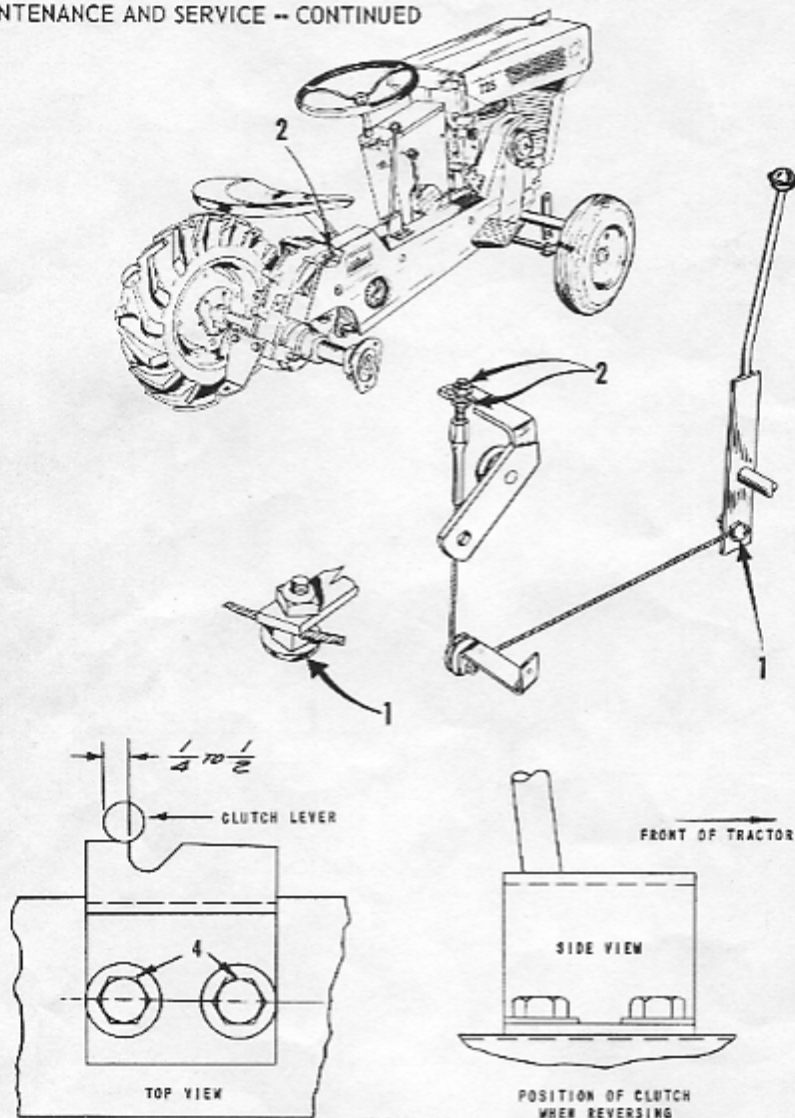

FIGURE G

REVERSE ADJUSTMENT:

1. Adjust cable so that clutch lever is approximately 1/4" to 1/2" past rear of notch in clutch lever lock, when tractor is reversing. See insert. There are two places for adjusting cable, one is located at bottom of clutch lever. It is fastened to the clutch lever by a drilled bolt. Loosen nut on bolt and adjust cable as mentioned above. Retighten nut.

IMPORTANT: Do not tighten nut too tightly to damage cable.

2. A finer adjustment can be made at the point where the cable fastens to the flanged bearing on arm. This end is threaded and adjustment is made by moving jam nuts up or down as necessary on threaded area.

NOTE: If clutch lever is difficult to hold in reverse, shorten cable adjustment.

MAINTENANCE AND SERVICE -- CONTINUED

ADJUST BRAKE:

1. Remove two screws holding cover and remove cover.
2. Tighten nut until brake band is snug on brake drum and latch is locked in middle notch - foot pedal travel approximately 2-3/4 inches.
3. Replace cover.

SEAT:

The seat has two positions. For a person with long legs, assemble seat in the rear hole of the seat spring. Another hole 2-1/2 inches forward in the seat spring for shorter legs.

WHEEL ADJUSTMENT:

The front wheels are not adjustable and wheel tread is 28 inches (tire center to tire center).

The rear wheel tread can be adjusted from 24" to 28" (center to center). To adjust the rear wheel tread, loosen cap screw on inside of hub. If hubs are difficult to move on axle, a chisel can be driven in slot of the hub for easier adjustment on axle.

PARTS LIST

SEARS SUBURBAN 725 RIDING TRACTOR

MODEL NUMBER 917.60633 OR 917.60634:

The above number is the Model Number of your Sears Suburban 725 Riding Tractor. It will be found on a plate attached to the side of the transmission. Always mention the Model Number of your Tractor when communicating with us or when ordering repair parts.

HOW TO ORDER REPAIR PARTS:

All parts listed herein may be ordered through Sears, Roebuck and Co. or Simpsons-Sears Limited. When ordering parts by mail from the mail order house which serves the territory in which you live, selling prices will be furnished on request or parts will be shipped at prevailing prices and you will be billed accordingly.

WHEN ORDERING REPAIR PARTS, ALWAYS GIVE THE FOLLOWING INFORMATION AS SHOWN IN THIS LIST:

- | | |
|---------------------|--|
| 1. The PART NUMBER. | 3. The MODEL NUMBER -- 917.60633 or 917.60634. |
| 2. The PART NAME. | 4. The NAME of Implement -- RIDING TRACTOR. |

Each part has been given a Key Number which is used only as a key to find the part number. Do not use the Key Number when ordering repair parts.

Cotter pins and lockwashers of standard dimensions do not carry part numbers. When these standard items are needed in service they should be purchased at the nearest Sears, Roebuck and Co. or Simpsons-Sears Limited store or from a local hardware store.

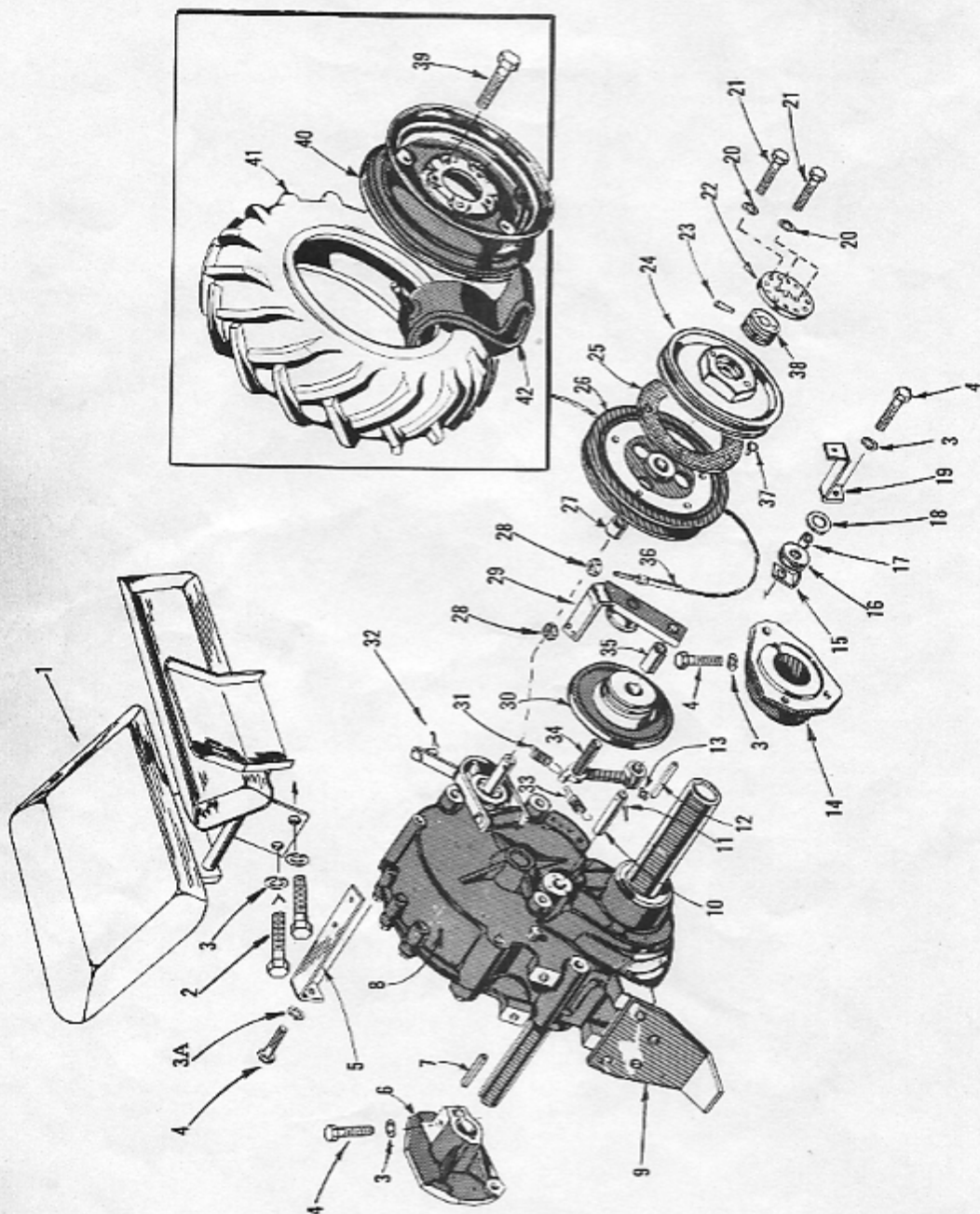

FIGURE H

For Parts List -- See Page 15.

KEY PART NO.	DESCRIPTION	KEY PART NO.	DESCRIPTION
1	606A231 Fenders, Complete	21	04600416 Bolt, Finished Hex, Heat Treated
2	04010818 *Bolt, Finished Hex 1/2 x 1 1/4 ASRU - 13 NC	22	3487H Clutch Adjusting Ring
3	10020800 *Washer, Lock 1/2	23	4865M Groove Pin
3A	10030600 *Washer, Lock 3/8	24	3491H Clutch Plate
4	04010620 *Bolt, Finished Hex 3/8 x 1-3/8 - 16 UNC	25	9552M Clutch Facing
5	4176H Belt Guard Support, Rear	26	606A82 Transmission Pulley (Inc. Key No. 25)
6	1284H Wheel Hub, L.H.	27	9551M Bearing
7	4700A Square Key, 1/4	28	03060400 *Nut, Hex Jam 1/4 ASF - 28 UNF
8	606A201 Transmission	29	606A155 Flanged Bearing and Arm
9	1249H1 Drawbar	30	606A86 Idler Sheave and Bearing
10	463H Idler Arm Pivot Shaft	31	3927H Spring
11	06010614 *Cotter, 3/16 x 7/8	32	06010410 Cotter, 1/8 x 5/8
12	4700A Square Key, 1/4	33	9462M Spring
13	4968H Grease Fitting	34	606A214 Idler Arm and Shaft
14	1283H Wheel Hub, R.H.	35	1310H Bearing
15	1258H Pulley Bracket	36	1317H Cable and Terminal
16	1217H Pulley	37	05080408 Brass Tubular Rivet, 1/4 x 1/2
17	9833E Bushing	38	3485H Adjusting Sleeve
18	09131316 *Washer, Flat 13/32 x 13/16 x 16 Ga.	39	1304H Hub Bolt, Cad. Plated
19	4175H Belt Guard Bracket, Rear	40	1297H1 Wheel
20	10030400 *Washer, Lock 1/4	41	1295H Tire, 600-12 - 2 Ply
		42	1296H Tube, 600-12 - Straight Valve Stem
		--	916.60633 Operating Manual and Parts List
		and	917.60634

*Standard Hardware Item -- May Be Purchased Locally

For Illustration -- See Page 14.

another free manual from www.searstractormanuals.com

FIGURE 1

For Parts List -- See Page 17.

PARTS LIST

KEY NO.	PART NO.	DESCRIPTION	KEY NO.	PART NO.	DESCRIPTION
1	04600535	Bolt, Finished Hex Heat Treated	27	4280M1	Oil Seal
2	4237H	Bushing	28	13020400	*Plug, Standard Pipe 1/2 - 14 N.P.T. (Filler)
3	06010308	*Cotter, 3/32 x 1/2	29	04010622	*Screw, Hex Head Cap 3/8 x 1-3/8 - 16 UNC
4	606A211	Brake Pedal and Bushing	30	10030600	*Washer, Lock 3/8
5	4243H	Pedal Cover	31	13020200	*Plug, Standard Pipe 1/2 - 18 N.P.T. (Drain)
6	03220500	*Nut, Hex 5/16 - 18 UNC ASF	32	509H	Bearing
7	10030500	*Washer, Lock 5/16	33	1302H	Gear Cover Thrust Washer
8	09111116	*Washer, 11/32 x 11/16 x 16 Ga., Cad. Plated	34	498H	Thrust Washer
9	4240H1	Brake Rod	35	4276M	Bushing
10	03220500	*Nut, Hex 1/4 - 20 UNC ASF Cad. Plated	36	1312H	Gasket
11	19111118	*Washer, 11/32 x 11/16 x 18 Ga., Cad. Plated	37	575PA825	Intermediate Shaft, Gear and Sprocket
12	4199H	Spring	38	501H	Chain
13	05080404	Rivet, Brass Tubular	39	4200H	Oil Seal
14	03300800	*Nut, Hex Jam 1/2 - 20 UNF ASF	40	4201H	Input Pinion
15	17841006	*Screw, Pan Head Slotted Self Tapping #10 x 3/8 Type B, Cad. Plated	41	606A88	Gear Case and Bushing
16	4259H	Brake Cover	42	4279M1	Oil Seal
17	606A209	Brake Band and Lining	43	7393M	Clutch Thrust Collar
18	319H	Huglock Nut	44	7394M	Clutch Pressure Ring
19	02230405	*Bolt, Square Neck Carriage 1/4 - 20 UNC x 5/8 Cad. Plated	45	06010614	*Cotter, 3/16 x 7/8
20	4202H	Brake Lining	46	4306M	Rivet, Drilled R.H.
21	4191H	Brake Drum	47	8753M	Clutch Shift Blocks
22	4241H	Brake Latch	48	606A57	Clutch Throwout Weldment
23	19091016	*Washer, 9/32 x 5/8 x 16 Ga., Cad. Plated	49	7392M	Steel Balls, (11 Req.)
24	9851M1	Woodruff Key	50	9553M	Clutch Pressure Washer
25	606A200	Gear Case Cover and Bushing	51	1305H	Drive Stud, Round Head
26	2103M	Metal Plug	52	5111H	Oil Seal
			53	508H	Bearing
			54	1303H	Gear Case Thrust Washer
			55	4275M	Dowel Pin
			56	575PA826	Axle and Gear
			57	606A77	Sprocket and Pinions
			58	606A80	Axle Tube and Bearings
			59	479H	Metal Plug

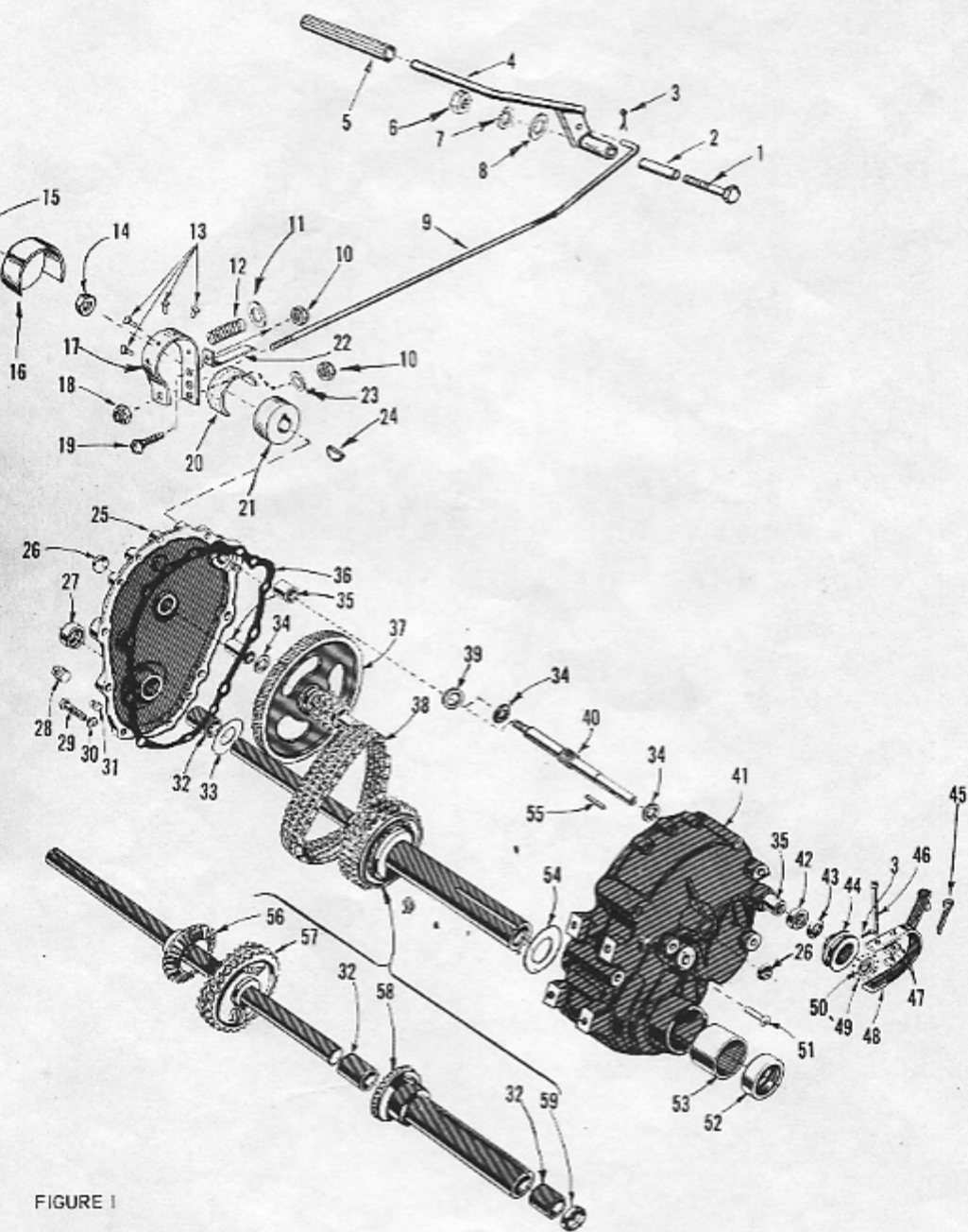
*Standard Hardware Item --
may be purchased locally.

For Illustration -- See Page 16.

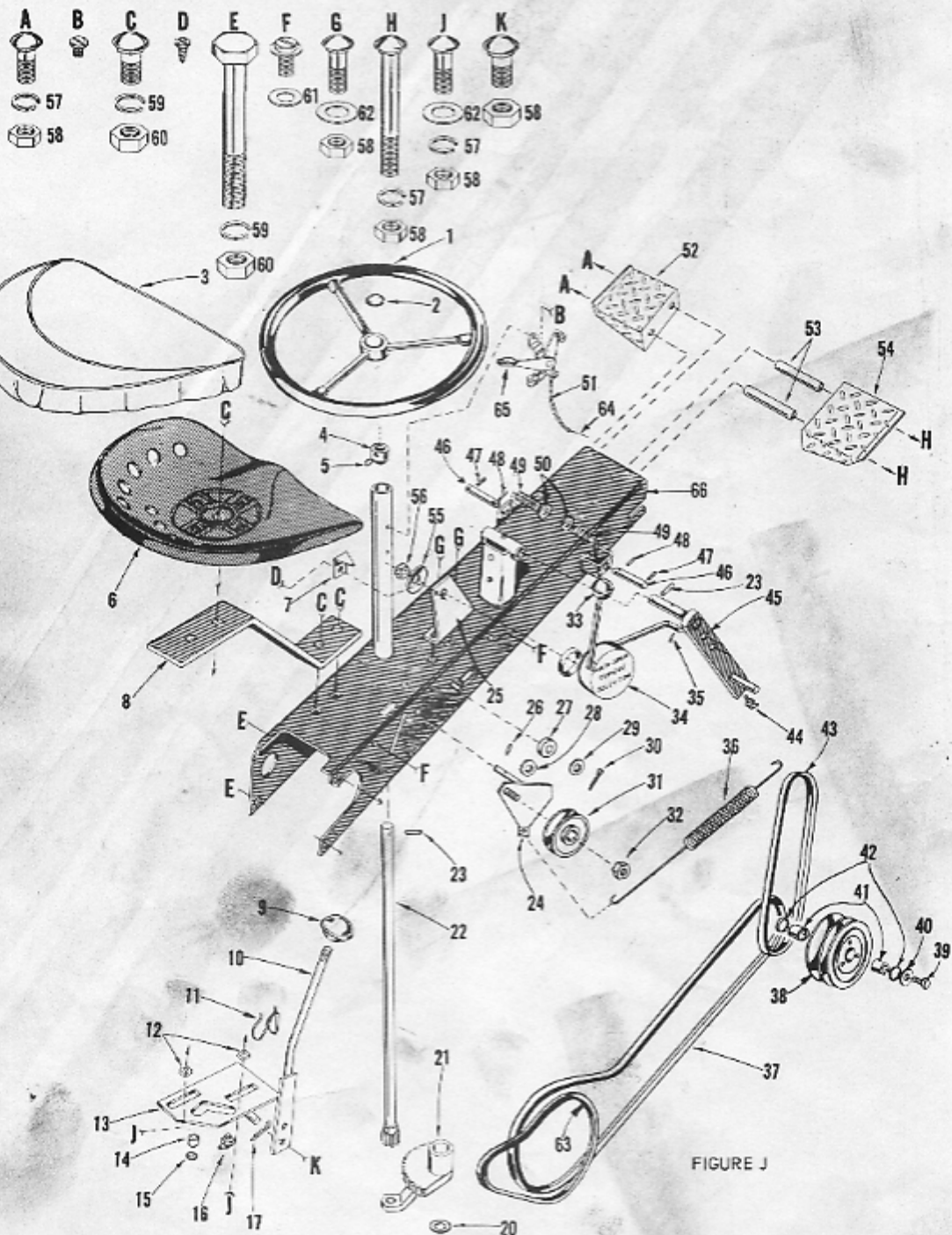

FIGURE J

For Parts List -- See Page 19.

SEARS SUBURBAN 725 RIDING TRACTOR -- MODEL NUMBER 917.60633 (12 VOLT STARTER)
AND 917.60634 (RECOIL STARTER)

PARTS LIST

KEY NO.	PART NO.	DESCRIPTION	KEY NO.	PART NO.	DESCRIPTION
1	4773H	Steering Wheel	43	1322H	V-Belt
2	3274H	Plug Button	44	4646H	Grease Fitting
3	4964H	Seat Pad	45	606A76	Changer Arm and Shaft
4	4723H	Steering Post Cap	46	1202H	Latch Pin
5	04250505	*Screw, Hex Socket Headless Set C.P. 5/16-18 UNC x 5/16	47	9465M	Roll Pin
			48	407H	Roll Pin
			49	1300H	Spring
6	1415M	Seat	50	08171713	*Washer, Flat 17/32 x 1-1/16 x 13 Ga.
7	4217H	Speed Indicator			
8	1248H	Seat Spring	51	3740H	Throttle Control Wire Cover
9	9439M	Control Knob	52	4748H	Foot Rest, L.H.
10	606A224	Clutch Lever	53	4170H	Foot Rest Support
11	1590H	Clutch Lever Spring	54	4747H	Foot Rest, R.H.
12	1219H	Guide Block	55	9914M	Spring Washer
13	606A58A	Clutch Throwout Plate and Pin	56	03370800	*Nut, Hex Slotted 1/2 x 13 UNC, ASF
14	1205H	Clutch Throwout Roller	57	10030600	*Washer, Lock 3/8
15	09141614	*Washer, Flat 7/16 x 1 x 14 Ga.	58	03030600	*Nut, Hex 3/8-16 UNC
			59	10020800	*Washer, Lock 1/2
16	4967H	Grease Fitting	60	03030800	*Nut, Hex 1/2 x 13 NC
17	06010614	*Cotter, 3/16 x 7/8	61	90991016	*Washer, Flat 9/32 x 5/8 x 16 Ga.
20	09262014	*Washer, Flat 13/16 x 1 1/4 x 14 Ga.	62	09131316	*Washer, Flat 13/32 x 13/16 x 16 Ga.
21	606A220	Steering Gear Sector and Arm	63	3496H	V-Belt
22	606A221	Steering Shaft and Pinion	64	3739H	Throttle Control Wire
23	8576M	Roll Pin	65	575H	Throttle Control Lever
24	606A212	Belt Tightener	66	606A225	Frame Weldment with Bearing
25	606A203	Speed Changer Bracket and Stop	A	02460608	*Bolt, Sq. Neck Carriage 3/8-16 UNC x 1, Short Shoulder
26	173H	Roll Pin	B	17161004	*Screw, Truss Head Thread Cutting - Type 1 #10 - 24 UNC x 1/4, Cad. Plated
27	3926H	Rubber Bushing			
28	08182212	*Washer, 9/16 x 1-3/8 x 12 Ga.	C	02010808	*Bolt, Sq. Neck Carriage 1/2-13 UNC x 1
29	09091016	*Washer, Flat 9/32 x 5/8 x 16 Ga.	D	17841006	*Screw, Slotted Self-Tapping Pan Head #10 x 3/8 Type B, Cad. Plated
30	06010308	*Cotter, 3/32 x 1/2	E	98000048	*Bolt, Finished Hex 1/2 x 13 UNC x 6 1/2
31	4178H	Flat Idler	F	17240408	*Screw, Slotted Hex Washer Head Thread Cutting, Type 1-1/4-20 UNC x 1/2 Cad. Plated
32	03030700	*Nut, Hex 7/16-14 UNC, ASF	G	02010606	*Bolt, Sq. Neck Carriage 3/8-16 NC x 3/4
33	9439M	Control Knob	H	02010632	*Bolt, Sq. Neck Carriage 3/8-16 UNC x 4
34	606A204	Lever and Cover	J	2052H	Bolt, Sq. Neck Carriage Heat Treated
35	172H	Roll Pin	K	1274H	*Bolt, Drilled Sq. Neck Carriage
36	4179H	Spring			
37	1323H	V-Belt			
38	575PA820	Speed Changer and Bearing			
39	04010408	*Bolt, Finished Hex 1/2- 20 UNC x 1/2			
40	3340H	*Washer, Flat 5/16 x 1 x 16 Ga., Heat Treated			
41	9437M	Needle Bearing, Torrington B 95			
42	9438M	Oil Seal			

*Standard Hardware Item --
may be purchased locally.

For Illustration -- See Page 18.

SEARS SUBURBAN 725 RIDING TRACTOR -- MODEL NUMBERS 917.60633 AND 917.60634

another free manual from www.searstractormanuals.com

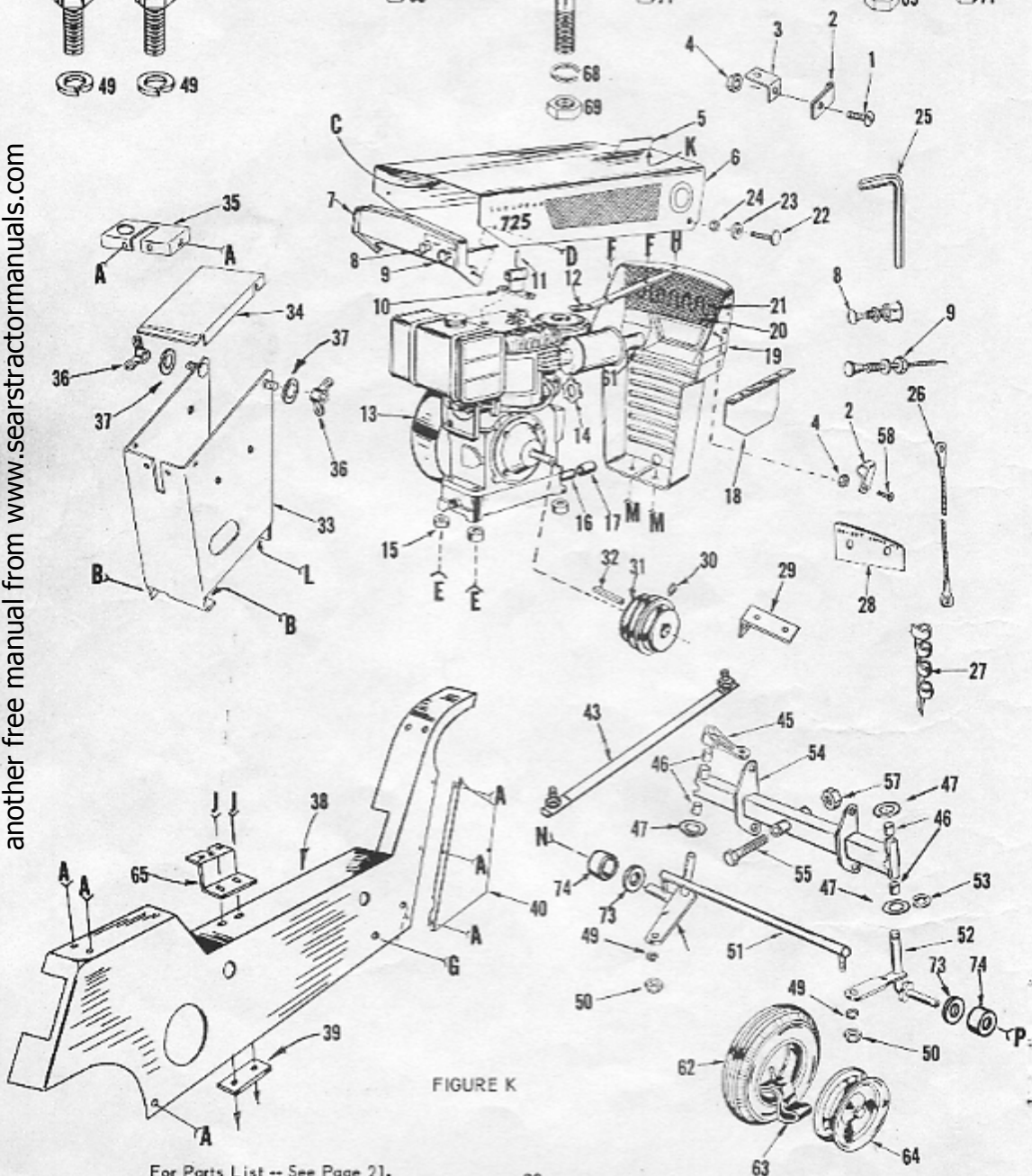
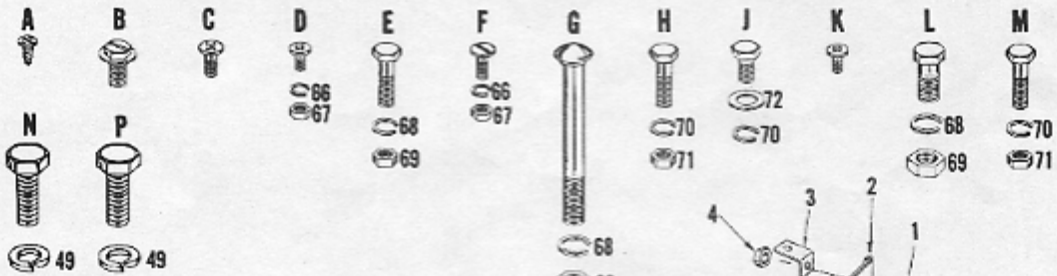

FIGURE K

For Parts List -- See Page 21.

SEARS SUBURBAN 725 RIDING TRACTOR -- MODEL NUMBERS 917.60633 AND 917.60634

PARTS LIST

KEY NO.	PART NO.	DESCRIPTION	KEY NO.	PART NO.	DESCRIPTION
1	04070408	*Screw, Round Hd. Machine 1/4-20 UNC x 1/2	49	10030600	*Washer, Lock 3/8
2	1697H	Choke Control Clip	50	03290600	*Nut, Hex 3/8-24 UNF
3	1782H	Choke Control Bracket	51	4761H	Tie Rod and Joints
4	03220400	*Nut, Hex Machine Screw 1/4-20 UNC, Cad. Plated	52	606A217	Spindle - R.H., Complete
5	3582H	Cowling Ornament	53	52913	"E" Ring .514 x 1.120 x .050
6	606A179	Cowling Top and Brackets	54	606A226	Front Axle with Bearings
7	3577H	Cowling, Rear	55	04011072	*Bolt Finished Hex 5/8 - 11 UNC x 4 1/2
8	2860H	Switch	57	4764H	*Nut, Huglock 5/8-11 UNC
9	2905H	Choke Control	58	04670412	*Screw, Pan Hd. 1/4-20 UNC x 3/4, Cad. Plated
10	606A188	Cowl Lock Weldment	61	3579H	Muffler
11	3656H	Roll Pin	62	3661H	Tire, 4.00-8 - 2 Ply
12	3663H	Heat Shield Bracket	63	338H	Inner Tube, 600-12 with Straight Valve Stem
13	606A232	Briggs and Stratton Engine with Recoil Starter, Model 19D	64	4760H	Wheel, Front
13	606A215	Briggs and Stratton Engine with Electric Starter, Model 19D	65	4174H	Clutch Lever Bracket
14	98000063	*Lock Nut, Conduit 1-11 - 1/2	66	10051000	*Washer, Lock #10
15	3658H	Engine Mount Spacer	67	03141000	*Nut, Hex #10-24 NC
16	13110300	*Pipe Nipple, 3/8 x 3 1/2 Long 18 N.P.T.	68	10030600	*Washer, Lock 3/8
17	13110400	*Pipe Coupling 3/8-18 N.P.T.	69	03030600	*Nut, Hex 3/8-16 UNC
18	3928H	Heat Shield	70	10030500	*Washer, Lock 5/16
19	3576H	Cowling, Front	71	03030700	*Nut, Hex 5/16-18 NC, ASF
20	3573H	Grill, Front	72	09121414	*Washer, Flat 3/8 x 7/8 x 14 Ga.
21	3662H	Grill Retainer	73	09132507	*Washer, Flat 13/32 x 1-9/16 x 7 Ga.
22	3578H	Cowling Pivot Bolt	74	1254H	Dust Cap
23	19141614	*Washer, Flat 7/16 x 1 x 7 Ga., Cad. Plated	A	17841006	*Screw, Pan Hd. Self Tapping #10 x 3/8 Type B, Cad. Plated
24	1685H	Lock Nut	B	17240408	*Screw, Slotted Hex Washer Hd. Thread Cutting Type 1, 1/4-20 UNC x 1/2
25	7755E	Allen Set Screw Wrench for 5/16 Set Screw	C	17191006	*Machine Screw, Truss Hd. Cross Recess #10-24 UNC x 3/8
26	3943H	Terminal	D	17521010	*Screw, Truss Hd. Cross Recess #10-24 UNC x 5/8 Cad. Plated
27	3498H	Tie	E	04010618	*Bolt, Finished Hex 3/8- 16 UNC x 1 1/4
28	3581H	Dash Board Plate	F	04461008	*Screw, Truss Hd. Slotted Machine #10-24 UNC x 1/2
29	4177H	Guard Bracket, Front	G	02010632	*Bolt, Sq. Neck Carriage 3/8- 16 UNC x 4
30	04250510	*Set Screw, Hex Socket Headless C.P. 5/16- 18 UNC x 5/8	H	04010516	*Bolt, Finished Hex 5/16- 18 UNC x 1
31	606A93	Motor Pulley and Set Screw	J	04010508	*Bolt Finished Hex 5/16- 18 UNC x 1/2
32	9396E	Square Key	K	17540806	*Screw, Truss Hd. Cross Recess Machine #8-32 UNC x 3/8
33	606A233	Battery Housing Assembly	L	04010612	*Bolt, Finished Hex 3/8- 16 UNC x 3/4
34	4736H	Battery Housing Cover, Front	M	04760516	*Bolt, Finished Hex 5/16- 18 UNC x 1, Cad. Plated
35	4737H	Battery Housing Cover, Rear	N	04850616	*Bolt, Finished Hex 3/8-16 UNC x 1 L.H. Thread
36	3748M	Wing Nut	P	04010616	*Bolt, Finished Hex 3/8-16 UNC x 1 R.H. Thread
37	09091016	*Washer, Flat 9/32 x 5/8 x 16 Ga.			
38	606A216	Belt Guard, Complete			
39	4168H	Lock Plate			
40	606A228	Belt Guard, Front and Mounting Strap			
43	4762H	Drag Link and Joints			
45	4759H	Drag Link Arm			
46	1309H	Bearing			
47	09262014	*Washer, Flat 13/16 x 1 1/4 x 14 Ga.			
48	606A218	Spindle - L.H., Complete For Illustration -- See Page 20.			

*Standard Hardware Item --
may be purchased locally.

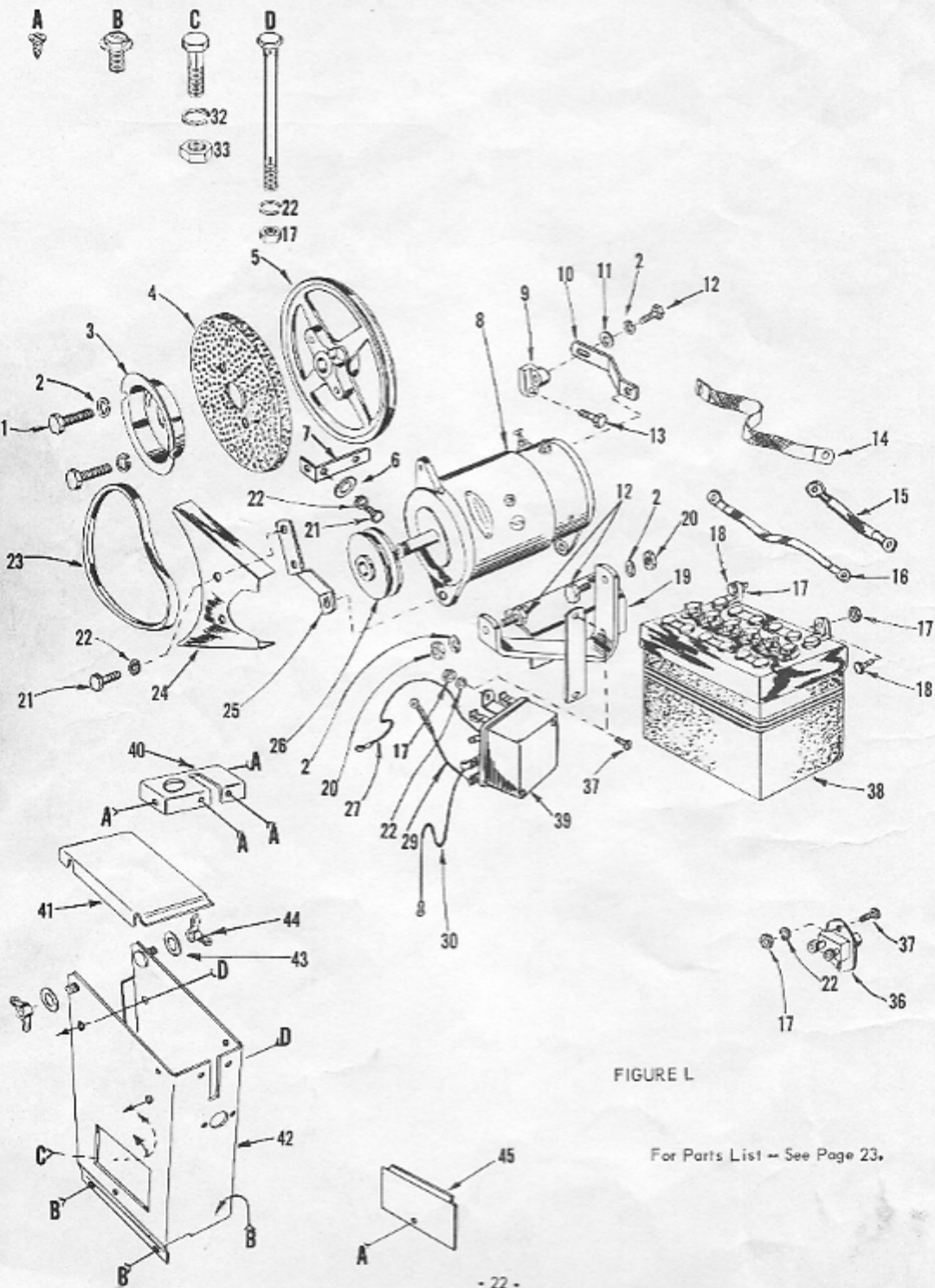

FIGURE L

For Parts List -- See Page 23.

PARTS LIST

KEY NO.	PART NO.	DESCRIPTION	KEY NO.	PART NO.	DESCRIPTION
1	04600538	Bolt, Finished Hex Heat Treated	22	10030400	*Lockwasher, 1/4
2	10030500	*Lockwasher, 5/16	23	3754H1	V-Belt
3	3757H	Rope Starter Pulley	24	3747H	Belt Guard
4	3756H	Flywheel Screen	25	606A192A	Guard Bracket and Nut, Lower
5	3755H	Engine Pulley	26	3763H	Generator Pulley
6	09101216	*Washer, Flat 5/16 x 3/4 x 16 Ga.	27	3759H	Ground to Generator Wire
7	606A193	Guard Bracket and Nut, Upper	29	3761H	Field Wire
8	606A189	Generator	30	4770H	Battery Wire
9	3753H	Adjusting Bracket	32	10030600	*Lockwasher, 3/8
10	3743H	Generator Adjusting Strap	33	03030600	*Nut, Hex 3/8 - 16 NC, ASF
11	09121414	*Washer, Flat 3/8 x 7/8 x 14 Ga.	36	4767H	Starter Switch
12	04760520	*Bolt, Finished Hex 5/16 - 18 UNC x 1 1/4 Cad. Plated	37	04390408	*Screw, Slotted Round Head Machine 1/4 - 20 UNC x 5/8, Cad. Plated
13	04760524	*Bolt, Finished Hex 5/16 - 18 UNC x 1 1/2 Cad. Plated	38	1709H1	12 Volt Battery
14	2016H	Ground Strap	39	606A190	Voltage Regulator
15	4769H	Battery Cable (Battery to Switch)	40	4737H	Battery Housing Cover - Rear
16	4768H	Battery Cable (Switch to Starter)	41	4736H	Battery Housing Cover - Front
17	03220400	*Nut, Hex 1/4 - 20 NC, ASF Cad. Plated	42	606A227	Battery Housing Assembly
18	04760412	*Bolt, Finished Hex 1/4 - 20 NC x 3/4, Cad. Plated	43	09091016	*Washer, Flat 9/32 x 5/8 x 16 Ga.
19	606A191	Generator Mount	44	3748M	Wing Nut
20	03220500	*Nut, Hex 5/16 - 18 NC ASF, Cad. Plated	45	4738H	Battery Housing Cover - Side
21	04760408	*Bolt, Finished Hex 1/4 - 20 NC x 3/8, Cad. Plated	A	17841006	*Screw, Pan Hd. Slotted Self-Tapping #10 - 3/8 Type B
			B	17240408	*Screw, Slotted Hex Washer Hd, Thread Cutting Type 1, 1/2 - 20 UNC x 1/2
			C	04010612	*Bolt, Finished Hex 3/8 - 16 UNC x 3/4
			D	04760492	*Bolt, Finished Hex 1/4 - 20 NC x 5/8, Cad. Plated

*Standard Hardware Item -- may be purchased locally.

For Illustration -- See Page 22.



SAFETY FIRST

CAUTION: Keep all bolts and nuts securely tight. Check at regular intervals.

Sears, Roebuck and Co. or Simpsons-Sears Limited reserves the right to make any changes in design and changes or improvements on its implements without imposing any obligations to install the same upon its implements heretofore manufactured.